

F.A.P. RTE.	SECTION	COUNTY	TOTAL SHEETS	SHEET NO.
*	**	***	68	13
STA. 716+01.34		TO STA. 723+24.84		
FED. ROAD DIST. NO.		ILLINOIS	FED. AID PROJECT	

- * FAP 332 (IL 1); FAP 328 (US 45)
- ** 101B-1; (8BR-1B-1)
- *** WABASH / WAYNE

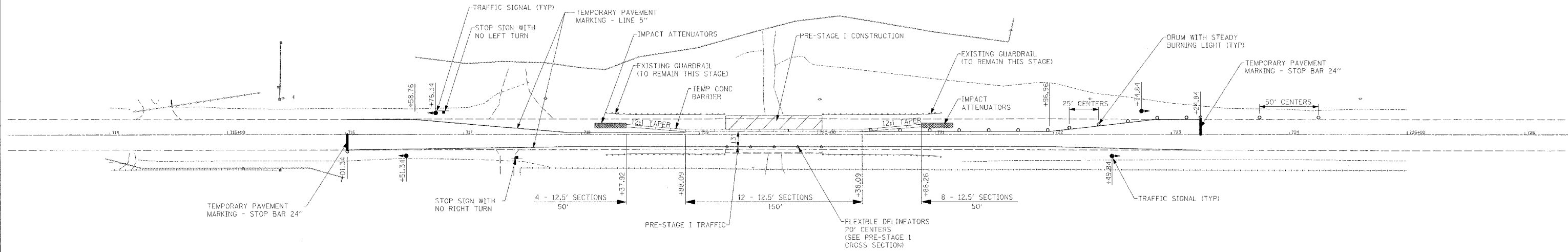

SEQUENCE OF CONSTRUCTION

1. SET-UP PRE-STAGE I TRAFFIC CONTROL.
2. INSTALL FLEXIBLE DELINEATORS ALONG RIGHT SIDE OF STRUCTURE.
3. REMOVE AND REPLACE TWO EXTERIOR BEAMS ON LEFT SIDE OF STRUCTURE
4. RESURFACE AREA OF BEAM REMOVAL & REPLACEMENT.
5. CHANGE TRAFFIC CONTROL TO STAGE I.

PRE-STAGE I

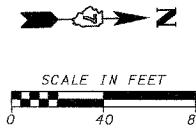

NOTES

ADVANCED WARNING SIGNS, TEMPORARY RUMBLE STRIPS, VERTICAL PANELS, PAVEMENT MARKERS, AND BARRICADE REFLECTORS SHALL BE LOCATED IN ACCORDANCE WITH TRAFFIC CONTROL AND PROTECTION STANDARD 701321.

SEE SPECIAL PROVISIONS, STAGING TYPICAL SECTIONS, AND HIGHWAY STANDARD 701321 FOR ADDITIONAL INFORMATION.

IMPACT ATTENUATORS SHALL CONFORM TO BDE PROCEDURE MEMORANDUM NO. 34-06 "IMPACT ATTENUATORS (CRASH CUSHIONS)"

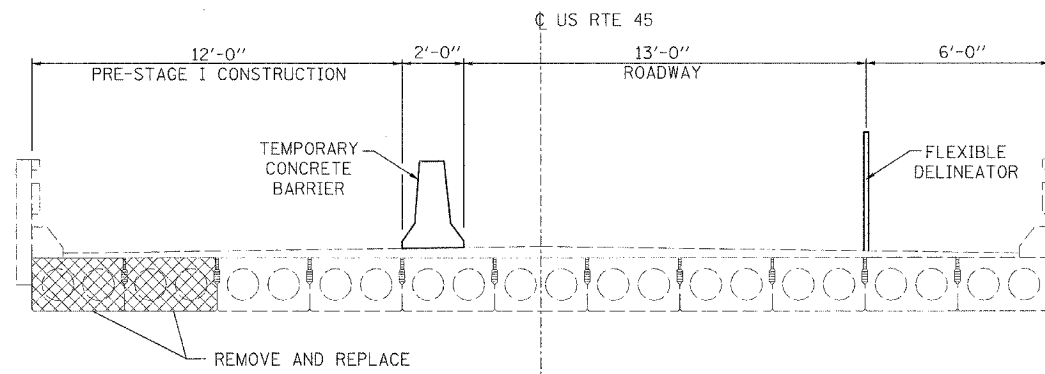

PRE-STAGE I CROSS SECTION

REVISIONS	
NAME	DATE

ILLINOIS DEPARTMENT OF TRANSPORTATION

STAGING DETAILS
US ROUTE 45
OVER ENDSLEY CREEK

SCALE: VERT. N/A
HORIZ. 1" = 40'
DATE 03/15/2007

DRAWN BY KMO
CHECKED BY SSM