

F.A.P. RTE.	SECTION	COUNTY	TOTAL SHEETS	SHEET NO.
*	**	***	68	49
STA. 143+00.00		TO STA. 146+00.00		
FED. ROAD DIST. NO.		ILLINOIS FED. AID PROJECT		
• FAP 332 (IL 1); FAP 328 (US 45) • 101B-1; (BBR-1)B-1 • WABASH / WAYNE				

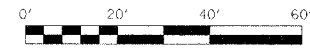

PLAN	DATE	BY
SURVEYED		
ALIGNED		
CHECKED		
NOTE BOOK		
NO.		

PROFILE	DATE	BY
SURVEYED		
GRADES CHECKED		
NOTE BOOK		
NO.		

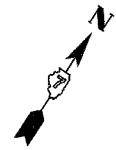
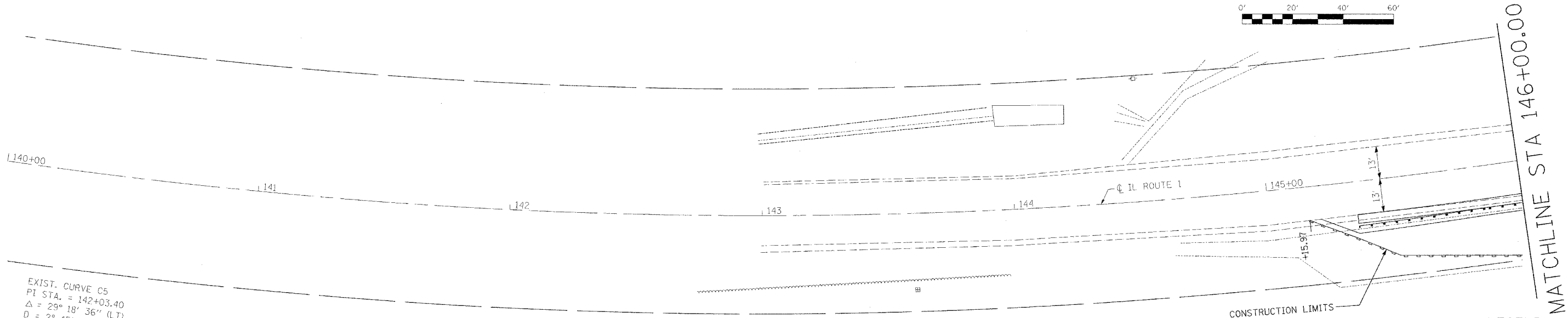

EXIST. CURVE C5  
 PI STA. = 142+03.40  
 $\Delta = 29^\circ 18' 36''$  (LT)  
 $D = 2^\circ 45' 00''$   
 $R = 2,083.48'$   
 $T = 544.84'$   
 $L = 1,065.82'$   
 $E = 70.06'$   
 $e =$   
 $T.R. =$   
 $S.E. RUN =$   
 $P.C. STA. = 136+58.56$   
 $P.T. STA. = 147+24.38$

CONSTRUCTION LIMITS

**LEGEND**

- PERIMETER EROSION BARRIER
- ◆ TEMPORARY DITCH CHECK

MATCHLINE STA 146+00.00

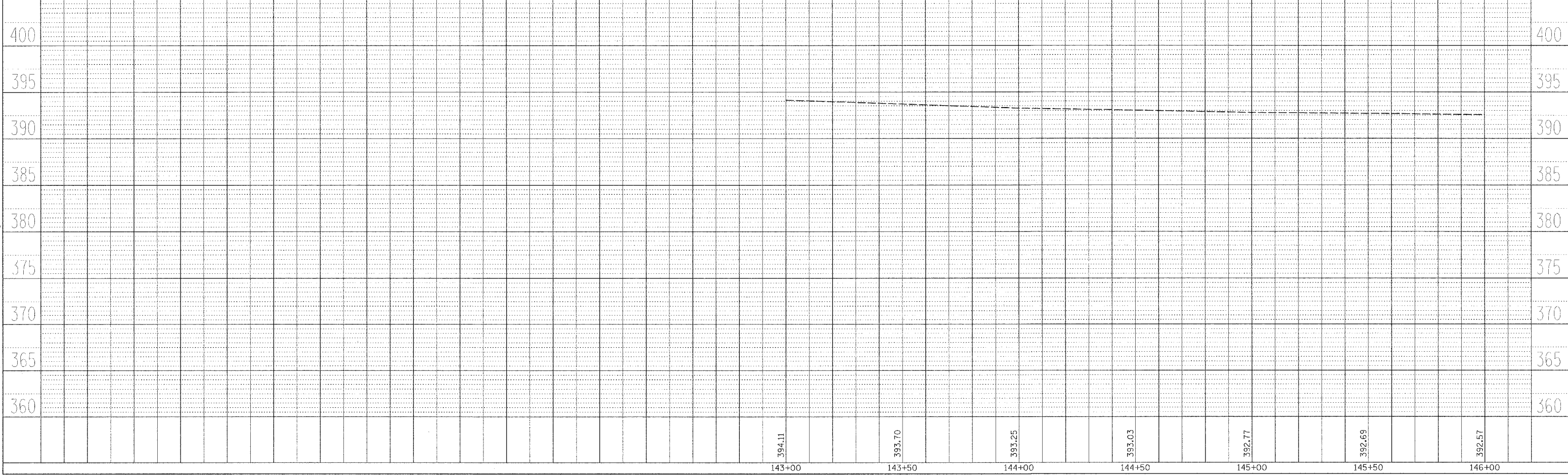

Plot Date: 3/7/2007  
 Plot Date: 3/7/2007  
 Plot Name: Erosion Control Plan  
 Plot Scale: 1/4" = 10'-0"