

| F.A. RTE. | SECTION | COUNTY | TOTAL SHEETS | SHEET NO. |
|-----------|--------------------------|--------|--------------|-----------|
| • | •• | ••• | 12 | 1 |
| • | VARIOUS | | | |
| •• | D-7 PAVT PATCHING 2007-2 | | | |
| ••• | VARIOUS | | | |

D-97-081-06

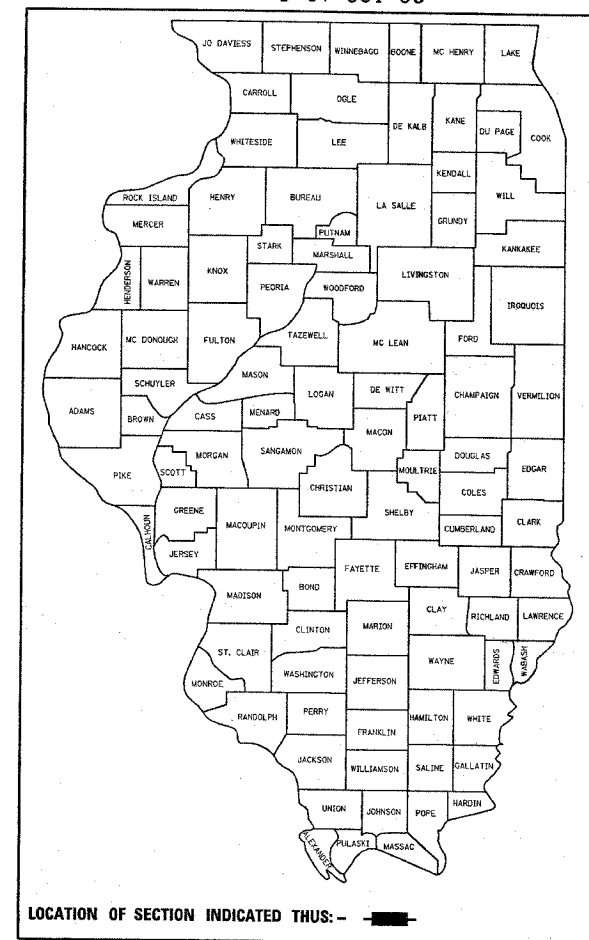

STATE OF ILLINOIS
DEPARTMENT OF TRANSPORTATION
DIVISION OF HIGHWAYS

**PROPOSED
HIGHWAY PLANS**

VARIOUS ROUTES
SECTION: D-7 PAVT PATCHING 2007-2
VARIOUS COUNTIES
C-97-027-06

FOR INDEX OF SHEETS, SEE SHEET NO. 2

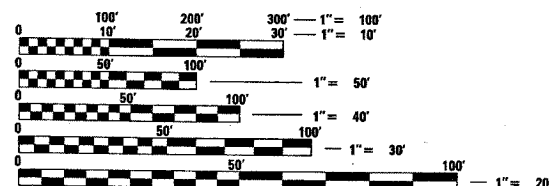
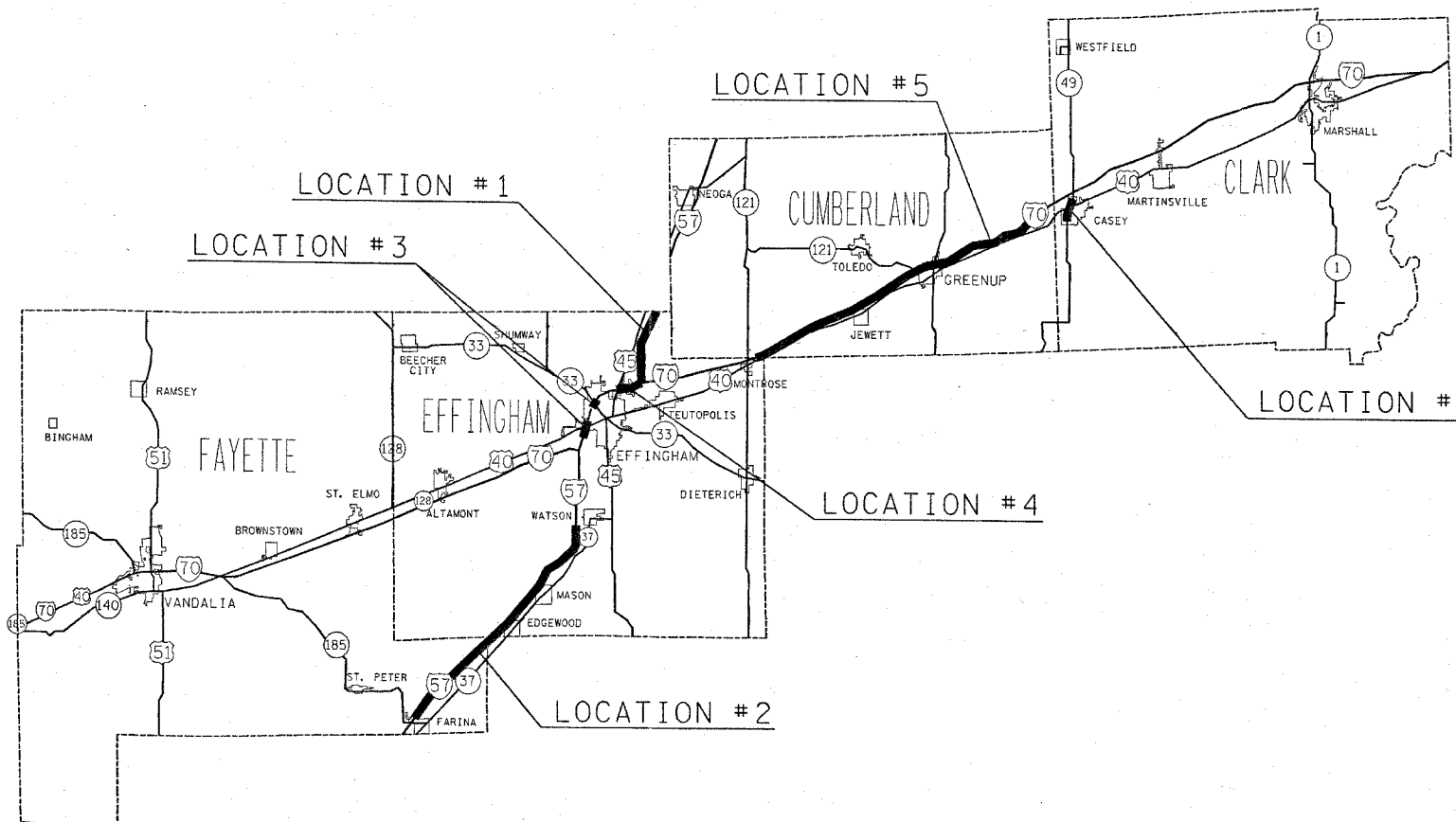

FULL SIZE PLANS HAVE BEEN PREPARED USING STANDARD ENGINEERING SCALES. REDUCED SIZED PLANS WILL NOT CONFORM TO STANDARD SCALES. IN MAKING MEASUREMENTS ON REDUCED PLANS, THE ABOVE SCALES MAY BE USED.

J.U.L.I.E.
JOINT UTILITY LOCATION INFORMATION FOR EXCAVATION
1-800-892-0123

PROJECT ENGINEER : BILL STANLEY
SQUAD LEADER : JENNIFER WENTHE
DESIGNER : DOUG HOLLAND
TELEPHONE : 217/342-3951 EX 361

CONTRACT NO. 74198

STATE OF ILLINOIS
DEPARTMENT OF TRANSPORTATION
DIVISION OF HIGHWAYS

SUBMITTED March 15, 2007

Christ H. Wood
DEPUTY DIRECTOR OF HIGHWAYS, REGION ENGINEER

May 11, 2007
Eric E. Howard
SENIOR ENGINEER OF DESIGN AND ENVIRONMENT

May 11, 2007
Milton R. Sess, P.E.
DIRECTOR OF HIGHWAYS, CHIEF ENGINEER

PRINTED BY THE AUTHORITY
OF THE STATE OF ILLINOIS

| F.A. RTE. | SECTION | COUNTY | TOTAL SHEETS | SHEET NO. |
|---------------------|---------|---------------------------|--------------|-----------|
| • | ** | *** | 12 | 2 |
| STA. | | | TO STA. | |
| FED. ROAD DIST. NO. | | ILLINOIS FED. AID PROJECT | | |

- VARIOUS
- ** D-7 PAVT PATCHING 2007-2
- *** VARIOUS

GENERAL NOTES

THIS SECTION SHALL BE CONSTRUCTED IN ACCORDANCE WITH THE PLANS, THE "STANDARD SPECIFICATIONS FOR ROAD AND BRIDGE CONSTRUCTION", ADOPTED JANUARY 1, 2007; THE "SUPPLEMENTAL SPECIFICATIONS AND RECURRING SPECIAL PROVISIONS" INDICATED ON THE CHECK SHEET, AND "THE SPECIAL PROVISIONS" INCLUDED IN THE PROPOSAL.

THE WORK INCLUDED IN THIS SECTION CONSISTS OF CLASS A, CLASS B, AND CLASS D FULL DEPTH PAVEMENT PATCHING, AND ANY OTHER WORK NECESSARY TO COMPLETE THIS SECTION.

ALL LONGITUDINAL REINFORCEMENT BARS IN CLASS A PATCHES SHALL BE NO. 6 BARS.

THE ACTUAL LOCATIONS OF PAVEMENT PATCHING AND FINAL QUANTITIES SHALL BE DETERMINED BY THE ENGINEER IN THE FIELD.

ON I-57 NORTH OF EFFINGHAM, 4" CIRCULAR UNDERDRAINS ARE LOCATED APPROXIMATELY 8" BELOW THE SUB-BASE. ANY UNDERDRAINS DAMAGED BY THE CONTRACTOR DURING PATCHING OPERATIONS, WILL BE REPAIRED BY THE CONTRACTOR TO THE SATISFACTION OF THE ENGINEER AND AT THE CONTRACTORS EXPENSE.

THE FOLLOWING MIXTURE REQUIREMENTS ARE APPLICABLE FOR THIS PROJECT:

MIXTURE USE: CLASS D PATCHING
 PG GRADE: PG 64-22
 RAP%: 15%
 DESIGN AIR VOIDS: 4% @ NDESIGN = 70
 MIXTURE COMPOSITION: IL-19.0
 FRICTION AGGREGATE: N/A

INDEX OF SHEETS

| SHEET NO. | TITLE |
|-----------|--|
| 1 | COVER SHEET |
| 2 | GENERAL NOTES, INDEX OF SHEETS & LIST OF STANDARDS |
| 3 | SUMMARY OF QUANTITIES |
| 4-7 | LOCATION DESCRIPTIONS |
| 8-10 | SCHEDULE OF QUANTITIES |
| 11-12 | TRAFFIC CONTROL DETAILS |

THE FOLLOWING STANDARDS ARE A PART OF THESE PLANS AND ARE INCLUDED AFTER SHEET NO. 12:

| STD. NO. | DESCRIPTION |
|-----------|---|
| 000001-04 | STANDARD SYMBOLS, ABBREVIATIONS AND PATTERNS |
| 001001-01 | AREAS OF REINFORCEMENT BARS |
| 001006 | DECIMAL OF AN INCH AND OF A FOOT |
| 420001-06 | PAVEMENT JOINTS |
| 420701-01 | PAVEMENT FABRIC |
| 442001-03 | CLASS A PATCHES |
| 442101-06 | CLASS B PATCHES |
| 442201-02 | CLASS C AND D PATCHES |
| 701101-01 | OFF-RD OPERATIONS, MULTILANE, 15' TO 24" FROM PAVEMENT EDGE |
| 701400-02 | APPROACH TO LANE CLOSURE, FREEWAY/EXPRESSWAY |
| 701401-03 | LANE CLOSURE, FREEWAY/EXPRESSWAY |
| 701411-03 | LANE CLOSURE, MULTILANE, AT ENTRANCE OR EXIT RAMP, FOR SPEEDS >= 45 MPH |
| 701501-03 | URBAN LANE CLOSURE, 2L, 2W, UNDIVIDED |
| 702001-06 | TRAFFIC CONTROL DEVICES |

PLOT DATE = 3/12/2007
 FILE NAME = c:\projects\74198\whscover-74198.dgn
 PLOT SCALE = 50.0000 / IN.
 USER NAME = swhrtr

| REVISIONS | | ILLINOIS DEPARTMENT OF TRANSPORTATION |
|--------------------|------|--|
| NAME | DATE | |
| | | GENERAL NOTES AND INDEX OF SHEETS |
| | | |
| | | |
| | | |
| | | |
| | | |
| | | |
| | | |
| | | |
| | | |
| SCALE: VERT. _____ | | DRAWN BY _____ |
| DATE _____ | | |

| F.A. RTE. | SECTION | COUNTY | TOTAL SHEETS | SHEET NO. |
|---------------------|----------|------------------|--------------|-----------|
| * | ** | *** | 12 | 3 |
| STA. TO STA. | | | | |
| FED. ROAD DIST. NO. | ILLINOIS | FED. AID PROJECT | | |

- * VARIOUS
- ** D-7 PAVT PATCHING 2007-2
- *** VARIOUS

| SUMMARY OF QUANTITIES | | | 100% STATE TOTAL QUANTITIES | CONSTRUCTION TYPE CODE | | |
|-----------------------|--|-------|-----------------------------------|------------------------|-------|-------|
| CODE NO | ITEM | UNIT | | J000 | J000 | I000 |
| | | | | RURAL | URBAN | URBAN |
| 44200549 | CLASS A PATCHES, TYPE I, 10 INCH | SQ YD | 111.8 | 111.8 | | |
| 44200553 | CLASS A PATCHES, TYPE II, 10 INCH | SQ YD | 264.7 | 264.7 | | |
| 44200557 | CLASS A PATCHES, TYPE III, 10 INCH | SQ YD | 56.3 | 56.3 | | |
| 44200559 | CLASS A PATCHES, TYPE IV, 10 INCH | SQ YD | 36.1 | 36.1 | | |
| 44200629 | CLASS A PATCHES, TYPE I, 15 INCH | SQ YD | 70.2 | 70.2 | | |
| 44200630 | CLASS A PATCHES, TYPE II, 15 INCH | SQ YD | 570.6 | 570.6 | | |
| 44200631 | CLASS A PATCHES, TYPE III, 15 INCH | SQ YD | 133.4 | 133.4 | | |
| 44200632 | CLASS A PATCHES, TYPE IV, 15 INCH | SQ YD | 53.4 | 53.4 | | |
| 44200970 | CLASS B PATCHES, TYPE II, 10 INCH | SQ YD | 70 | | 70 | |
| 44201007 | CLASS B PATCHES, TYPE II, 13 INCH | SQ YD | 55.8 | | 55.8 | |
| 44201019 | CLASS B PATCHES, TYPE II, 14 INCH | SQ YD | 629.6 | | 629.6 | |
| 44201023 | CLASS B PATCHES, TYPE III, 14 INCH | SQ YD | 54.7 | | 54.7 | |
| 44201025 | CLASS B PATCHES, TYPE IV, 14 INCH | SQ YD | 26.7 | | 26.7 | |
| 44201031 | CLASS B PATCHES, TYPE II, 15 INCH | SQ YD | 40 | | 40 | |
| 44201043 | CLASS B PATCHES, TYPE II, 16 INCH | SQ YD | 21.4 | 21.4 | | |
| 44201047 | CLASS B PATCHES, TYPE III, 16 INCH | SQ YD | 32 | 16 | 16 | |
| 44201747 | CLASS D PATCHES, TYPE IV, 8 INCH | SQ YD | 166.7 | | | 166.7 |
| 44201789 | CLASS D PATCHES, TYPE II, 12 INCH | SQ YD | 21.4 | | | 21.4 |
| 44201794 | CLASS D PATCHES, TYPE III, 12 INCH | SQ YD | 16 | | | 16 |
| 44213000 | PATCHING REINFORCEMENT | SQ YD | 1296.5 | 1296.5 | | |
| 44213100 | PAVEMENT FABRIC | SQ YD | 113.4 | 16 | 97.4 | |
| 44213200 | SAW CUTS | FOOT | 13731 | 9110 | 4621 | |
| 67100100 | MOBILIZATION | L SUM | 1 | 0.5 | 0.4 | 0.1 |
| 70100205 | TRAFFIC CONTROL AND PROTECTION, STANDARD 701401 | EACH | 17 | 17 | | |
| 70100420 | TRAFFIC CONTROL AND PROTECTION, STANDARD 701411 | EACH | 12 | 11 | 1 | |
| 70101005 | TRAFFIC CONTROL AND PROTECTION, STANDARD 701401 (SPECIAL) | EACH | 1 | | 1 | |
| 70101220 | TRAFFIC CONTROL AND PROTECTION, STANDARD 701411 (SPECIAL) | EACH | 7 | | 7 | |
| 70102620 | TRAFFIC CONTROL AND PROTECTION, STANDARD 701501 | L SUM | 1 | | | 1 |
| Z0002700 | BARRICADES | EACH | 705 | 705 | | |
| Z0017202 | DOWEL BARS 1 1/2" | EACH | 2176 | 160 | 2016 | |
| Z0075310 | TIE BARS 3/4" | EACH | 78 | 78 | | |

| REVISIONS | |
|-----------|------|
| NAME | DATE |
| | |
| | |
| | |
| | |
| | |
| | |
| | |
| | |
| | |
| | |

ILLINOIS DEPARTMENT OF TRANSPORTATION

**SUMMARY
OF
QUANTITIES**

SCALE: VERT. _____
HORIZ. _____

DATE _____ DRAWN BY _____
CHECKED BY _____

| F.A. RTE. | SECTION | COUNTY | TOTAL SHEETS | SHEET NO. |
|---------------------|----------|------------------|--------------|-----------|
| * | ** | *** | 12 | 4 |
| STA. | | TO STA. | | |
| FED. ROAD DIST. NO. | ILLINOIS | FED. AID PROJECT | | |

- * VARIOUS
- ** D-7 PAVT PATCHING 2007-2
- *** VARIOUS

FAYETTE COUNTY

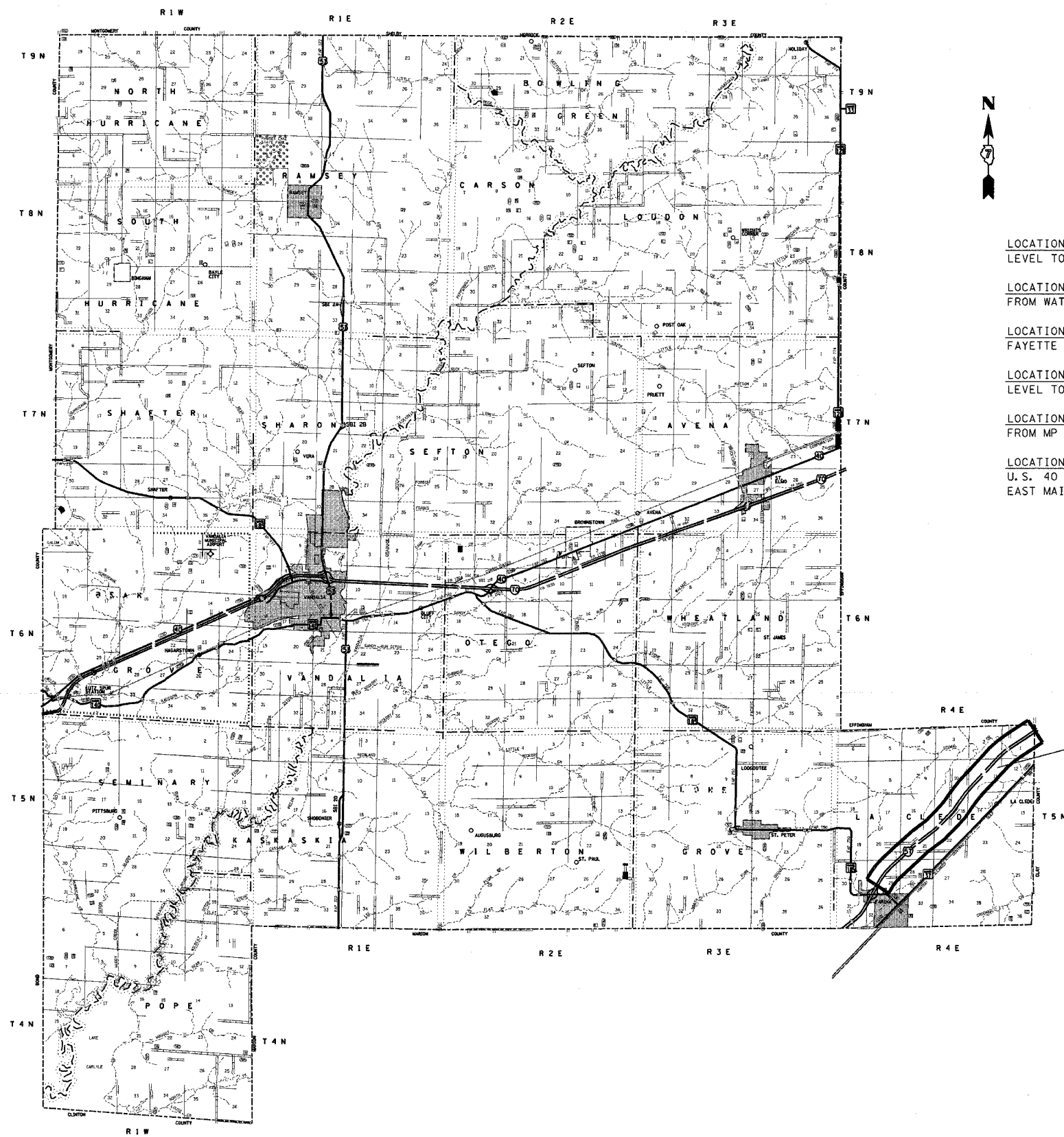

- LOCATION #1: EFFINGHAM COUNTY, I-57 NB & SB, NORTH OR NORTH TRI-LEVEL TO SHELBY COUNTY LINE.
- LOCATION #2: EFFINGHAM COUNTY AND FAYETTE COUNTY, I-57 NB & SB, FROM WATSON/MASON INTERCHANGE TO FARINA INTERCHANGE.
- LOCATION #3: EFFINGHAM COUNTY, I-57/70, RAMPS AT IL 32/33 AND FAYETTE AVENUE INTERCHANGES IN EFFINGHAM.
- LOCATION #4: EFFINGHAM COUNTY, I-57/70 SB/WB, FROM THE NORTH TRI-LEVEL TO THE U.S. 45 BRIDGE.
- LOCATION #5: CUMBERLAND COUNTY AND CLARK COUNTY, I-70 EB & WB, FROM MP 106 TO THE CASEY INTERCHANGE.
- LOCATION #6: CLARK COUNTY, IL 49 IN CASEY, FROM 1000 FT NORTH OF U.S. 40 TO EAST MAIN STREET. PATCH #4 IS JUST NORTH OF THE IL 49 AND EAST MAIN STREET INTERSECTION.

LOCATION #2

PLOT DATE = 3/12/2007
 PLOT TIME = 11:54:11 AM
 PLOT SCALE = 50,000.00 / IN.
 USER NAME = sner-tcr

| REVISIONS | |
|-----------|------|
| NAME | DATE |
| | |
| | |
| | |
| | |
| | |
| | |
| | |
| | |
| | |
| | |

ILLINOIS DEPARTMENT OF TRANSPORTATION

LOCATION MAPS

SCALE: VERT. _____
 HORIZ. _____

DATE _____ DRAWN BY _____
 CHECKED BY _____

| F.A. RTE. | SECTION | COUNTY | TOTAL SHEETS | SHEET NO. |
|---------------------|---------|---------------------------|--------------|-----------|
| * | ** | *** | 12 | 5 |
| STA. | | TO STA. | | |
| FED. ROAD DIST. NO. | | ILLINOIS FED. AID PROJECT | | |

- * VARIOUS
- ** D-7 PAVT PATCHING 2007-2
- *** VARIOUS

EFFINGHAM COUNTY

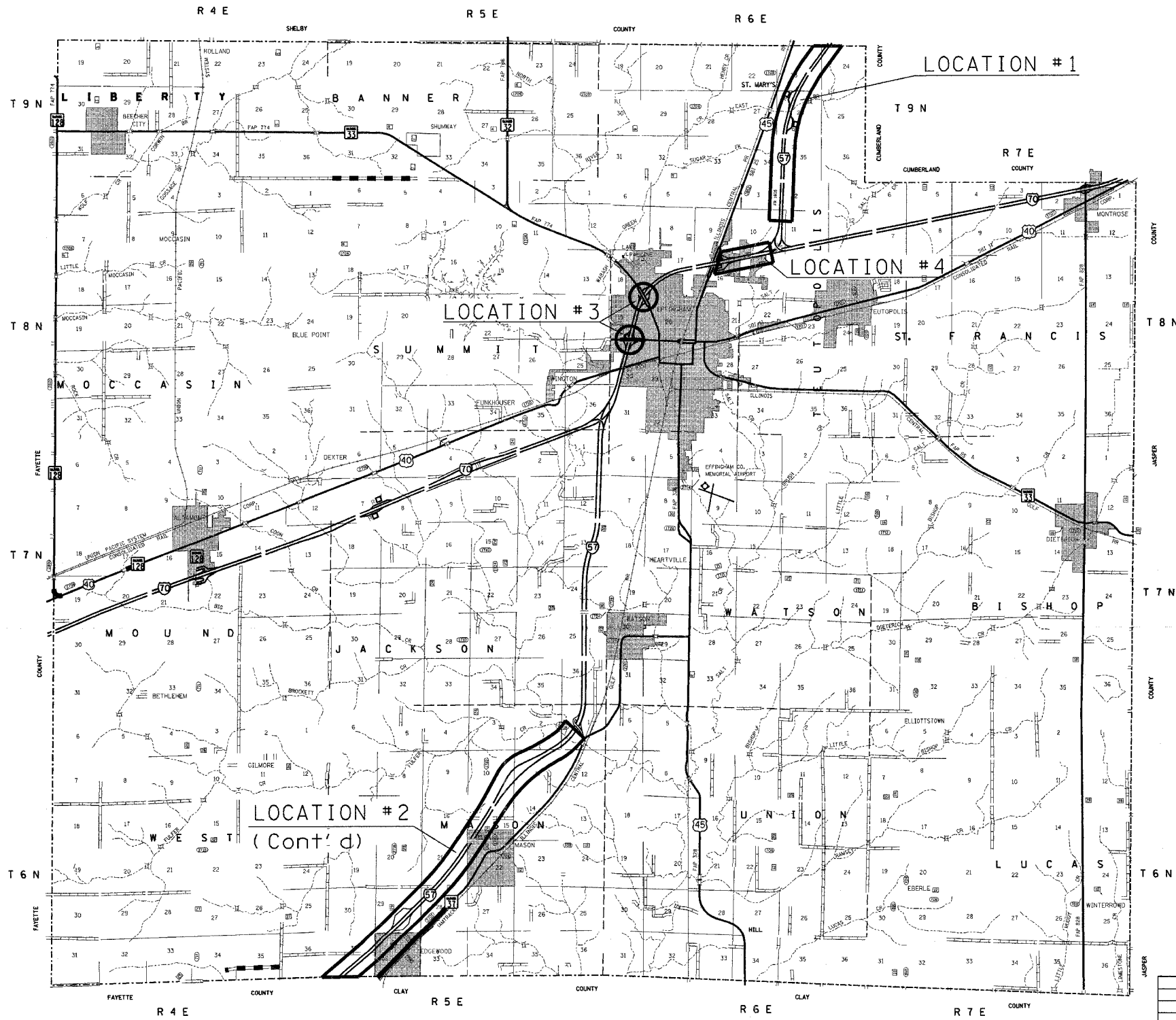

| REVISIONS | |
|-----------|------|
| NAME | DATE |
| | |
| | |
| | |
| | |
| | |
| | |
| | |
| | |
| | |
| | |

ILLINOIS DEPARTMENT OF TRANSPORTATION

LOCATION MAPS

SCALE: VERT. HORIZ.
DATE

DRAWN BY
CHECKED BY

PLOT DATE = 3/12/2007
 PLOT SCALE = 500.0000 / IN.
 USER NAME = swr1274

| F.A. RTE. | SECTION | COUNTY | TOTAL SHEETS | SHEET NO. |
|-----------|---------|--------|--------------|-----------|
| • | •• | ••• | 12 | 6 |

STA. TO STA.
 FED. ROAD DIST. NO. ILLINOIS FED. AID PROJECT

- VARIOUS
- D-7 PAVT PATCHING 2007-2
- VARIOUS

CUMBERLAND COUNTY

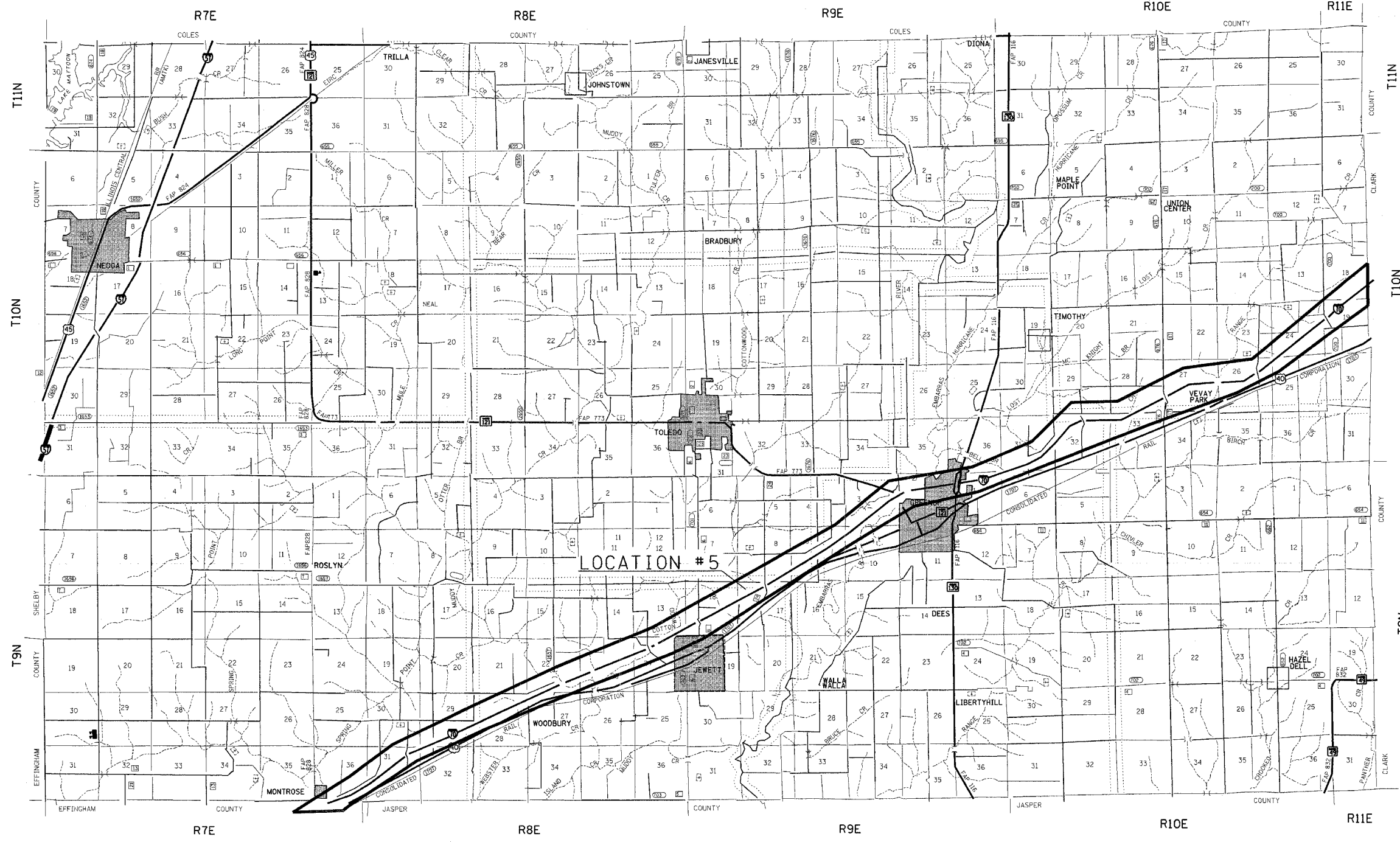

PLOT DATE = 3/12/2007
 FILE NAME = c:\arcgis\mxd\74198a\lctover-74198.dgn
 PLOT SCALE = 50,000 / IN.
 USER NAME = swh-tzr

| REVISIONS | |
|-----------|------|
| NAME | DATE |
| | |
| | |
| | |
| | |
| | |
| | |
| | |
| | |
| | |
| | |

ILLINOIS DEPARTMENT OF TRANSPORTATION

LOCATION MAPS

SCALE: VERT. _____
 HORIZ. _____
 DATE _____

DRAWN BY _____
 CHECKED BY _____

| F.A. RTE. | SECTION | COUNTY | TOTAL SHEETS | SHEET NO. |
|---------------------|---------|---------------------------|--------------|-----------|
| * | ** | *** | 12 | 7 |
| STA. | | TO STA. | | |
| FED. ROAD DIST. NO. | | ILLINOIS FED. AID PROJECT | | |

- * VARIOUS
- ** D-7 PAVT PATCHING 2007-2
- *** VARIOUS

CLARK COUNTY

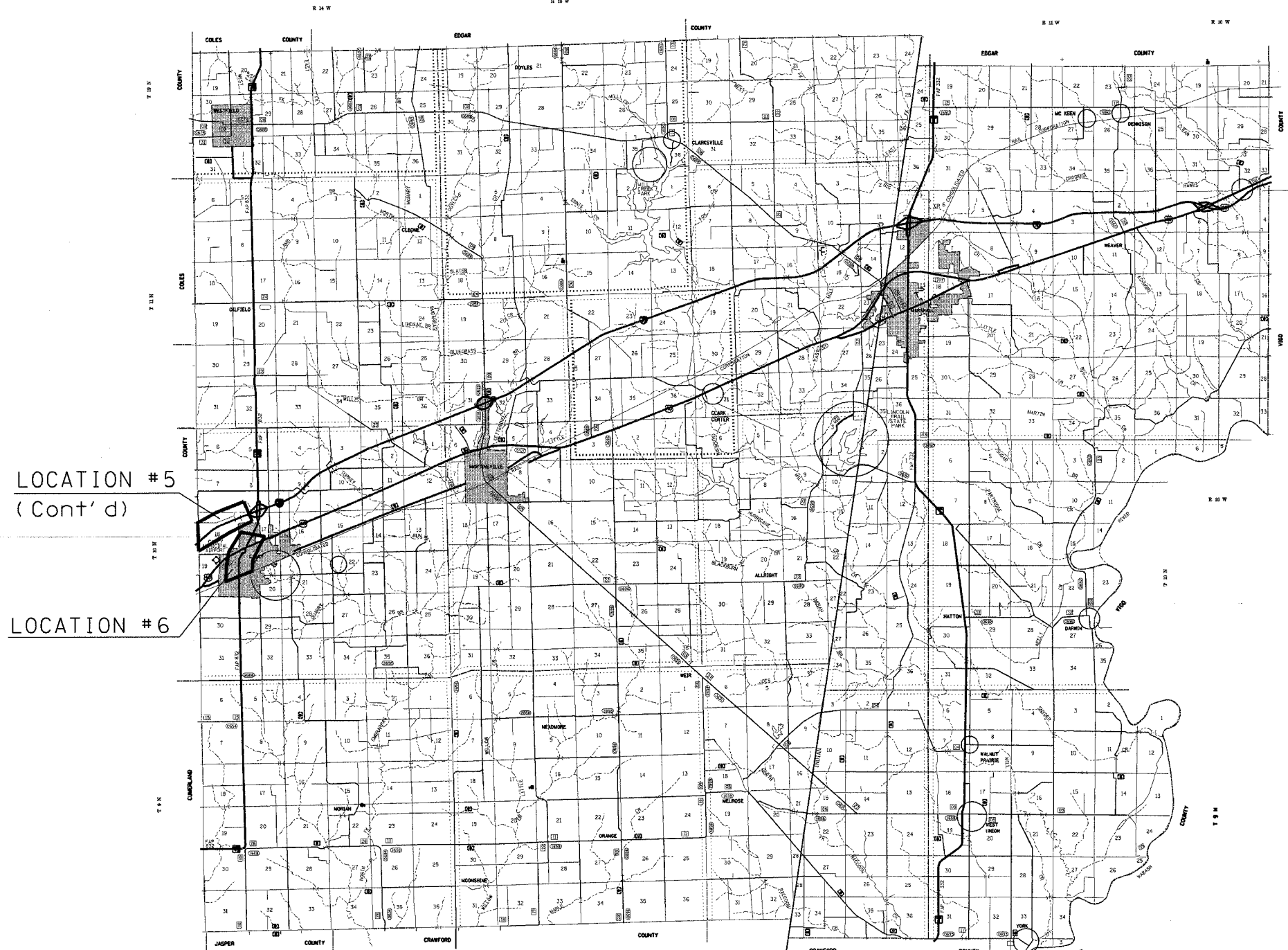

LOCATION #5
(Cont'd)

LOCATION #6

| REVISIONS | |
|-----------|------|
| NAME | DATE |
| | |
| | |
| | |
| | |
| | |
| | |
| | |
| | |
| | |
| | |

ILLINOIS DEPARTMENT OF TRANSPORTATION

LOCATION MAPS

SCALE: VERT.
HORIZ.
DATE

DRAWN BY
CHECKED BY

PLOT DATE = 9/12/2007
FILE NAME = c:\pvc\mca\74198\74198.dgn
PLOT SCALE = 0.00000 / IN.
USER NAME = swartzm

| F.A. RTE. | SECTION | COUNTY | TOTAL SHEETS | SHEET NO. |
|---------------------|---------|---------------------------|--------------|-----------|
| * | ** | *** | 12 | 9 |
| STA. | | TO STA. | | |
| FED. ROAD DIST. NO. | | ILLINOIS FED. AID PROJECT | | |

- * VARIOUS
- ** D-7 PAVT PATCHING 2007-2
- *** VARIOUS

| Location #3 Class B Patching, 14", Urban | | | | | | | | | | | | |
|---|-------|-------------|------------|------------|--------------|--------------|--------------|--------------|--------------|----------------|--------------|-------------|
| Lane | Sta | Length Feet | Width Feet | Patch Area | Type 1 Sq Yd | Type 2 Sq Yd | Type 3 Sq Yd | Type 4 Sq Yd | TieBars Each | Pavt Fab Sq Yd | Saw Cut Feet | Dowels Each |
| I 57/70 SB/WB Fayette Ave Off Ramp | | | | | | | | | | | | |
| | 13+86 | 6 | 14 | 9.3 | | 9.3 | | | | | 54 | 24 |
| | 13+01 | 6 | 14 | 9.3 | | 9.3 | | | | | 54 | 24 |
| | 12+35 | 6 | 14 | 9.3 | | 9.3 | | | | | 54 | 24 |
| | 11+96 | 6 | 14 | 9.3 | | 9.3 | | | | | 54 | 24 |
| | 11+39 | 6 | 14 | 9.3 | | 9.3 | | | | | 54 | 24 |
| | 10+86 | 6 | 14 | 9.3 | | 9.3 | | | | | 54 | 24 |
| | 10+39 | 6 | 14 | 9.3 | | 9.3 | | | | | 54 | 24 |
| | 9+39 | 6 | 14 | 9.3 | | 9.3 | | | | | 54 | 24 |
| | 7+38 | 6 | 14 | 9.3 | | 9.3 | | | | | 54 | 24 |
| | 5+31 | 6 | 14 | 9.3 | | 9.3 | | | | | 54 | 24 |
| | 3+23 | 6 | 14 | 9.3 | | 9.3 | | | | | 54 | 24 |
| | 2+17 | 6 | 14 | 9.3 | | 9.3 | | | | | 54 | 24 |
| | 1+58 | 6 | 14 | 9.3 | | 9.3 | | | | | 54 | 24 |
| I 57/70 NB/EB Fayette On Ramp | | | | | | | | | | | | |
| | 0+00 | 6 | 14 | 9.3 | | 9.3 | | | | | 54 | 24 |
| | 2+08 | 6 | 14 | 9.3 | | 9.3 | | | | | 54 | 24 |
| | 3+06 | 10 | 14 | 15.6 | | | 15.6 | | | 15.6 | 62 | 24 |
| | 4+14 | 6 | 14 | 9.3 | | 9.3 | | | | | 54 | 24 |
| | 6+00 | 6 | 14 | 9.3 | | 9.3 | | | | | 54 | 24 |
| | 6+95 | 6 | 14 | 9.3 | | 9.3 | | | | | 54 | 24 |
| | 8+50 | 6 | 14 | 9.3 | | 9.3 | | | | | 54 | 24 |
| | 9+76 | 6 | 14 | 9.3 | | 9.3 | | | | | 54 | 24 |
| | 10+97 | 8 | 14 | 12.4 | | 12.4 | | | | | 58 | 24 |
| | | | | | | | | | | | 0 | 0 |
| | | | | | | | | | | | 0 | 0 |
| On Ramp from EB Fayette Ave to I 57/70 NB/EB Fayette On Ramp | | | | | | | | | | | | |
| | 6 | 14 | 9.3 | | | 9.3 | | | | | 54 | 24 |
| | 12 | 16 | 21.3 | | | | 21.3 | | | 21.3 | 72 | 28 |
| | 15 | 16 | 26.7 | | | | | 26.7 | | 26.7 | 78 | 28 |
| | ** | 6 | 14 | 9.3 | | 9.3 | | | | | 48 | 24 |
| ** This patch is adjacent to the patch at Sta. 4+14 for the I 57/70 NB/EB Fayette On Ramp | | | | | | | | | | | | |
| I 57/70 SB/WB On Ramp from WB Fayette Ave | | | | | | | | | | | | |
| | 0+00 | 6 | 16 | 10.7 | | 10.7 | | | | | 60 | 28 |
| | 1+86 | 6 | 16 | 10.7 | | 10.7 | | | | | 60 | 28 |
| | 2+48 | 6 | 16 | 10.7 | | 10.7 | | | | | 60 | 28 |
| | 2+79 | 6 | 16 | 10.7 | | 10.7 | | | | | 60 | 28 |
| | 3+34 | 6 | 16 | 10.7 | | 10.7 | | | | | 60 | 28 |
| | 4+68 | 6 | 16 | 10.7 | | 10.7 | | | | | 60 | 28 |
| | 6+58 | 6 | 16 | 10.7 | | 10.7 | | | | | 60 | 28 |
| | 9+44 | 6 | 16 | 10.7 | | 10.7 | | | | | 60 | 28 |
| | 12+14 | 6 | 16 | 10.7 | | 10.7 | | | | | 60 | 28 |
| | 13+28 | 10 | 16 | 17.8 | | | 17.8 | | | 17.8 | 68 | 28 |
| | 15+50 | 8 | 16 | 14.2 | | 14.2 | | | | | 64 | 28 |
| | 18+53 | 6 | 16 | 10.7 | | 10.7 | | | | | 60 | 28 |
| I 57/70 SB/WB On Ramp from EB Fayette Ave | | | | | | | | | | | | |
| | -0+60 | 6 | 14 | 9.3 | | 9.3 | | | | | 54 | 24 |
| | -0+07 | 6 | 14 | 9.3 | | 9.3 | | | | | 54 | 24 |
| | 1+98 | 6 | 14 | 9.3 | | 9.3 | | | | | 54 | 24 |
| | 2+46 | 6 | 14 | 9.3 | | 9.3 | | | | | 54 | 24 |
| | 3+44 | 6 | 14 | 9.3 | | 9.3 | | | | | 54 | 24 |
| | 4+42 | 6 | 14 | 9.3 | | 9.3 | | | | | 54 | 24 |
| | 5+39 | 6 | 14 | 9.3 | | 9.3 | | | | | 54 | 24 |
| | 6+37 | 6 | 14 | 9.3 | | 9.3 | | | | | 54 | 24 |
| | 7+37 | 6 | 14 | 9.3 | | 9.3 | | | | | 54 | 24 |
| | 8+26 | 8 | 14 | 12.4 | | 12.4 | | | | | 58 | 24 |
| | 9+24 | 6 | 14 | 9.3 | | 9.3 | | | | | 54 | 24 |
| | 16+87 | 6 | 14 | 9.3 | | 9.3 | | | | | 54 | 24 |

| Location #3 (Cont'd) Class B Patching, 14", Urban | | | | | | | | | | | | |
|---|-------|-------------|------------|------------|--------------|--------------|--------------|--------------|---------------|----------------|--------------|-------------|
| Lane | Sta | Length Feet | Width Feet | Patch Area | Type 1 Sq Yd | Type 2 Sq Yd | Type 3 Sq Yd | Type 4 Sq Yd | TieBars Each | Pavt Fab Sq Yd | Saw Cut Feet | Dowels Each |
| I 57/70 NB/EB Fayette Off Ramp | | | | | | | | | | | | |
| | -1+32 | 6 | 14 | 9.3 | | 9.3 | | | | | 54 | 24 |
| | -1+09 | 6 | 14 | 9.3 | | 9.3 | | | | | 54 | 24 |
| | 0+00 | 6 | 14 | 9.3 | | 9.3 | | | | | 54 | 24 |
| | 1+02 | 6 | 14 | 9.3 | | 9.3 | | | | | 54 | 24 |
| | 1+53 | 6 | 14 | 9.3 | | 9.3 | | | | | 54 | 24 |
| | 2+51 | 6 | 14 | 9.3 | | 9.3 | | | | | 54 | 24 |
| | 3+51 | 6 | 14 | 9.3 | | 9.3 | | | | | 54 | 24 |
| | 6+53 | 6 | 14 | 9.3 | | 9.3 | | | | | 54 | 24 |
| | 8+41 | 6 | 14 | 9.3 | | 9.3 | | | | | 54 | 24 |
| | 8+99 | 6 | 14 | 9.3 | | 9.3 | | | | | 54 | 24 |
| | 10+00 | 6 | 14 | 9.3 | | 9.3 | | | | | 54 | 24 |
| | 14+59 | 6 | 14 | 9.3 | | 9.3 | | | | | 54 | 24 |
| | 15+89 | 6 | 14 | 9.3 | | 9.3 | | | | | 54 | 24 |
| | 16+52 | 6 | 14 | 9.3 | | 9.3 | | | | | 54 | 24 |
| | 16+95 | 6 | 14 | 9.3 | | 9.3 | | | | | 54 | 24 |
| Ramp to WB Fayette Ave. from I 57/70 NB/EB Fayette Off Ramp | | | | | | | | | | | | |
| | 0+00 | 6 | 14 | 9.3 | | 9.3 | | | | | 54 | 24 |
| | 0+53 | 6 | 14 | 9.3 | | 9.3 | | | | | 54 | 24 |
| | 2+07 | 6 | 14 | 9.3 | | 9.3 | | | | | 54 | 24 |
| | 2+56 | 6 | 14 | 9.3 | | 9.3 | | | | | 54 | 24 |
| | | | | Totals | 711 | 0 | 629.6 | 54.7 | 26.7 | 0 | 81.4 | 1712 |
| Class B Patching, 13" | | | | | | | | | | | | |
| Lane | Sta | Length Feet | Width Feet | Patch Area | Type 1 Sq Yd | Type 2 Sq Yd | Type 3 Sq Yd | Type 4 Sq Yd | Tie Bars Each | Pavt Fab Sq Yd | Saw Cut Feet | Dowels Each |
| I 57/70 SB/WB Keller Dr Off Ramp | | | | | | | | | | | | |
| | 11+00 | 6 | 14 | 9.3 | | 9.3 | | | | | 54 | 24 |
| | 10+00 | 6 | 14 | 9.3 | | 9.3 | | | | | 54 | 24 |
| | 9+02 | 6 | 14 | 9.3 | | 9.3 | | | | | 54 | 24 |
| | 8+00 | 6 | 14 | 9.3 | | 9.3 | | | | | 54 | 24 |
| | 7+35 | 6 | 14 | 9.3 | | 9.3 | | | | | 54 | 24 |
| | 7+00 | 6 | 14 | 9.3 | | 9.3 | | | | | 54 | 24 |
| | | | | Totals | 55.8 | 0 | 55.8 | 0 | 0 | 0 | 324 | 144 |
| Class B Patching, 10" | | | | | | | | | | | | |
| Lane | Sta | Length Feet | Width Feet | Patch Area | Type 1 Sq Yd | Type 2 Sq Yd | Type 3 Sq Yd | Type 4 Sq Yd | Tie Bars Each | Pavt Fab Sq Yd | Saw Cut Feet | Dowels Each |
| I 57/70 SB/WB Evergreen Ave to Keller Dr On Ramp | | | | | | | | | | | | |
| | 0+00 | 6 | 21 | 14 | | 14 | | | | | 75 | 28 |
| | 1+35 | 6 | 21 | 14 | | 14 | | | | | 75 | 28 |
| | 1+78 | 6 | 21 | 14 | | 14 | | | | | 75 | 28 |
| | 3+25 | 6 | 21 | 14 | | 14 | | | | | 75 | 28 |
| | 3+48 | 6 | 21 | 14 | | 14 | | | | | 75 | 28 |
| | | | | Totals | 70 | 0 | 70 | 0 | 0 | 0 | 375 | 140 |

PLOT DATE = 8/12/2007
 FILE NAME = c:\projects\74198\sheet\74198.dgn
 PLOT SCALE = 50.0000 / IN.
 USER NAME = swe-tzrv

| REVISIONS | | ILLINOIS DEPARTMENT OF TRANSPORTATION |
|--------------------|------|---------------------------------------|
| NAME | DATE | |
| | | |
| | | |
| | | |
| | | |
| | | |
| | | |
| | | |
| | | |
| SCALE: VERT. _____ | | DRAWN BY _____ |
| DATE: _____ | | |

SCHEDULE OF QUANTITIES

| | | | | |
|---------------------|---------|--------|---------------------------|-----------|
| F.A. RTE. | SECTION | COUNTY | TOTAL SHEETS | SHEET NO. |
| * | ** | *** | 12 | 10 |
| STA. TO STA. | | | | |
| FED. ROAD DIST. NO. | | | ILLINOIS FED. AID PROJECT | |

- * VARIOUS
- ** D-7 PAVT PATCHING 2007-2
- *** VARIOUS

Location #4; Class B Patches, 16"

| Lane | Station | Length Feet | Width Feet | Patch Area | Type 1 Sq Yd | Type 2 Sq Yd | Type 3 Sq Yd | Type 4 Sq Yd | Tie Bars Each | Pavt Fab Sq Yd | Saw Cut Feet | Dowels Each |
|---------------|---------|-------------|------------|------------|--------------|--------------|--------------|--------------|---------------|----------------|--------------|-------------|
| WBDL | 2369+62 | 8 | 12 | 10.7 | | 10.7 | | | | | 52 | 20 |
| WBDL | 2369+48 | 12 | 12 | 16 | | | 16 | | | 16 | 60 | 20 |
| WBDL | 2368+83 | 8 | 12 | 10.7 | | 10.7 | | | | | 52 | 20 |
| WBPL | 2295+92 | 12 | 12 | 16 | | | 16 | | | 16 | 60 | 20 |
| Totals | | | | | 0 | 21.4 | 32 | 0 | 0 | 32 | 224 | 80 |

Location #5; I-70WB Cumberland/Clark Co.

| Patch Number | | Lane | Sta | CLASS A PATCHES, 15 INCH | | | | Patching Reinf (SQ YD) | Saw Cut (FT) | Barricade (EA) | | |
|-----------------|---------|------|-----|--------------------------|------------|----------------|----------------|------------------------|----------------|----------------|-------|------|
| | | | | Leng (FT) | Width (FT) | Type 1 (SQ YD) | Type 2 (SQ YD) | Type 3 (SQ YD) | Type 4 (SQ YD) | Tie Bars (EA) | | |
| WBDL | 128.995 | | | 5 | 12 | | 6.7 | | | 6.7 | 59.5 | |
| WBDL | 128.733 | | | 5 | 6 | 3.3 | | | | 3.3 | 35.5 | |
| WBPL | 128.158 | | | 8 | 12 | | 10.7 | | | 10.7 | 57.5 | 0 |
| WBDL | 128.158 | | | 8 | 12 | | 10.7 | | | 10.7 | 65.5 | 12 |
| WBDL | 128.118 | | | 5 | 12 | | 6.7 | | | 6.7 | 59.5 | |
| WBDL | 127.964 | | | 5 | 12 | | 6.7 | | | 6.7 | 59.5 | |
| WBDL | 127.601 | | | 5 | 12 | | 6.7 | | | 6.7 | 59.5 | |
| WBDL | 127.183 | | | 5 | 6 | 3.3 | | | | 3.3 | 35.5 | 6 |
| WBDL | 127.181 | | | 5 | 6 | 3.3 | | | | 3.3 | 35.5 | |
| WBDL | 127.057 | | | 5 | 6 | 3.3 | | | | 3.3 | 35.5 | |
| WBDL | 126.98 | | | 8 | 12 | | 10.7 | | | 10.7 | 65.5 | |
| WBPL | 126.75 | | | 8 | 12 | | 10.7 | | | 10.7 | 57.5 | 42 |
| WBDL | 126.75 | | | 8 | 12 | | 10.7 | | | 10.7 | 65.5 | |
| WBPL | 126.476 | | | 8 | 12 | | 10.7 | | | 10.7 | 57.5 | |
| WBDL | 126.476 | | | 5 | 12 | | 6.7 | | | 6.7 | 59.5 | |
| WBPL | 126.308 | | | 5 | 12 | | 6.7 | | | 6.7 | 54.5 | |
| WBDL | 126.308 | | | 5 | 12 | | 6.7 | | | 6.7 | 59.5 | |
| WBPL | 126.056 | | | 5 | 12 | | 6.7 | | | 6.7 | 59.5 | |
| WBPL | 125.762 | | | 10 | 12 | | 13.3 | | | 13.3 | 59.5 | 2 |
| WBDL | 125.762 | | | 12 | 12 | | | 16 | | 16 | 73.5 | 10 |
| WBPL | 123.396 | | | 20 | 12 | | | | 26.7 | 9 | 26.7 | 89.5 |
| WBPL | 121.77 | | | 8 | 12 | | 10.7 | | | 10.7 | 65.5 | 51 |
| WBDL | 119.087 | | | 5 | 12 | | 6.7 | | | 6.7 | 59.5 | |
| WBDL | 119.025 | | | 12 | 12 | | | 16 | | 16 | 73.5 | |
| WBDL | 119.005 | | | 25 | 6 | | | 16.7 | | 12 | 16.7 | 75.5 |
| WBDL | 116.532 | | | 5 | 12 | | 6.7 | | | 6.7 | 59.5 | |
| WBDL | 114.885 | | | 8 | 12 | | 10.7 | | | 10.7 | 65.5 | 51 |
| WBDL | 109.366 | | | 10 | 12 | | 13.3 | | | 13.3 | 69.5 | |
| TOTALS = | | | | 13.2 | 179.2 | 48.7 | 26.7 | 21.0 | 267.8 | 1673.0 | 178.0 | |

Location #5; I-70EB, Cumberland/Clark County

| Patch Number | Lane | Sta | CLASS A PATCHES, 15 INCH | | | | Patching Reinf (SQ YD) | Saw Cut (FT) | Barricades (EA) | | |
|-----------------|---------|-----|--------------------------|------------|----------------|----------------|------------------------|----------------|-----------------|-------|------|
| | | | Leng (FT) | Width (FT) | Type 1 (SQ YD) | Type 2 (SQ YD) | Type 3 (SQ YD) | Type 4 (SQ YD) | Tie Bars (EA) | | |
| EBDL | 107.475 | | 5 | 6 | 3.3 | | | | 3.3 | 35.5 | |
| EBDL | 107.493 | | 5 | 6 | 3.3 | | | | 3.3 | 35.5 | |
| EBDL | 107.501 | | 10 | 12 | | 13.3 | | | 13.3 | 69.5 | |
| EBDL | 107.521 | | 10 | 6 | | 6.7 | | | 6.7 | 45.5 | |
| EBPL | 113.485 | | 8 | 12 | | 10.7 | | | 10.7 | 57.5 | |
| EBDL | 113.486 | | 12 | 12 | | | 16 | | 16 | 73.5 | |
| EBDL | 113.498 | | 40 | 6 | | | 26.7 | 19 | 26.7 | 105.5 | |
| EBPL | 113.518 | | 5 | 6 | 3.3 | | | | 3.3 | 35.5 | |
| EBDL | 114.926 | | 8 | 12 | | 10.7 | | | 10.7 | 65.5 | 44.0 |
| EBDL | 117.066 | | 5 | 6 | 3.3 | | | | 3.3 | 35.5 | |
| EBDL | 117.068 | | 5 | 6 | 3.3 | | | | 3.3 | 35.5 | |
| EBDL | 117.07 | | 8 | 6 | | 5.3 | | | 5.3 | 41.5 | |
| EBDL | 117.074 | | 5 | 6 | 3.3 | | | | 3.3 | 35.5 | |
| EBPL | 117.097 | | 5 | 12 | | 6.7 | | | 6.7 | 54.5 | |
| EBDL | 117.097 | | 8 | 12 | | 10.7 | | | 10.7 | 65.5 | |
| EBPL | 117.257 | | 5 | 12 | | 6.7 | | | 6.7 | 54.5 | |
| EBDL | 117.257 | | 5 | 12 | | 6.7 | | | 6.7 | 59.5 | |
| EBPL | 117.511 | | 5 | 12 | | 6.7 | | | 6.7 | 54.5 | |
| EBDL | 117.511 | | 5 | 12 | | 6.7 | | | 6.7 | 59.5 | |
| EBPL | 117.69 | | 5 | 12 | | 6.7 | | | 6.7 | 59.5 | |
| EBDL | 117.69 | | 5 | 12 | | 6.7 | | | 6.7 | 59.5 | |
| EBDL | 117.812 | | 5 | 12 | | 6.7 | | | 6.7 | 59.5 | |
| EBDL | 117.821 | | 5 | 6 | 3.3 | | | | 3.3 | 35.5 | |
| EBPL | 117.832 | | 5 | 12 | | 6.7 | | | 6.7 | 54.5 | |
| EBDL | 117.832 | | 5 | 12 | | 6.7 | | | 6.7 | 59.5 | |
| EBDL | 117.952 | | 5 | 6 | 3.3 | | | | 3.3 | 35.5 | |
| EBDL | 117.959 | | 5 | 6 | 3.3 | | | | 3.3 | 35.5 | |
| EBDL | 117.967 | | 5 | 6 | 3.3 | | | | 3.3 | 35.5 | |
| EBDL | 117.981 | | 8 | 12 | | 10.7 | | | 10.7 | 65.5 | |
| EBDL | 118.018 | | 8 | 6 | | 5.3 | | | 5.3 | 41.5 | |
| EBPL | 118.186 | | 5 | 12 | | 6.7 | | | 6.7 | 59.5 | 3.0 |
| EBPL | 118.377 | | 5 | 12 | | 6.7 | | | 6.7 | 59.5 | |
| EBDL | 118.384 | | 8 | 12 | | 10.7 | | | 10.7 | 65.5 | 4.0 |
| EBDL | 119.659 | | 5 | 12 | | 6.7 | | | 6.7 | 59.5 | 38.0 |
| EBDL | 119.662 | | 12 | 6 | | 8 | | | 8 | 49.5 | |
| EBDL | 119.678 | | 5 | 12 | | 6.7 | | | 6.7 | 59.5 | |
| EBDL | 119.708 | | 10 | 12 | | 13.3 | | | 13.3 | 69.5 | |
| EBPL | 119.708 | | 5 | 12 | | 6.7 | | | 6.7 | 54.5 | 40.0 |
| EBPL | 119.911 | | 5 | 12 | | 6.7 | | | 6.7 | 54.5 | |
| EBDL | 119.911 | | 5 | 12 | | 6.7 | | | 6.7 | 59.5 | |
| EBDL | 121.271 | | 30 | 6 | | | 20 | 14 | 20 | 85.5 | 41.0 |
| EBDL | 121.306 | | 5 | 12 | | 6.7 | | | 6.7 | 59.5 | |
| EBDL | 121.309 | | 12 | 6 | | 8 | | | 8 | 49.5 | |
| EBPL | 125.207 | | 6 | 6 | 4 | | | | 4 | 37.5 | |
| EBPL | 125.211 | | 6 | 6 | 4 | | | | 4 | 37.5 | |
| EBDL | 125.226 | | 25 | 6 | | | 16.7 | 12 | 16.7 | 75.5 | |
| EBDL | 128.278 | | 12 | 6 | | 8 | | | 8 | 49.5 | |
| EBDL | 128.617 | | 5 | 12 | | 6.7 | | | 6.7 | 59.5 | 3.0 |
| TOTALS = | | | 41.0 | 248.7 | 52.7 | 26.7 | 45.0 | 369.1 | 2606.0 | 173.0 | |

Location 6; IL 49 In Casey

| Patch Number | | Lane | Sta | CLASS D PATCHES, 12 INCH | | | | Patching Reinf (SQ YD) | Saw Cut (FT) | | |
|-----------------|----|------|-----------|--------------------------|----------------|----------------|----------------|------------------------|---------------|------|-----|
| | | | Leng (FT) | Width (FT) | Type 1 (SQ YD) | Type 2 (SQ YD) | Type 3 (SQ YD) | Type 4 (SQ YD) | Tie Bars (EA) | | |
| 1 | NB | | 176+75 | 8 | 12 | | 10.7 | | | | |
| 2 | SB | | 176+75 | 12.0 | 12.0 | | | 16.0 | | | |
| 3 | SB | | 181+24 | 8.0 | 12.0 | | 10.7 | | | | |
| TOTALS = | | | | 0.0 | 21.4 | 16.0 | 0.0 | 0.0 | 0.0 | 0.0 | 0.0 |
| Patch Number | | Lane | Sta | CLASS D PATCHES, 8 INCH | | | | Patching Reinf (SQ YD) | Saw Cut (FT) | | |
| | | | Leng (FT) | Width (FT) | Type 1 (SQ YD) | Type 2 (SQ YD) | Type 3 (SQ YD) | Type 4 (SQ YD) | Tie Bars (EA) | | |
| 4 | SB | | 131+00 | 90.0 | 6.0 | | | | | 60.0 | |
| | SB | | 131+90 | 30.0 | 12.0 | | | | | 40.0 | |
| | SB | | 132+20 | 100.0 | 6.0 | | | | | 66.7 | |
| TOTALS = | | | | 0.0 | 0.0 | 0.0 | 166.7 | 0.0 | 0.0 | 0.0 | 0.0 |

| REVISIONS | |
|-----------|------|
| NAME | DATE |
| | |
| | |
| | |
| | |
| | |
| | |
| | |
| | |
| | |
| | |
| | |
| | |
| | |
| | |
| | |
| | |
| | |
| | |

ILLINOIS DEPARTMENT OF TRANSPORTATION
SCHEDULE OF QUANTITIES
 SCALE: VERT. / HORIZ.
 DATE: / / DRAWN BY: / CHECKED BY: /

| | | | | |
|---------------------|---------|---------------------------|--------------|-----------|
| F.A. RTE. | SECTION | COUNTY | TOTAL SHEETS | SHEET NO. |
| • | •• | ••• | 12 | 11 |
| STA. | | TO STA. | | |
| FED. ROAD DIST. NO. | | ILLINOIS FED. AID PROJECT | | |

- VARIOUS
- D-7 PAVT PATCHING 2007-2
- VARIOUS

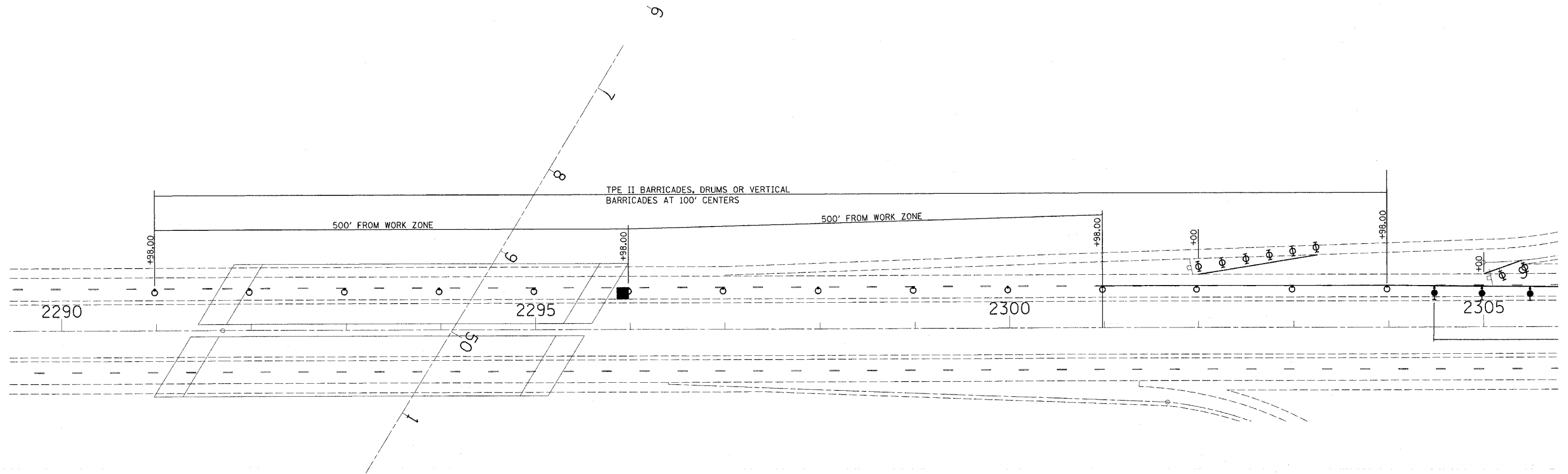

LEGEND

- CHANGABLE MESSAGE BOARD
- TYPE III BARRICADE W/ ROAD CLOSED SIGN
- SIGN
- DIRECTION INDICATOR BARRICADE WITH STEADY BURN MONODIRECTIONAL LIGHT
- DRUM, TYPE II BARRICADE, OR VERTICAL BARRICADE WITH STEADY BURN MONODIRECTIONAL LIGHT
- TYPE II BARRICADES
- ARROW BOARD

At Location #4, it is the intent of the designer to channelize traffic from the U.S. 45 On Ramp into the I-57/70 SB/WB driving lane a minimum of 500 ft before the work area. Therefore, Traffic Control and Protection, Standard 701411 shall be put in place as per the Highway Standard 701411-03, Application No. 1 at the location shown in the detail. This work shall be paid for at the contract unit price per EACH for TRAFFIC CONTROL AND PROTECTION, STANDARD 701411.







| REVISIONS | | ILLINOIS DEPARTMENT OF TRANSPORTATION |
|--------------------|------|--|
| NAME | DATE | |
| | | TRAFFIC CONTROL DETAIL STANDARD 701401 (SPECIAL) |
| | | |
| | | |
| | | |
| | | |
| | | |
| | | |
| | | |
| | | |
| | | |
| SCALE: VERT. _____ | | DRAWN BY _____ |
| HORIZ. _____ | | |
| DATE _____ | | CHECKED BY _____ |

| F.A. RTE. | SECTION | COUNTY | TOTAL SHEETS | SHEET NO. |
|---------------------|---------|---------------------------|--------------|-----------|
| • | •• | ••• | 12 | 12 |
| STA. | | TO STA. | | |
| FED. ROAD DIST. NO. | | ILLINOIS FED. AID PROJECT | | |

- VARIOUS
- D-7 PAVT PATCHING 2007-2
- VARIOUS



LEGEND

-  CHANGABLE MESSAGE BOARD
-  TYPE III BARRICADE W/ ROAD CLOSED SIGN
-  SIGN
-  DIRECTION INDICATOR BARRICADE WITH STEADY BURN MONODIRECTIONAL LIGHT
-  DRUM, TYPE II BARRICADE, OR VERTICAL BARRICADE WITH STEADY BURN MONODIRECTIONAL LIGHT
-  TYPE II BARRICADES
-  ARROW BOARD

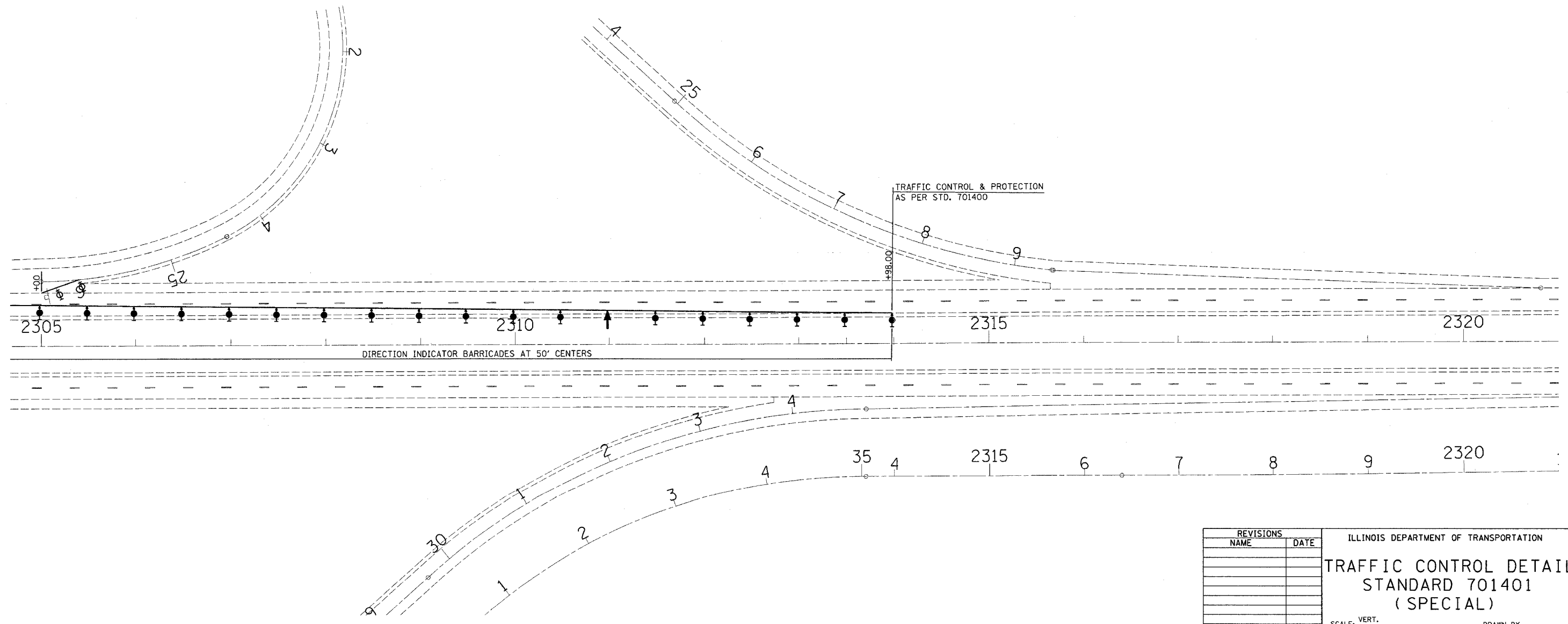

PLOT DATE = 3/12/2007
 FILE NAME = \\s01\p01\74198\veh\plan_74198.dgn
 PLOT SCALE = 50.0000' / IN.
 USER NAME = svertrm

| REVISIONS | |
|-----------|------|
| NAME | DATE |
| | |
| | |
| | |
| | |
| | |
| | |
| | |
| | |
| | |
| | |

ILLINOIS DEPARTMENT OF TRANSPORTATION
TRAFFIC CONTROL DETAIL
STANDARD 701401
(SPECIAL)

SCALE: VERT. _____
 HORIZ. _____

DATE _____ DRAWN BY _____
 CHECKED BY _____