

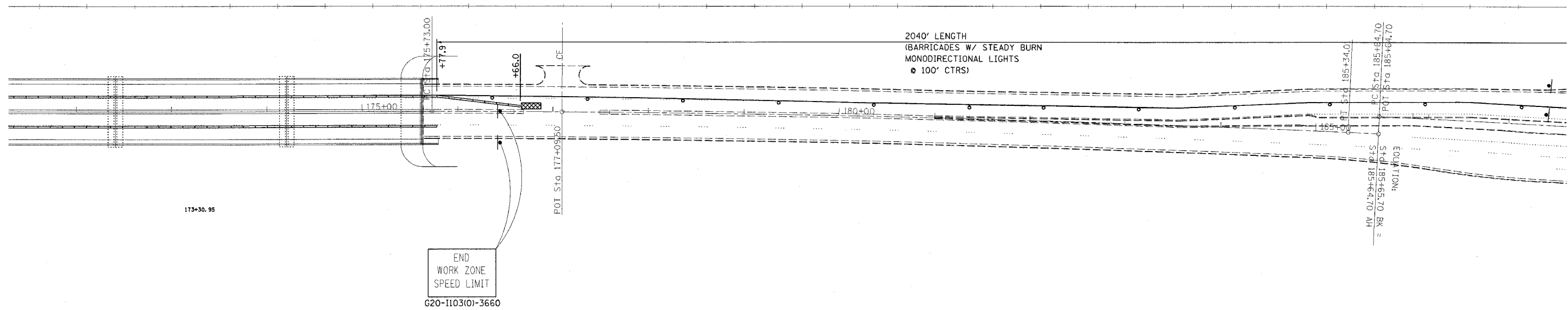

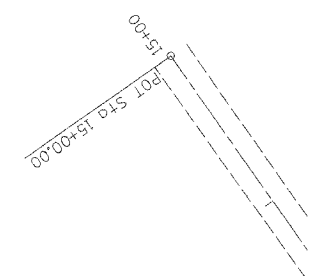

F.A.P. RTE.	SECTION	COUNTY	TOTAL SHEETS	SHEET NO.
320		MACON	18	5
STA.		TO STA.		
FED. ROAD DIST. NO.		ILLINOIS FED. AID PROJECT		
D7 JOINT REPAIRS 2007-3				



EXIST. CURVE C1
 PI STA. = 180+53.59
 $\Delta = 2^\circ 34' 00''$ (RT)
 $D = 0^\circ 16' 01''$
 $R = 21,452.43'$
 $T = 480.59'$
 $L = 961.01'$
 $E = 5.38'$
 $e = \text{-----}$
 $T.R. = \text{-----}$
 $S.E. RUN = \text{-----}$
 $P.C. STA. = 175+73.00$
 $P.T. STA. = 185+34.01$

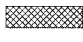

LEGEND

-  BARRICADES W/ STEADY BURN MONODIRECTIONAL LIGHT
-  DIRECTION INDICATOR BARRICADES
-  SIGN
-  ARROW BOARD
-  IMPACT ATTENUATOR

REVISIONS	
NAME	DATE

ILLINOIS DEPARTMENT OF TRANSPORTATION
TRAFFIC CONTR. & PROT.
701423 (SPECIAL)
STAGE I
SN 058-0020

SCALE: VERT. _____
 HORIZ. _____

DATE _____ DRAWN BY _____
 CHECKED BY _____

PLOT DATE = 2/26/2007
 FILE NAME = c:\p\projects\74202\187486\p\dgn
 PLOT SCALE = 5/8"=1'-0"
 USER NAME = hmartin