

F.A.P. RTE.	SECTION	COUNTY	TOTAL SHEETS	SHEET NO.
320		MACON	12	8
STA.	TO STA.			
FED. ROAD DIST. NO.	ILLINOIS	FED. AID PROJECT		
• D7 JOINT REPAIRS 2007-3				

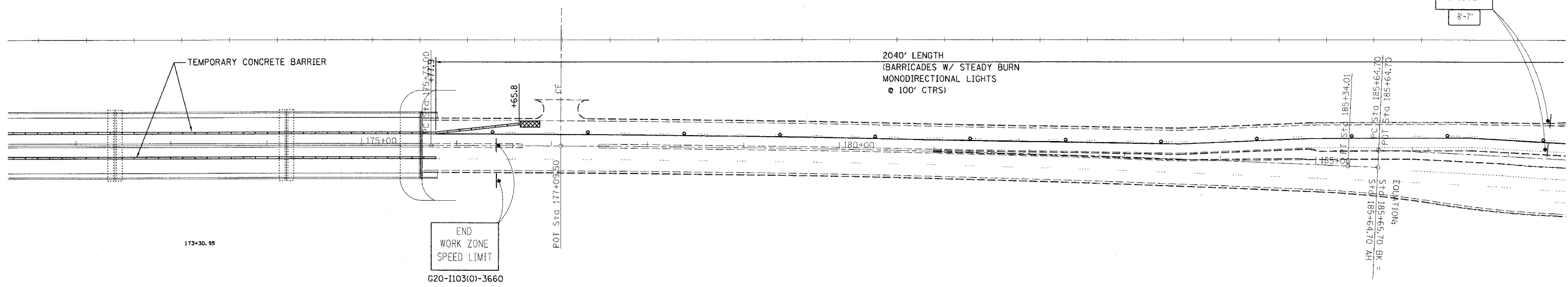

EXIST. CURVE C1
 PI STA. = 180+53.59
 $\Delta = 2^\circ 34' 00''$ (RT)
 D = $0^\circ 16' 01''$
 R = 21,452.43'
 T = 480.59'
 L = 961.01'
 E = 5.38'
 e = -----
 T.R. = -----
 S.E. RUN = -----
 P.C. STA. = 175+73.00
 P.T. STA. = 185+34.01

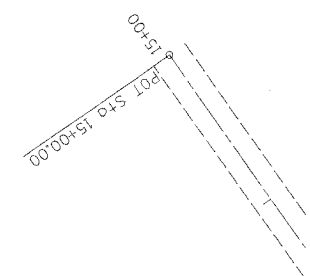

LEGEND

- BARRICADES W/ STEADY BURN MONODIRECTIONAL LIGHT
- DIRECTION INDICATOR BARRICADES
- SIGN
- ARROW BOARD
- IMPACT ATTENUATOR

REVISIONS	
NAME	DATE

ILLINOIS DEPARTMENT OF TRANSPORTATION
TRAFFIC CONTR. & PROT.
701423 (SPECIAL)
STAGE II
SN 058-0020

SCALE: VERT. _____
 HORIZ. _____

DATE _____ DRAWN BY _____
 CHECKED BY _____

PLOT DATE = 2/29/2007
 FILE NAME = C:\p1\1103\74202\1103\1103.dgn
 PLOT SCALE = 5/8" = 1' / IN.
 USER NAME = hbert