



CONTRACT NO. 74239

FAP RTE	SECTION	COUNTY	TOTAL SHEETS	SHEET NO.
716	(130BR-1)BR	MACON	22	3
STA. 124+75		TO STA. 132+50		
FED. ROAD DIST. NO.		ILLINOIS FED. AID PROJECT		

NOTES

1. TRAFFIC CONTROL SHALL BE ERECTED AS SHOWN AND ACCORDING TO TRAFFIC CONTROL AND PROTECTION, STANDARD 701602. SEE STANDARD FOR LOCATIONS OF ITEMS NOT SHOWN HERE.
2. SEE STANDARD 701321 FOR LOCATIONS AND DETAILS OF THE BARRIER WALL REFLECTORS AND THE DOUBLE VERTICAL PANELS WITH STEADY BURNING LIGHTS REQUIRED FOR TEMPORARY CONCRETE BARRIER.
3. THE LEFT TURN LANE AND THE NORTHBOUND DRIVING LANE ARE CURRENTLY CLOSED DUE TO THE CONDITION OF THE EXISTING BRIDGE. TRAFFIC WILL NOT BE ALLOWED ON THESE PORTIONS OF THE STRUCTURE DURING THIS PROJECT. UPON COMPLETION OF THE WORK, THE LEFT TURN LANE SHALL REMAIN CLOSED AND THE NORTHBOUND DRIVING LANE SHALL BE OPENED AS SHOWN ON SHEET 5.
4. THE CONTRACTOR SHALL COLLECT ALL EXISTING TRAFFIC CONTROL DEVICES USED FOR THE CURRENT LANE CLOSURES SUCH AS SIGNS, BARRICADES, DRUMS, ARROW BOARDS, ETC; DELIVER THEM TO THE IDOT MAINTENANCE YARD IN DECATUR; AND UNLOAD AND STACK THEM IN A LOCATION AS DETERMINED BY THE ENGINEER.
5. THE CONTRACTOR SHALL BE RESPONSIBLE FOR SUPPLYING, INSTALLING, MAINTAINING, AND REMOVING ALL TRAFFIC CONTROL ITEMS SHOWN ON SHEETS 3 AND 4. ALL TRAFFIC CONTROL ITEMS SHOWN ON SHEET 5 WILL BE SUPPLIED BY IDOT. THE CONTRACTOR SHALL PICK THESE ITEMS UP AT THE IDOT MAINTENANCE YARD IN DECATUR, DELIVER THEM TO THE SITE, UNLOAD THEM, AND INSTALL THEM AS SHOWN ON THE PLANS.
6. SEE SPECIAL PROVISIONS FOR ADDITIONAL TRAFFIC CONTROL REQUIREMENTS.

SCHEDULE OF QUANTITIES

TEMPORARY CONCRETE BARRIER			
STATION	TO	STATION	TOTAL FEET
134+12.5		137+00	287.5

IMPACT ATTENUATORS, TEMPORARY (NON-REDIRECTIVE), TEST LEVEL 3	
	- 2 EACH

LEGEND

- DRUM WITH STEADY BURNING LIGHT
- MEDIAN REMOVAL
- TRAFFIC DIRECTION
- ARROW BOARD
- SIGN ON PORTABLE OR PERMANENT SUPPORT
- IMPACT ATTENUATORS
- TYPE III BARRICADE

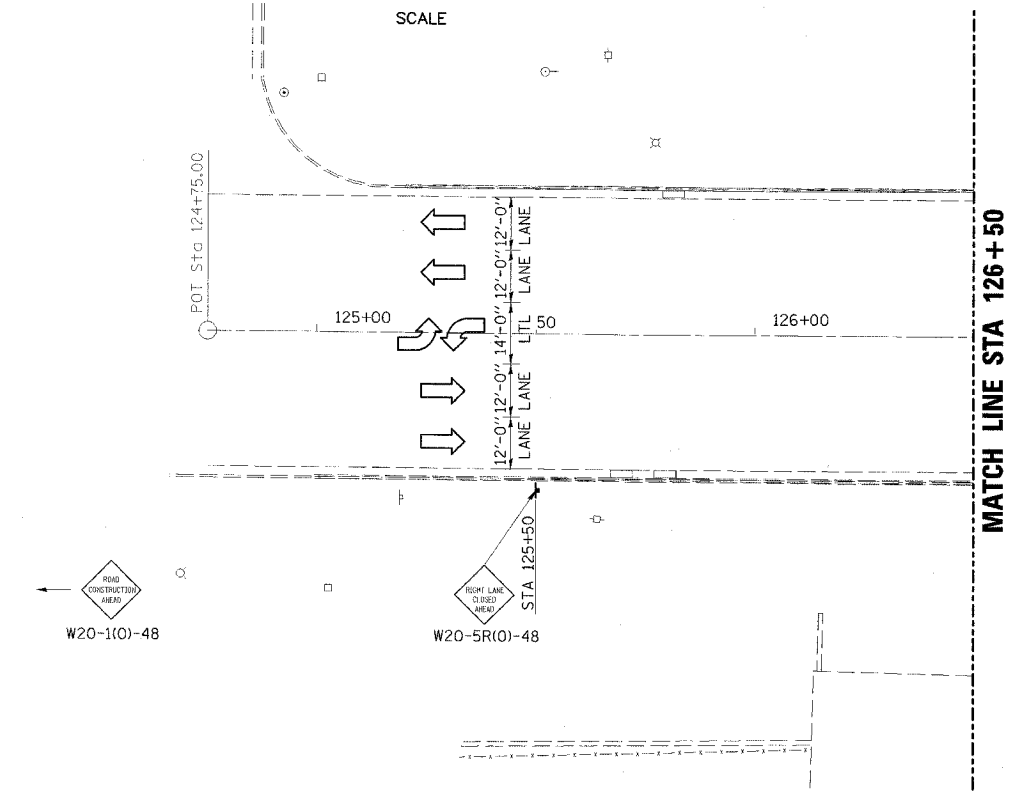
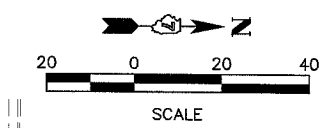

DURING CONSTRUCTION

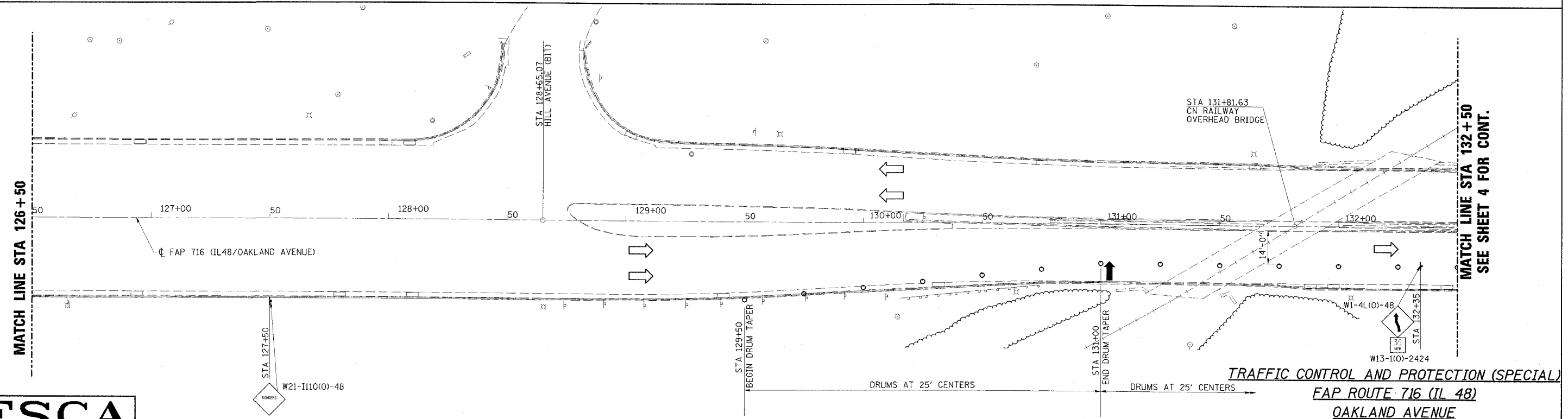

MATCH LINE STA 132+50
SEE SHEET 4 FOR CONT.

ESCA
CONSULTANTS, INC.

DESIGNED BY:	ELH	02/07
DRAWN BY:	JPC/KAH	02/07
CHECKED BY:	ELH	02/07
APPROVED BY:	RDP	02/07

DURING CONSTRUCTION

FAP ROUTE 716 (IL 48)
OAKLAND AVENUE
SECTION (130BR-1)BR
MACON COUNTY
SN 058-0056