

FAU RTE.	SECTION	COUNTY	TOTAL SHEETS	SHEET NO.
9393	37-BR	MADISON	38	27
STA.	TO STA.			
FED. ROAD DIST. NO.	ILLINOIS	FED. AID PROJECT		
CONTRACT NO. 76304				

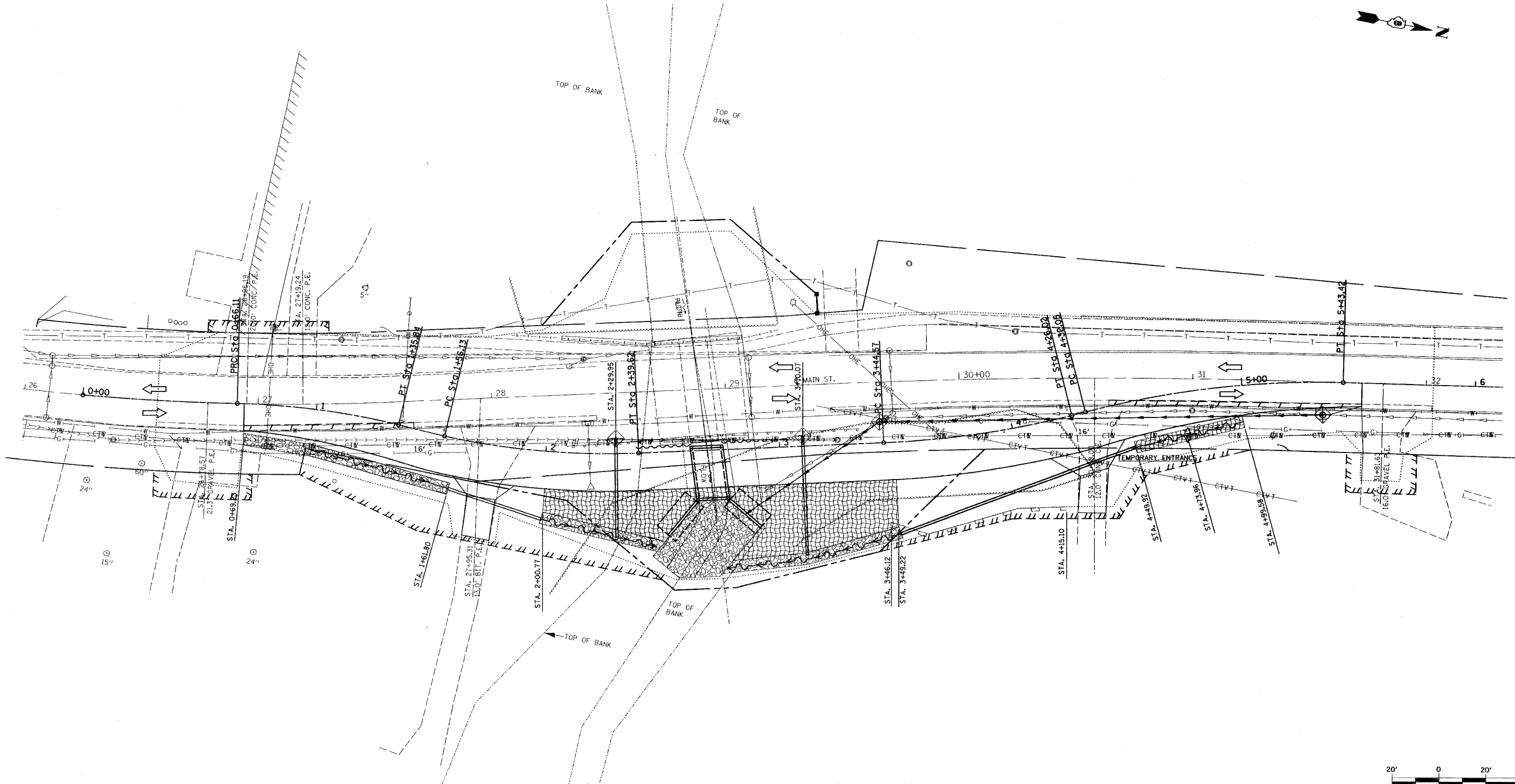

LEGEND

- ⊕ INLET AND PIPE PROTECTION
- ⊕ TEMPORARY DITCH CHECKS
- PERIMETER EROSION CONTROL BARRIER
- ▨ AGGREGATE DITCH, 12"
- ▩ EROSION CONTROL BLANKET

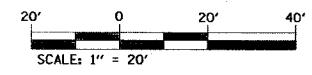

REVISIONS	
NAME	DATE

ILLINOIS DEPARTMENT OF TRANSPORTATION  
**STORM WATER POLLUTION  
 PREVENTION PLAN**  
 FAU ROUTE 9393 (MAIN ST.)  
 SECTION 37-BR  
 MADISON COUNTY

DRAWN BY: SGK

PLOT DATE: 12/16/2006  
 PLOT SCALE: 1/8" = 20' 0" / IN.  
 USER: NAME: S. GIBSON