

F.A.A. NO.	SECTION	COUNTY	TOTAL SHEETS	SHEET NO.
789	IRS-1	MADISON	26	21
STA. 253+00		TO STA. 257+00		
EXISTING CONDITIONS:				

PLAN	DATE
DESIGNED	
CHECKED	
IN CHARGE	
DATE	

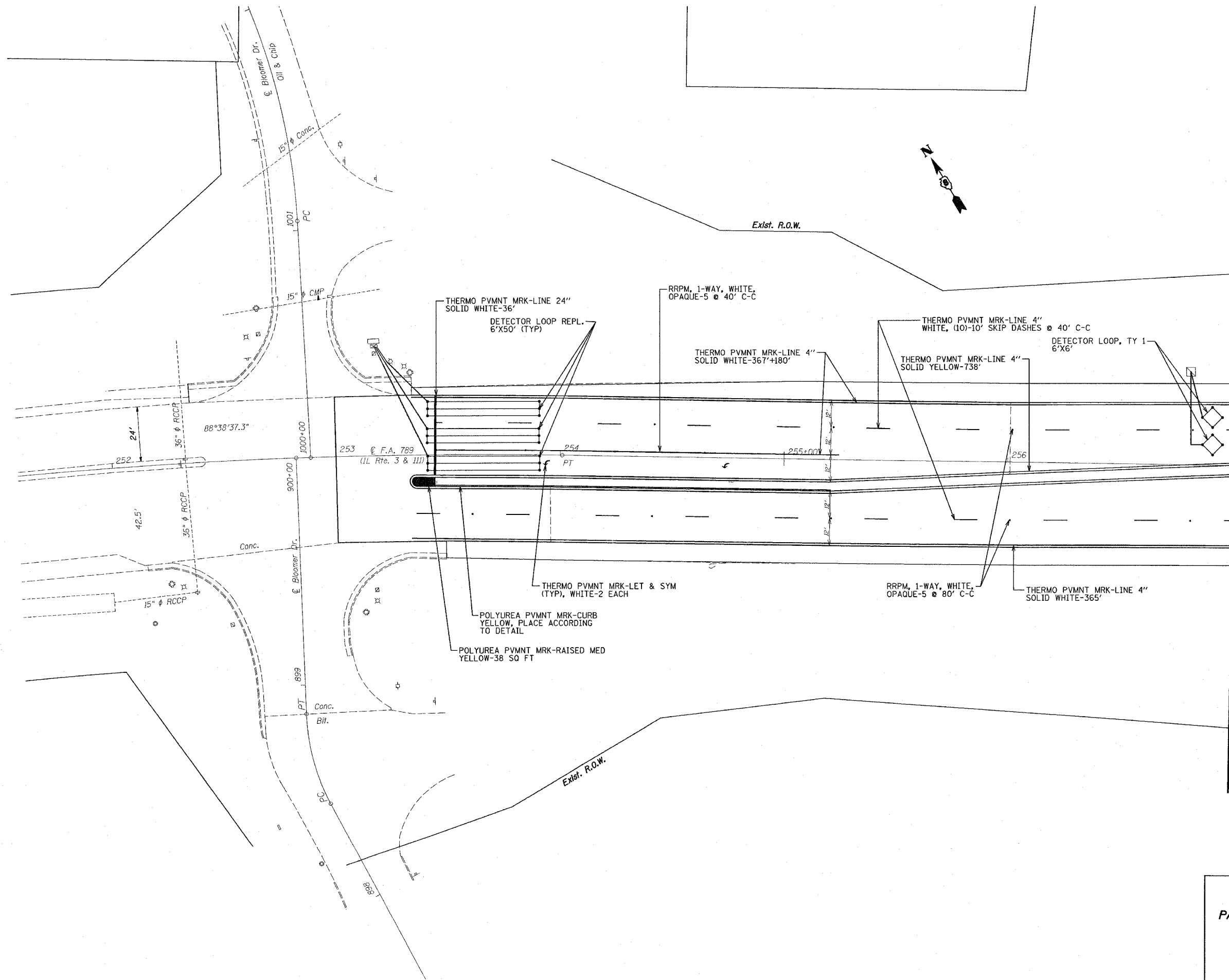

ILLINOIS DEPARTMENT OF TRANSPORTATION
**PAVEMENT MARKING & ELECTRICAL
LOCATION #3**
F.A. 789 (IL RTE. 3 & 111)
SECTION IRS-1
MADISON COUNTY

PLOT DATE: 4/5/2007

4/5/2007
4/5/2007
4/5/2007
4/5/2007