

F.A.I. RTE.	SECTION	COUNTY	TOTAL SHEETS	SHEET NO.
2509	96-00094-01-WR	KANE	187	27
STA.		TO STA.		
FED. ROAD DIST. NO.		ILLINOIS FED. AID PROJECT		

ALL LANES ARE 11 FT WIDTH UNLESS NOTED OTHERWISE.

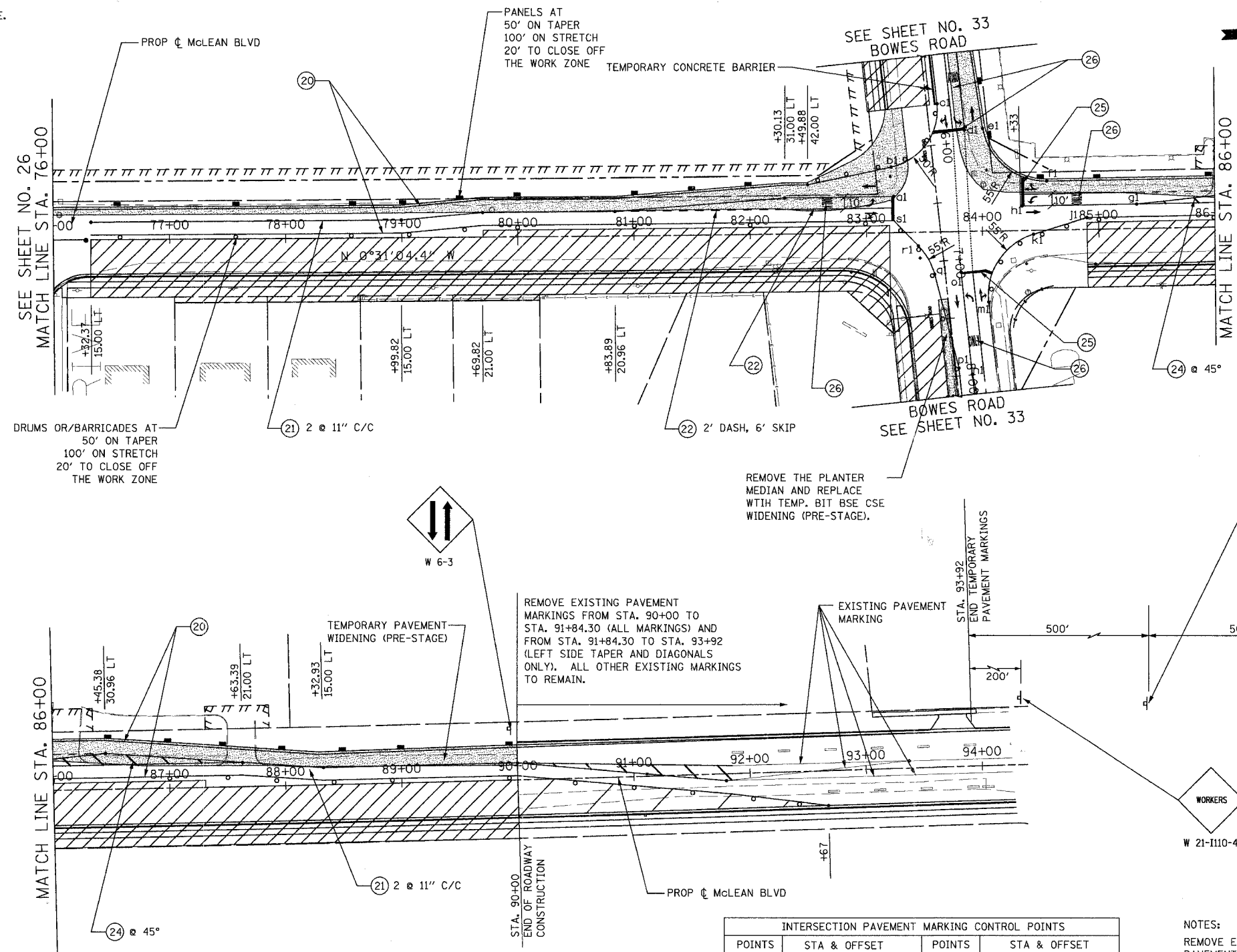

INTERSECTION PAVEMENT MARKING CONTROL POINTS			
POINTS	STA & OFFSET	POINTS	STA & OFFSET
a1	+24.03, 31.00 LT	p1	7+93.33, 2.74 LT
b1	+22.23, 56.25 LT	q1	7+10.69, 9.05 RT
c1	5+65.00, 9.00 LT	r1	+44.65, 11.66 RT
d1	5+89.93, 30.06 LT	s1	+24.03, 10.00 LT
e1	5+90.32, 45.56 LT		
f1	+55.94, 42.00 LT		
g1	+33.07, 21.00 LT		
h1	+34.29, 21.00 LT		
j1	+90.00, 10.00 RT		
k1	+43.83, 3.36 RT		
m1	7+39.60, 34.65 LT		
n1	8+00.00, 13.70 LT		
o1	7+11.36, 13.62 LT		

NOTES:
 REMOVE EXISTING CURB & GUTTER, DRIVEWAY ISLAND, OR PAVEMENT WHERE NECESSARY TO PROVIDE A SMOOTH RIDE FOR AREAS THAT REQUIRE TEMP. WIDENING.
 ALL LANES ARE 11-FOOT WIDTH UNLESS SHOWN OTHERWISE.

FOR PAVEMENT MARKING DESCRIPTION AND LEGEND SEE SHEET NO. 22.

REVISIONS	
NAME	DATE

URS 100 SOUTH WACKER DRIVE
 SUITE 500 CHICAGO, IL 60606 TEL (312) 939-1000 FAX (312) 939-4198

McLEAN BOULEVARD

SUGGESTED MAINTENANCE OF TRAFFIC STAGE I

SCALE: DATE 04/06/2007 DRAWN BY MIA CHECKED BY NAP