

F.A.U. RTE.	SECTION	COUNTY	TOTAL SHEETS	SHEET NO.
2509	96-00094-01-WF	KANE	187	42
STA.		TO STA.		
FED. ROAD DIST. NO.		ILLINOIS FED. AID PROJECT		

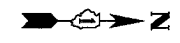

MAINTAIN DRIVEWAY ACCESS BY STAGING THE WORK AND ADJUSTING THE DRUM SPACING. (TYPICAL FOR ALL DRIVEWAYS).

ALL LANES ARE 11 FT WIDTH UNLESS NOTED OTHERWISE.

26+50 27+00 28+00 29+00 30+00 31+00 32+00 33+00 34+00 35+00 36+00 37+00 38+00 39+00 40+00

MATCH LINE STA. 40+00

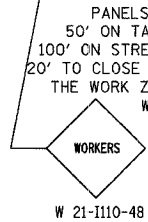
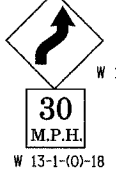

SEE STD 701501-02 FOR ADDITIONAL SIGNS AND DETAILS

- NOTES:
1. REMOVE EXISTING CURB & GUTTER, DRIVEWAY ISLAND, OR PAVEMENT WHERE NECESSARY TO PROVIDE A SMOOTH RIDE FOR AREAS THAT REQUIRE TEMP. WIDENING.
 2. EXISTING DRAINAGE STRUCTURES WITHIN THE TEMPORARY PAVING LIMITS SHALL BE COVERED WITH A METAL PLATE PRIOR TO THE TEMPORARY PAVEMENT WIDENING AND THEN BURRIED IF NECESSARY. THIS WORK WILL NOT BE PAID SEPARATELY BUT SHALL BE INCLUDED IN THE CONTRACT UNIT PRICE OF THE TEMPORARY PAVEMENT WIDENING.
 3. SEE EROSION CONTROL PLANS FOR TEMPORARY DRAINAGE AND INLET PIPE PROTECTION. TYPICAL FOR ALL STAGES.

MATCH LINE STA. 40+00

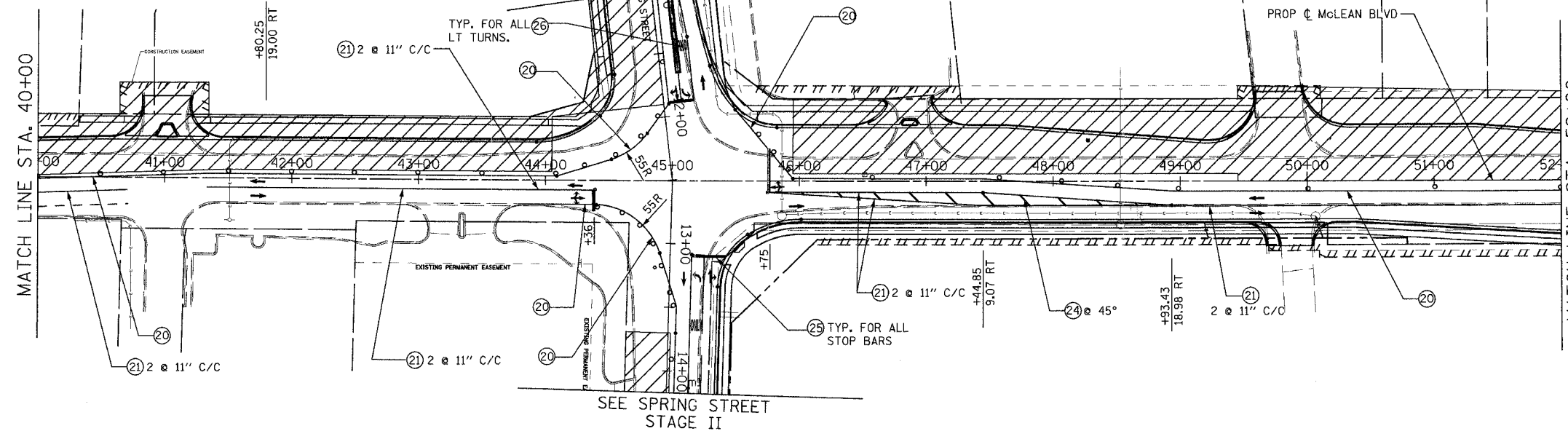

MATCH LINE STA. 52+00
SEE SHEET NO. 43

FOR PAVEMENT MARKING DESCRIPTION AND LEGEND SEE SHEET NO. 22.

URS 100 SOUTH WACKER DRIVE SUITE 500 CHICAGO, IL 60606 TEL (312) 939-1000 FAX (312) 939-4198

REVISIONS	
NAME	DATE

McLEAN BOULEVARD
SUGGESTED MAINTENANCE OF TRAFFIC STAGE II
SCALE: DATE 04/06/2007 DRAWN BY MIA CHECKED BY NAP