

ALL LANES ARE 11 FT WIDTH UNLESS NOTED OTHERWISE.

CONTRACT NO. 83737				
F.A.U. RTE.	SECTION	COUNTY	TOTAL SHEETS	SHEET NO.
2509	96-00094-01-WR	KANE	187	44
STA.		TO STA.		
FED. ROAD DIST. NO.		ILLINOIS FED. AID PROJECT		

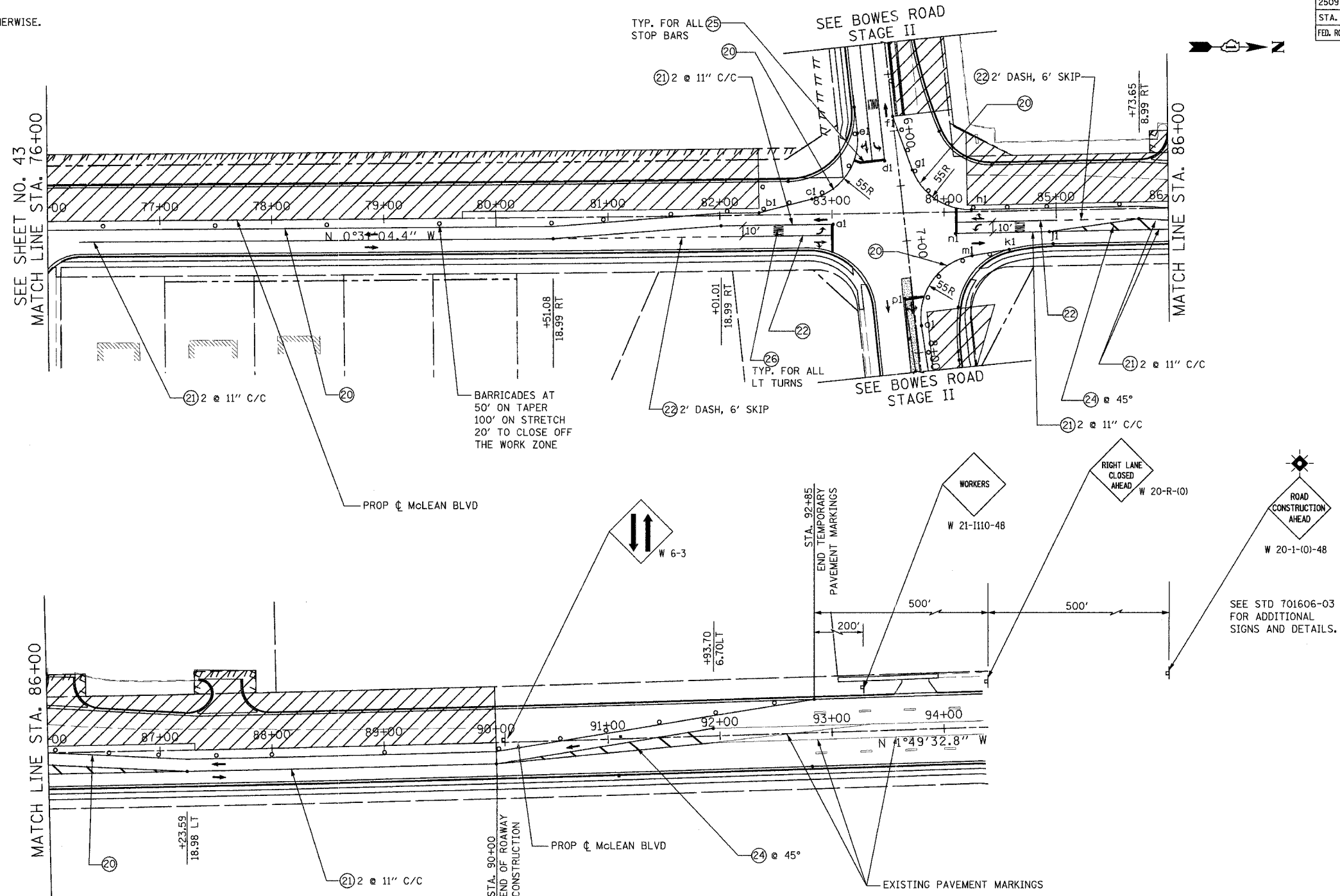

INTERSECTION PAVEMENT MARKING CONTROL POINTS			
POINTS	STA & OFFSET	POINTS	STA & OFFSET
a1	+00.99, 9.02 LT	p1	7+50.75, 7.33 RT
b1	+35.00, 2.00 LT		
c1	+82.37, 13.92 LT		
d1	6+26.08, 11.51 RT		
e1	5+98.69, 33.00 RT		
f1	5+87.28		
g1	6+36.78, 12.08 LT		
h1	+24.48, 1.88 LT		
j1	+93.68, 19.00 RT		
k1	+57.70, 34.34 RT		
m1	+24.34, 39.45 RT		
n1	+09.81, 19.16 RT		
o1	7+76.73, 4.82 LT		

FOR PAVEMENT MARKING DESCRIPTION AND LEGEND SEE SHEET NO. 22.

REVISIONS	
NAME	DATE

**URS** 100 SOUTH WACKER DRIVE  
SUITE 500 CHICAGO, IL 60606 TEL (312) 939-1000 FAX (312) 939-4198

**McLEAN BOULEVARD**

**SUGGESTED MAINTENANCE OF TRAFFIC STAGE II**

SCALE: DATE 04/06/2007 DRAWN BY MIA CHECKED BY NAP