

CONTRACT NO. 83737				
F.A.J. RTE.	SECTION	COUNTY	TOTAL SHEETS	SHEET NO.
2509	96-00094-01-WR	KANE	187	51
STA.		TO STA.		
FED. ROAD DIST. NO.		ILLINOIS FED. AID PROJECT		

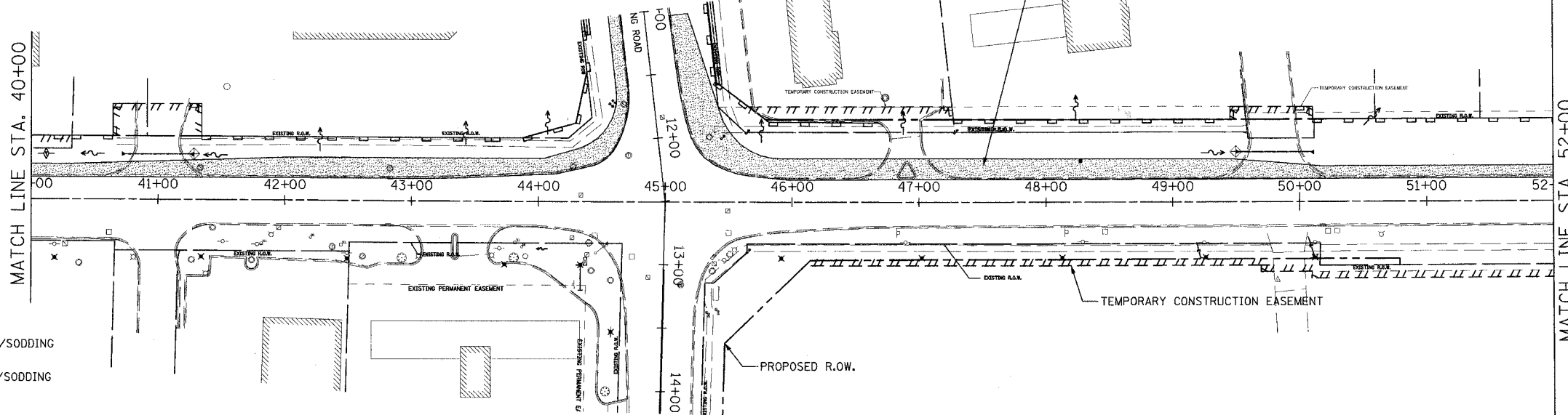
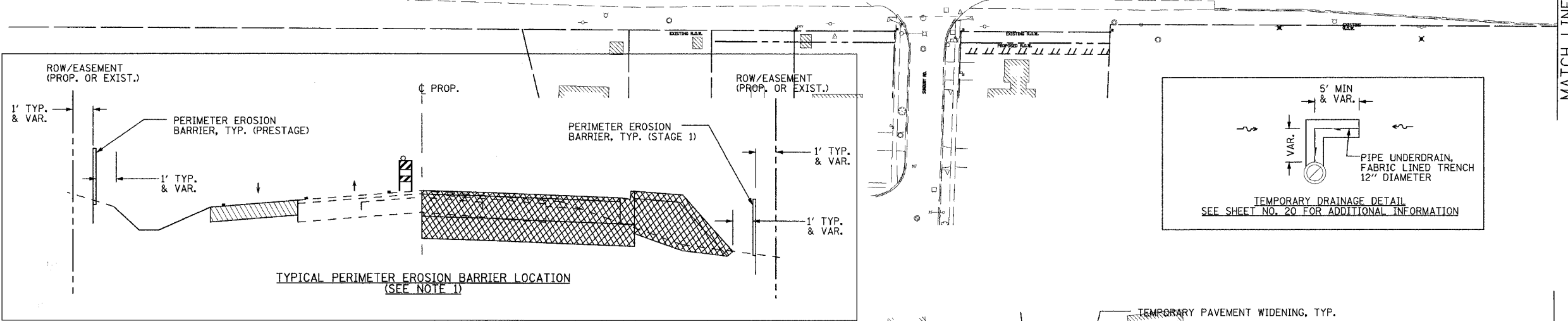
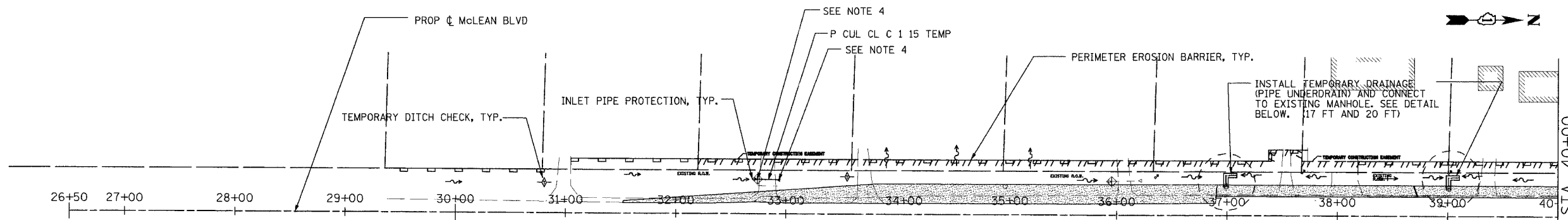

**LEGEND**

	PERMANENT SEEDING/SODDING (PREVIOUS STAGE)
	PERMANENT SEEDING/SODDING (CURRENT STAGE)
	TEMPORARY PAVEMENT WIDENING
	PERIMETER EROSION BARRIER (PREVIOUS STAGE)
	PERIMETER EROSION BARRIER (CURRENT STAGE)
	INLET PIPE PROTECTION
	DITCH CHECK (TEMPORARY)
	FLOW DIRECTION
	DIRECTION OF TRAFFIC FLOW

- NOTES:**
1. THE RESIDENT ENGINEER SHALL HAVE THE FINAL DETERMINATION OF THE PLACEMENT AND LOCATION OF THE PERIMETER EROSION BARRIER
  2. SEE SUGGESTED MAINTENANCE OF TRAFFIC PLANS FOR ADDITIONAL INFORMATION REGARDING THE SEQUENCE OF CONSTRUCTION.
  3. NOT ALL DRAINAGE STRUCTURES ARE SHOWN. SEE DRAINAGE PLANS FOR ADDITIONAL INFORMATION.
  4. FLARED END SECTIONS FOR THE TEMPORARY PIPE CULVERTS ARE OMITTED INTENTIONALLY.
  5. MAINTAIN THE PROTECTION MEASURES FROM THE PREVIOUS STAGE UNTIL THE REMOVAL IS ABSOLUTELY NECESSARY.

REVISIONS	
NAME	DATE

**URS** 100 SOUTH WACKER DRIVE  
SUITE 500 TEL (312) 939-1000  
CHICAGO, IL 60606 FAX (312) 939-4198

**McLEAN BOULEVARD**  
**EROSION CONTROL PLAN**  
**PRESTAGE**

SCALE: DATE 04/06/2007 DRAWN BY KLM CHECKED BY MHL