

CONTRACT NO. 83737				
F.A.U. RTE.	SECTION	COUNTY	TOTAL SHEETS	SHEET NO.
2509	96-00094-01-WR	KANE	187	58
STA.		TO STA.		
FED. ROAD DIST. NO.		ILLINOIS	FED. AID PROJECT	

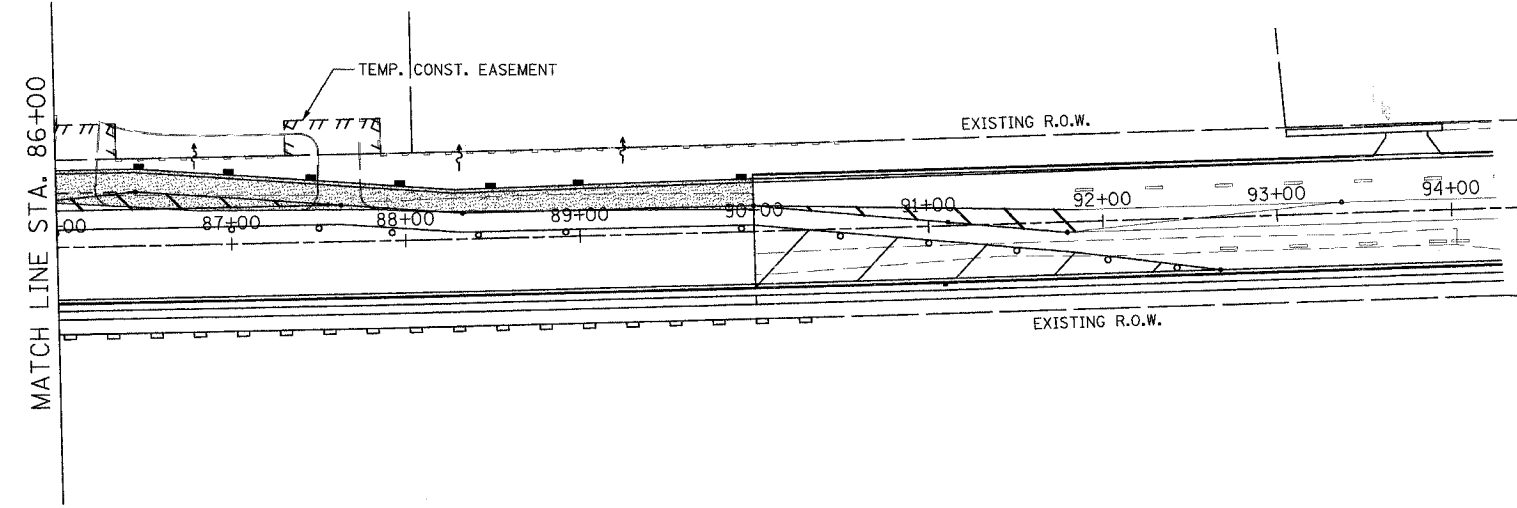
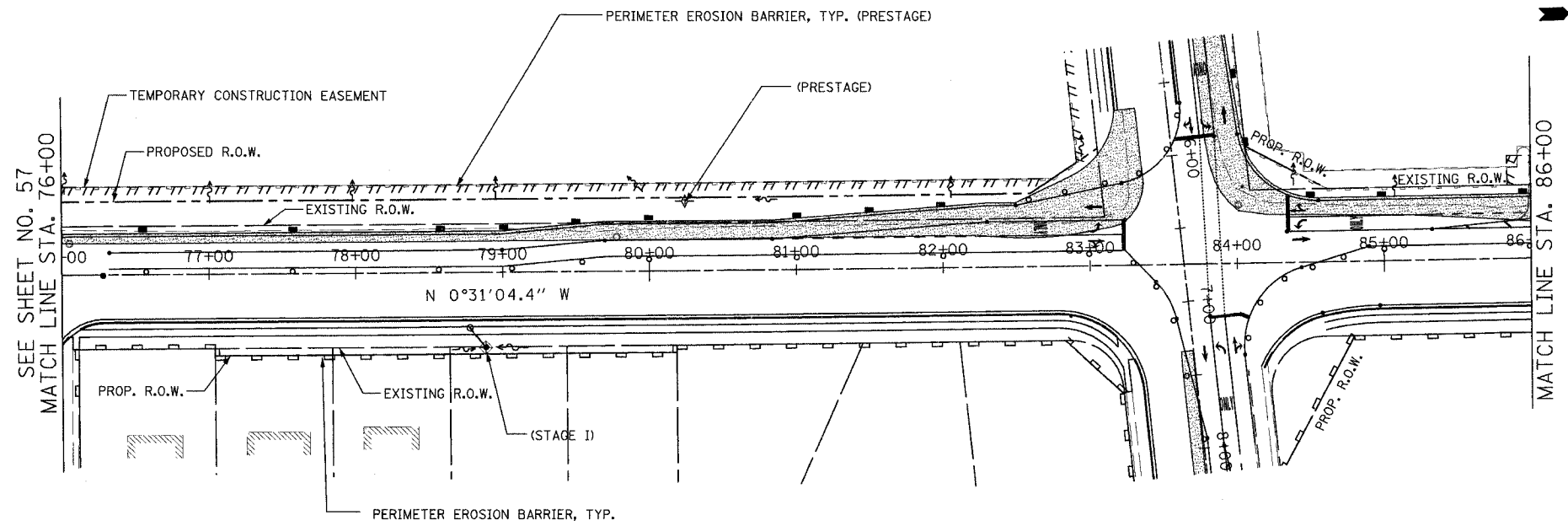

- NOTES:
1. THE RESIDENT ENGINEER SHALL HAVE THE FINAL DETERMINATION OF THE PLACEMENT AND LOCATION OF THE PERIMETER EROSION BARRIER
  2. SEE SUGGESTED MAINTENANCE OF TRAFFIC PLANS FOR ADDITIONAL INFORMATION REGARDING THE SEQUENCE OF CONSTRUCTION.
  3. NOT ALL DRAINAGE STRUCTURES ARE SHOWN. SEE DRAINAGE PLANS FOR ADDITIONAL INFORMATION.
  4. FLARED END SECTIONS FOR THE TEMPORARY PIPE CULVERTS ARE OMITTED INTENTIONALLY.
  5. MAINTAIN THE PROTECTION MEASURES FROM THE PREVIOUS STAGE UNTIL THE REMOVAL IS ABSOLUTELY NECESSARY.

FOR EROSION CONTROL PLAN LEGEND, SEE SHEET NO 51.

REVISIONS	
NAME	DATE

**URS** 100 SOUTH WACKER DRIVE TEL (312) 939-1000  
 SUITE 500 CHICAGO, IL 60606 FAX (312) 939-4198

McLEAN BOULEVARD  
 EROSION CONTROL PLANS  
 STAGE I

SCALE: DATE 04/06/2007 DRAWN BY MIA CHECKED BY MHL