

CONTRACT NO. 83737

F.A.U. RTE.	SECTION	COUNTY	TOTAL SHEETS	SHEET NO.
2509	96-00094-01-WR	KANE	187	61
STA. TO STA.		FED. ROAD DIST. NO. ILLINOIS FED. AID PROJECT		

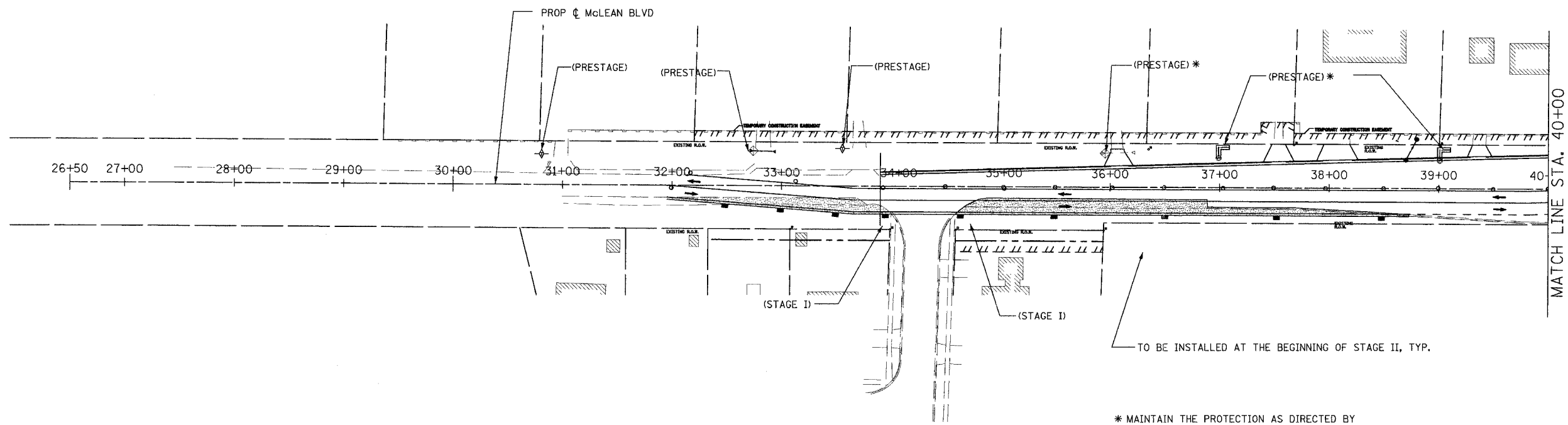

* MAINTAIN THE PROTECTION AS DIRECTED BY THE ENGINEER UNTIL THE REMOVAL IS NECESSARY.

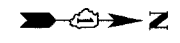
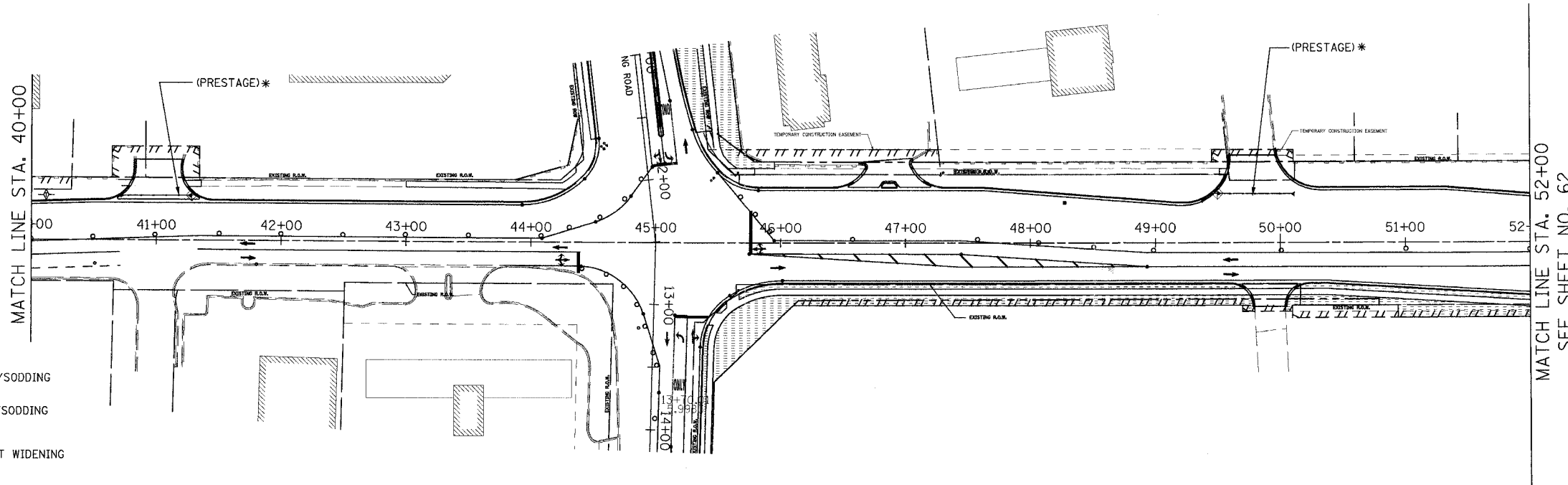

LEGEND

- PERMANENT SEEDING/SODDING (PREVIOUS STAGE)
- PERMANENT SEEDING/SODDING (CURRENT STAGE)
- TEMPORARY PAVEMENT WIDENING
- PERIMETER EROSION BARRIER (PREVIOUS STAGE)
- PERIMETER EROSION BARRIER (CURRENT STAGE)
- INLET PIPE PROTECTION
- DITCH CHECK (TEMPORARY)
- FLOW DIRECTION
- DIRECTION OF TRAFFIC FLOW

NOTES:

1. THE RESIDENT ENGINEER SHALL HAVE THE FINAL DETERMINATION OF THE PLACEMENT AND LOCATION OF THE PERIMETER EROSION BARRIER
2. SEE SUGGESTED MAINTENANCE OF TRAFFIC PLANS FOR ADDITIONAL INFORMATION REGARDING THE SEQUENCE OF CONSTRUCTION.
3. NOT ALL DRAINAGE STRUCTURES ARE SHOWN. SEE DRAINAGE PLANS FOR ADDITIONAL INFORMATION.
4. FLARED END SECTIONS FOR THE TEMPORARY PIPE CULVERTS ARE OMITTED INTENTIONALLY.
5. MAINTAIN THE PROTECTION MEASURES FROM THE PREVIOUS STAGE UNTIL THE REMOVAL IS ABSOLUTELY NECESSARY.

REVISIONS	
NAME	DATE

URS 100 SOUTH WACKER DRIVE
SUITE 500
CHICAGO, IL 60606
TEL (312) 939-1000
FAX (312) 939-4198

McLEAN BOULEVARD
EROSION CONTROL PLAN
STAGE II

SCALE: DATE 04/06/2007
DRAWN BY KLM
CHECKED BY MHL