

DRIVEWAY STA. 5+48 LT		
PT.	STATION	OFFSET *
a	STA 5+10.59	20.60' LT
b	STA 5+16.48	20.60' LT
c	STA 5+36.40	38.80' LT
d	STA 5+60.52	39.28' LT
e	STA 5+80.48	20.60' LT

\* FROM CL TO BACK OF CURB

DRIVEWAY STA. 5+55 RT		
PT.	STATION	OFFSET *
a	STA 5+91.98	20.08' RT
b	STA 5+37.74	45.69' RT
c	STA 5+38.23	49.00' RT
d	STA 5+68.57	49.00' RT
e	STA 5+92.57	24.12' RT

\* FROM CL TO BACK OF CURB  
CE/CONC

DRIVEWAY STA. 8+08 LT		
PT.	STATION	OFFSET *
a	STA 7+77.60	24.15' RT
b	STA 7+91.40	44.30' RT
c	STA 7+91.40	48.21' RT
d	STA 8+24.73	50.19' RT
e	STA 8+32.50	26.69' RT

\* FROM CL TO BACK OF CURB

DRIVEWAY STA. 8+15 RT		
PT.	STATION	OFFSET *
a	STA 7+86.16	31.73' RT
b	STA 7+94.66	31.73' RT
c	STA 7+97.23	48.56' RT
d	STA 8+31.65	48.66' RT
e	STA 8+34.63	58.39' RT
f	STA 8+42.29	33.94' RT

\* FROM CL TO BACK OF CURB

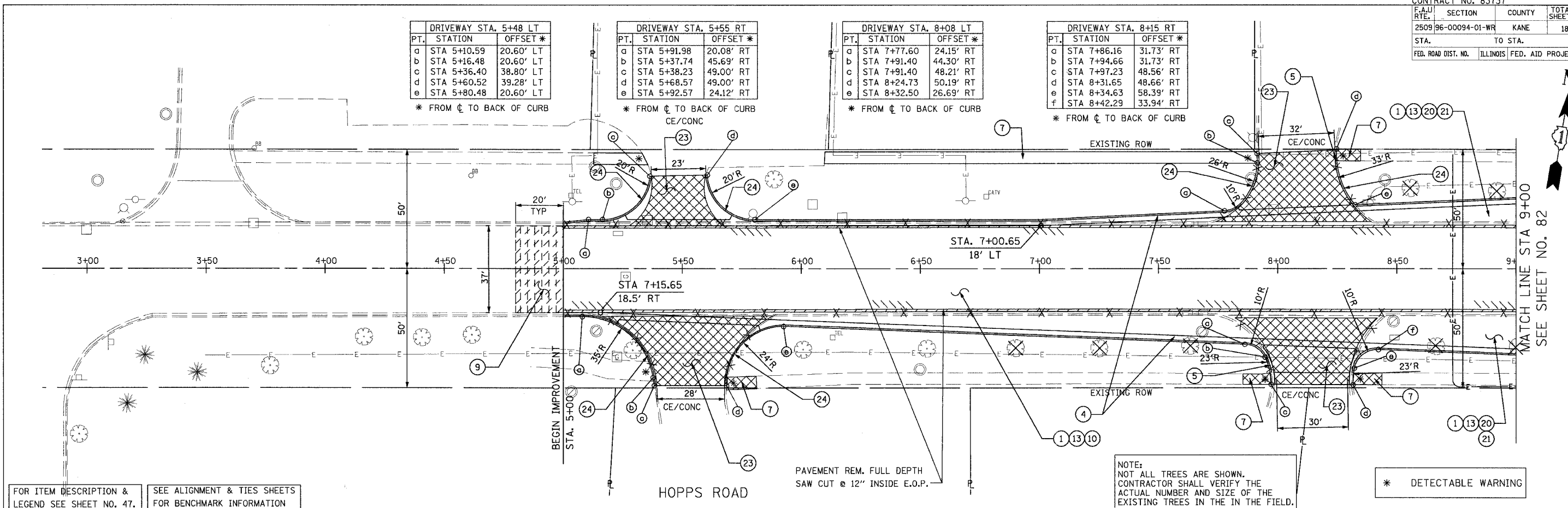

FOR ITEM DESCRIPTION & LEGEND SEE SHEET NO. 47.  
 SEE ALIGNMENT & TIES SHEETS FOR BENCHMARK INFORMATION

NOTE:  
 NOT ALL TREES ARE SHOWN.  
 CONTRACTOR SHALL VERIFY THE ACTUAL NUMBER AND SIZE OF THE EXISTING TREES IN THE IN THE FIELD.

\* DETECTABLE WARNING

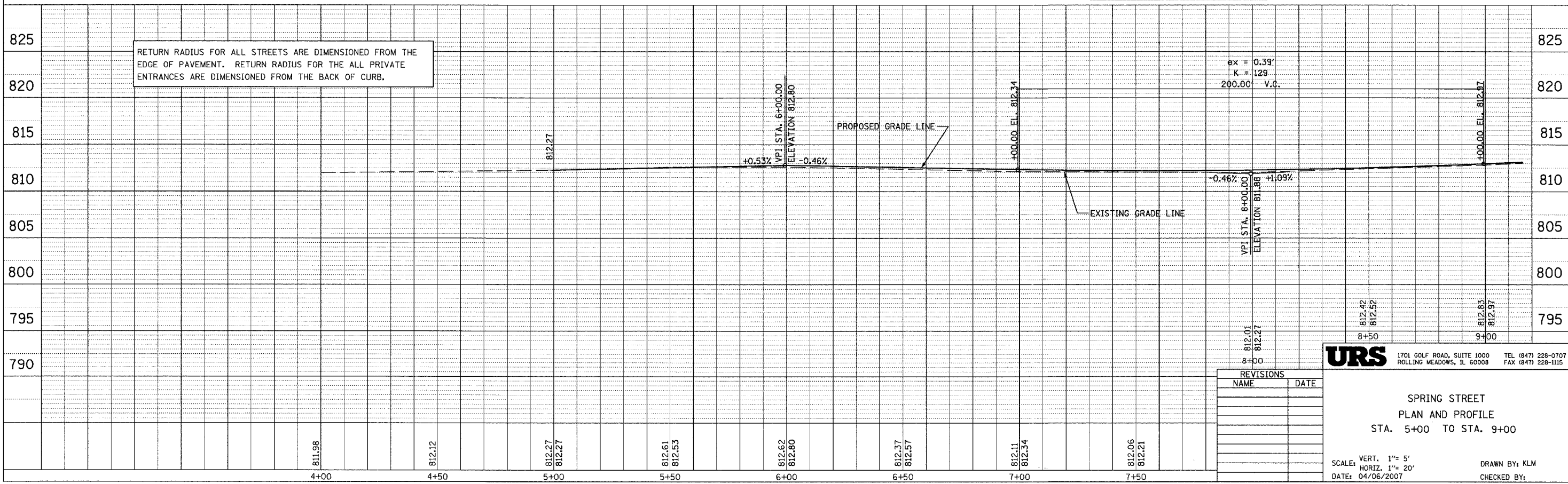

RETURN RADIUS FOR ALL STREETS ARE DIMENSIONED FROM THE EDGE OF PAVEMENT. RETURN RADIUS FOR THE ALL PRIVATE ENTRANCES ARE DIMENSIONED FROM THE BACK OF CURB.

$px = 0.39'$   
 $K = 129$   
 200.00 V.C.

$-0.46\%$   
 VPI STA. 8+00.00  
 ELEVATION 811.88  
 $+1.09\%$

**URS** 1701 GOLF ROAD, SUITE 1000 TEL (847) 228-0707  
 ROLLING MEADOWS, IL 60008 FAX (847) 228-1115

REVISIONS	
NAME	DATE

SPRING STREET  
 PLAN AND PROFILE  
 STA. 5+00 TO STA. 9+00

SCALE: VERT. 1" = 5'  
 HORIZ. 1" = 20'  
 DATE: 04/06/2007  
 DRAWN BY: KLM  
 CHECKED BY:

PLAN  
 SURVEYED  
 PLOTTED  
 CHECKED  
 BY: \_\_\_\_\_  
 DATE: \_\_\_\_\_  
 NOTE BOOK NO. \_\_\_\_\_  
 DATE FILED \_\_\_\_\_

PROFILE  
 SURVEYED  
 PLOTTED  
 CHECKED  
 BY: \_\_\_\_\_  
 DATE: \_\_\_\_\_  
 NOTE BOOK NO. \_\_\_\_\_  
 DATE FILED \_\_\_\_\_