

ROUTE NO.	SECTION	COUNTY	TOTAL SHEETS	SHEET NO.
FAU 2545	*	WILL	147	38
FED. ROAD DIST. NO. 7		ILLINOIS	FED. AID PROJECT	
* 98-00036-19-FP				
CONTRACT NO. 83896				

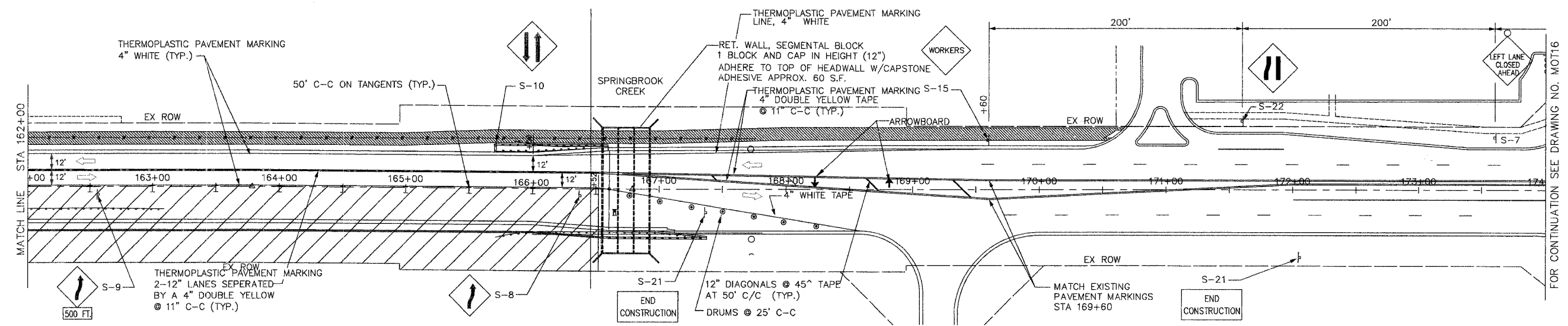
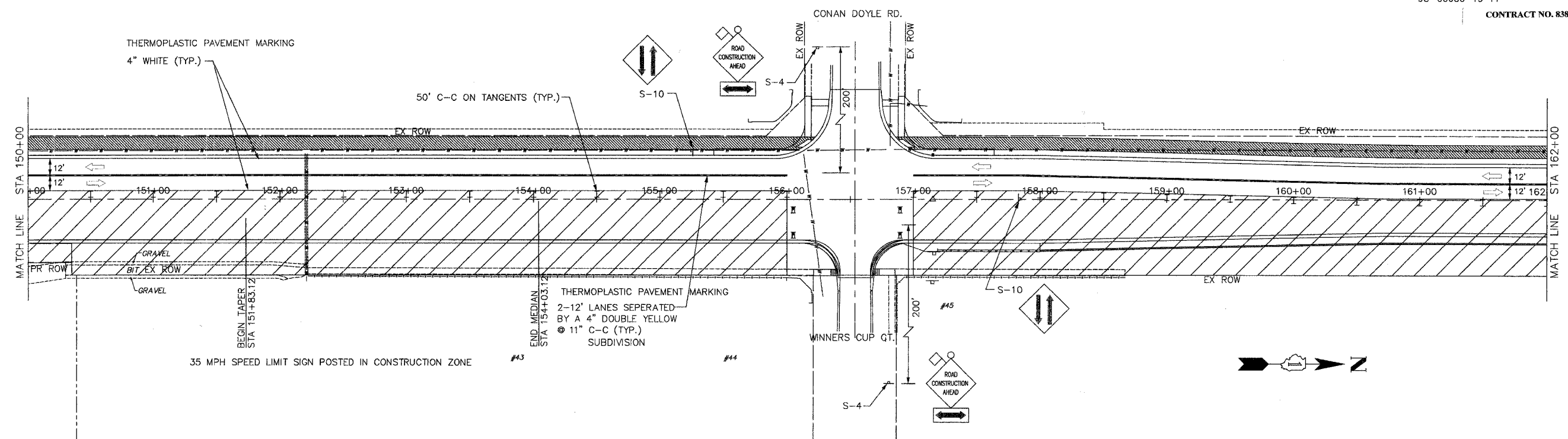

- LEGEND**
- PLASTIC DRUMS W/STEADY BURN LIGHTS @ 25FT SPACING
 - I TYPE I OR TYPE II BARRICADES W/STEADY BURN LIGHTS @ 50' C-C ON TANGENTS; 25' C-C ON TAPERS
 - II TYPE III BARRICADES W/STEADY BURN LIGHTS
 - ⇨ TRAFFIC LANE
 - ⇨ TRAFFIC SIGN
 - ⇨ FLASHING ARROWBOARD
 - ▨ WORK AREA

WILL COUNTY DEPARTMENT OF HIGHWAYS			
PLAINFIELD-NAPERVILLE ROAD (C.H. 14)			
ROADWAY RECONSTRUCTION			
M.O.T. STAGE 3			
STA 150+00 TO 173+50			
McDonough Associates Inc. Engineers/Architects		DESIGNED BY: MC CHECKED BY: NUL DRAWN BY: JTF	SCALE: 1" = 40'

P4
 DRAWING ID: G:\200300023 - Plainfield-Naperville Road\dwg\MOT3 1-4.dwg
 PLOT DATE: 07/08/05 - 10:33