

SECTION	COUNTY	TOTAL SHEETS	SHEET NO.
06-00031-00-PV	COOK	14	3
SUMMARY OF QUANTITIES & LOCATION MAP			
FED. ROAD DIST. NO. 7	ILLINOIS	FED. AID PROJECT HPP-0224(004)	

ITEM NO.	DESCRIPTION	UNIT	TOTAL (CONSTRUCTION TYPE CODE 1000-2A)	CHICAGO STREET (SHEET NO. 4)	ARTHUR AVENUE (SHEET NO. 4)	ASHBEL AVENUE (SHEET NO. 5)	HILLSIDE AVENUE (SHEET NO. 5)	ALBIN TERRACE (SHEET NO. 6)	HAWTHORNE AVENUE (SHEET NO. 6)	VICTORIA AVENUE (SHEET NO. 7)	ATWOOD AVENUE (SHEET NO. 7)	HARDING AVENUE (SHEET NO. 7)	HERBERT AVENUE (SHEET NO. 7)	BURR OAK AVENUE (SHEET NO. 8)	MAPLE AVENUE (SHEET NO. 8)	LEE AVENUE (SHEET NO. 9)	MORRIS AVENUE (SHEET NO. 9)	RHODE AVENUE (SHEET NO. 9)	SPEECHLEY AVENUE (SHEET NO. 10)	SPENCER AVENUE (SHEET NO. 10)	BOHLANDER AVENUE (SHEET NO. 10)	PROSPECT AVENUE (SHEET NO. 11)	ARTHUR AVENUE (SHEET NO. 11)	HERBERT AVENUE (SHEET NO. 11)	MADISON AVE. (SHEET NO. 11)	ATWOOD AVENUE (SHEET NO. 12)
40600300	AGGREGATE (PRIME COAT)	TON	70	4	4	2	4	4	2	2	2	2	4	4	4	4	4	4	4	4	1	3	2	2	3	1
40600400	MIXTURE FOR CRACKS, JOINTS, AND FLANGEWAYS	TON	76	4	4	2	4	4	2	2	2	2	4	5	5	5	5	5	5	5	4	1	3	2	2	3
40603310	HOT-MIX ASPHALT SURFACE COURSE, MIX "C", N50	TON	7608	396	406	188	436	436	167	215	215	216	425	475	510	455	490	482	475	436	92	308	210	215	260	100
40800010	BITUMINOUS MATERIALS (PRIME COAT)	GALLON	6886	353	362	168	387	389	149	192	192	193	498	424	455	402	434	427	419	389	82	275	187	192	230	87
44000157	HOT-MIX ASPHALT SURFACE REMOVAL, 2"	SQ YD	68818	3530	3621	1675	3871	3892	1485	1915	1916	1928	4980	4235	4550	4023	4335	4267	4193	3885	822	2745	1865	1915	2300	870
44201713	CLASS D PATCHES, TYPE I, 6 INCH	SQ YD	688	35	36	17	39	39	15	19	19	19	50	42	46	40	43	43	42	39	8	27	19	19	23	9
44201717	CLASS D PATCHES, TYPE II, 6 INCH	SQ YD	2754	141	145	67	155	156	59	77	77	77	199	169	182	161	173	171	168	155	33	110	75	77	92	35
44201721	CLASS D PATCHES, TYPE III, 6 INCH	SQ YD	2754	141	145	67	155	156	59	77	77	77	199	169	182	161	173	171	168	155	33	110	75	77	92	35
44201723	CLASS D PATCHES, TYPE IV, 6 INCH	SQ YD	688	35	36	17	39	39	15	19	19	19	50	42	46	40	43	43	42	39	8	27	19	19	23	9
60300310	FRAMES AND LIDS TO BE ADJUSTED (SPECIAL)	EACH	185	8	7	3	8	17	7	3	4	5	8	9	16	13	14	9	11	8	2	11	6	4	7	5
60406100	FRAMES AND LIDS, TYPE 1, CLOSED LID	EACH	99	4	5	2	4	6	5	1	1	1	5	7	9	6	6	6	6	6	2	7	3	1	4	2
67100100	MOBILIZATION	L SUM	1	---	---	---	---	---	---	---	---	---	---	---	---	---	---	---	---	---	---	---	---	---	---	---
70102620	TRAFFIC CONTROL AND PROTECTION, STANDARD 701501	L SUM	1	---	---	---	---	---	---	---	---	---	---	---	---	---	---	---	---	---	---	---	---	---	---	---
* 78000400	THERMOPLASTIC PAVEMENT MARKING - LINE 6"	FOOT	2661	154	313	54	150	114	70	112	112	112	212	58	198	54	54	52	100	52	0	74	168	112	336	0
* 78000650	THERMOPLASTIC PAVEMENT MARKING - LINE 24"	FOOT	790	36	73	12	38	36	12	24	24	24	49	36	36	73	73	50	50	36	12	12	36	36	12	0

* SPECIALITY ITEM

PLAN SHEET KEY MAP

NOT TO SCALE

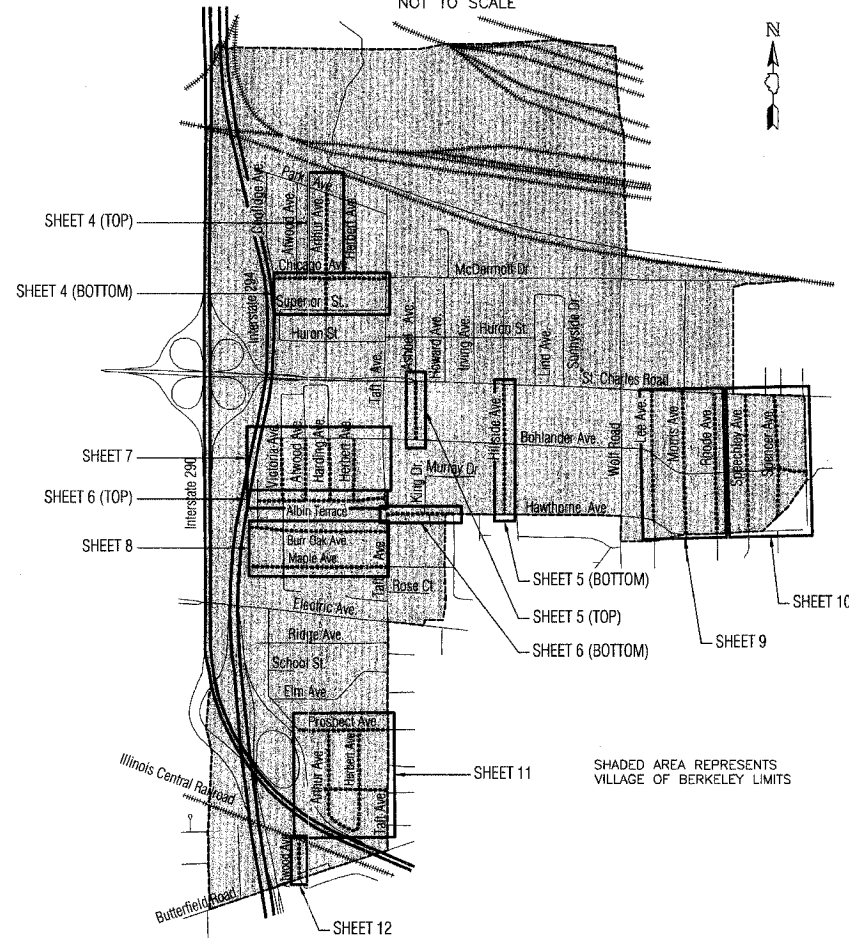

REVISIONS	
NAME	DATE

ILLINOIS DEPARTMENT OF TRANSPORTATION

SUMMARY OF QUANTITIES & KEY MAP

DATE: 2-23-07
CHECKED BY: D.N.M.

.. \1974_Summary_Quantity.dwg[Layout1]
PLOTTED: Friday, 23 Feb 2007 - 10:43am
SAVED: Friday, 23 Feb 2007 - 10:40am

