

F.A.U. RTE.	SECTION	COUNTY	TOTAL SHEETS	SHEET NO.
3869	06-00030-00-FF	MCHENRY	56	1
COVER SHEET				
FED. ROAD DIST. NO. 7 ILLINOIS FED. AID PROJECT M-8003(641)				

**STATE OF ILLINOIS
DEPARTMENT OF TRANSPORTATION
DIVISION OF HIGHWAYS**

**PLANS FOR PROPOSED FEDERAL AID PROJECT
F.A.U. ROUTE 3869 (HALIGUS ROAD)
F.A.P. ROUTE 0339 (ALGONQUIN ROAD) TO REED ROAD
SECTION 06-00030-00-FP
PROJECT NO. M-8003(641)
ROADWAY CONSTRUCTION
AND TRAFFIC SIGNAL INSTALLATION
MCHENRY COUNTY
C-91-350-06**

INDEX OF SHEETS

SHEET NO.	DESCRIPTION
1	COVER SHEET
2-4	GENERAL NOTES AND STATE STANDARDS
5-6	SUMMARY OF QUANTITIES
7	TYPICAL SECTIONS
8	SCHEDULE OF QUANTITIES
9	ALIGNMENT, TIES AND BENCHMARKS
10-19	ROADWAY IMPROVEMENT PLANS
20	INTERSECTION GRADING PLANS
21-22	PAVEMENT MARKING AND SIGNING
23-24	LANDSCAPING AND EROSION CONTROL
25	TEMPORARY TRAFFIC SIGNAL PLAN
26	TEMPORARY CABLE PLAN, SEQUENCES, AND SCHEDULE OF QUANTITIES
27	MAST ARM MOUNTED STREET NAME SIGNS
28-31	TRAFFIC SIGNAL DETAILS
32-33	ROADWAY DETAILS
34	BD-03 OUTLET FOR CONCRETE CURB AND GUTTER
35	BD-08 DETAILS FOR FRAMES AND LIDS ADJUSTMENT WITH MILLING
36	BD-32 BUTT JOINT AND BITUMINOUS TAPER DETAILS
37	TC-10 TRAFFIC CONTROL AND PROTECTION FOR SIDE ROADS, INTERSECTIONS, AND DRIVEWAYS
38	TC-11 TYPICAL APPLICATIONS RAISED REFLECTIVE PAVEMENT MARKERS (SNOW PLOW RESISTANT)
39	TC-13 DISTRICT ONE TYPICAL PAVEMENT MARKINGS
40	TC-22 TEMPORARY INFORMATION SIGNING
41-56	CROSS SECTIONS

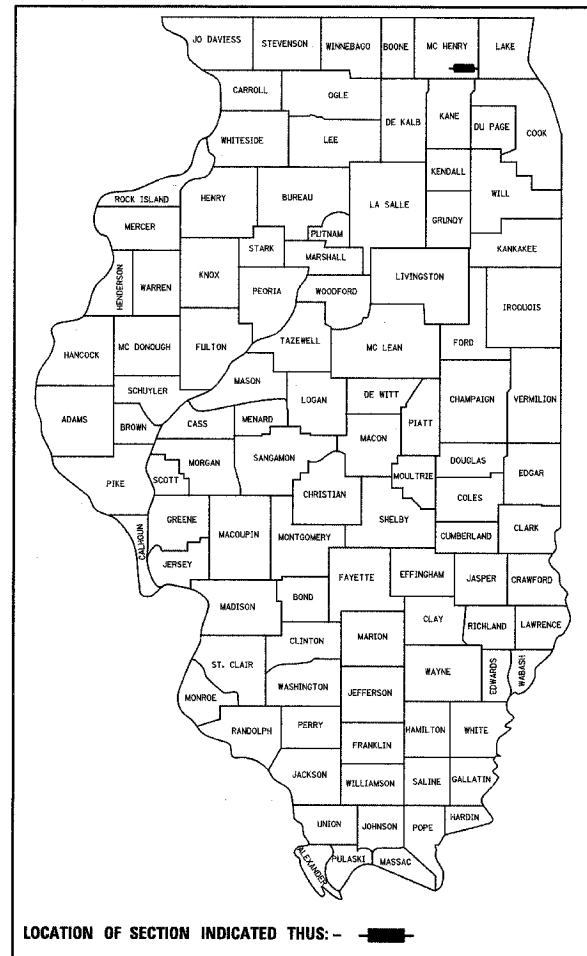

FEDERAL AID ENGINEER: ABIGAIL WILGREEN 847-705-4233 SCHAUMBURG, IL
CONSULTANT ENGINEER: JONATHAN VANA, P.E. CIVILTECH ENGINEERING, INC.

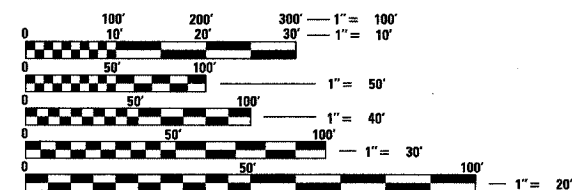

FULL SIZE PLANS HAVE BEEN PREPARED USING STANDARD ENGINEERING SCALES. REDUCED SIZED PLANS WILL NOT CONFORM TO STANDARD SCALES. IN MAKING MEASUREMENTS ON REDUCED PLANS, THE ABOVE SCALES MAY BE USED.

J.U.L.I.E.
JOINT UTILITY LOCATION INFORMATION FOR EXCAVATION
1-800-892-0123

CONTRACT NO. 83919

POSTED SPEEDS:
HALIGUS ROAD - 35 MPH
REED ROAD - 45 MPH

DESIGN SPEEDS:
HALIGUS ROAD - 40 MPH
REED ROAD - 50 MPH

THE "STANDARD SPECIFICATIONS FOR ROAD AND BRIDGE CONSTRUCTION", ADOPTED JANUARY 1, 2007 BY THE ILLINOIS DEPARTMENT OF TRANSPORTATION, SHALL GOVERN THIS WORK.

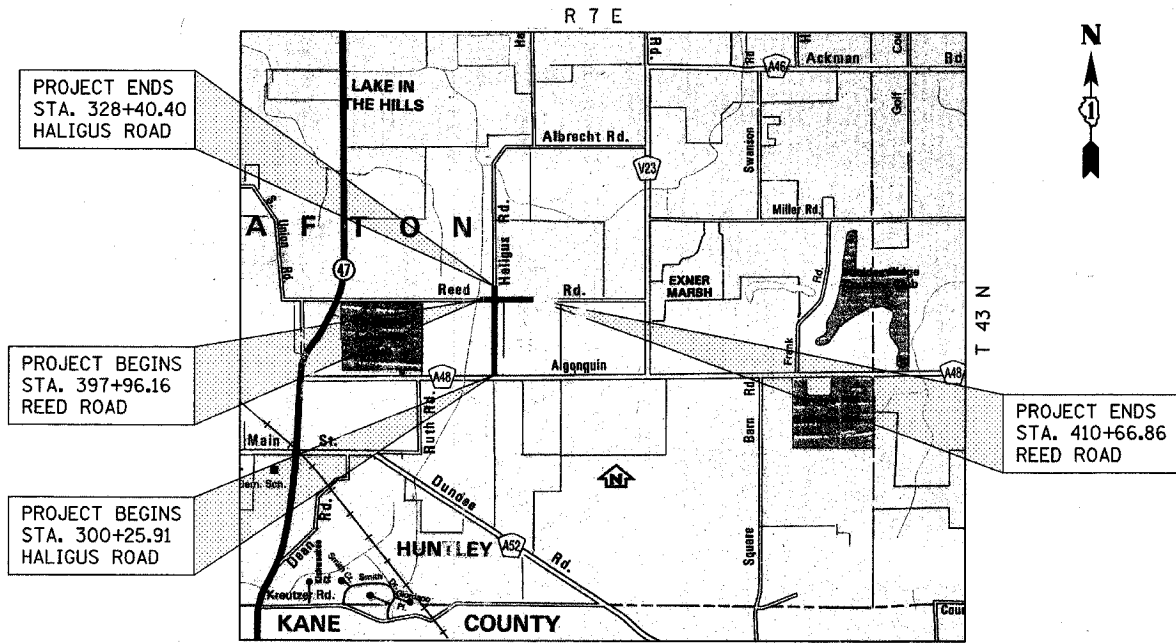

LOCATION MAP
NOT TO SCALE

PROJECT LENGTH:
HALIGUS ROAD - PROJECT LENGTH (NET & GROSS) - 2,814.5 (0.533 MILE)
REED ROAD - PROJECT LENGTH (NET & GROSS) - 1,271 FT. (0.241 MILE)
TOTAL PROJECT LENGTH (NET & GROSS) - 4,085.5 FT. (0.774 MILE)

DESIGN DESIGNATIONS:
HALIGUS ROAD - 5000(2030) • COLLECTOR TWS-2 • 0.41 (FD-20)
REED ROAD - 11000(2030) • COLLECTOR TWS-2 • 0.39 (FD-20)



3-7-07
REGISTERED P.E., STATE OF ILLINOIS

STATE OF ILLINOIS
DEPARTMENT OF TRANSPORTATION
DIVISION OF HIGHWAYS

APPROVED: *Carl Johnson* 2-28-2007
VILLAGE MANAGER, VILLAGE OF HUNTLEY

PASSED: *April 4* 2007
DISTRICT ONE ENGINEER OF LOCAL ROADS & STREETS

RELEASING FOR BID BASED ON LIMITED REVIEW: *April 4 2007* 20
DEPUTY DIRECTOR OF HIGHWAYS, REGION ONE ENGINEER

PLANS PREPARED BY:
CIVILTECH
450 E. Devon Ave, Suite 300 - Itasca, Illinois 60143
Tel: 630.773.3900 - Fax: 630.773.3975
www.civiltechinc.com