

F.A.U. RTE.	SECTION	COUNTY	TOTAL SHEETS	SHEET NO.
3869	06-00030-00-FP	MCHENRY	56	15
STA. 324+00		TO STA. 328+40.40		
FED. ROAD DIST. NO. 7 ILLINOIS FED. AID PROJECT M-8003(64)				

- 40 STA. 399+34.42, 15.75' RT. FRAME AND LID TO BE ADJUSTED (SPECIAL) EXIST. RIM = 884.89 PROP. RIM = 884.80
- 41 STA. 399+59.66, 20.10' RT. V.V. TO BE FILLED
- 42 STA. 400+30.66, 32.90' RT. MH TO BE ADJUSTED (SPECIAL) EXIST. RIM = 884.21 PROP. RIM = 884.56
- 43 STA. 400+68, 36.56' LT. V.V. TO BE RECONSTRUCTED EXIST. RIM = 884.77 PROP. RIM = 884.68 (ROTATE CONE SECTION TO PLACE LID OUTSIDE OF PROPOSED BIKE PATH PAVEMENT)

NOTE:
PRIOR TO PLACING HOT-MIX ASPHALT ADJACENT TO EXISTING PAVEMENT TO REMAIN, THE EXPOSED EDGE SHALL BE CLEANED OF LOOSE MATERIAL TO THE SATISFACTION OF THE ENGINEER. THIS WORK SHALL BE CONSIDERED INCLUDED IN THE COST OF THE HOT-MIX ASPHALT BEING PLACED.

REED ROAD
MATCH LINE STA. 398+50
(SEE SHEET NO. 16)

- NOTES:
- TRANSITION CURB HEIGHT FROM 6" TO 0" OVER 5'. PAID FOR AS "COMBINATION CONCRETE CURB AND GUTTER, TYPE B-6.12".
 - STATION OFFSET CALL-OFFS NOTED WITH (R) ARE DEFINED BY THE REED ROAD ALIGNMENT.
 - ADDITIONAL GUTTER WIDTH FOR STUBS SHALL BE INCLUDED IN THE COST OF "COMB. CONC. CURB AND GUTTER, TYPE B-6.12" OR "P.C.C. SHOULDER, 8". SEE DETAIL SHEET NO. 31.
 - REMOVAL OF THE EXISTING BIKEPATH SHALL BE PAID FOR AS "BITUMINOUS BIKE PATH REMOVAL".
 - REMOVAL OF THE EXISTING DETECTABLE WARNINGS SHALL BE PAID FOR AS "SIDEWALK REMOVAL".
 - RELOCATION OF THE EXISTING LIGHTING UNIT MUST BE COMPLETED THE SAME DAY. ALL LIGHTING MUST BE OPERATIONAL THAT SAME EVENING.
 - THE EXISTING METAL FOUNDATION SHALL BE REUSED FOR THE RELOCATED LIGHTING UNIT. THE COST TO REMOVE AND REINSTALL THE METAL FOUNDATION SHALL BE INCLUDED IN THE PAY ITEM "RELOCATE EXISTING LIGHTING UNIT".

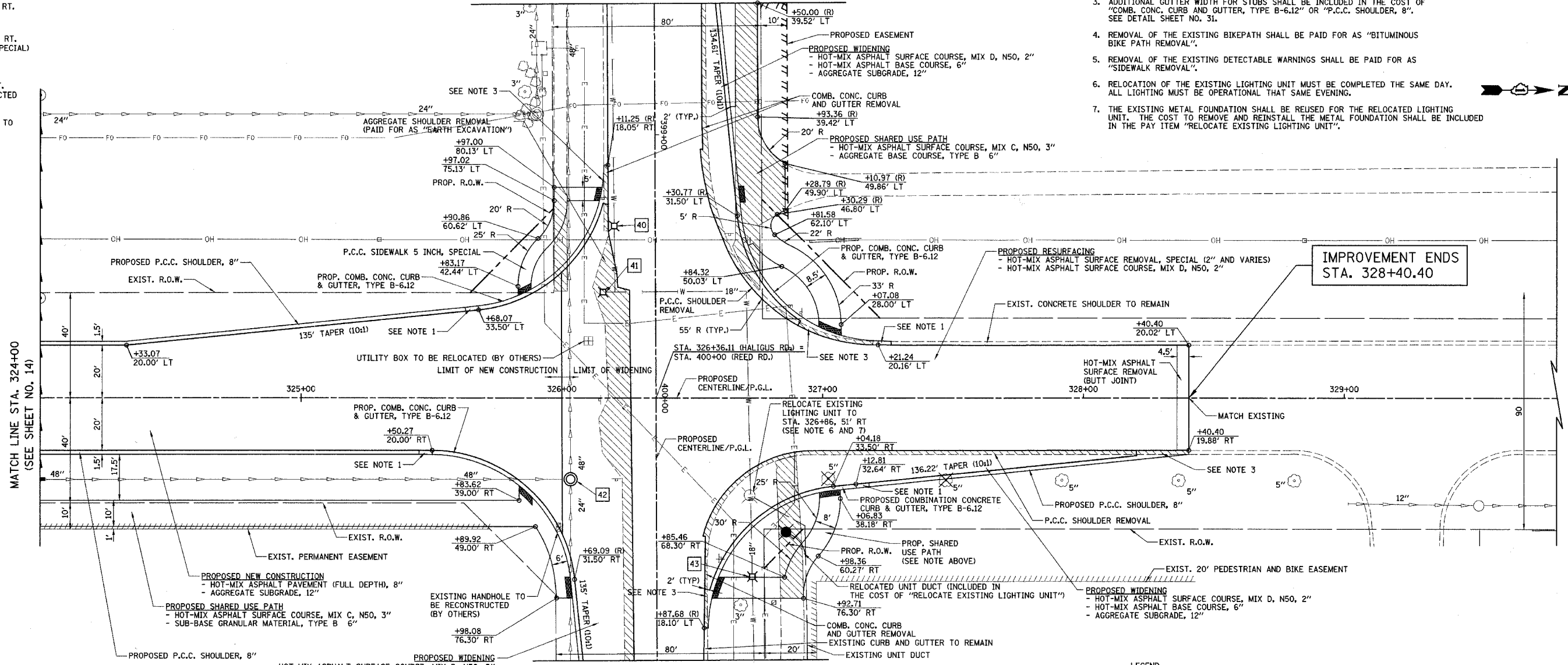

REED ROAD
MATCH LINE STA. 401+00 (SEE SHEET NO. 17)

LEGEND
REMOVAL
HALIGUS ROAD

IMPROVEMENT ENDS STA. 328+40.40

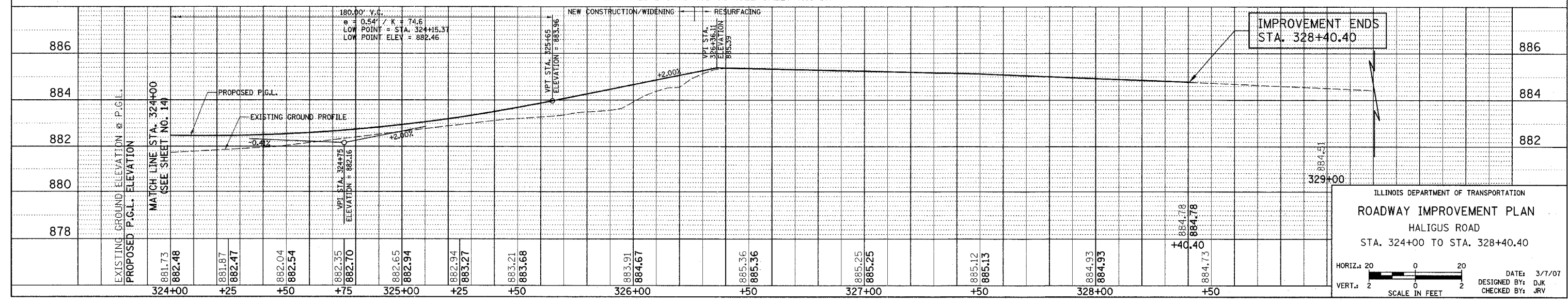

ILLINOIS DEPARTMENT OF TRANSPORTATION
ROADWAY IMPROVEMENT PLAN
HALIGUS ROAD
STA. 324+00 TO STA. 328+40.40

HORIZ. 1" = 20'
VERT. 1" = 2'

DATE: 3/7/07
DESIGNED BY: DJK
CHECKED BY: JRV