

F.A. RTE.	SECTION	COUNTY	TOTAL SHEETS	SHEET NO.
---	D6-00062-00-RS	COOK	41	7
STA. 10+00.00		TO STA. 21+00.00		
FED. ROAD DIST. NO.		ILLINOIS	FED. AID PROJECT	
CONTRACT NO. 83920				

DATE	BY	PLAN
		SURVEYED
		PLOTTED
		CHECKED
		NOTED
		NO. _____
		NOTE BOOK NO. _____
		ADD FILE NAME _____

CHRISTOPHER B. BURKE ENGINEERING LTD.
 9575 West Higgins Road, Suite 600
 Rosemont, Illinois 60018
 (847) 823-0500

DATE	BY	PROFILE
		REVISED
		PLOTTED
		CHECKED
		NOTED
		NO. _____
		NOTE BOOK NO. _____
		STRUCTURE NOTATION CONTOUR

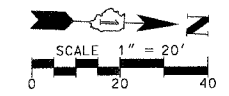
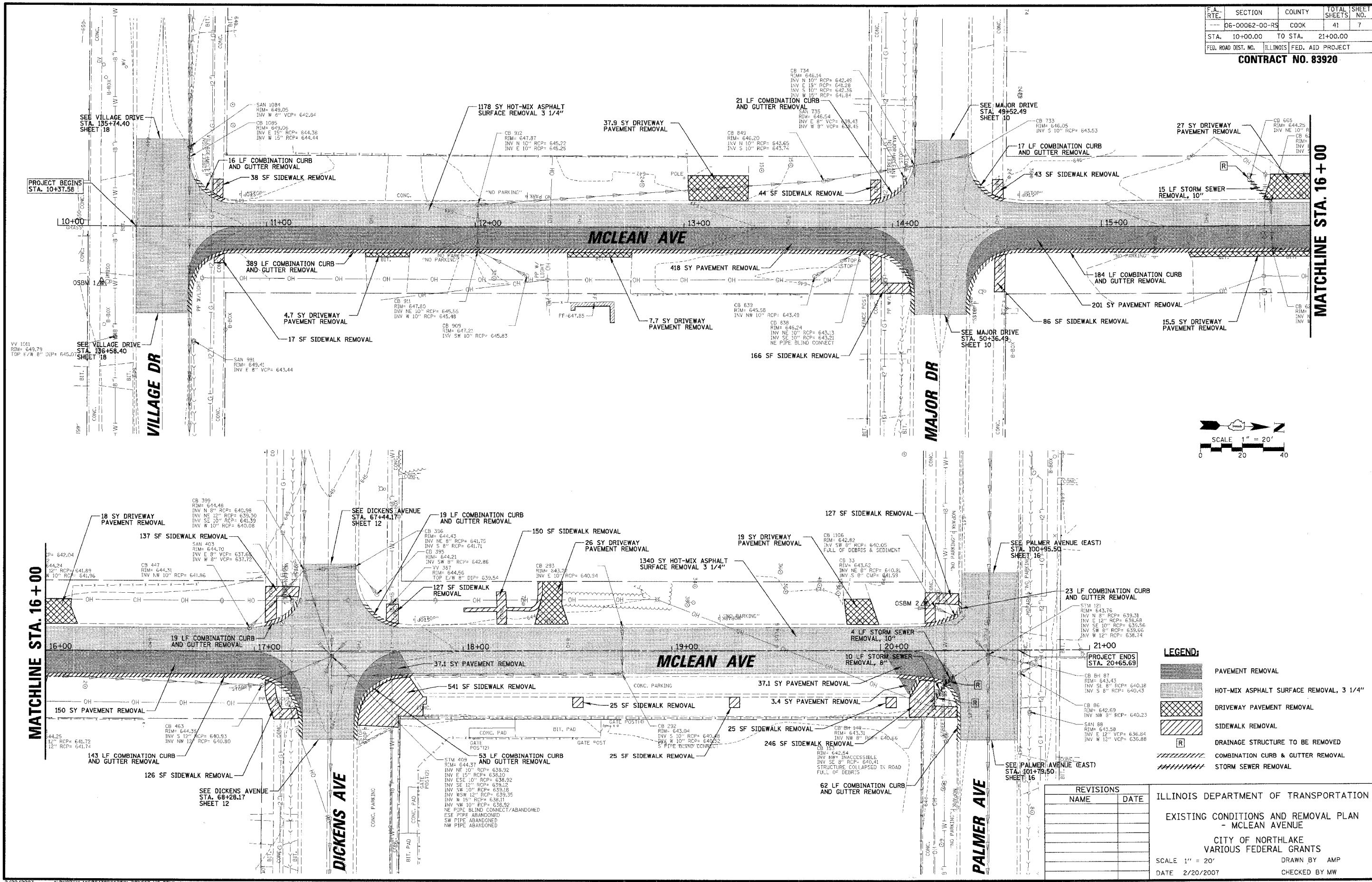

LEGEND:

	PAVEMENT REMOVAL
	HOT-MIX ASPHALT SURFACE REMOVAL, 3 1/4"
	DRIVEWAY PAVEMENT REMOVAL
	SIDEWALK REMOVAL
	DRAINAGE STRUCTURE TO BE REMOVED
	COMBINATION CURB & GUTTER REMOVAL
	STORM SEWER REMOVAL

REVISIONS	
NAME	DATE

ILLINOIS DEPARTMENT OF TRANSPORTATION
 EXISTING CONDITIONS AND REMOVAL PLAN
 - MCLEAN AVENUE
 CITY OF NORTHLAKE
 VARIOUS FEDERAL GRANTS
 SCALE 1" = 20'
 DATE 2/20/2007
 DRAWN BY AMP
 CHECKED BY MW