

INDEX OF SHEETS

- 1 COVER SHEET, STANDARDS, & SUMMARY OF QUANTITIES
- 2 TYPICAL CROSS-SECTIONS & RUMBLE STRIP DETAIL
- 3 TRANSITION AT BRIDGES, END TAPER, AND SIDE ROAD DETAILS
- 4 ENTRANCE DETAILS
- 5 CH14/CH17 INTERSECTION DETAILS
- 6 SCHEDULE OF RESURFACING QUANTITIES

STATE OF ILLINOIS
DEPARTMENT OF TRANSPORTATION
LIVINGSTON COUNTY
PLANS FOR

PROPOSED LOCAL AGENCY IMPROVEMENT
SURFACE TRANSPORTATION PROGRAM

F.A.S. ROUTE 1354, CH 14, SECTION 02-00122-00-RS
MISSAL ROAD
PROJECT NO. SR-1354(104)
JOB NO. C-93-056-06

ROUTE NO.	SECTION	COUNTY	TOTAL SHEETS	SHEET NO.
1354	02-00122-00-RS	LIVINGSTON	6	1

PROJECT NO. SR-1354(104)

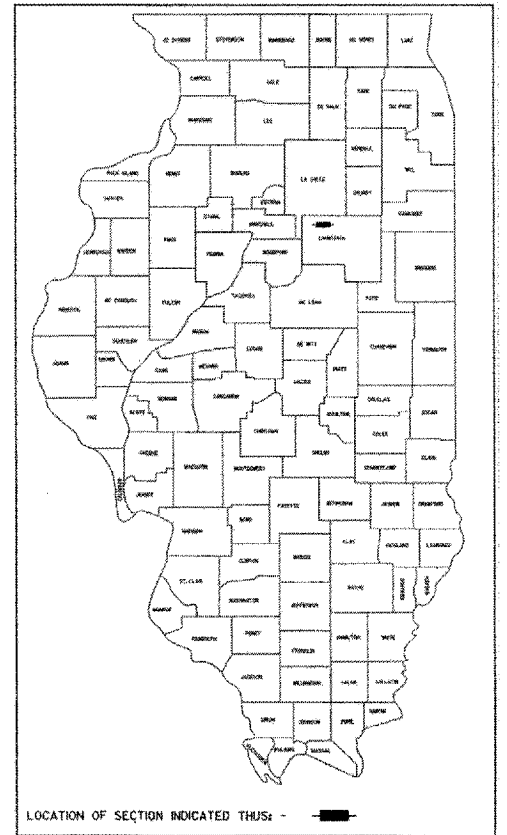

SUMMARY OF QUANTITIES		CONST. CODE I000	
ITEM NO.	ITEM	UNIT	QUANTITIES
20200100	EARTH EXCAVATION	CU YD	250.0
35100100	AGGREGATE BASE COURSE, TYPE A	TON	90.0
35600900	HOT-MIX ASPHALT BASE COURSE WIDENING	TON	118.0
40600100	BITUMINOUS MATERIALS (PRIME COAT)	GALLON	4,159.0
40600300	AGGREGATE (PRIME COAT)	TON	155.0
40600625	LEVELING BINDER (MACHINE METHOD), N50	TON	3,335.0
40603080	HOT-MIX ASPHALT BINDER COURSE, IL-19.0, N50	TON	4,249.0
40603310	HOT-MIX ASPHALT SURFACE COURSE, MIX "C", N50	TON	6,881.0
40800010	BITUMINOUS MATERIALS (PRIME COAT)	GALLON	322.0
40800050	INCIDENTAL HOT-MIX ASPHALT SURFACING	TON	243.0
* 44000198	HOT-MIX ASPHALT SURFACE REMOVAL, VARIABLE DEPTH	SQ YD	1,198.0
44201735	CLASS D PATCHES, TYPE IV, 7 INCH	SQ YD	347.0
44300100	AREA REFLECTIVE CRACK CONTROL TREATMENT	SQ YD	78,605.0
48101200	AGGREGATE SHOULDERS, TYPE B	TON	5,878.0
* 67100100	MOBILIZATION	L SUM	1.0
* 70101800	TRAFFIC CONTROL AND PROTECTION (SPECIAL)	L SUM	1.0
70300100	SHORT-TERM PAVEMENT MARKING	FOOT	6,638.0
70301000	WORK ZONE PAVEMENT MARKING REMOVAL	SQ FT	1,108.0
△ 78001100	PAINT PAVEMENT MARKING - LETTERS AND SYMBOLS	SQ FT	122.4
△ 78001110	PAINT PAVEMENT MARKING - LINE 4"	FOOT	15,061.0
△ 78001180	PAINT PAVEMENT MARKING - LINE 24"	FOOT	44.0
* 20048665	RAILROAD PROTECTIVE LIABILITY INSURANCE	L SUM	1.0
* 20055300	RUMBLE STRIP	EACH	4.0

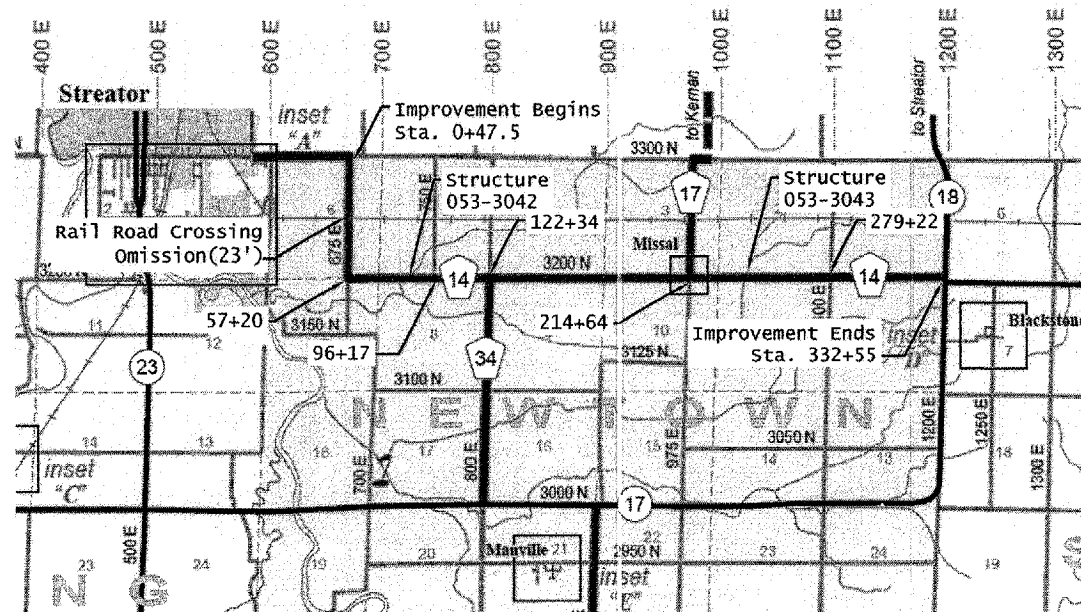

GROSS LENGTH = 33,207.5' = 6.29 MILES
NET LENGTH = 33,184.5' = 6.28 MILES

SCALE(MILES)

THIS PROJECT CONSISTS OF BITUMINOUS CONCRETE BINDER COURSE, SUPERPAVE, IL-19.0, N50, BITUMINOUS CONCRETE SURFACE COURSE, SUPERPAVE, MIX "C", N50, AND AGGREGATE SHOULDERS BEGINNING AT A POINT NEAR THE INTERSECTION OF COUNTY HIGHWAY 14 AND 3300N (12th ST.), EAST OF STREATOR, ILLINOIS AND EXTENDING IN A SOUTHERLY DIRECTION TO THE INTERSECTION OF 3200N, THENCE EASTERLY TO A POINT NEAR THE INTERSECTION OF ILLINOIS ROUTE 18 (1200E).

"THE ACCEPTANCE OF THIS PROJECT IS BASED ON THE MINIMUM DESIGN CRITERIA UNDER 3R GUIDELINES."

* SEE SPECIAL PROVISIONS

△ SPECIALTY ITEMS

UTILITIES

CONTACT J.U.L.I.E. 800-892-0123 BEFORE DIGGING

STATE STANDARDS DETAILS

701201-02	701311-02	BLR 22-4
701301-02	702001-06	BLR 24-1
701306-01	BLR 21-6	780001-01

MISSAL ROAD - COLLECTOR
POSTED SPEED = 55 MPH-RURAL
DESIGN SPEED = 50 MPH-RURAL
DESIGN ADT= 800/ YR 2022
CLASS III ROADS, 80,000# DESIGN (E. 2 1/2 mi.),
15 YEAR D.P.

SCALE APPLIES TO SHEET 5 ONLY
REMAINING SHEETS ARE NOT TO SCALE

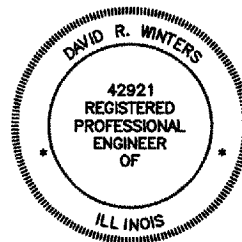

THESE PLANS WERE MADE BY ME OR BY A MEMBER OF MY STAFF WORKING UNDER MY PERSONAL SUPERVISION.

03/23/07 DATE
COUNTY ENGINEER, P.E. NO. 42921
EXPIRATION DATE 11/30/2007

APPROVED 03/23 20 07
David R. Winters
LIVINGSTON COUNTY OFFICIAL

PASSED 03-29 20 07
Bennett R. [Signature]
DISTRICT ENGINEER OF LOCAL ROADS & STREETS

APPROVED 03-29 20 07
George F. Ryan
DEPUTY DIRECTOR OF HIGHWAYS, REGIONAL ENGINEER

STATE OF ILLINOIS
DEPARTMENT OF TRANSPORTATION