

INDEX OF SHEETS

- 1 COVER SHEET, STANDARDS, & SUMMARY OF QUANTITIES
- 2 TYPICAL CROSS-SECTIONS & RUMBLE STRIP DETAIL
- 3 TRANSITION AT BRIDGES, END TAPER, AND SIDE ROAD DETAILS
- 4 ENTRANCE DETAILS
- 5 CH14/CH17 INTERSECTION DETAILS
- 6 SCHEDULE OF RESURFACING QUANTITIES

STATE OF ILLINOIS
DEPARTMENT OF TRANSPORTATION
LIVINGSTON COUNTY
PLANS FOR

PROPOSED LOCAL AGENCY IMPROVEMENT
SURFACE TRANSPORTATION PROGRAM

F.A.S. ROUTE 1354, CH 14, SECTION 02-00122-00-RS
MISSAL ROAD
PROJECT NO. SR-1354(104)
JOB NO. C-93-056-06

ROUTE NO.	SECTION	COUNTY	TOTAL SHEETS	SHEET NO.
1354	02-00122-00-RS	LIVINGSTON	6	1

PROJECT NO. SR-1354(104)

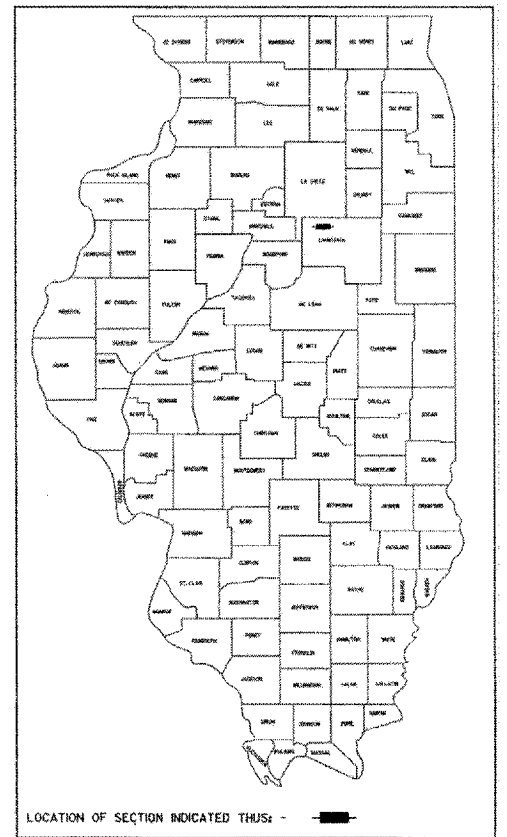

LOCATION OF SECTION INDICATED THUS: [Symbol]

SUMMARY OF QUANTITIES		CONST. CODE I000	
ITEM NO.	ITEM	UNIT	QUANTITIES
20200100	EARTH EXCAVATION	CU YD	250.0
35100100	AGGREGATE BASE COURSE, TYPE A	TON	90.0
35600900	HOT-MIX ASPHALT BASE COURSE WIDENING	TON	118.0
40600100	BITUMINOUS MATERIALS (PRIME COAT)	GALLON	4,159.0
40600300	AGGREGATE (PRIME COAT)	TON	155.0
40600625	LEVELING BINDER (MACHINE METHOD), N50	TON	3,335.0
40603080	HOT-MIX ASPHALT BINDER COURSE, IL-19.0, N50	TON	4,249.0
40603310	HOT-MIX ASPHALT SURFACE COURSE, MIX "C", N50	TON	6,881.0
40800010	BITUMINOUS MATERIALS (PRIME COAT)	GALLON	322.0
40800050	INCIDENTAL HOT-MIX ASPHALT SURFACING	TON	243.0
* 44000198	HOT-MIX ASPHALT SURFACE REMOVAL, VARIABLE DEPTH	SQ YD	1,198.0
44201735	CLASS D PATCHES, TYPE IV, 7 INCH	SQ YD	347.0
44300100	AREA REFLECTIVE CRACK CONTROL TREATMENT	SQ YD	78,605.0
48101200	AGGREGATE SHOULDERS, TYPE B	TON	5,878.0
* 67100100	MOBILIZATION	L SUM	1.0
* 70101800	TRAFFIC CONTROL AND PROTECTION (SPECIAL)	L SUM	1.0
70300100	SHORT-TERM PAVEMENT MARKING	FOOT	6,638.0
70301000	WORK ZONE PAVEMENT MARKING REMOVAL	SQ FT	1,108.0
△ 78001100	PAINT PAVEMENT MARKING - LETTERS AND SYMBOLS	SQ FT	122.4
△ 78001110	PAINT PAVEMENT MARKING - LINE 4"	FOOT	15,061.0
△ 78001180	PAINT PAVEMENT MARKING - LINE 24"	FOOT	44.0
* 20048665	RAILROAD PROTECTIVE LIABILITY INSURANCE	L SUM	1.0
* 20055300	RUMBLE STRIP	EACH	4.0

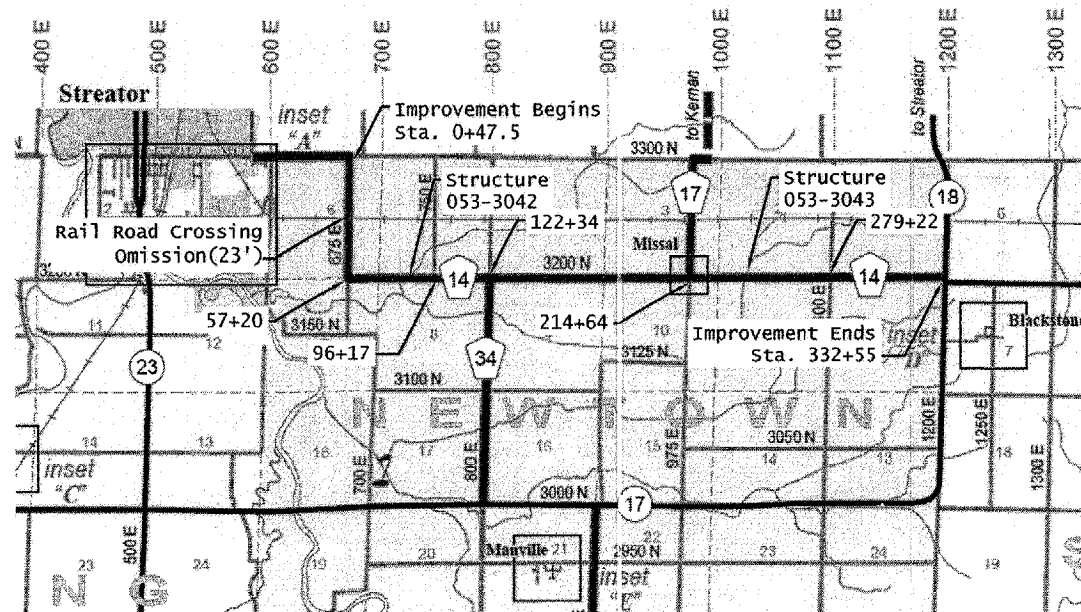

GROSS LENGTH = 33,207.5' = 6.29 MILES
NET LENGTH = 33,184.5' = 6.28 MILES

0 1 2 3 4
SCALE(MILES)

THIS PROJECT CONSISTS OF BITUMINOUS CONCRETE BINDER COURSE, SUPERPAVE, IL-19.0, N50, BITUMINOUS CONCRETE SURFACE COURSE, SUPERPAVE, MIX "C", N50, AND AGGREGATE SHOULDERS BEGINNING AT A POINT NEAR THE INTERSECTION OF COUNTY HIGHWAY 14 AND 3300N (12th ST.), EAST OF STREATOR, ILLINOIS AND EXTENDING IN A SOUTHERLY DIRECTION TO THE INTERSECTION OF 3200N, THENCE EASTERLY TO A POINT NEAR THE INTERSECTION OF ILLINOIS ROUTE 18 (1200E).

"THE ACCEPTANCE OF THIS PROJECT IS BASED ON THE MINIMUM DESIGN CRITERIA UNDER 3R GUIDELINES."

* SEE SPECIAL PROVISIONS

△ SPECIALTY ITEMS

UTILITIES

CONTACT J.U.L.I.E. 800-892-0123 BEFORE DIGGING

STATE STANDARDS DETAILS

701201-02	701311-02	BLR 22-4
701301-02	702001-06	BLR 24-1
701306-01	BLR 21-6	780001-01

MISSAL ROAD - COLLECTOR
POSTED SPEED = 55 MPH-RURAL
DESIGN SPEED = 50 MPH-RURAL
DESIGN ADT= 800/ YR 2022
CLASS III ROADS, 80,000# DESIGN (E. 2 1/2 mi.),
15 YEAR D.P.

0 10 20 30
SCALE APPLIES TO SHEET 5 ONLY
REMAINING SHEETS ARE NOT TO SCALE

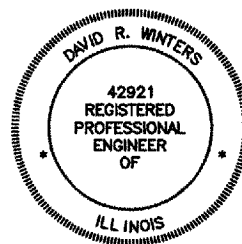

THESE PLANS WERE MADE BY ME OR BY A MEMBER OF MY STAFF WORKING UNDER MY PERSONAL SUPERVISION.

03/23/07 [Signature]
DATE COUNTY ENGINEER, P.E. NO. 42921
EXPIRATION DATE 11/30/2007

APPROVED 03/23 20 07
[Signature]
LIVINGSTON COUNTY OFFICIAL

PASSED 03-29 20 07
[Signature]
DISTRICT ENGINEER OF LOCAL ROADS & STREETS

APPROVED 03-29 20 07
[Signature]
DEPUTY DIRECTOR OF HIGHWAYS, REGIONAL ENGINEER

STATE OF ILLINOIS
DEPARTMENT OF TRANSPORTATION

NOT PLOTTED TO SCALE

ROUTE NO.	SECTION	COUNTY	TOTAL SHEETS	SHEET NO.
1354	02-00122-00-RS	LIVINGSTON	6	2

PROJECT NO. SR-1354(104)

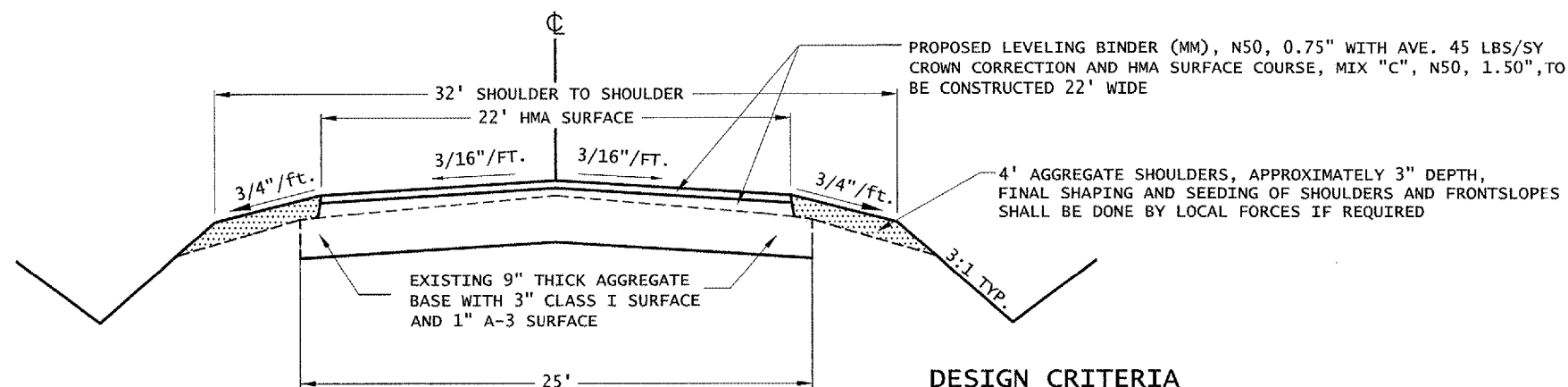

TYPICAL CROSS SECTION (NTS)

Sta. 0+47.5 to 213+50 (FAS RTE 1354)
(See Sht. 3 for Transition & Taper Details)

DESIGN CRITERIA

STRUCTURAL DESIGN TRAFFIC (S.D.T.): 73,280#, CLASS III
BLR MANUAL, CHAPTER 37-8.05(c) - A PAVEMENT DESIGN IS NOT REQUIRED IF STRUCTURAL LEVEL IS NOT BEING UPGRADED

PAVEMENT STRUCTURAL MATERIALS:

TYPE	DEPTH	a
EXISTING 9" AGGREGATE TY. B-CRUSHED	9"	0.08
EXISTING A-3 SURFACE	1"	0.15
EXISTING CLASS I SURFACE	3"	0.30
NEW LEVEL BINDER (MM), N50	3/4"	0.40
NEW HMA SURFACE, MIX "C", N50	1 1/2"	0.40

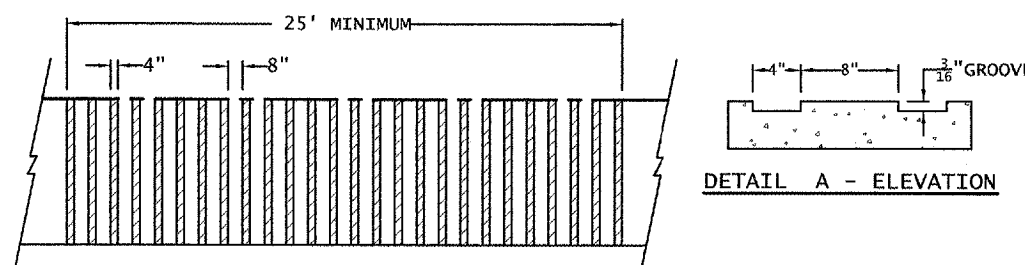
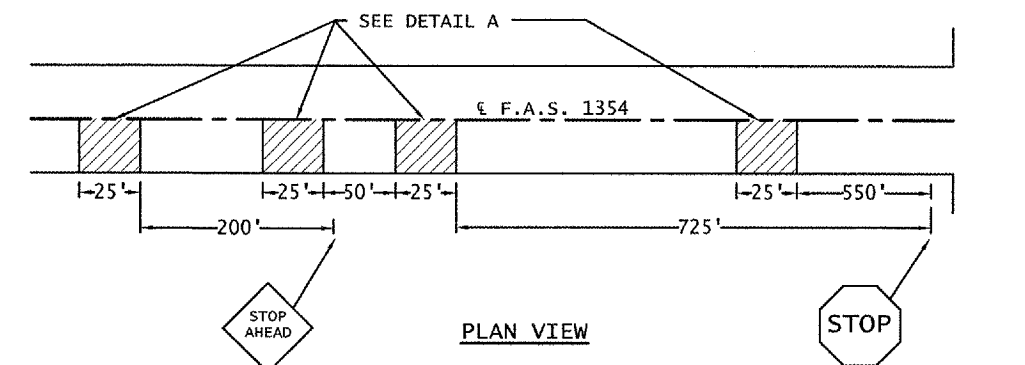

DETAIL A - PLAN VIEW

GROOVED RUMBLE STRIP APPLICATION (NTS)
IN ADVANCE OF 675E INTERSECTION

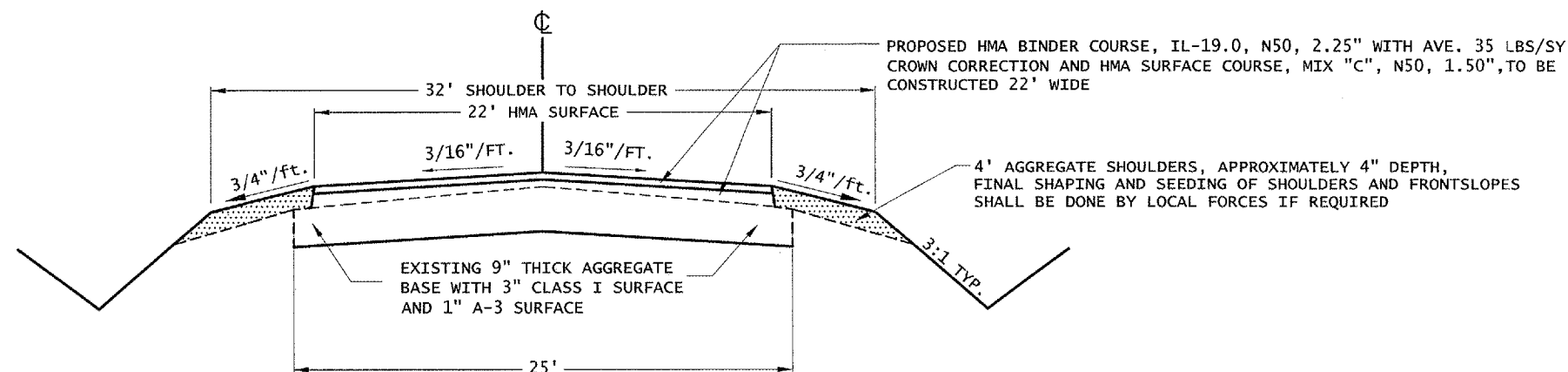

TYPICAL CROSS SECTION (NTS)

Sta. 213+50 to 332+55 (FAS RTE 1354)
(See Sht. 3 for Transition & Taper Details)

DESIGN CRITERIA

STRUCTURAL DESIGN TRAFFIC (S.D.T.): 80,000#, CLASS III
YEAR 2015: PV 748, SU 60, MU 43
MINIMUM SOIL SUPPORT: IBR = 3.00
T.F. = 0.172; Dt = 3.1

PAVEMENT STRUCTURAL MATERIALS:

TYPE	DEPTH	a
EXISTING 9" AGGREGATE TY. B-CRUSHED	9"	0.08
EXISTING A-3 SURFACE	1"	0.15
EXISTING CLASS I SURFACE	3"	0.30
NEW HMA BINDER, N50	2 1/4"	0.32
NEW HMA SURFACE, N50	1 1/2"	0.40

SCHEDULE OF PAINT PAVEMENT MARK 4"			
LOCATION STATION TO STATION	NO PASSING ZONE		SKIP DASH
	WBL	EBL	¢
BEGIN CH 14			
+48 to 24+93			611
24+93 to 29+93		500	125
29+93 to 30+33			10
30+33 to 35+31	498		125
35+31 to 202+62			4,183
202+62 to 212+73		1,011	253
212+73 to 224+14	1,141	1,141	
224+14 to 234+39	1,025		256
234+39 to 285+71			1,283
285+71 to 295+51		980	245
295+51 to 297+73			56
297+73 to 305+20	747		187
305+20 to 332+55			684
END CH 14			
TOTALS	3,411	3,632	8,018
TOTAL PAY QUANTITY		15,061	FOOT
RR Symbols & 24" Stripes		SQ FT	FOOT
78001100 - PT PVT MK LTRS & SYMB		122.4	
78001180 - PAINT PVT MK LINE 24			44

ROUTE NO.	SECTION	COUNTY	TOTAL SHEETS	SHEET NO.
1354	02-00122-00-RS	LIVINGSTON	6	3

PROJECT NO. SR-1354(104)

NOT PLOTTED TO SCALE

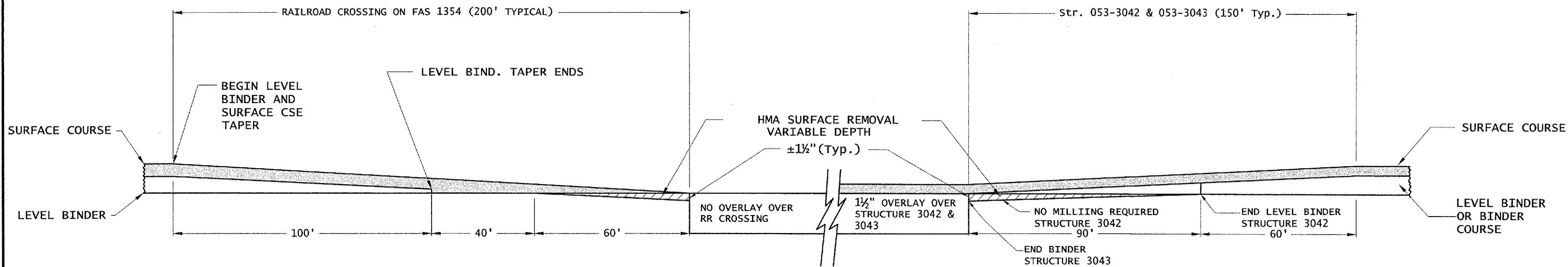

TRANSITION DETAIL AT BRIDGES AND RAILROAD CROSSING (NTS)

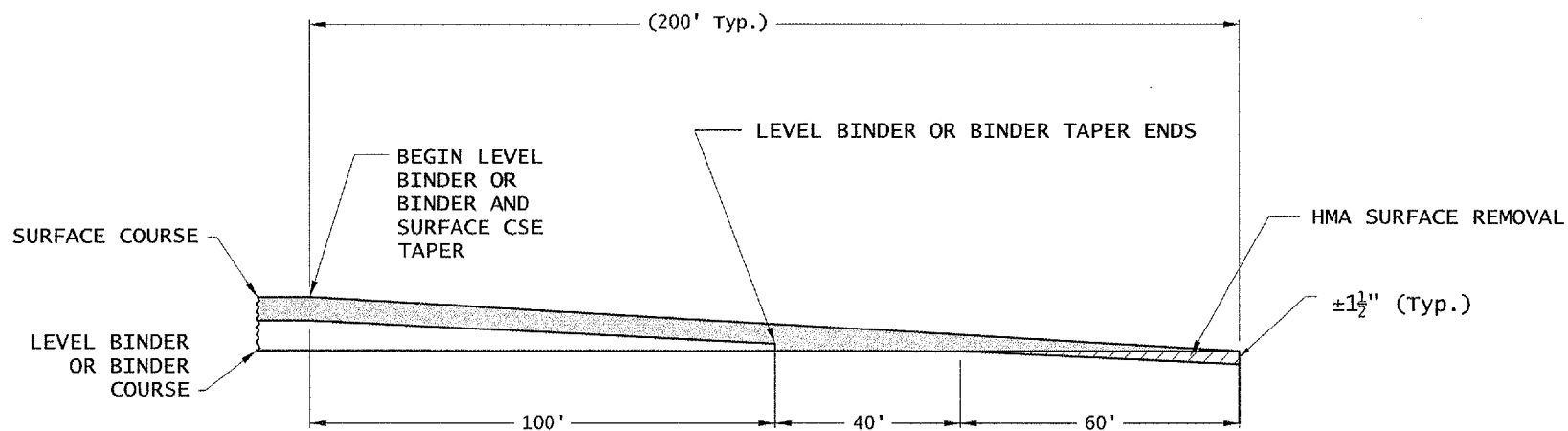

BEGINNING & ENDING TAPER (NTS)

Sta. 0+47.5 TO 2+47.5 (FAS RTE. 1354)
Sta. 330+55 TO 332+55 (FAS RTE. 1354)

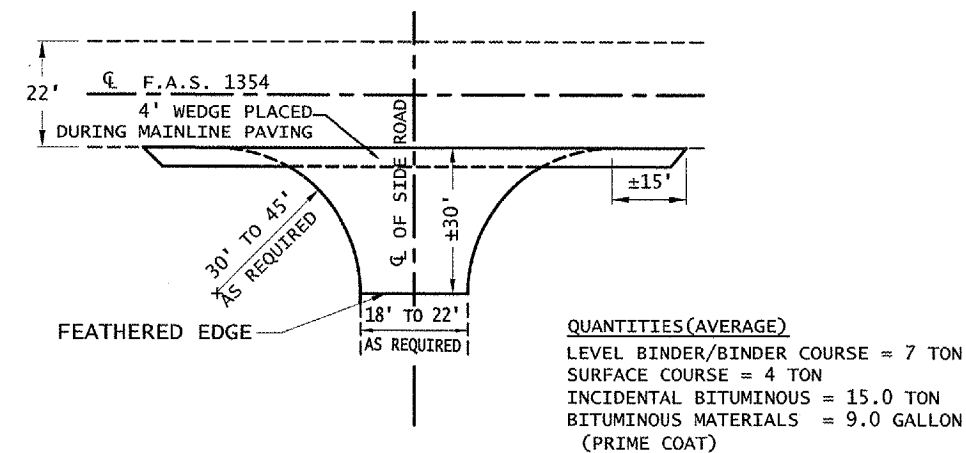

QUANTITIES(AVERAGE)
LEVEL BINDER/BINDER COURSE = 7 TON
SURFACE COURSE = 4 TON
INCIDENTAL BITUMINOUS = 15.0 TON
BITUMINOUS MATERIALS = 9.0 GALLON
(PRIME COAT)

TYPICAL SIDE ROAD INTERSECTION (NTS)

STA. 57+20 RT. (675E) STA. 96+17 LT. (750E)
STA. 122+34 LT. + RT. (800E) STA. 214+64 RT. (975E)
STA. 279+22 LT. + RT. (1100E)

ROUTE NO.	SECTION	COUNTY	TOTAL SHEETS	SHEET NO.
1354	02-00122-00-RS	LIVINGSTON	6	4

PROJECT NO. SR-1354(104)

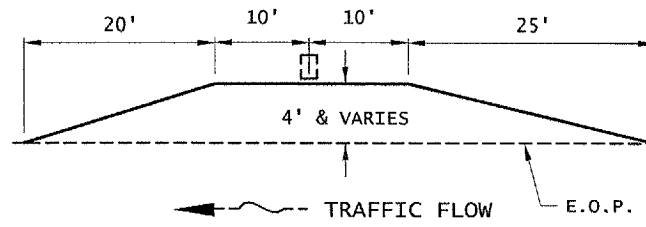

NOT PLOTTED TO SCALE

MAILBOX TURNOUT DETAIL (PLACED DURING MAINLINE PAVING) (NTS)

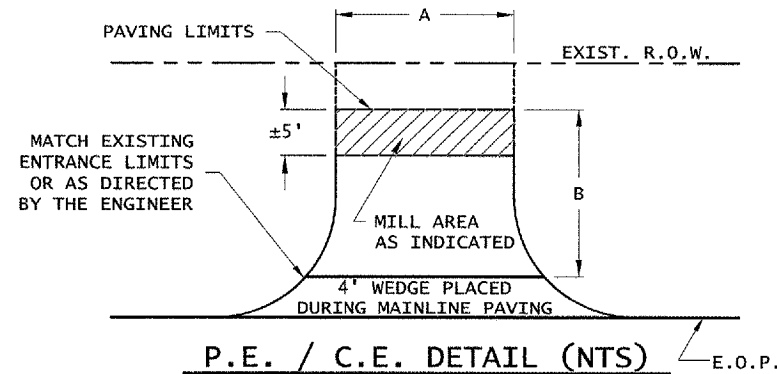

P.E. / C.E. DETAIL (NTS)

FOR QUANTITIES SEE CHART BELOW

LOCATION	WIDTH	LENGTH	AREA
STA. 301+66 TO 302+96 RT	9'	130'	130 SY
STA. 313+03 TO 315+47 LT	8'	244'	217 SY
TOTAL =			347 SY

CLASS D PATCH SCHEDULE

MISSAL RD./CH 14 - ENTRANCE QUANTITIES

TYPE	STATION	A(Ft.)	B(Ft.)	AREA (S.Y.)	MILLING (S.Y.)	BIT. MAT. PRIME(MC-30)	BIT. MAT. PRIME(RC-70)	LEVEL BINDER	BINDER COURSE	SURFACE COURSE	INCID. BIT.
CE	40+30(L)	15	15	25		9		1		1	6
PE	42+90(L)	12	17	23	7	9	1	1		1	6
MBTO	76+30(L)	65	4	19		7		3		3	
PE	76+33(R)	10	15	17	6	6	1	1		1	4
PE	77+47(R)	10	15	17	6	6	1	1		1	4
PE	84+47(R)	10	15	17		6		1		1	4
MBTO	84+50(L)	65	4	19		7		3		3	
PE	161+06(L)	10	4	4		2		1		1	1
PE	216+82(L)	11	4	5		2			1	1	2
MBTO	216+85(R)	65	4	19		7			3	3	
PE	235+70(R)	12	15	20		7			1	1	5
PE	266+89(L)	14	15	23		9			1	1	6
MBTO & PE	291+38(L)	65	15	28		10			4	3	7
MBTO & PE	296+66(R)	65	15	28	9	10	1		4	3	7
MBTO & PE	304+00(L)	65	15	28		10			4	3	7
MBTO & PE	311+55(R)	65	15	28		10			4	3	7
MBTO & PE	315+50(R)	65	15	28		10			4	3	7
PE	317+46(R)	12	15	20		7			1	1	5
TOTALS					28	134	4	12	27	34	78

Z:\COWork\ROAD Projects\00122RS-Missal\Planning\Plans.dwg, 3/23/2007 4:17:08 PM

ROUTE NO.	SECTION	COUNTY	TOTAL SHEETS	SHEET NO.
1354	02-00122-00-RS	LIVINGSTON	6	5

PROJECT NO. SR-1354(104)

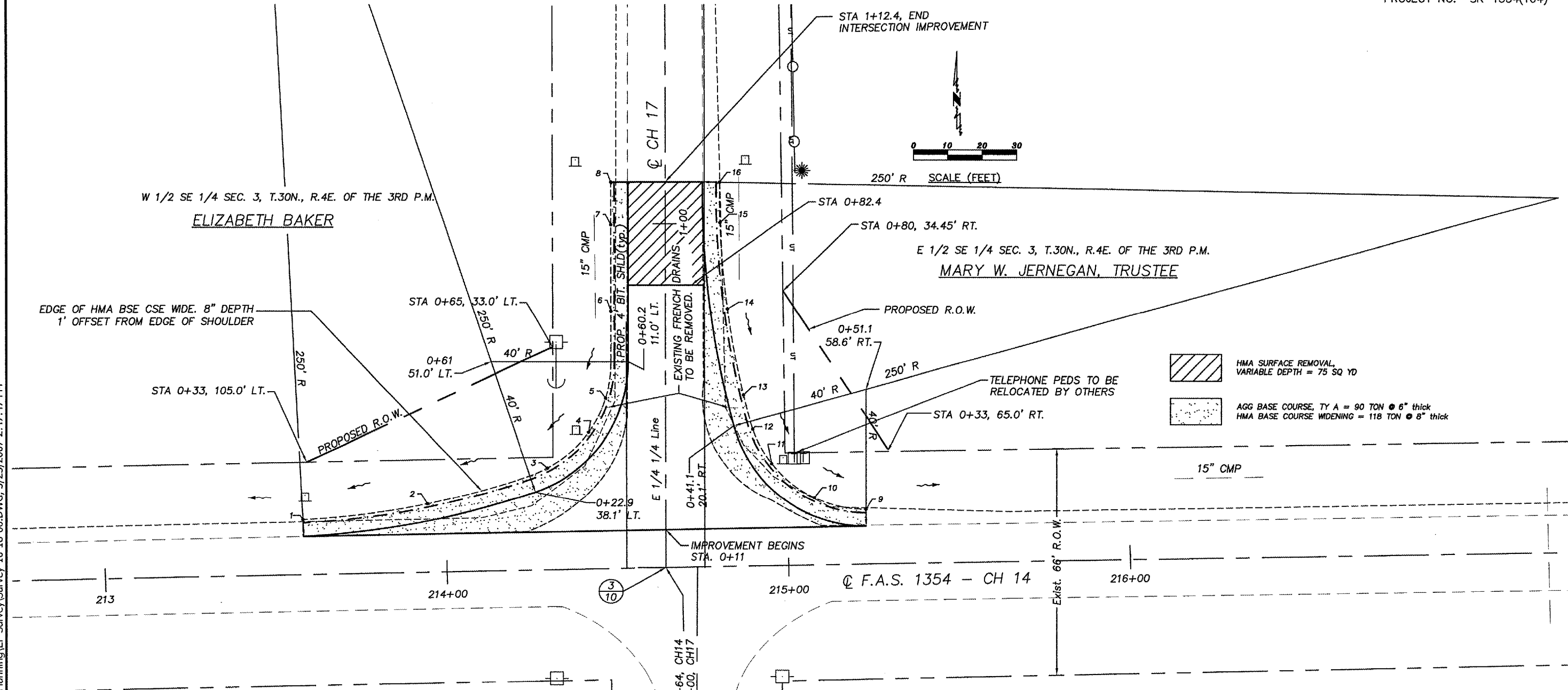

- HMA SURFACE REMOVAL, VARIABLE DEPTH = 75 SQ YD
- AGG BASE COURSE, TY A = 90 TON @ 6" thick
HMA BASE COURSE WIDENING = 118 TON @ 8" thick

CONTROL INFORMATION

BM = RR SPIKE IN PP, 25.4' RT. STA. -1+11.2 EL. 95.91

CP #1 = IRON ROD 28.9' LT. STA. -0+30.9

CP #2 = PK NAIL 0.0' RT. STA. -3+20.2

CP #3 = IRON ROD 14.4' RT. STA. 2+36.1

EDGE OF PAVED SHOULDER POINTS

POINT NUMBER	C.H. 17 CENTERLINE			
	STATION	OFFSET	ELEVATION	CL ELEV.
1	0+15	106.1 LT	96.47	97.92
2	0+20	69.8 LT.	96.91	97.90
3	0+30	34.6 LT	97.36	98.00
4	0+40	22.6 LT	97.71	98.14
5	0+50	17.6 LT	98.00	98.34
6	0+75	16.0 LT	98.35	98.65
7	1+00	16.0 LT	98.65	98.95
8	1+11	16.0 LT	98.67	98.97
9	0+15	68.6 RT	97.80	97.92
10	0+20	43.5 RT	97.70	97.90
11	0+30	31.1 RT	97.50	98.00
12	0+40	25.6 RT	97.64	98.14
13	0+50	22.9 RT	97.90	98.34
14	0+75	18.2 RT	98.31	98.65
15	1+00	16.1 RT	98.65	98.95
16	1+11	16.0 RT	98.67	98.97

QUANTITIES(AVERAGE)

EARTH EXCAVATION = 250 CU YD (includes proposed ditch & widening)
 AGG BASE COURSE, TY A = 90 TON
 HMA BSE CSE WIDE = 118 TON
 INCIDENTAL HMA SURFACING = 60 TON
 BITUMINOUS MATERIALS (MC-30) = 90 GALLON
 HMA SURF REM VAR DEPTH = 75 SQ YD
 SEEDING IN RELOCATED DITCH AREA TO BE DONE BY COUNTY FORCES WITHIN 7 DAYS OF EARTHWORK OPERATION

Z:\COWork\ROAD Projects\00122RS-Missal\Planning\EP-Survey\Survey-10-18-06.DWG, 3/23/2007 2:47:47 PM

ROUTE	SECTION	COUNTY	TOTAL SHEETS	SHEET NO.
FAS 1354	02-00122-00-RS	LIVINGSTON	6	6

PROJECT NO. SR-1354(104)

SCHEDULE OF RESURFACING QUANTITIES

Unit weight Constant = 112.0 lbs./s.y./inch

LOCATION (QUANTITY)	LENGTH	AREA (SQ YD)	HMA SURF REMOVAL VAR DEPTH (SQ YD)	SHORT- TERM PAVT MARKING (FOOT)	WORK ZONE PAVT MK REM (SQ FT)	EARTH EXCAVATION (CU YD)	AGG BSE CSE TYPE A (TON)	HMA BSE CSE WIDENING (TON)	BIT MATLS PR CT RC-70 (GALLON)	BIT MATLS PR CT MC-30 (GALLON)	AGG PR CT (TON)	AREA REFL CR CONT (SQ YD)	LEVEL BINDER (MM), IL-9.5 N50 (TON)	HMA BINDER CSE, IL-19.0 N50 (TON)	HMA SURFACE CSE, MIX "C" N50 (TON)	INCIDENTAL HMA SURF (TON)	PAINT PVT MARKING LINE, 4" (FOOT)	AGG SHLDS TYPE B (TON)
<i>SEE SHEET 2 FOR SCHEDULE</i>																		
MAINLINE																		
+47 to 2+47 (TAPER)	200	556	214	(2 Apps.) 40	(1 App.) 7				28	98	1	278	(crown corr. = 45) 36	(crown corr. = 35) -	47	-		35
2+47 to 28+78	2,631	6,431	-	526	88	-	-	-	322	-	13	6,431	415	-	540	-		466
28+78 to 30+78 (TAPER)	200	489	147	40	7	-	-	-	24	-	-	245	32	-	41	-		35
30+78 to 31+01 (RR Omission)	23	-	-	-	-	-	-	-	-	-	-	-	-	-	-	-		-
31+01 to 33+01 (TAPER)	200	489	147	40	7	-	-	-	24	-	-	245	32	-	41	-		35
33+01 to 80+77	4,776	11,675	-	956	159	-	-	-	584	-	23	11,675	753	-	981	-		846
80+77 to 81+37 (TAPER)	60	147	-	12	2	-	-	-	7	-	-	147	9	-	12	-		11
81+37 to 82+27	90	220	-	18	3	-	-	-	11	-	-	-	-	-	18	-		16
82+27 to 82+59 (053-3042)	32	78	-	6	1	-	-	-	4	-	-	-	-	-	7	-		6
82+59 to 83+49	90	220	-	18	3	-	-	-	11	-	-	-	-	-	18	-		16
83+49 to 84+09 (TAPER)	60	147	-	12	2	-	-	-	7	-	-	147	9	-	12	-		11
84+09 to 211+50	12,741	31,145	-	2,548	425	-	-	-	1,557	-	62	31,145	2,009	-	2,616	-		2,257
211+50 to 213+50 (LB to BINDER)	200	489	-	40	7	-	-	-	24	-	-	489	-	70	41	-		35
213+50 to 237+79	2,429	5,938	-	486	81	-	-	-	297	-	12	5,938	-	852	499	-		430
237+79 to 239+29 (TAPER)	150	367	220	30	5	-	-	-	18	-	-	-	-	53	31	-		27
239+29 to 239+60 (053-3043)	31	76	-	6	1	-	-	-	4	-	-	-	-	-	6	-		5
239+60 to 241+10 (TAPER)	150	367	220	30	5	-	-	-	18	-	-	-	-	53	31	-		27
241+10 to 330+55	8,945	21,866	-	1,790	298	-	-	-	1,093	-	44	21,866	-	3,138	1,837	-		1,585
330+55 to 332+55 (TAPER)	200	489	147	40	7	-	-	-	24	-	-	-	-	35	41	-		35
TOTAL JOB LENGTH OR MAINLINE QUANTITY	33,208	81,189	1,095	6,638	1,108	0	0	0	4,057	98	155	78,605	3,295	4,201	6,819	0	15,061	5,878
MISCELLANEOUS																		
P.E.'s, C.E.'s, and M.B.T.O.'s	-	-	28.0	-	-	-	-	-	4	134	-	-	12	27	34	78	-	-
SIDEROAD INTERSECTIONS (7)	-	-	-	-	-	-	-	-	98.0	-	-	-	28	21	28	105	-	-
Truck Intersection	-	-	75.0	-	-	250	90	118	-	90	-	-	-	-	-	60.0	-	-
TOTALS OF MAINLINE & MISC.	33,208	81,189	1,198	6,638	1,108	250	90	118	4,159	322	155	78,605	3,335	4,249	6,881	243	15,061	5,878

Z:\ICOWork\ROAD Projects\00122RS-Missall\Planning\Plans\EstCost-Resurf\Sched-MissallRd.xls\SchedResurfQty