

CONTRACT #	SECTION #	TOTAL SHEETS	SHEET NO.
89362	04-00401-24-RS	21	14

20200410 EARTH EXCAVATION SPL STA 19+85 - 20+36 LT	43 CU YD
35102000 AGG BASE CSE B 8 STA 19+85 - 20+36 LT	121 SQ YD

35400300 PCC BASE CSE V B STA 20+47.6 - 20+76.0 LT	4.7 SQ YD
STA 20+62.4 - 20+67.0 RT	0.8 SQ YD
STA 20+83.5 - 20+86.5 RT	0.5 SQ YD
STA 20+90.3 - 21+56.3 LT	11.0 SQ YD
STA 21+15.2 - 21+19.7 RT	0.8 SQ YD
STA 21+33.7 - 21+36.9 RT	0.5 SQ YD
STA 21+41.3 - 21+44.3 RT	0.5 SQ YD
STA 21+51.1 - 21+54.1 RT	0.5 SQ YD
STA 21+67.0 - 21+70.0 LT	0.5 SQ YD
STA 21+70.4 - 21+73.4 RT	0.5 SQ YD
STA 21+78.0 - 21+89.0 LT	1.8 SQ YD
STA 21+99.5 - 22+04.0 LT	0.8 SQ YD
STA 22+18.0 - 22+21.0 LT	0.5 SQ YD
STA 22+30.0 - 22+33.0 LT	0.5 SQ YD
STA 22+45.5 - 22+49.5 RT	0.7 SQ YD
STA 22+47.3 - 22+60.8 LT	2.2 SQ YD

40200800 AGG SURF CSE B STA 21+10 LT	0.4 TDNS
--	----------

40600100 BIT MATLS PR CT STA 20+00 - 22+50	105 GAL
--	---------

40600300 AGG PR CT STA 20+00 - 22+50	2.6 TDNS
--	----------

40600982 HMA SURF REM BUTT JT STA 20+08 RT	74.7 SQ YD
--	------------

40600995 TEMPORARY RAMP SPL STA 20+03 LT	10.6 SQ YD
STA 20+08 RT	21.1 SQ YD
STA 21+10 LT	1.3 SQ YD

40603080 HMA BC SUPER JL -19.0 N50 STA 20+00 - 22+50	184 TONS
--	----------

40603535 P HMA SC SUPER 'D' N50 STA 20+00 - 22+50	114 TONS
---	----------

40800050 INCIDENTAL HMA SURF STA 21+10 LT	0.1 TDNS
---	----------

42400100 PC CONC SIDEWALK 4 STA 20+34.1 - 20+39.5 LT	22.1 SQ FT
STA 20+91.7 - 21+10.4 LT	66.4 SQ FT
STA 21+27.2 - 21+79.8 LT	189.4 SQ FT
STA 22+07.6 - 22+63.3 LT	200.5 SQ FT

42400410 PC CONC SIDEWALK 8 STA 20+25.2 - 20+34.1 LT	24.2 SQ FT
--	------------

42400800 DETECTABLE WARNINGS STA 20+25 LT	8.0 SQ FT
---	-----------

44000080 HMA SURF REM (CM) 3 STA 20+00 - 22+50	1111.1 SQ YD
--	--------------

44000500 COMB CURB GUTTER REM STA 20+16.5 - 20+39.5 LT	23.0 FT
STA 20+47.6 - 20+76.0 LT	28.4 FT
STA 20+62.4 - 20+67.0 RT	4.6 FT
STA 20+83.5 - 20+86.5 RT	3.0 FT
STA 20+90.3 - 21+56.3 LT	66.0 FT
STA 21+15.2 - 21+19.7 RT	4.5 FT
STA 21+33.7 - 21+36.9 RT	3.2 FT
STA 21+41.3 - 21+44.3 RT	3.0 FT
STA 21+51.1 - 21+54.1 RT	3.0 FT
STA 21+67.0 - 21+70.0 LT	3.0 FT
STA 21+70.4 - 21+73.4 RT	3.0 FT
STA 21+78.0 - 21+89.0 LT	11.8 FT
STA 21+99.5 - 22+04.0 LT	4.5 FT
STA 22+18.0 - 22+21.0 LT	3.0 FT
STA 22+30.0 - 22+33.0 LT	3.0 FT
STA 22+36.0 - 22+39.0 RT	3.0 FT
STA 22+45.5 - 22+49.5 RT	4.0 FT
STA 22+47.3 - 22+60.8 LT	13.5 FT

44000600 SIDEWALK REM STA 20+16.4 - 20+39.5 LT	80.7 SQ FT
STA 20+91.7 - 21+10.4 LT	66.4 SQ FT
STA 21+27.2 - 21+79.8 LT	189.4 SQ FT
STA 22+07.6 - 22+63.3 LT	200.5 SQ FT

- PC CONC SIDEWALK 4
- PC CONC SIDEWALK 6
- PC CONC SIDEWALK 8
- CL C PATCH T1 11
- CL C PATCH T2 11
- CL C PATCH T3 11
- CL C PATCH T4 11
- PCC BASE CSE WIDENING 8
- HMA BC WIDENING 4
- COMB CC&G TYPE B-6.12
- BRICK SURF REM BUTT JT
- CENTERLINE STATIONING
- WATER MAIN
- STORM SEWER
- SANITARY SEWER

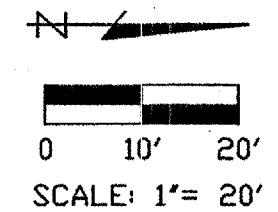

XX005807 PVT REM PARTIAL DEPTH STA 20+35.0 - 20+47.6 LT	2.1 SQ YD
STA 20+76.0 - 20+90.3 LT	2.4 SQ YD
STA 21+56.3 - 21+67.0 LT	1.8 SQ YD
STA 21+70.0 - 21+78.0 LT	1.3 SQ YD
STA 21+89.0 - 21+99.5 LT	1.8 SQ YD
STA 22+04.0 - 22+18.0 LT	2.3 SQ YD
STA 22+21.0 - 22+30.0 LT	1.5 SQ YD
STA 22+33.0 - 22+47.3 LT	2.4 SQ YD

#4001795 HMA BC VID 4 STA 20+35.0 - 20+47.6 LT	2.1 SQ YD
STA 20+76.0 - 20+90.3 LT	2.4 SQ YD
STA 21+56.3 - 21+67.0 LT	1.8 SQ YD
STA 21+70.0 - 21+78.0 LT	1.3 SQ YD
STA 21+89.0 - 21+99.5 LT	1.8 SQ YD
STA 22+04.0 - 22+18.0 LT	2.3 SQ YD
STA 22+21.0 - 22+30.0 LT	1.5 SQ YD
STA 22+33.0 - 22+47.3 LT	2.4 SQ YD

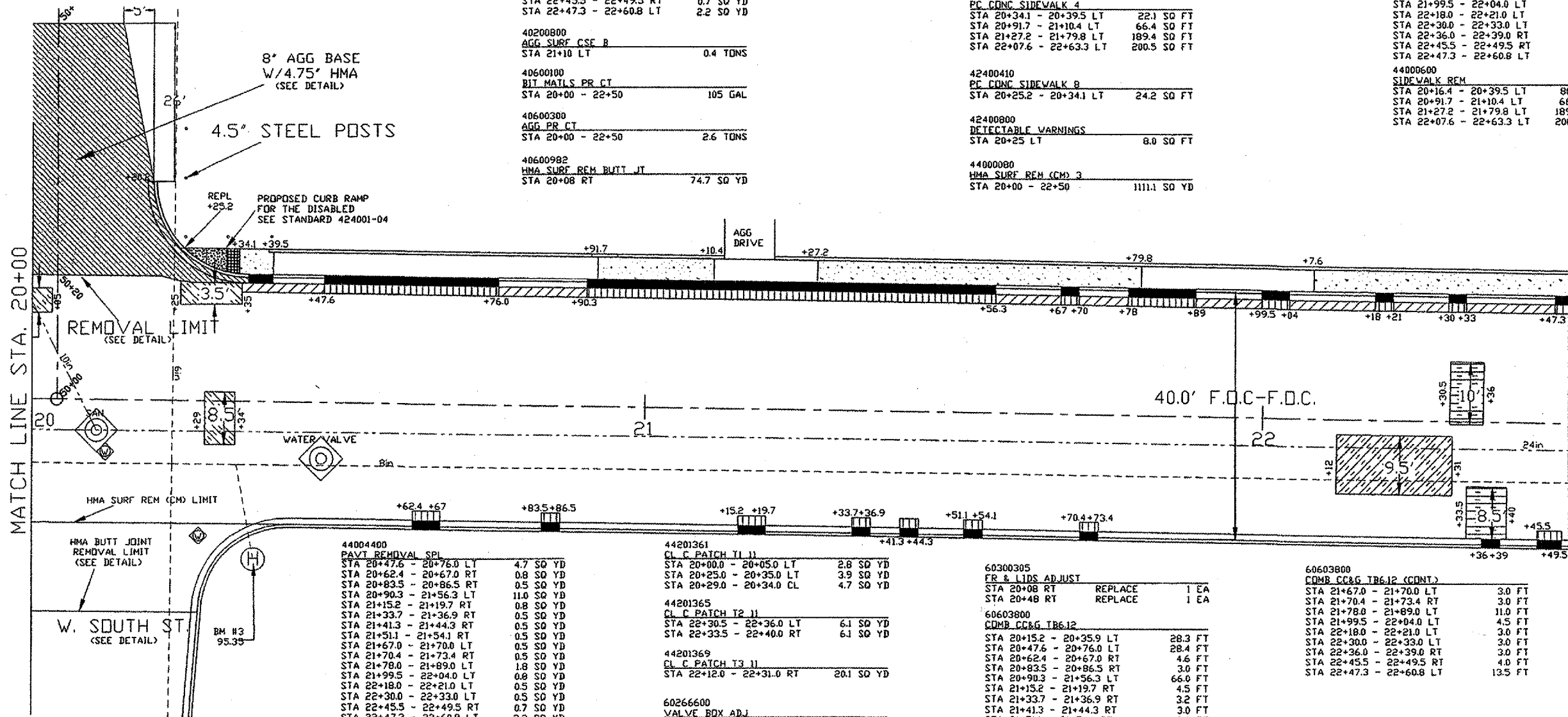

44004400 PAVT REMOVAL SPL STA 20+47.6 - 20+76.0 LT	4.7 SQ YD
STA 20+62.4 - 20+67.0 RT	0.8 SQ YD
STA 20+83.5 - 20+86.5 RT	0.5 SQ YD
STA 20+90.3 - 21+56.3 LT	11.0 SQ YD
STA 21+15.2 - 21+19.7 RT	0.8 SQ YD
STA 21+33.7 - 21+36.9 RT	0.5 SQ YD
STA 21+41.3 - 21+44.3 RT	0.5 SQ YD
STA 21+51.1 - 21+54.1 RT	0.5 SQ YD
STA 21+67.0 - 21+70.0 LT	0.5 SQ YD
STA 21+70.4 - 21+73.4 RT	0.5 SQ YD
STA 21+78.0 - 21+89.0 LT	1.8 SQ YD
STA 21+99.5 - 22+04.0 LT	0.8 SQ YD
STA 22+18.0 - 22+21.0 LT	0.5 SQ YD
STA 22+30.0 - 22+33.0 LT	0.5 SQ YD
STA 22+45.5 - 22+49.5 RT	0.7 SQ YD
STA 22+47.3 - 22+60.8 LT	2.2 SQ YD

44201361 CL C PATCH T1 11 STA 20+00.0 - 20+05.0 LT	2.8 SQ YD
STA 20+25.0 - 20+35.0 LT	3.9 SQ YD
STA 20+29.0 - 20+34.0 CL	4.7 SQ YD

44201365 CL C PATCH T2 11 STA 22+30.5 - 22+36.0 LT	6.1 SQ YD
STA 22+33.5 - 22+40.0 RT	6.1 SQ YD

44201369 CL C PATCH T3 11 STA 22+12.0 - 22+31.0 RT	20.1 SQ YD
--	------------

60266600 VALVE BOX ADJ STA 20+12 RT	1 EA
STA 20+28 RT	1 EA

60300305 FR & LIDS ADJUST STA 20+08 RT	REPLACE	1 EA
STA 20+48 RT	REPLACE	1 EA

60603800 COMB CC&G TB6.12 STA 20+15.2 - 20+35.9 LT	28.3 FT
STA 20+47.6 - 20+76.0 LT	28.4 FT
STA 20+62.4 - 20+67.0 RT	4.6 FT
STA 20+83.5 - 20+86.5 RT	3.0 FT
STA 20+90.3 - 21+56.3 LT	66.0 FT
STA 21+15.2 - 21+19.7 RT	4.5 FT
STA 21+33.7 - 21+36.9 RT	3.2 FT
STA 21+41.3 - 21+44.3 RT	3.0 FT
STA 21+51.1 - 21+54.1 RT	3.0 FT

60603800 COMB CC&G TB6.12 (CONT.) STA 21+67.0 - 21+70.0 LT	3.0 FT
STA 21+70.4 - 21+73.4 RT	3.0 FT
STA 21+78.0 - 21+89.0 LT	11.0 FT
STA 21+99.5 - 22+04.0 LT	4.5 FT
STA 22+18.0 - 22+21.0 LT	3.0 FT
STA 22+30.0 - 22+33.0 LT	3.0 FT
STA 22+36.0 - 22+39.0 RT	3.0 FT
STA 22+45.5 - 22+49.5 RT	4.0 FT
STA 22+47.3 - 22+60.8 LT	13.5 FT

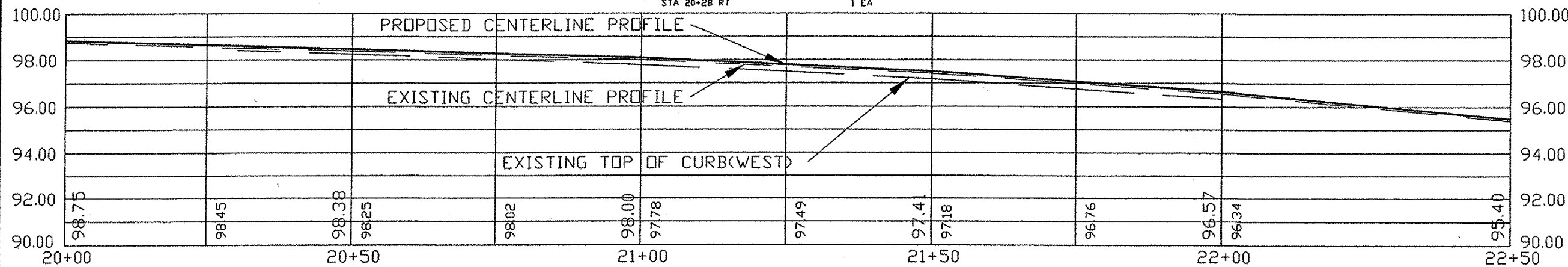

BM #3: ELEV: 95.35
TOP OF NNW BOLT BELOW 'SS'
ON BOTTOM FLANGE OF FIRE
HYDRANT LOCATED AT NE
CORNER OF SOUTH ST. AND
S. HENDERSON ST.

PLAN & PROFILE 5
STA 20+00 - 22+50
S. HENDERSON ST. RESURFACING
SECTION # 04-00401-24-RS
FAU ROUTE 6791
JOB # C-94-040-05
CONTRACT # 89362



ALL ELEVATIONS EXISTING UNLESS OTHERWISE NOTED
LARGE FONT ELEVATIONS= PAVEMENT CENTERLINE
SMALL FONT ELEVATIONS= TOP OF CURB (WEST SIDE)