

F.A. RTE.	SECTION	COUNTY	TOTAL SHEETS	SHEET NO.
07-00000-00-SC	TAZEWELL	ILLINOIS	19	9

FED. ROAD DIST. NO. ILLINOIS FED. AID PROJECT  
• VARIOUS

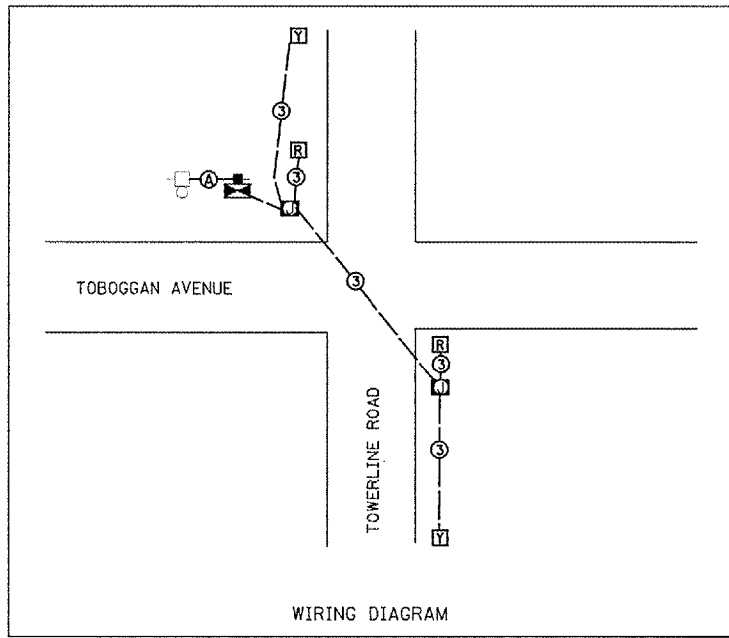

- NOTES**
- 1 GROUND CONTROLLER, SERVICE EXPOSED METALLIC CONDUIT IN ACCORDANCE WITH NEC REQUIREMENTS. COST INCLUDED IN CONTRACT.
  - 2 NO. 14 SPARE CONDUCTOR CAN BE USED FOR GROUNDING. COST INCLUDED IN CONTRACT
  - 3 AERIAL SERVICE CABLE FROM THE EXISTING SERVICE POLE TO THE PROPOSED SERVICE POLE WILL BE PROVIDED BY OTHERS

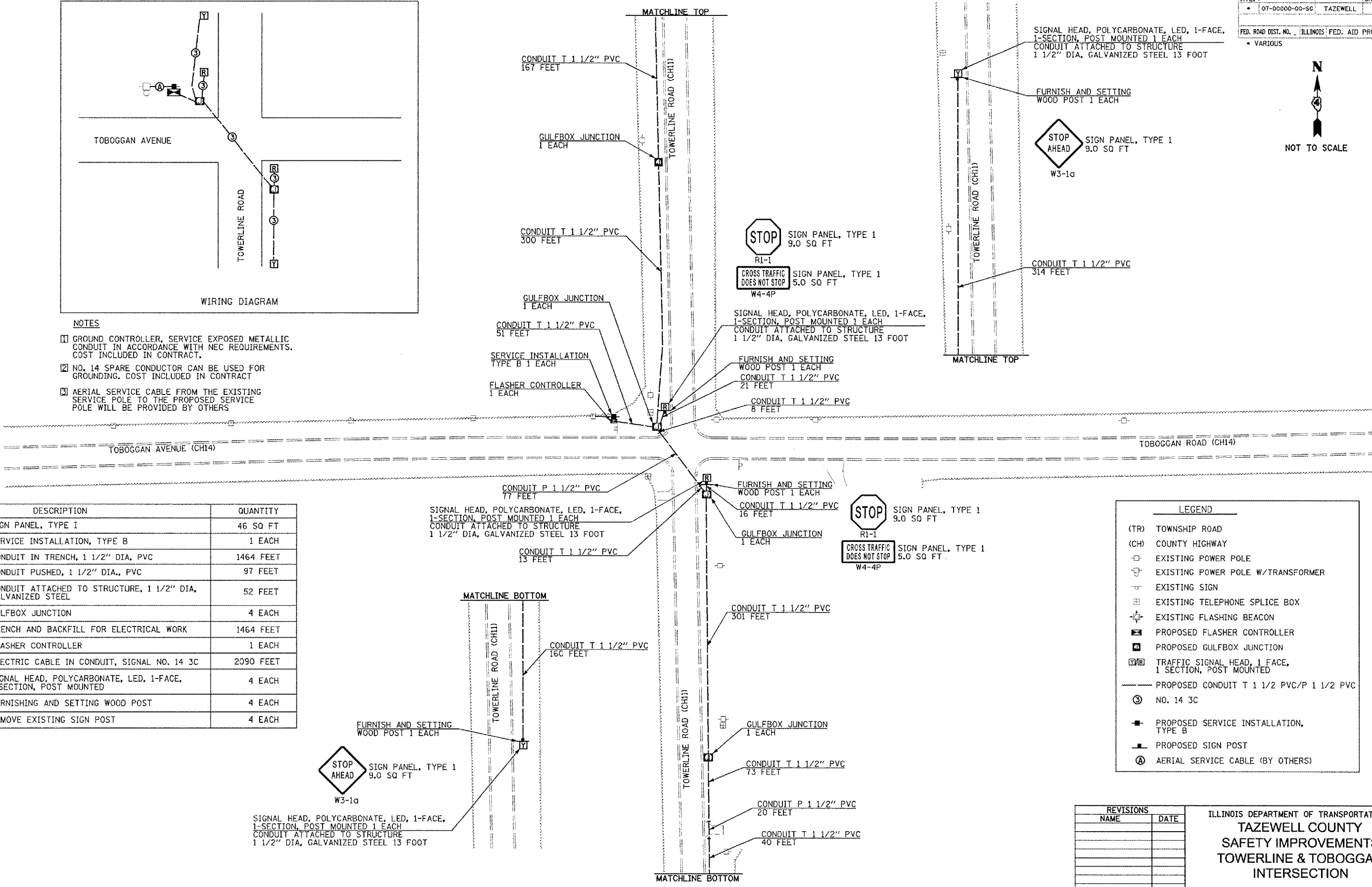

DESCRIPTION	QUANTITY
SIGN PANEL, TYPE I	46 SQ FT
SERVICE INSTALLATION, TYPE B	1 EACH
CONDUIT IN TRENCH, 1 1/2" DIA, PVC	1464 FEET
CONDUIT PUSHED, 1 1/2" DIA., PVC	97 FEET
CONDUIT ATTACHED TO STRUCTURE, 1 1/2" DIA, GALVANIZED STEEL	52 FEET
GULFBOX JUNCTION	4 EACH
TRENCH AND BACKFILL FOR ELECTRICAL WORK	1464 FEET
FLASHER CONTROLLER	1 EACH
ELECTRIC CABLE IN CONDUIT, SIGNAL NO. 14 3C	2090 FEET
SIGNAL HEAD, POLYCARBONATE, LED, 1-FACE, 1-SECTION, POST MOUNTED	4 EACH
FURNISHING AND SETTING WOOD POST	4 EACH
REMOVE EXISTING SIGN POST	4 EACH

**LEGEND**

- (TR) TOWNSHIP ROAD
- (CH) COUNTY HIGHWAY
- EXISTING POWER POLE
- EXISTING POWER POLE W/TRANSFORMER
- EXISTING SIGN
- EXISTING TELEPHONE SPLICE BOX
- EXISTING FLASHING BEACON
- PROPOSED FLASHER CONTROLLER
- PROPOSED GULFBOX JUNCTION
- TRAFFIC SIGNAL HEAD, 1 FACE, 1 SECTION, POST MOUNTED
- PROPOSED CONDUIT T 1/2 PVC/P 1/2 PVC
- ⊙ NO. 14 3C
- PROPOSED SERVICE INSTALLATION, TYPE B
- PROPOSED SIGN POST
- ⊙ AERIAL SERVICE CABLE (BY OTHERS)

**REVISIONS**

NAME	DATE

ILLINOIS DEPARTMENT OF TRANSPORTATION  
**TAZEWELL COUNTY**  
**SAFETY IMPROVEMENTS**  
**TOWERLINE & TOBOGGAN**  
**INTERSECTION**

SCALE: NO SCALE  
 DATE 03/20/2007  
 DRAWN BY MEW  
 CHECKED BY DLH SDO

Copyright © 2007 D.A.S. Consulting Services, LLC  
**D.A.S.**  
 Consulting Services, LLC  
 600 Besler Lake Drive  
 Grafton, Illinois 61535

PLOT DATE = 4/7/2007  
 FILE NAME = c:\dms\proj\08\jobs\08\0805\road\serv\1\sheet\loc-ah07.dgn