

28000300

| TEMPORARY DITCH CHECKS | | |
|------------------------|---|------|
| 17.5 LT STA. 20+01.2 | 1 | EACH |
| 17.5 RT STA. 20+04.1 | 1 | EACH |
| 23.5 LT STA. 21+23.5 | 1 | EACH |
| 23.5 RT STA. 21+75.1 | 1 | EACH |
| SHEET TOTAL = 4 EACH | | |

SCALES:
1" = 20' HOR
1" = 2' VER

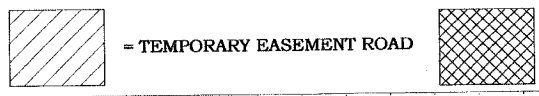

44000100

| PAVEMENT REMOVAL | |
|------------------------------|---------------|
| STA. 21+69.7 TO STA. 22+96.2 | 201.3 SQ. YD. |
| SHEET TOTAL = 201.3 SQ. YD. | |

60260100

| INLETS TO BE ADJUSTED | | |
|-----------------------|---|------|
| 17.5 LT STA. 20+01.2 | 1 | EACH |
| 17.5 RT STA. 20+04.1 | 1 | EACH |
| 23.5 LT STA. 21+23.5 | 1 | EACH |
| SHEET TOTAL = 3 EACH | | |

VPI STA = 20+00.00
VPI EL = 712.32
CURVE LEN = 100.00
K = 70.67
E = 0.18

44000600

| SIDEWALK REMOVAL | |
|---------------------------------|----------------|
| LT STA. 20+33.5 TO STA. 20+54.3 | 63.03 SQ. FT. |
| LT STA. 21+14.5 TO STA. 21+40.0 | 126.26 SQ. FT. |
| SHEET TOTAL = 189.3 SQ. FT. | |

XX002053

| LANDSCAPE RESTORATION | |
|----------------------------------|----------|
| RT STA. 22+50 TO RT STA. 22+96.2 | 1 L. SUM |
| SHEET TOTAL = 1 L. SUM | |

42400100

| PORTLAND CEMENT CONCRETE SIDEWALK 4 INCH | |
|--|----------------|
| LT STA. 20+33.5 TO STA. 20+54.3 | 96.36 SQ. FT. |
| LT STA. 21+14.5 TO STA. 21+40.0 | 133.14 SQ. FT. |
| SHEET TOTAL = 229.5 SQ. FT. | |

XX006616

| LANDSCAPE REMOVAL | |
|----------------------|--------|
| RT STA. 22+54 | 1 EACH |
| RT STA. 22+85 | 1 EACH |
| SHEET TOTAL = 2 EACH | |

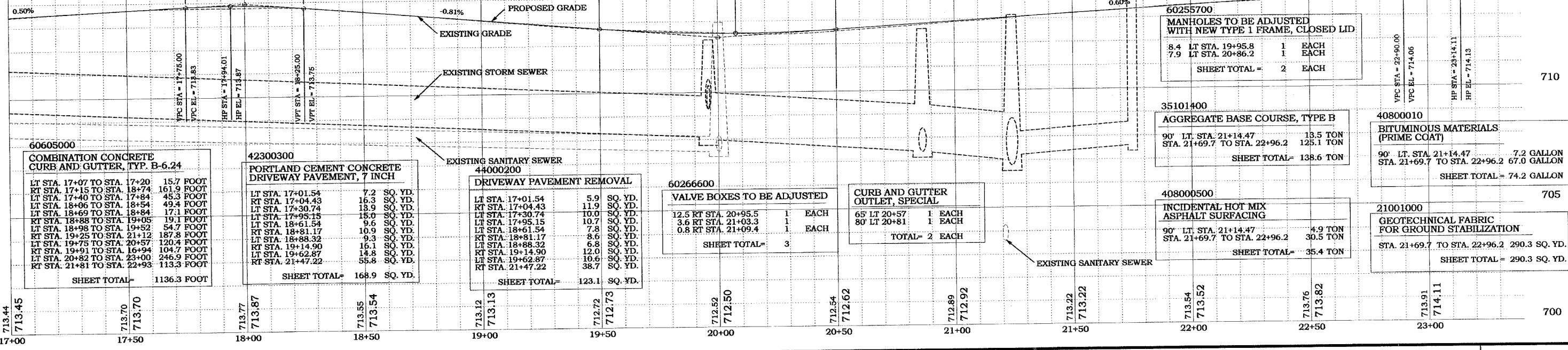

60605000

| COMBINATION CONCRETE CURB AND GUTTER, TYP. B-6.24 | |
|---|------------|
| LT STA. 17+07 TO STA. 17+20 | 15.7 FOOT |
| RT STA. 17+15 TO STA. 18+74 | 161.9 FOOT |
| LT STA. 17+40 TO STA. 17+84 | 45.3 FOOT |
| LT STA. 18+06 TO STA. 18+54 | 49.4 FOOT |
| LT STA. 18+69 TO STA. 18+84 | 17.1 FOOT |
| RT STA. 18+88 TO STA. 19+05 | 19.1 FOOT |
| LT STA. 18+98 TO STA. 19+52 | 54.7 FOOT |
| RT STA. 19+25 TO STA. 21+12 | 187.8 FOOT |
| LT STA. 19+75 TO STA. 20+57 | 120.4 FOOT |
| RT STA. 19+91 TO STA. 16+94 | 104.7 FOOT |
| LT STA. 20+82 TO STA. 23+00 | 246.9 FOOT |
| RT STA. 21+81 TO STA. 22+93 | 113.3 FOOT |
| SHEET TOTAL = 1136.3 FOOT | |

42300300

| PORTLAND CEMENT CONCRETE DRIVEWAY PAVEMENT, 7 INCH | |
|--|--------------|
| LT STA. 17+01.54 | 7.2 SQ. YD. |
| RT STA. 17+04.43 | 16.3 SQ. YD. |
| LT STA. 17+30.74 | 18.9 SQ. YD. |
| LT STA. 17+95.15 | 18.0 SQ. YD. |
| LT STA. 18+61.54 | 9.6 SQ. YD. |
| RT STA. 18+81.17 | 10.9 SQ. YD. |
| LT STA. 18+88.32 | 9.3 SQ. YD. |
| RT STA. 19+14.90 | 15.1 SQ. YD. |
| LT STA. 19+62.87 | 14.8 SQ. YD. |
| RT STA. 21+47.22 | 55.8 SQ. YD. |
| SHEET TOTAL = 168.9 SQ. YD. | |

44000200

| DRIVEWAY PAVEMENT REMOVAL | |
|-----------------------------|--------------|
| LT STA. 17+01.54 | 5.9 SQ. YD. |
| RT STA. 17+04.43 | 11.9 SQ. YD. |
| LT STA. 17+30.74 | 10.0 SQ. YD. |
| LT STA. 17+95.15 | 10.7 SQ. YD. |
| LT STA. 18+61.54 | 7.8 SQ. YD. |
| RT STA. 18+81.17 | 8.6 SQ. YD. |
| LT STA. 18+88.32 | 6.8 SQ. YD. |
| RT STA. 19+14.90 | 12.0 SQ. YD. |
| LT STA. 19+62.87 | 10.6 SQ. YD. |
| RT STA. 21+47.22 | 38.7 SQ. YD. |
| SHEET TOTAL = 123.1 SQ. YD. | |

60266600

| VALVE BOXES TO BE ADJUSTED | | |
|----------------------------|---|------|
| 12.5 RT STA. 20+95.5 | 1 | EACH |
| 3.6 RT STA. 21+03.3 | 1 | EACH |
| 0.8 RT STA. 21+09.4 | 1 | EACH |
| SHEET TOTAL = 3 | | |

CURB AND GUTTER OUTLET, SPECIAL

| | |
|----------------|--------|
| 65 LT 20+57 | 1 EACH |
| 80 LT 20+81 | 1 EACH |
| TOTAL = 2 EACH | |

60255700

| MANHOLES TO BE ADJUSTED WITH NEW TYPE 1 FRAME, CLOSED LID. | |
|--|--------|
| 8.4 LT STA. 19+95.8 | 1 EACH |
| 7.9 LT STA. 20+86.2 | 1 EACH |
| SHEET TOTAL = 2 EACH | |

35101400

| AGGREGATE BASE COURSE, TYPE B | |
|-------------------------------|-----------|
| 90' LT STA. 21+14.47 | 13.5 TON |
| STA. 21+69.7 TO STA. 22+96.2 | 125.1 TON |
| SHEET TOTAL = 138.6 TON | |

40800010

| BITUMINOUS MATERIALS (PRIME COAT) | |
|-----------------------------------|-------------|
| 90' LT STA. 21+14.47 | 7.2 GALLON |
| STA. 21+69.7 TO STA. 22+96.2 | 67.0 GALLON |
| SHEET TOTAL = 74.2 GALLON | |

408000500

| INCIDENTAL HOT MIX ASPHALT SURFACING | |
|--------------------------------------|----------|
| 90' LT STA. 21+14.47 | 4.9 TON |
| STA. 21+69.7 TO STA. 22+96.2 | 30.5 TON |
| SHEET TOTAL = 35.4 TON | |

21001000

| GEOTECHNICAL FABRIC FOR GROUND STABILIZATION | |
|--|---------------|
| STA. 21+69.7 TO STA. 22+96.2 | 290.3 SQ. YD. |
| SHEET TOTAL = 290.3 SQ. YD. | |

FRANCIS ASSOCIATES
CONSULTING ENGINEERS
LAND SURVEYORS
330 NORTH CENTRAL AVENUE
PARIS, ILLINOIS 61944
PH. (217) 465-5306
PROFESSIONAL DESIGN FIRM #184-001406

| SCALES | |
|----------------------|--------|
| PLAN : HOR. 1" = 20' | |
| VERT. 1" = 2' | |
| DRAWN DATE | 3/5/07 |
| CHECKED DATE | |
| APPROVED DATE | |
| REVISED DATE | |

FRANCIS ASSOC. FILE NO. **P-356**