

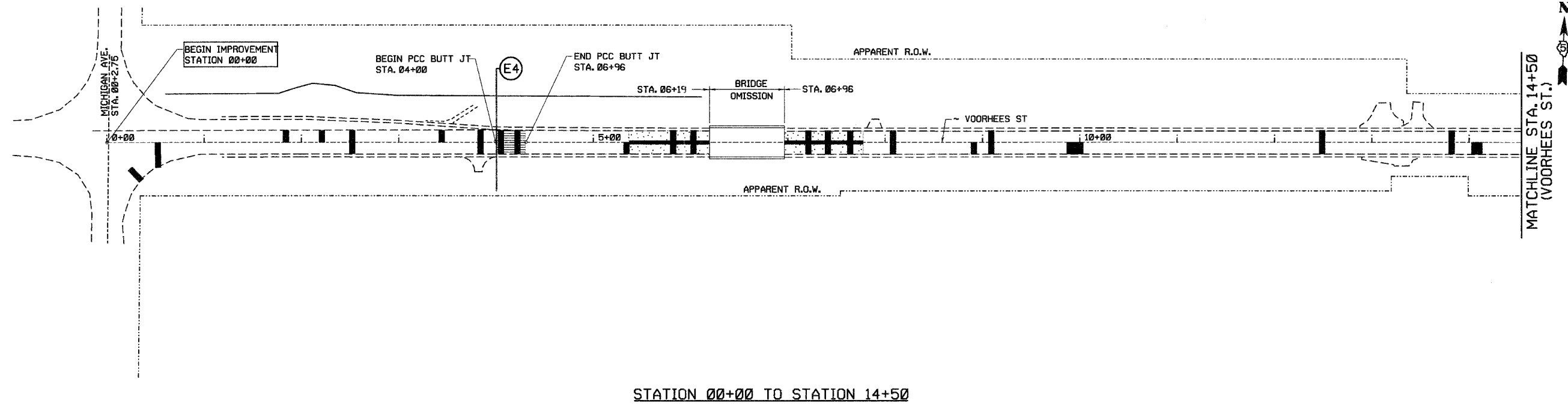

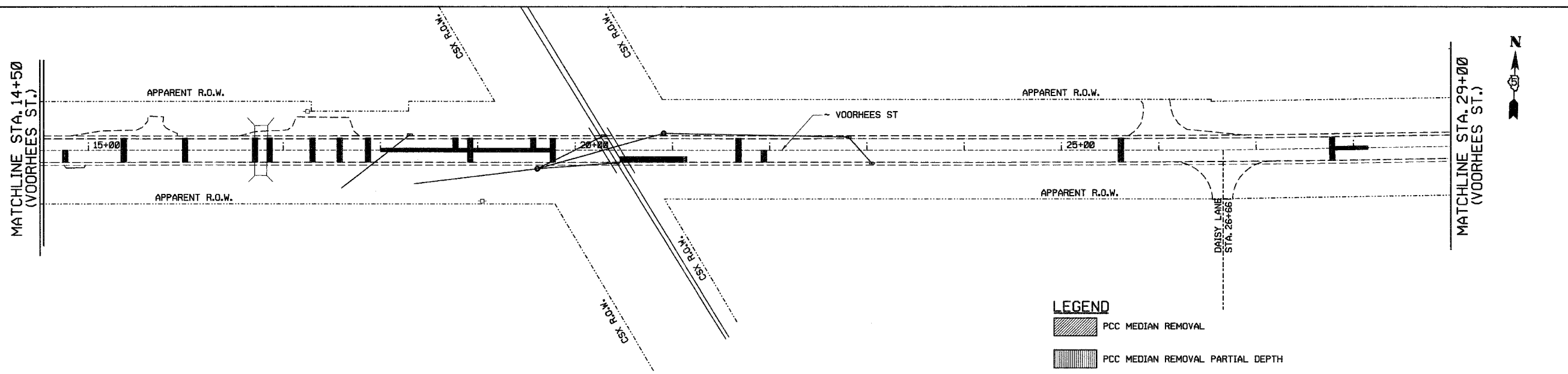



RTE.	PROJECT NO.	COUNTY	TOTAL SHEETS	SHEET NO.
•	05-00218-00-PV	VERMILION	57	16
STA. 00+00.00 TO STA. 335+39.18				
*F.A.P. 729 & F.A.U. 6999 CONTRACT NO. 91367				



STATION 00+00 TO STATION 14+50

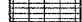

STATION 14+50 TO STATION 29+00

- LEGEND**
-  PCC MEDIAN REMOVAL
  -  PCC MEDIAN REMOVAL PARTIAL DEPTH
  -  PCC BUTT JOINT
  -  PAVEMENT PATCHING
  -  HMA SURFACE REMOVAL
  -  PCC SURFACE REMOVAL

DEPARTMENT OF ENGINEERING  
 DANVILLE, ILL. R. DAVID SCHNELLE, CITY ENGINEER  
 LYNCH ROAD IMPROVEMENT  
 EXISTING REMOVAL PLAN  
 STA. 0+00 TO STA. 29+00  
 SCALE: 1:50  
 DATE: 3/12/2007  
 DRAWN BY: RDS  
 CHECKED BY: JPH

REVISIONS	DATE
NAME	

X:\Projects\C:\City\Current\05010215-Lynch Spur\Civil\DMN\REM009.dgn

