

RTE.	PROJECT NO.	COUNTY	TOTAL SHEETS	SHEET NO.
	05-00218-00-PV	VERMILION	57	17
STA. 00+00.00 TO STA. 335+39.10				
*F.A.P. 729 & F.A.U. 6999 CONTRACT NO. 91367				

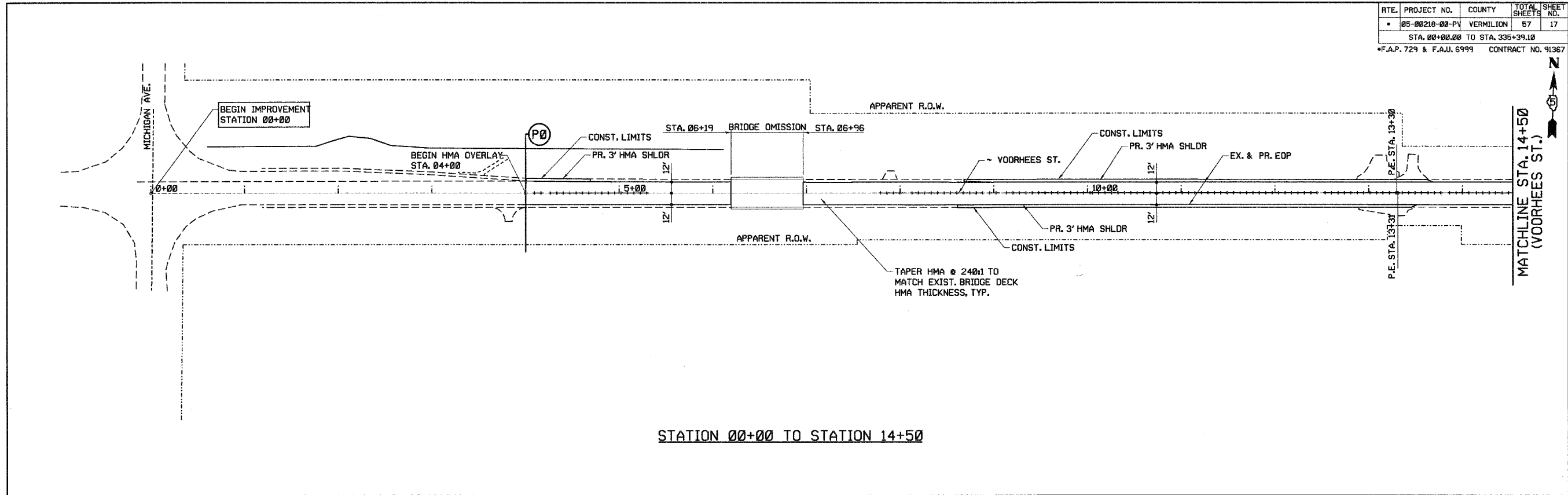

STATION 00+00 TO STATION 14+50

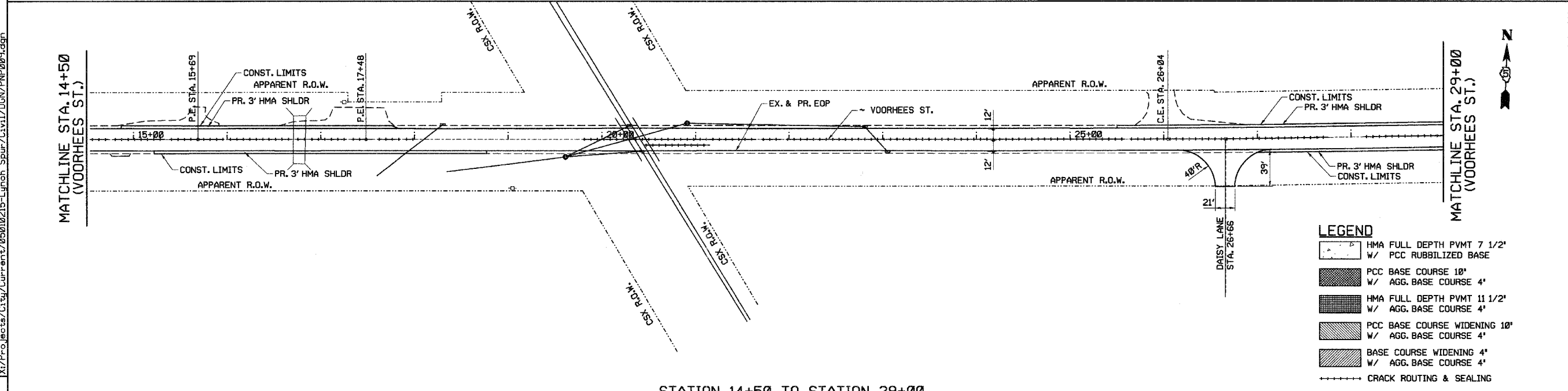

STATION 14+50 TO STATION 29+00

LEGEND

	HMA FULL DEPTH PVMT 7 1/2"
	W/ PCC RUBBILIZED BASE
	PCC BASE COURSE 10"
	W/ AGG. BASE COURSE 4"
	HMA FULL DEPTH PVMT 11 1/2"
	W/ AGG. BASE COURSE 4"
	PCC BASE COURSE WIDENING 10"
	W/ AGG. BASE COURSE 4"
	BASE COURSE WIDENING 4"
	W/ AGG. BASE COURSE 4"
	CRACK ROUTING & SEALING

DEPARTMENT OF ENGINEERING
 DANVILLE, ILL. R. DAVID SCHNELLE, CITY ENGINEER
 LYNCH ROAD IMPROVEMENT
 PROPOSED PLAN VOORHEES ST
 STA. 0+00 TO STA. 29+00
 SCALE: 1:50
 DATE: 3/12/2007
 DRAWN BY: RDS
 CHECKED BY: JPH

	DATE
	REVISIONS
NAME	DATE

X:\Projects\Civil\Current\05010215-Lynch Spur\Civil\DM\PNP009.dgn