

RTE.	PROJECT NO.	COUNTY	TOTAL SHEET NO.
05-00218-00-PV	VERMILION	57	30
STA. 00+00.00 TO STA. 335+39.10			
*F.A.P. 729 & F.A.U. 6999			CONTRACT NO. 91367

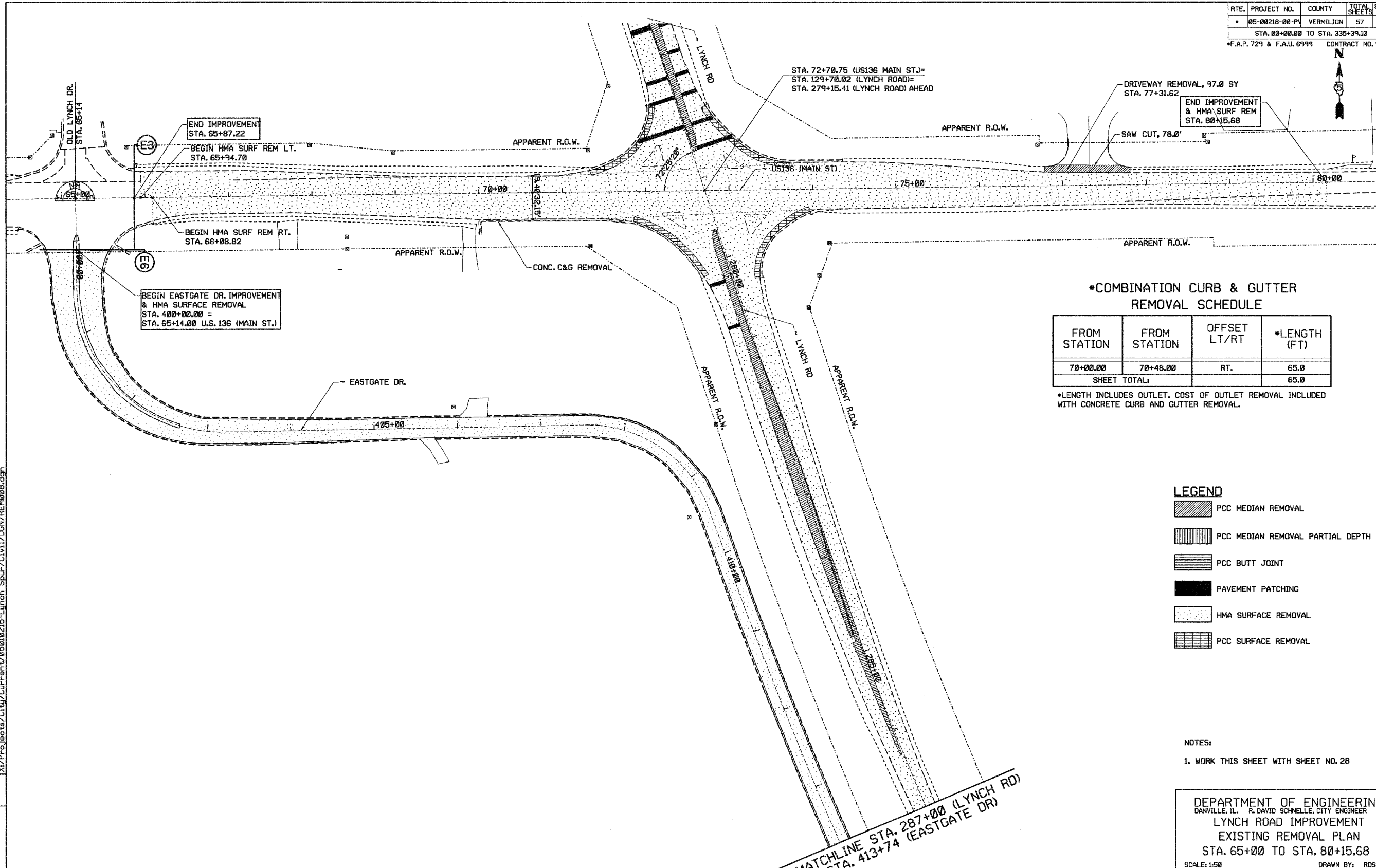





***COMBINATION CURB & GUTTER REMOVAL SCHEDULE**

FROM STATION	FROM STATION	OFFSET LT/RT	*LENGTH (FT)
70+00.00	70+48.00	RT.	65.0
SHEET TOTAL:			65.0

*LENGTH INCLUDES OUTLET. COST OF OUTLET REMOVAL INCLUDED WITH CONCRETE CURB AND GUTTER REMOVAL.

LEGEND

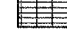
-  PCC MEDIAN REMOVAL
-  PCC MEDIAN REMOVAL PARTIAL DEPTH
-  PCC BUTT JOINT
-  PAVEMENT PATCHING
-  HMA SURFACE REMOVAL
-  PCC SURFACE REMOVAL

NOTES:

1. WORK THIS SHEET WITH SHEET NO. 28

DEPARTMENT OF ENGINEERING
 DANVILLE, IL. R. DAVID SCHNELLE, CITY ENGINEER
 LYNCH ROAD IMPROVEMENT
 EXISTING REMOVAL PLAN
 STA. 65+00 TO STA. 80+15.68
 SCALE: 1/50
 DATE: 3/12/2007
 DRAWN BY: RDS
 CHECKED BY: MEW

Revisions

NO.	DATE	DESCRIPTION

City of Danville
 CITY OF DANVILLE, IL. WEST MAIN STREET
 DANVILLE, ILLINOIS 61830

X:\Projects\Cty\Current\05010215-Lynch Spur\Civil\DM\REM008.dgn