

STATE OF ILLINOIS
DEPARTMENT OF TRANSPORTATION
DIVISION OF HIGHWAYS
PLANS FOR PROPOSED
HIGHWAY BRIDGE PROGRAM

EMBARRASS ROAD DISTRICT
SECTION 06-05132-00-BR

EDGAR COUNTY
PROJECT NO. BROS-045(41)
T.R. 60

JOB NO. C-95-309-07

R. 14 W., 2ND P.M. | R. 13 W., 2ND P.M.

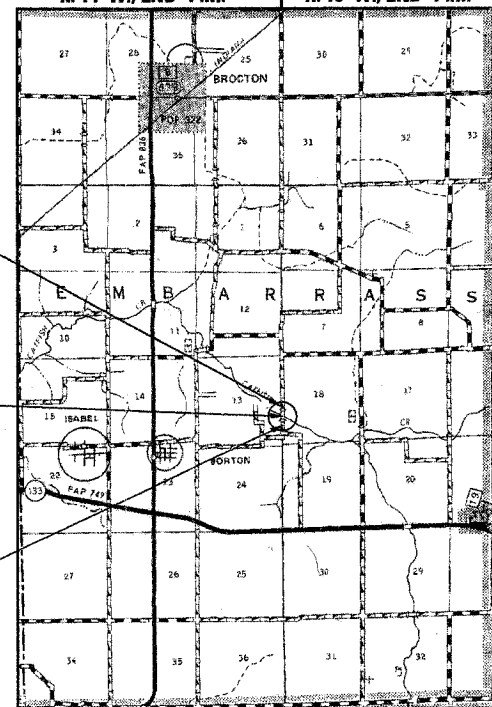

IMPROVEMENT ENDS
STA. 19 + 50

STA. 15 + 00 - SPECIAL BRIDGE DESIGN
 PRECAST PRESTRESSED CONCRETE DECK
 BEAM BRIDGE; TWO SPANS @ 63'-0",
 27'-0" ROADWAY; SKEW = 0°
 EXISTING S.N. 023-4406
 PROPOSED S.N. 023-4428

IMPROVEMENT BEGINS
STA. 11 + 50

FUNCTIONAL CLASSIFICATION LOCAL ROAD CURRENT ADT LESS THAN 150

LOCATION PLAN

GROSS LENGTH OF SECTION = 800 FEET = 0.152 MILES
 NET LENGTH OF SECTION = 800 FEET = 0.152 MILES



ROUTE NO.	SECTION	COUNTY	TOTAL SHEETS	SHEET NO.
T.R. 60	06-05132-00-BR	EDGAR	15	1
ROAD DIST.		ILLINOIS	EMBARRASS	

CONTRACT NO. 91374

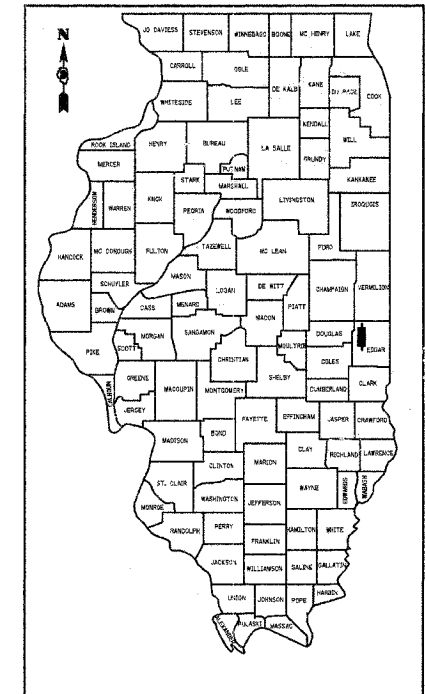

LOCATION OF SECTION INDICATED THUS: [arrow pointing to the rectangle on the map]

CLASSIFICATION: LOCAL ROAD NON-URBAN
DESIGN VOLUME: <150 ADT
CURRENT ADT: <150 ADT
DESIGN SPEED: 30 MPH

TOLL FREE JOINT UTILITY LOCATING
 INFORMATION FOR EXCAVATORS (J.U.L.I.E.)
 TELEPHONE NUMBER 1-800-892-0123

PASSED Feb 2 2007
 ROAD DISTRICT COMMISSIONER

APPROVED Feb 5 2007
 COUNTY ENGINEER

PASSED 3/15 2007
 DISTRICT FIVE ENGINEER OF LOCAL ROADS & STREETS

RELEASED FOR BID
 BASED ON LIMITED
 REVIEW March 15 2007
 DEPUTY DIRECTOR OF HIGHWAYS, REGION THREE ENGINEER

STATE OF ILLINOIS
 DEPARTMENT OF TRANSPORTATION

INDEX OF SHEETS

SHEET NO.	TITLE
1.	COVER SHEET
2.	SUMMARY OF QUANTITIES, GENERAL NOTES & TYPICAL SECTIONS
3.	PLAN AND PROFILE SHEET
4.-8.	BRIDGE PLANS
9.-14.	STATION CROSS SECTIONS
15.	EROSION CONTROL PLAN

STANDARDS:

280001-03	TEMPORARY EROSION CONTROL SYSTEMS
515001-02	NAME PLATE FOR BRIDGES
631026-03	TRAFFIC BARRIER TERMINAL TYPE 5
635006-02	REFLECTOR AND TERMINAL MARKER REPLACEMENT
702001-06	TYPICAL APPLICATION OF TRAFFIC CONTROL DEVICES FOR CONSTRUCTION ON RURAL LOCAL HIGHWAYS
BLR 21-6	TRAFFIC CONTROL DEVICES

SCALES

PLAN	0' 50' 100'
PROFILE HORIZ.	0' 50' 100'
PROFILE VERT.	0' 5' 10'
CROSS SECTIONS	0' 5' 10'

4440 ASH GROVE
 SPRINGFIELD, IL 62711
 (217) 793-8600
 www.fehr-graham.com

FEHR-GRAHAM & ASSOCIATES, LLC
 ENGINEERING AND SCIENCE CONSULTANTS
PROFESSIONAL ENGINEERS AND ARCHITECTS



Fred J. Stone, Jr. (1-25-07)
 ILLINOIS PROFESSIONAL NO. 26065
 EXPIRES 11-30-07