

F.A.P. RTE.	SECTION	COUNTY	TOTAL SHEETS	SHEET NO.
95		EFFINGHAM	409	31
FED. ROAD DIST. NO. 7 ILLINOIS FED. AID PROJECT				
* (6,7)Y, RS-1, 6B-1, 7B-1, 7BR-2				
CONTRACT NO. 94356				

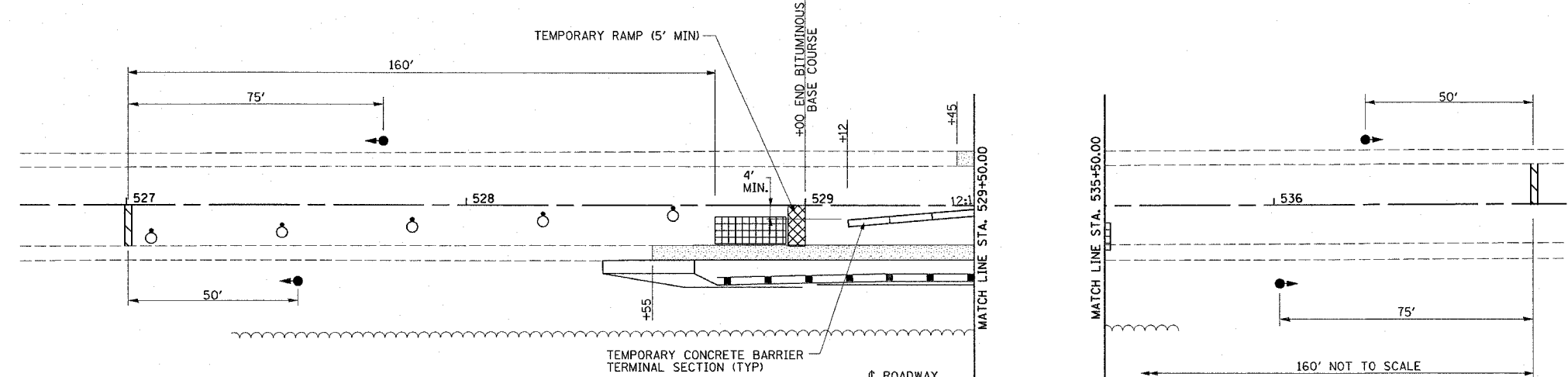
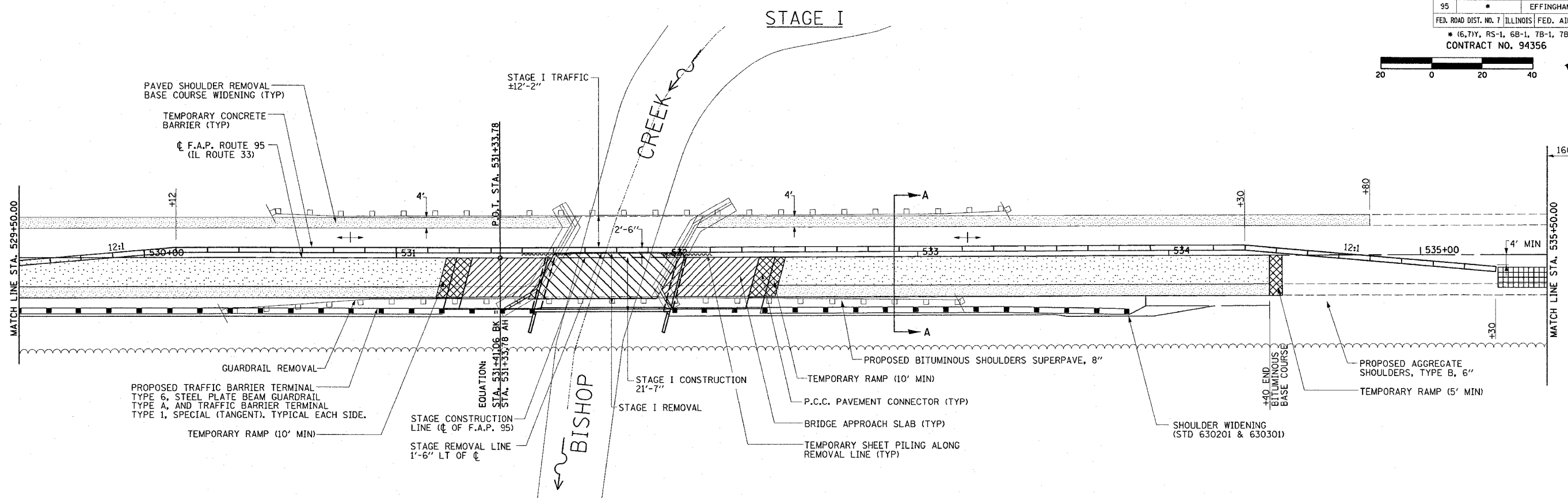
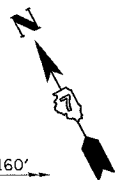

**TEMPORARY RAMP**

STA. 531+20.28 - STA. 531+30.28	16 SQ YD
STA. 532+37.00 - STA. 532+47.00	16 SQ YD
STA. 528+95.00 - STA. 529+00.00	8 SQ YD
<b>TOTAL</b>	<b>40 SQ YD</b>

**TEMPORARY CONCRETE BARRIER**

STA. 529+12.00 - STA. 535+30.00	625'
---------------------------------	------

- NOTES:**
- FOR ADDITIONAL DETAILS ON LANE CLOSURES WITH BARRIERS, SEE STANDARD 701321 AND SPECIAL PROVISION FOR TRAFFIC CONTROL AND PROTECTION STANDARD 701321 (SPECIAL).
  - SEE BRIDGE PLANS FOR ADDITIONAL INFORMATION ON STAGE CONSTRUCTION.
  - UNLESS NOTED, BASE COURSE WIDENING TO REMAIN IN PLACE AFTER BRIDGE CONSTRUCTION IS COMPLETE.
  - FINAL SURFACE COURSE TO BE APPLIED UNDER TRAFFIC.

- SUGGESTED SEQUENCE OF OPERATIONS**
- CONSTRUCT BASE COURSE WIDENING, LEFT SIDE
  - ERECT SIGNS, TRAFFIC SIGNALS, TEMPORARY BARRIERS, ETC. ACCORDING TO THE TRAFFIC CONTROL STANDARD 701321.
  - INSTALL TEMPORARY SHEET PILING. REMOVE THE STAGE I PORTION OF THE EXISTING STRUCTURE, PAVEMENT AND GUARDRAIL.
  - CONSTRUCT EMBANKMENT AND RAISE ROAD PER CROSS SECTIONS.
  - CONSTRUCT THE STAGE I PORTION OF THE NEW BRIDGE, APPROACH PAVEMENT, TEMPORARY RAMPS AND GUARDRAIL.

**LEGEND**

- PAVEMENT REMOVAL
- BITUMINOUS BINDER COURSE
- BASE COURSE WIDENING
- TEMPORARY RAMP
- TEMPORARY CONCRETE BARRIER
- STRUCTURE REMOVAL
- IMPACT ATTENUATOR
- TRAFFIC SIGNALS
- BARRICADE OR DRUM WITH MONODIRECTIONAL STEADY BURNING LIGHT
- STOP BAR

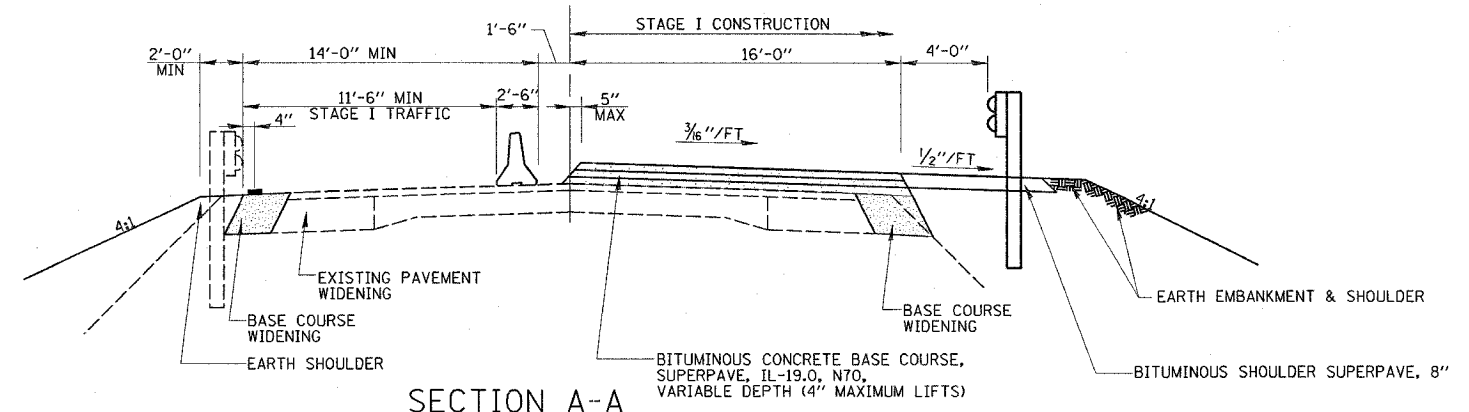

REVISIONS	
NAME	DATE

ILLINOIS DEPARTMENT OF TRANSPORTATION

**STAGE I CONSTRUCTION**  
 IL RTE 33 OVER BISHOP CREEK  
 STRUCTURE NO. 025-0097  
 STA. 531+80.00

DATE 8/03  
 REVISED DATE 03/26/07

DRAWN BY MLO  
 CHECKED BY PBB