

F.A.P. RTE.	SECTION	COUNTY	TOTAL SHEETS	SHEET NO.
95	*	EFFINGHAM	409	60
STA. 348+00.00 TO STA. 361+00.00				
FED. ROAD DIST. NO. 7 ILLINOIS FED. AID PROJECT				
* (6,7)Y, RS-1, 6B-1, 7B-1 & 7BR-2				
CONTRACT NO. 94356				

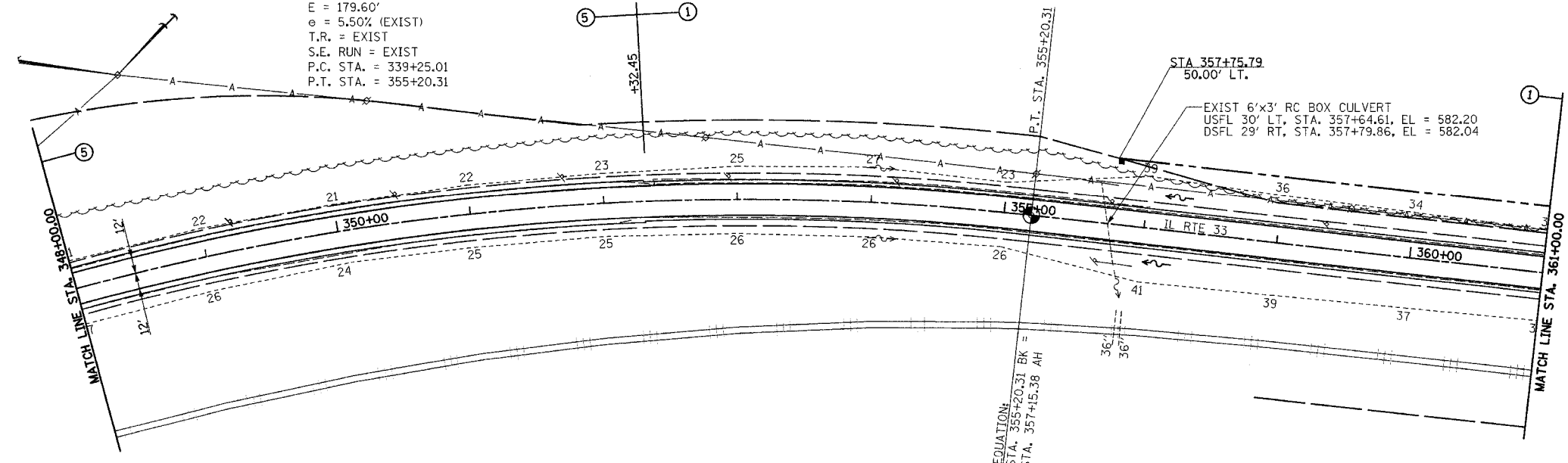

EXIST CURVE C4  
 PI STA. = 347+72.52  
 $\Delta = 47^\circ 51' 32''$  (RT)  
 $D = 3^\circ 00' 00''$   
 $R = 1,909.86'$   
 $T = 847.51'$   
 $L = 1,595.30'$   
 $E = 179.60'$   
 $e = 5.50\%$  (EXIST)  
 T.R. = EXIST  
 S.E. RUN = EXIST  
 P.C. STA. = 339+25.01  
 P.T. STA. = 355+20.31



PERMANENT SURVEY MARKERS, TYPE I  
 P.T. STA. 355+20.31 (BK) 1 EACH

FURNISHING AND ERECTING RIGHT-OF-WAY MARKERS  
 50' LT STA. 357+75.79 1 EACH

DATE	BY	REVISION

DATE	BY	REVISION

