

PIPE CULVERTS, CLASS D, TYPE 1, 15"
 STA. 591+95.31, 33' LT
 LENGTH = 133'
 UPSTREAM FLOWLINE = 602.12
 DOWNSTREAM FLOWLINE = 601.32

END SECTIONS, 15"
 34' LT STA. 591+28.98 1 EACH
 33' LT STA. 592+61.64 1 EACH
 TOTAL 2 EACH

EXIST CURVE C7
 PI STA. = 590+74.46
 $\Delta = 0^\circ 23' 49"$ (RT)
 $D = 0^\circ 02' 15"$
 $R = 152,759.23'$
 $T = 529.26'$
 $L = 1,058.52'$
 $E = 0.92'$
 $e = N/C$
 T.R. = NONE
 S.E. RUN = NONE
 P.C. STA. = 585+45.20
 P.T. STA. = 596+03.72

SEE SHEET 136 FOR ISLAND GEOMETRY
 STA 591+41.69
 50.00' LT.

ISLAND REMOVAL
 LT STA. 591+74.73 - STA. 591+89.31 115 SQ FT
 CONCRETE MEDIAN, TYPE SM-6.24
 LT STA. 591+73.48 - STA. 591+89.37 131 SQ FT

COMBINATION CONCRETE CURB AND GUTTER REMOVAL AND REPLACEMENT
 LT STA. 591+38.00 - STA. 591+51.00 15'
 LT STA. 592+50.00 - STA. 592+58.00 12'
 TOTAL 27'

PAVEMENT REMOVAL
 NORB AVE 372 SQ YD

F.A.P. RTE.	SECTION	COUNTY	TOTAL SHEETS	SHEET NO.
95	*	EFFINGHAM	409	80

STA. 587+00.00 TO STA. 599+00.00
 FED. ROAD DIST. NO. 7 ILLINOIS FED. AID PROJECT
 *(6,7)Y, RS-1, 6B-1, 7B-1 & 7B-2
 CONTRACT NO. 94356

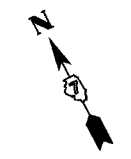

EXISTING CORNER ISLAND TO REMAIN
 BITUMINOUS MIXTURE COMPLETE FEATHERED TO MATCH EXISTING CONCRETE SURFACE. SEE ENTRANCE SCHEDULE FOR QUANTITIES.

PERMANENT SURVEY MARKERS, TYPE I
 P.I. STA. 590+74.46 1 EACH
 P.T. STA. 596+03.72 1 EACH
 TOTAL 2 EACH

FURNISHING AND ERECTING RIGHT-OF-WAY MARKERS
 50' LT STA. 591+41.69 1 EACH
 50' LT STA. 592+65.72 1 EACH
 50' LT STA. 596+03.72 1 EACH
 50' LT STA. 598+46.54 1 EACH
 TOTAL 4 EACH

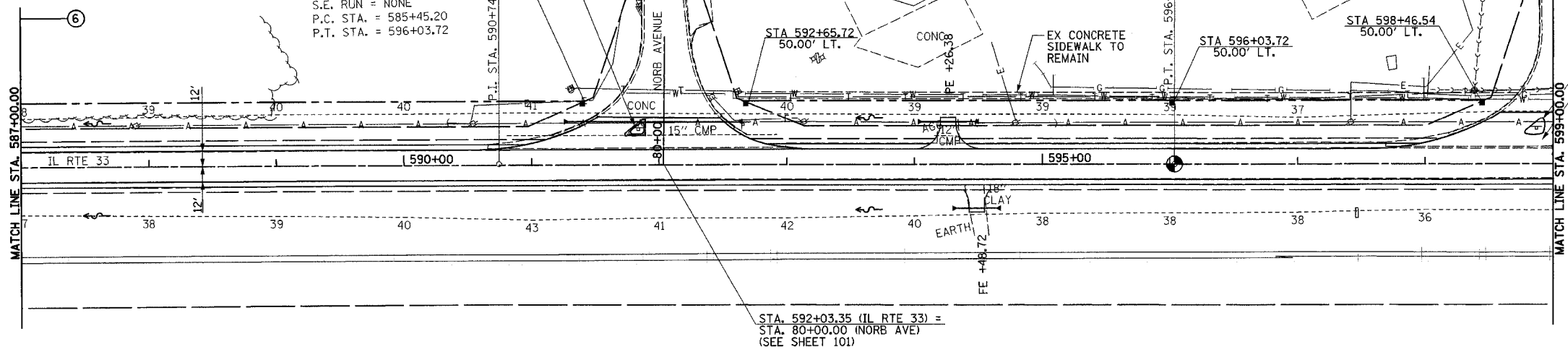

DATE	BY

PLAN
 SURVEYED
 ALIGNED
 CHECKED
 NOTE BOOK NO.
 FILE NO.

DATE	BY

PROFILE
 SURVEYED
 GRADES CHECKED
 E.M. NOTES
 STRUCTURE NOTATIONS
 NO.

