

F.A.P. RTE.	SECTION	COUNTY	TOTAL SHEETS	SHEET NO.
95	*	EFFINGHAM	409	85
STA. 647+00.00 TO STA. 659+00.00				
FED. ROAD DIST. NO. 7 ILLINOIS FED. AID PROJECT				
*(6,7)Y, RS-1, 6B-1, 7B-1 & 7BR-2				
CONTRACT NO. 94356				

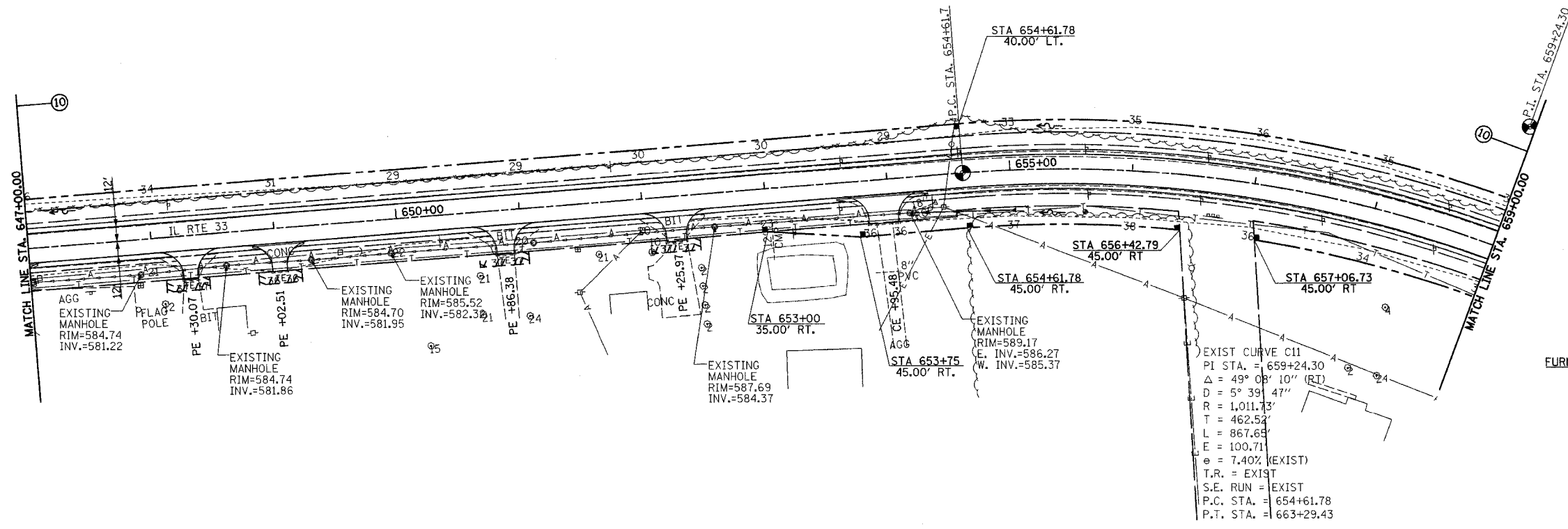

PLAN	SURVEYED	DATE
NOTE BOOK	BY	
NO.		
	CHECKED	
	BY	
	DATE	



PERMANENT SURVEY MARKERS, TYPE I
P.C. STA. 654+61.78 1 EACH

PERMANENT SURVEY MARKERS, TYPE II
P.I. STA. 659+24.30 1 EACH

FURNISHING AND ERECTING RIGHT-OF-WAY MARKERS

35' RT STA. 653+00.00	1 EACH
45' RT STA. 653+75.00	1 EACH
40' LT STA. 654+61.78	1 EACH
45' RT STA. 654+61.78	1 EACH
45' RT STA. 656+42.79	1 EACH
45' RT STA. 657+06.73	1 EACH
TOTAL	6 EACH

SEE SHEET 22 FOR STORM SEWER SCHEDULE

PROFILE	SURVEYED	DATE
NOTE BOOK	BY	
NO.		
	CHECKED	
	BY	
	DATE	

