

F.A.P. RTE.	SECTION	COUNTY	TOTAL SHEETS	SHEET NO.
95	*	EFFINGHAM	409	134
FED. ROAD DIST. NO. 7 ILLINOIS FED. AID PROJECT				
* (6,7)Y, RS-1, 6B-1, 7B-1, 7BR-2				
CONTRACT NO. 94356				

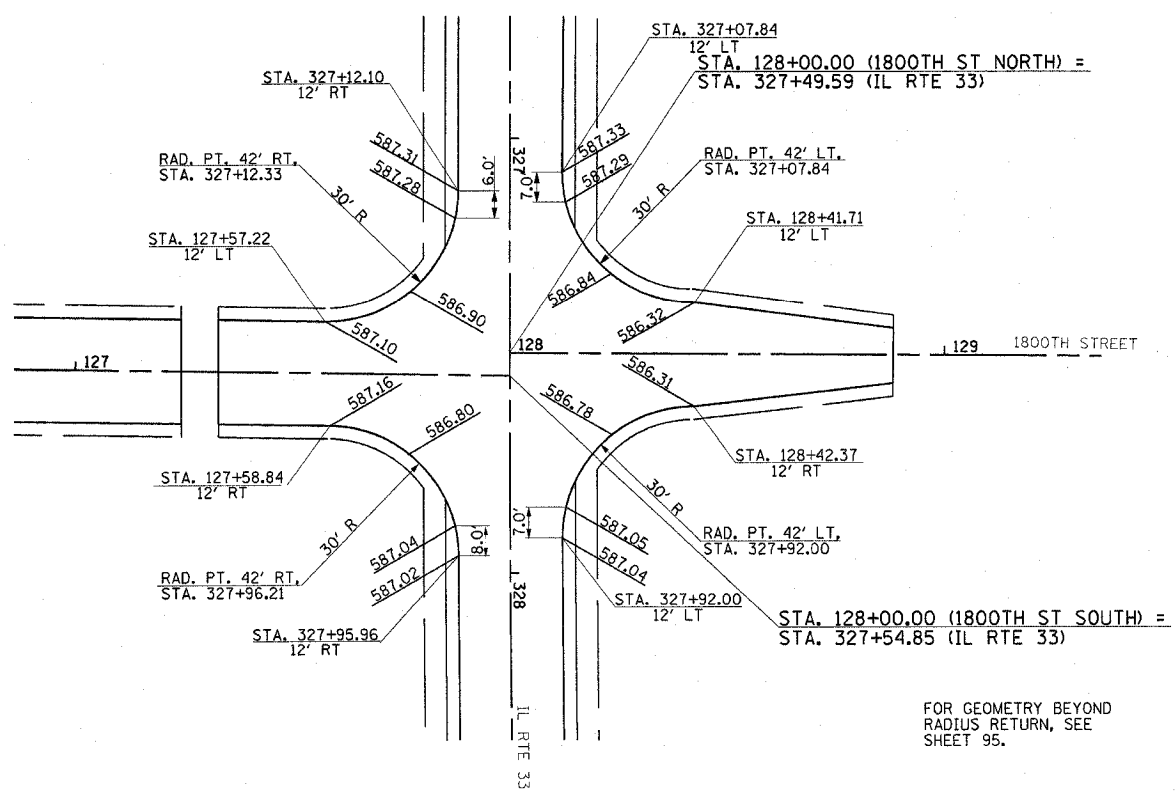

FOR GEOMETRY BEYOND RADIUS RETURN, SEE SHEET 95.

1800TH ST

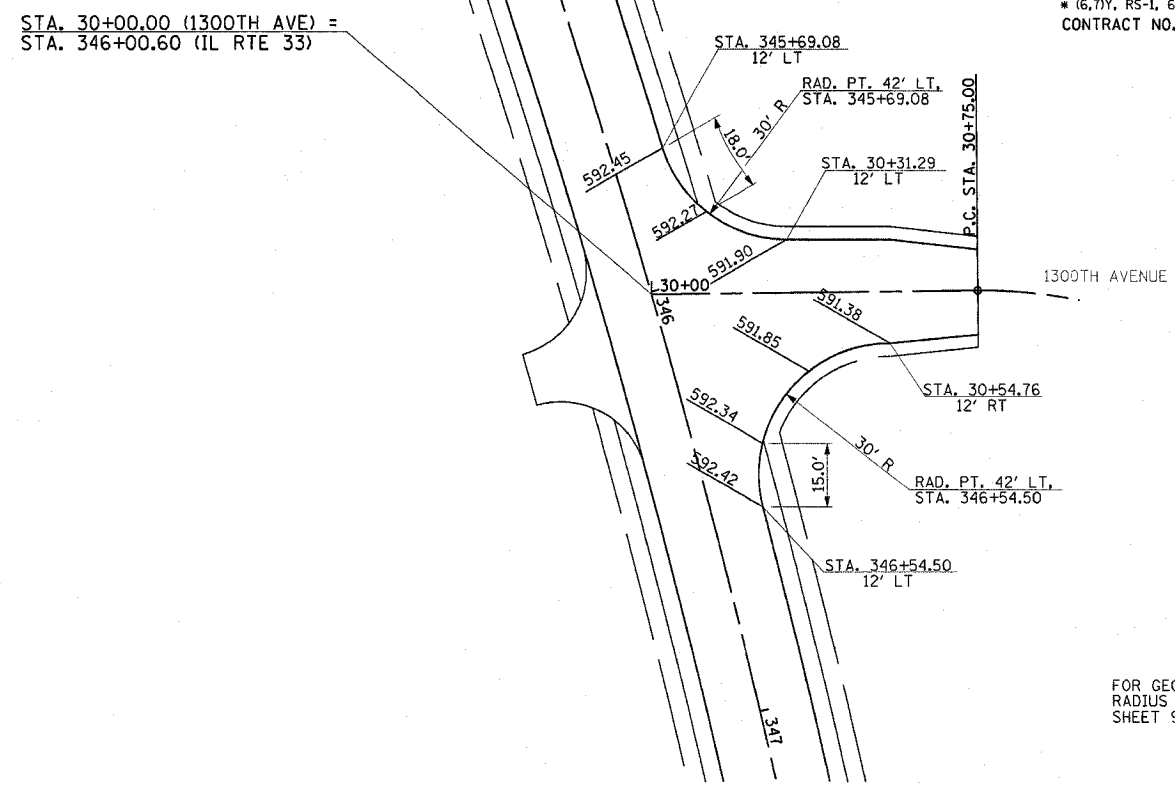

FOR GEOMETRY BEYOND RADIUS RETURN, SEE SHEET 95.

1300TH AVE

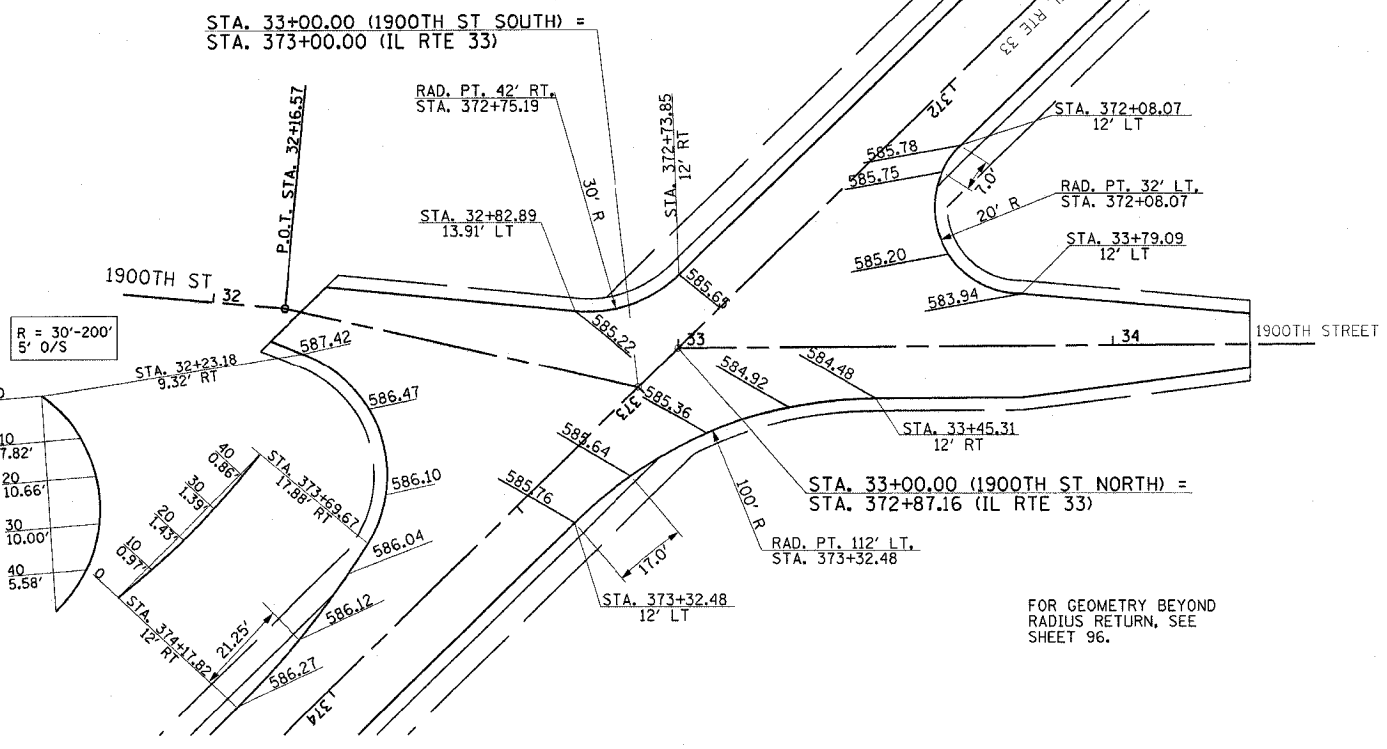

FOR GEOMETRY BEYOND RADIUS RETURN, SEE SHEET 96.

1250TH AVE

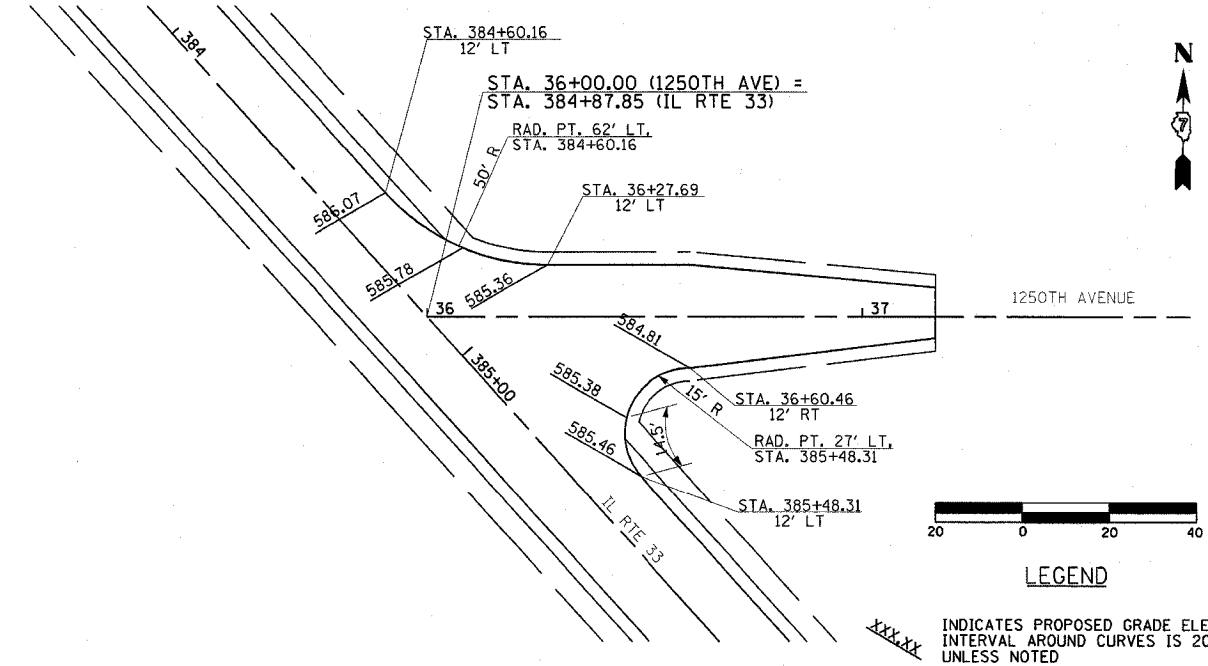

LEGEND

INDICATES PROPOSED GRADE ELEVATION INTERVAL AROUND CURVES IS 20' UNLESS NOTED

REVISIONS	
NAME	DATE

ILLINOIS DEPARTMENT OF TRANSPORTATION

INTERSECTION GEOMETRICS SHEET 5 OF 9

DATE 7/02 DRAWN BY MLO CHECKED BY RMD