

F.A.P. RTE.	SECTION	COUNTY	TOTAL SHEETS	SHEET NO.
95	*	EFFINGHAM	409	238
STA. 550+00.00		TO STA. 554+00.00		
FED. ROAD DIST. NO. 7 ILLINOIS FED. AID PROJECT				

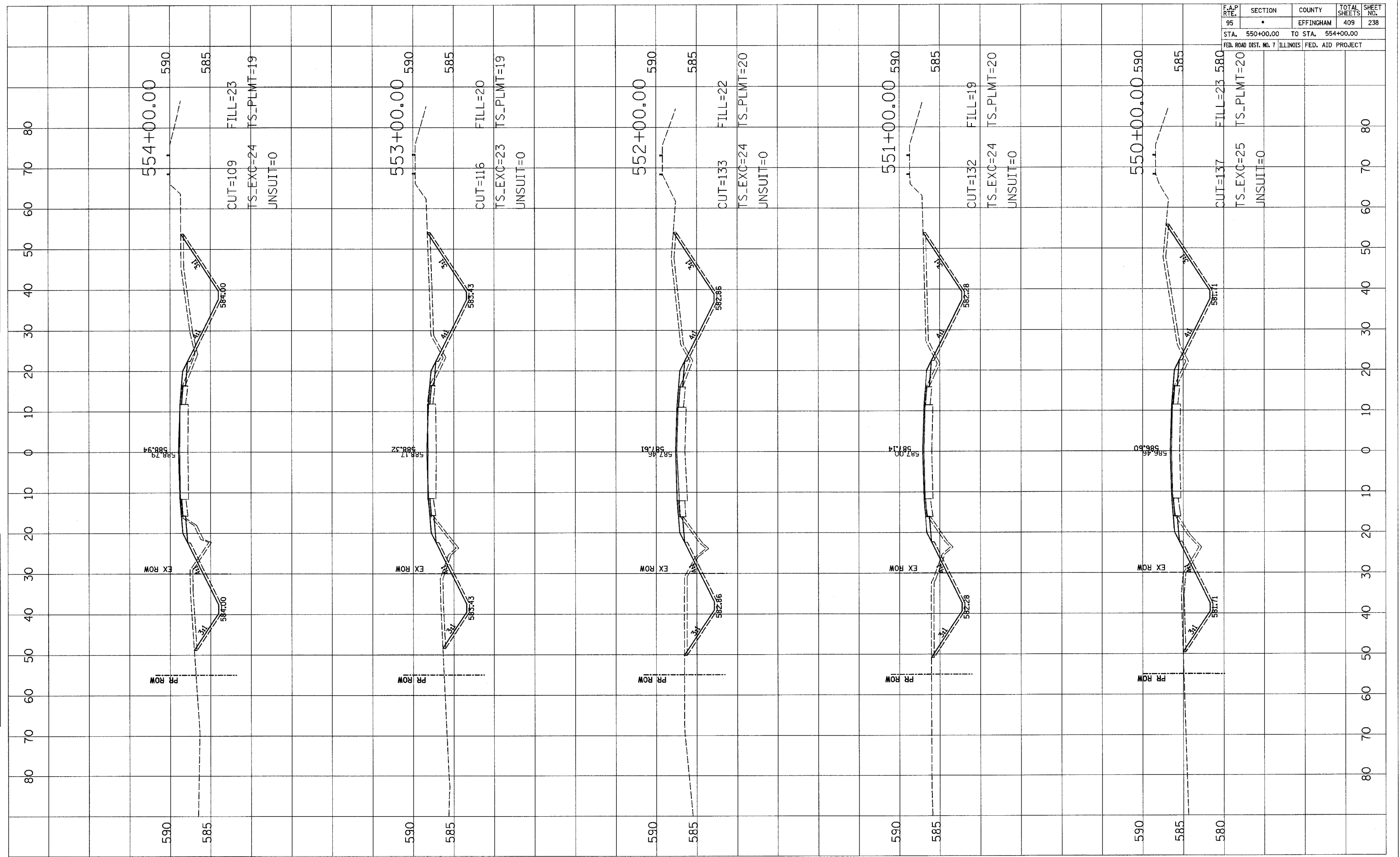

BY	DATE

FINAL SURVEY
 SURVEYED
 PLOTTED
 CHECKED
 NOTE BOOK
 AREAS CHECKED

BY	DATE

ORIGINAL SURVEY
 SURVEYED
 PLOTTED
 CHECKED
 NOTE BOOK
 AREAS CHECKED