

F.A.P. RTE.	SECTION	COUNTY	TOTAL SHEETS	SHEET NO.
95	•	EFFINGHAM	409	295A
STA.		TO STA.		
FED. ROAD DIST. NO. 7		ILLINOIS		FED. AID PROJECT

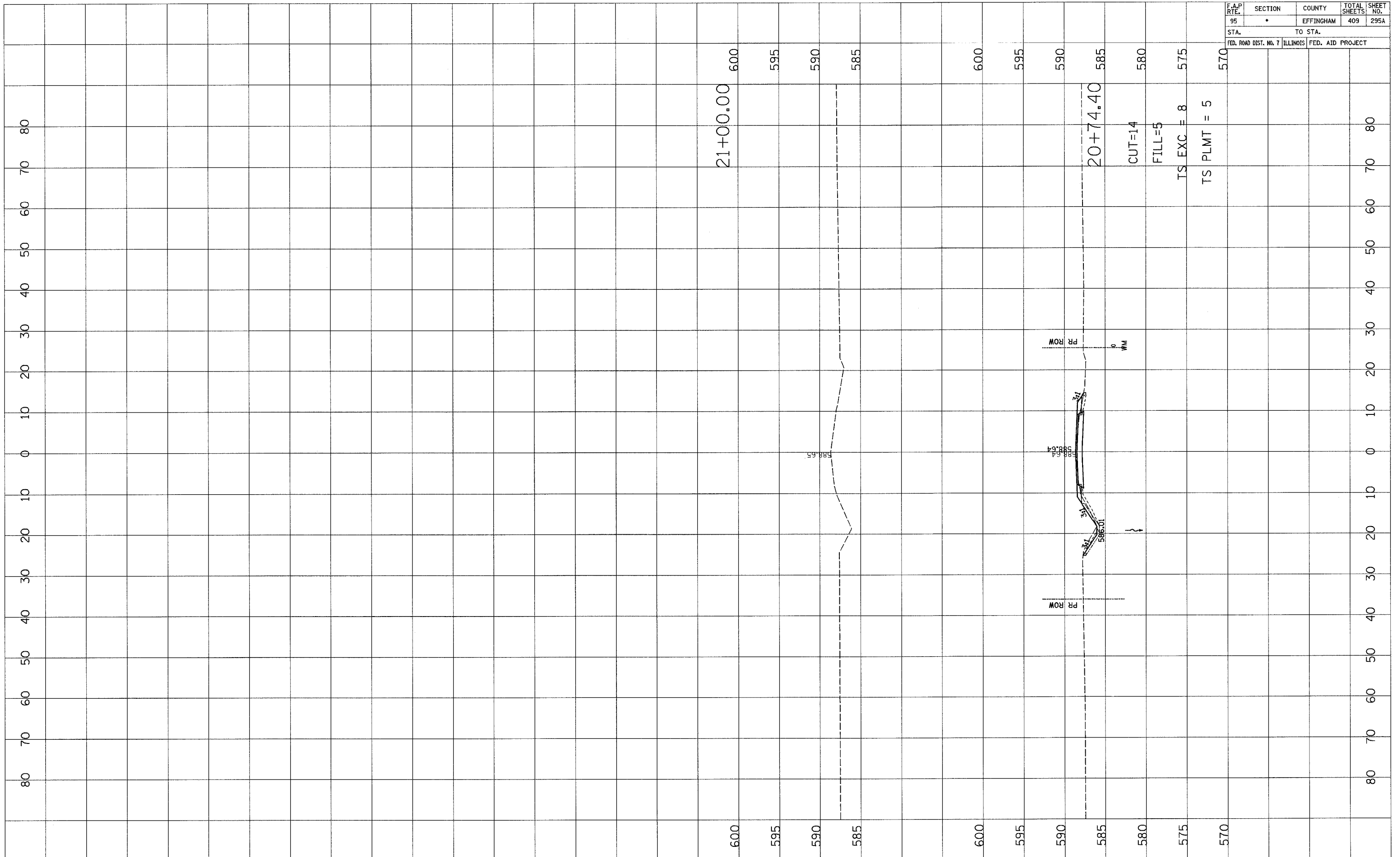

FINAL SURVEY NOTE BOOK NO.	SUBMITTED AREAS CHECKED	BY	DATE

ORIGINAL SURVEY NOTE BOOK NO.	SUBMITTED AREAS CHECKED	BY	DATE