

| F.A.P. NO. | SECTION | COUNTY | TOTAL SHEETS | SHEET NO. |
|-----------------------|---------|-----------|------------------|-----------|
| 95 | 7B-1 | EFFINGHAM | 409 | 357 |
| FED. ROAD DIST. NO. 7 | | ILLINOIS | FED. AID PROJECT | |

SHEET NO. 12
SHEETS 18

CONTRACT NO. 94356

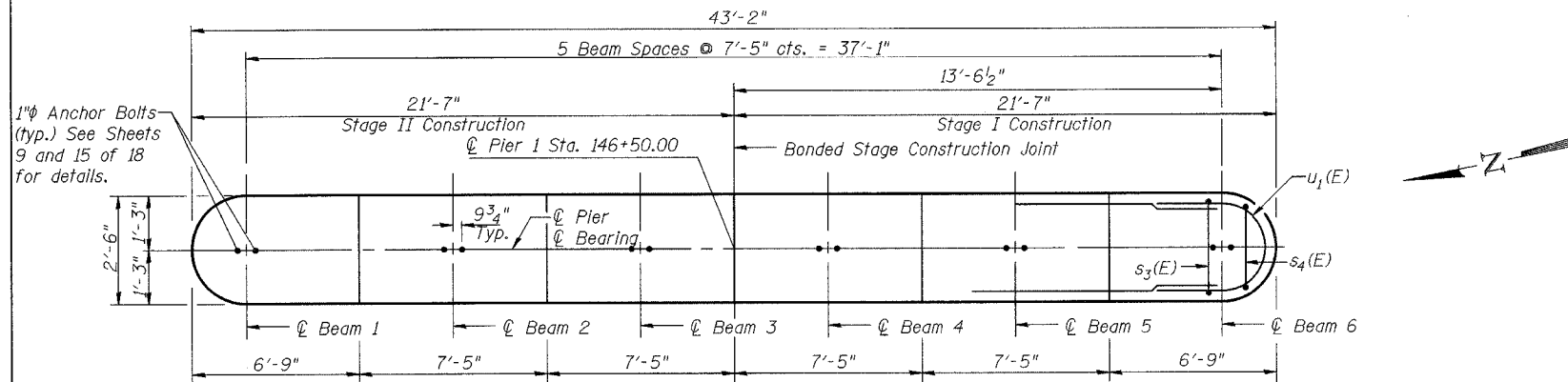

TOP PLAN

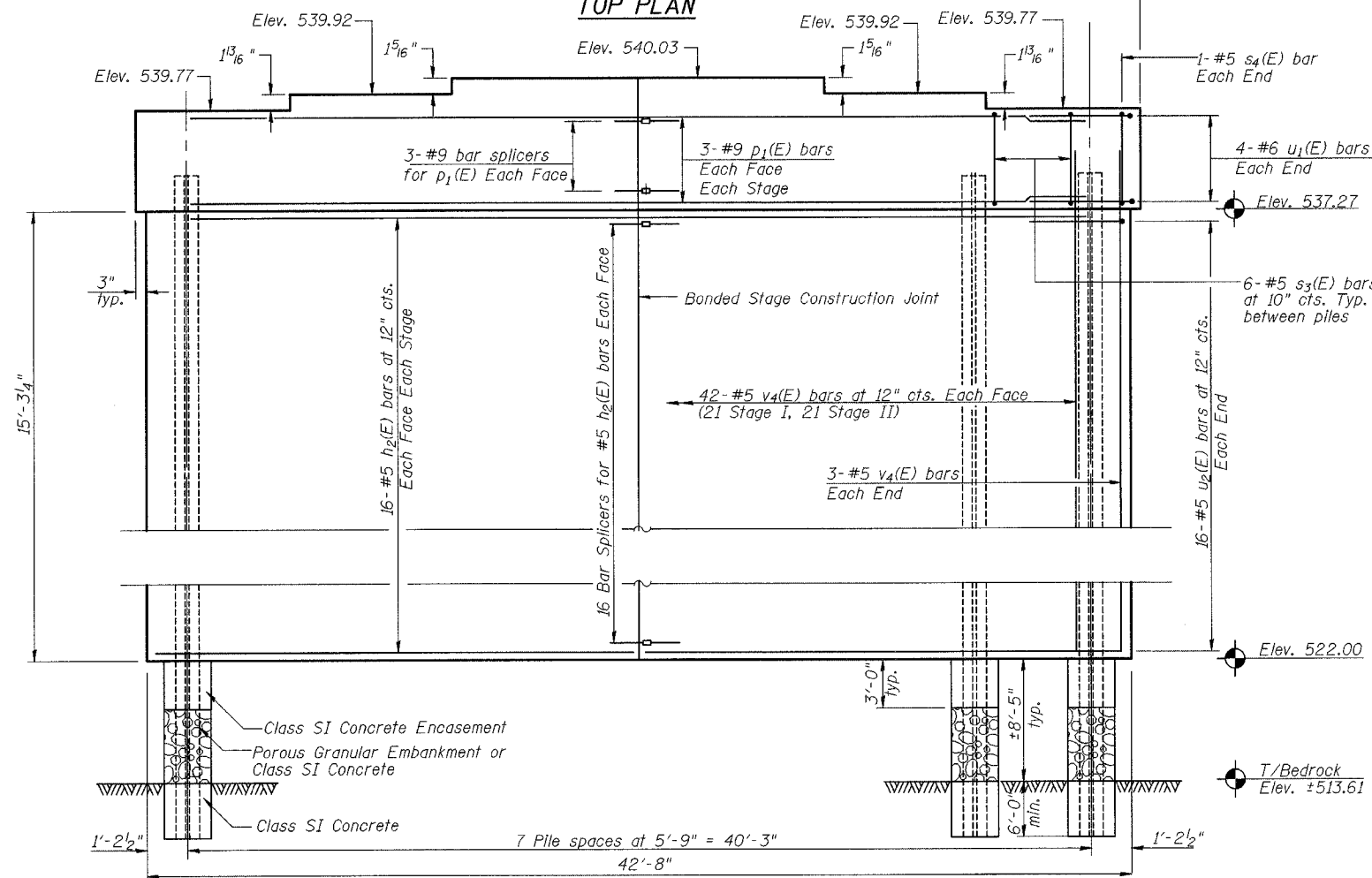

ELEVATION
(Looking East)

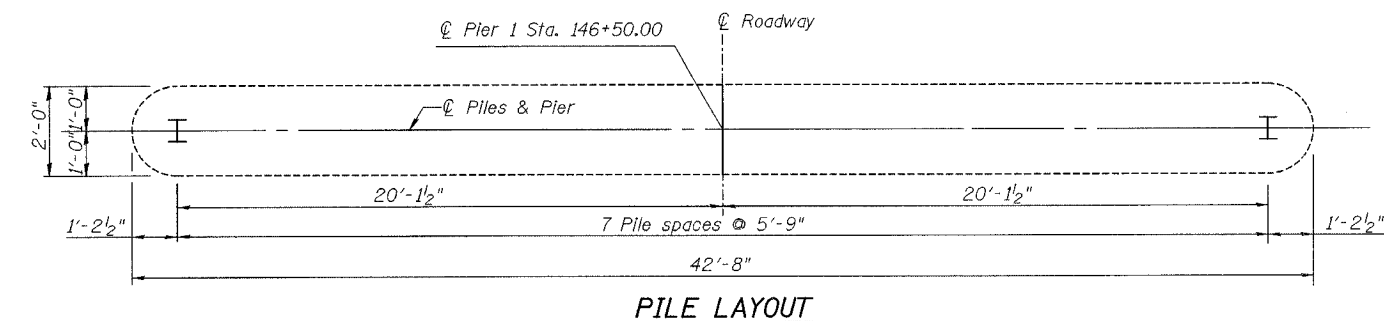

PILE LAYOUT

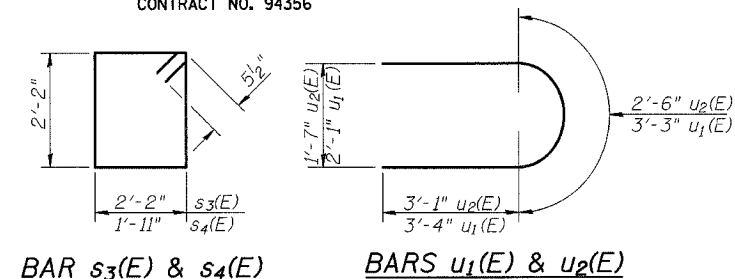

BAR s₃(E) & s₄(E)

BARS u₁(E) & u₂(E)

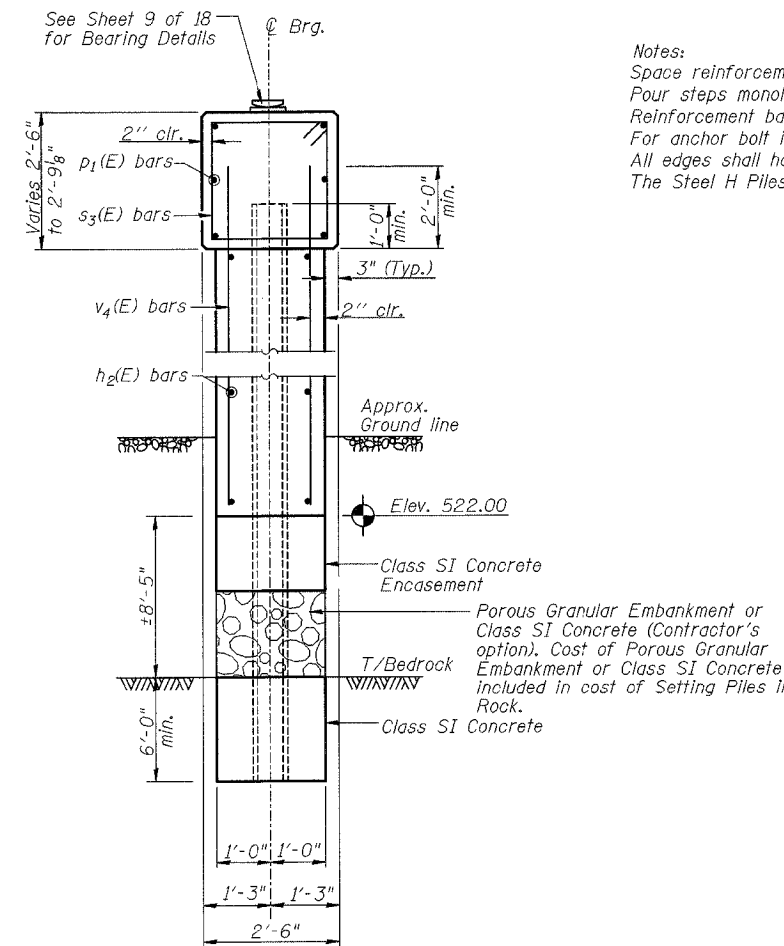

PIER SECTION

Notes:
Space reinforcement in cap to miss anchor bolts.
Pour steps monolithically with cap.
Reinforcement bars designated (E) shall be epoxy coated.
For anchor bolt installation see sheet 15 of 18.
All edges shall have standard 3/4" chamfers except as noted.
The Steel H Piles shall be according to AASHTO M270 Grade 50.

PILE DATA

Type: HP 12x74
Capacity: Set in Rock
Est. Length: 31'
No. Req'd: 8

PIER 1

BILL OF MATERIAL

| Bar | No. | Size | Length | Shape |
|---|---------|------|--------|-------|
| h ₂ (E) | 64 | #5 | 20'-2" | — |
| p ₁ (E) | 12 | #9 | 20'-2" | — |
| s ₃ (E) | 42 | #5 | 9'-7" | □ |
| s ₄ (E) | 2 | #5 | 9'-1" | □ |
| u ₁ (E) | 8 | #6 | 9'-11" | U |
| u ₂ (E) | 32 | #5 | 8'-8" | U |
| v ₄ (E) | 90 | #5 | 17'-1" | — |
| Concrete Structures | Cu. Yd. | | 58.3 | |
| Reinforcement Bars, Epoxy Coated | Pound | | 4620 | |
| Structure Excavation | Cu. Yd. | | 73 | |
| Setting Piles in Rock | Each | | 8 | |
| Underwater Structure Excavation Protection Location 1 | Each | | 1 | |
| Furnishing Steel Piles HP 12x74 | Ft. | | 248 | |

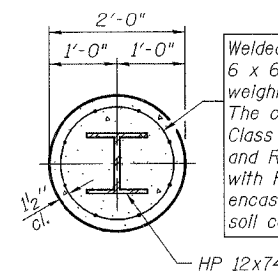

SECTION A-A

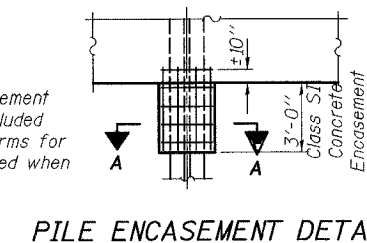

PILE ENCASEMENT DETAIL

ILLINOIS DEPARTMENT OF TRANSPORTATION
PIER 1
ILLINOIS ROUTE 33 OVER
BIG SALT CREEK
F.A.P. ROUTE 95
SECTION 7B-1
EFFINGHAM COUNTY
STA. 146+62.50
STRUCTURE NUMBER 025-0101

DATE: OCT. 2003

DRAWN BY: NJV
CHECKED BY: PBB/SJK