

staffemk
3/20/2007
c:\projects\94911\d05403pa.dgn

FAP NO.	SECTION	COUNTY	TOTAL SHEETS	SHEET NO.
116	123RS-3 122RS-4	RICHLAND	27	26

CONTRACT NO. 94911

NUMBER OF TURNS REQUIRED IN DETECTOR LOOPS														LOOP SIZE
5 X 5		6 X 6		6 X 15		6 X 30		6 X 35		6 X 40		6 X 50		
FROM	TO	FROM	TO	FROM	TO	FROM	TO	FROM	TO	FROM	TO	FROM	TO	
0	681	0	545	0	573	0	491	0	559	0	627	0	764	
682	954	546	818	574	955	492	982	560	1118	628	1255	765	1527	
955	1272	819	1145	956	1432	983	1636	1119	1864	1256	2091	1528	2545	
1273	1636	1146	1527	1433	2005	1637	2455	1865	2795	2092	3136	2546	3818	
1637	2045	1528	1964	2006	2673	2456	3436	2796	3914					
2046	2499	1965	2455	2674	3436									
		2456	3000											

THE NUMBERS IN THE TABLE REPRESENT THE DISTANCE FROM THE CABINET TO THE DETECTOR LOOP IN FEET

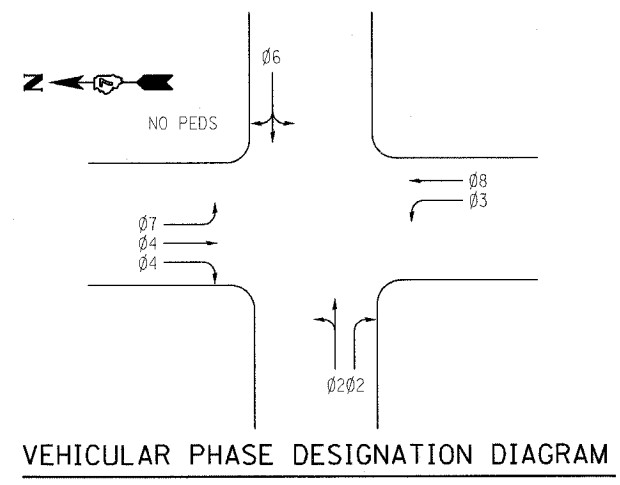
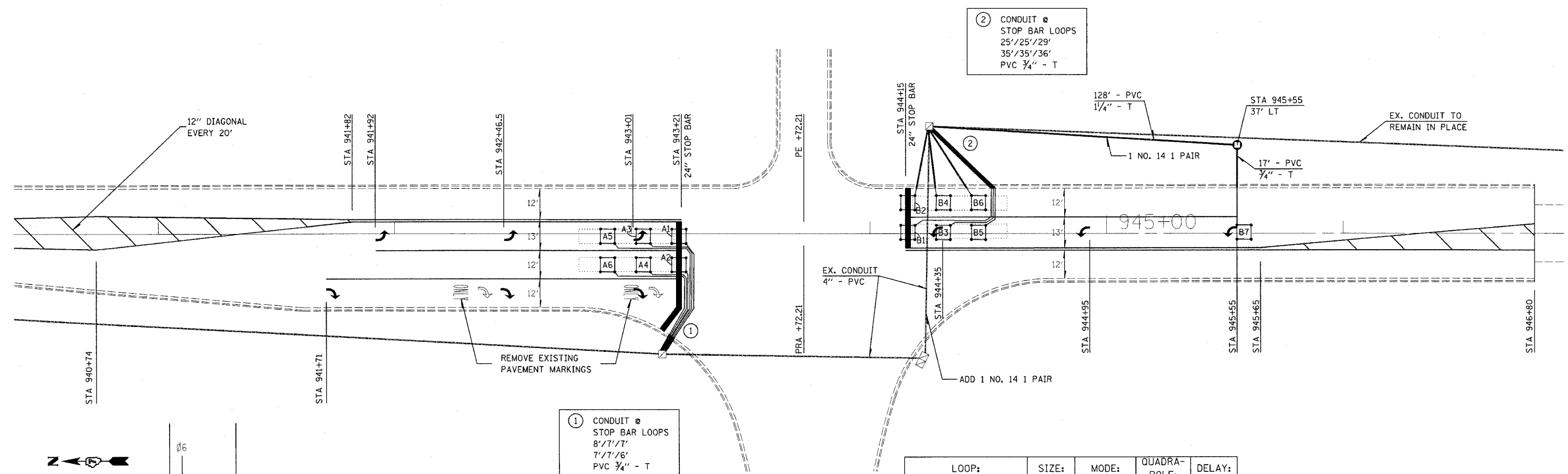

① CONDUIT @ STOP BAR LOOPS
8' / 7' / 7'
7' / 7' / 6'
PVC 3/4" - T

6' DETECTOR LOOP, TYPE 1

② CONDUIT @ STOP BAR LOOPS
25' / 25' / 29'
35' / 35' / 36'
PVC 3/4" - T

LOOP:	SIZE:	MODE:	QUADRA-POLE:	DELAY:
A1, A3, A5, A2, A4, A6 B1, B3, B5, B2, B4, B6	6X6	NORMAL	NO	0
A7, B7	6X6	EXTENDED	NO	0

THE FOLLOWING CABLES SHALL BE WIRED TO COMMON AMPLIFIERS:

(A1, A3, A5), (A2, A4, A6),
(B1, B3, B5), (B2, B4, B6),
(A7), (B7)

1 ADDITIONAL TWO CHANNEL DESIGN AMPLIFIER REQUIRED.

REVISIONS	
NAME	DATE

ILLINOIS DEPARTMENT OF TRANSPORTATION
**PAVEMENT MARKING
DETAILS & DETECTOR LOOPS**
**STA 940+50 TO
STA 946+80**
SCALE: VERT. HORIZ.
DATE: DRAWN BY: CHECKED BY: