

CADD FILE: \\1812\rs.Goldwin\F.dgn  
 PLOTTED: 01/23/2007

ORIGINAL SURVEY	DATE
SURVEYED	BY
NOTE BOOK	
EMPLATE	
AREAS	
AREAS CHECKED	

FINAL SURVEY	DATE
SURVEYED	BY
NOTE BOOK	
EMPLATE	
AREAS	
AREAS CHECKED	

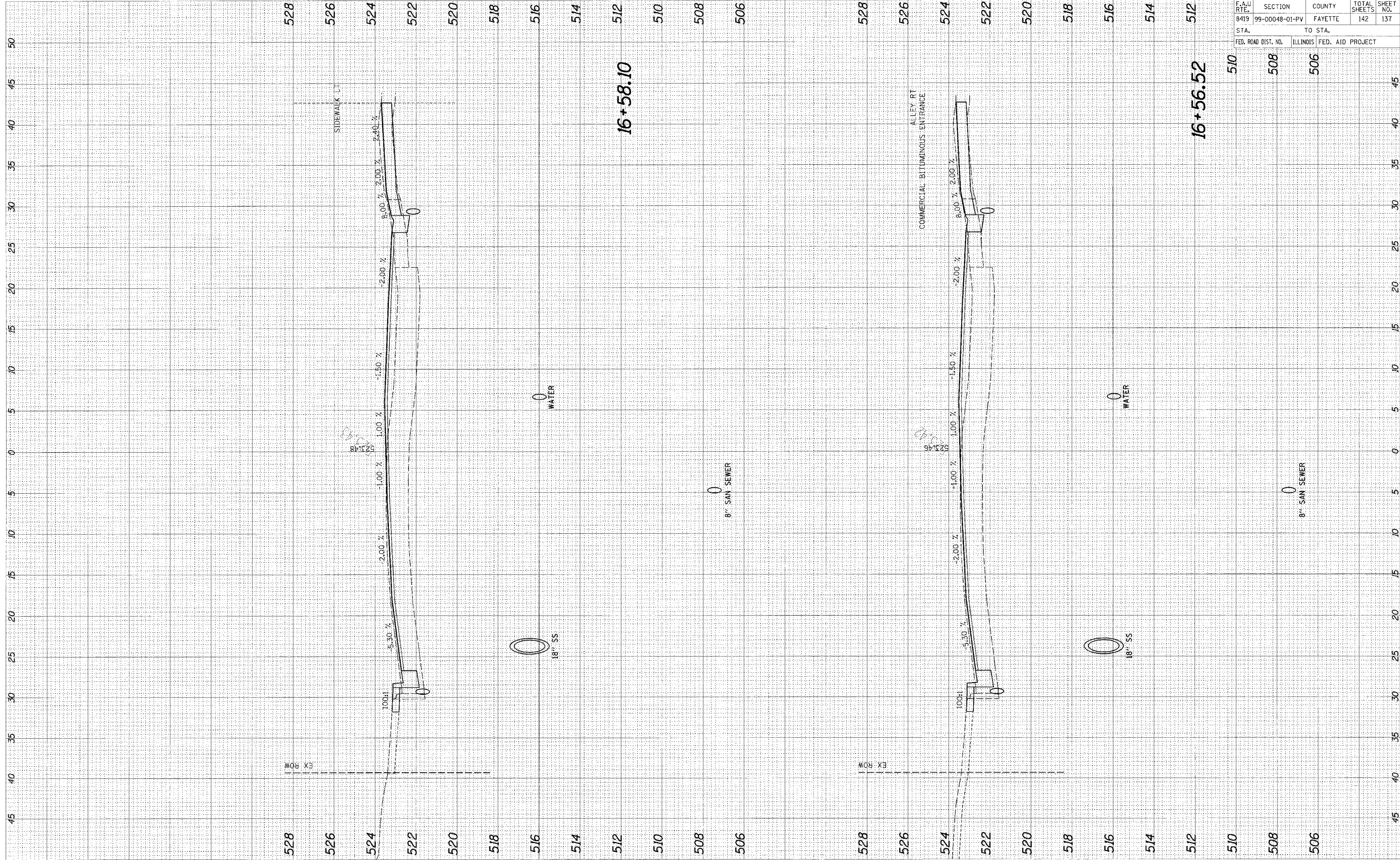

95500

F.A.U. RTE.	SECTION	COUNTY	TOTAL SHEETS	SHEET NO.
8419	99-00048-01-PV	FAYETTE	142	137
STA.		TO STA.		
FED. ROAD DIST. NO.	ILLINOIS	FED. AID PROJECT		
510	508	506		