

FOR UNDERGROUND UTILITY LOCATIONS
 CALL J.U.L.I.E. TOLL FREE 1-800-892-0123

STATE OF ILLINOIS, DISTRICT SEVEN (7)
CITY OF MATTOON, FEDERAL AID PROJECT

SECTION 06-00144-00-RS
ROUTE: F.A.U. 7695 / 14TH STREET
F.A.U. 7680 / 19TH STREET
F.A.U. 7679 / RUDY AVENUE

JOB: C-97-043-07 PROJECT: M-5042(16) CONTRACT#: 95501
FUND TYPE - SURFACE TRANSPORTATION URBAN
COLES COUNTY

INDEX OF SHEETS

PAGE#	ITEM
1	COVER
2-3	GENERAL NOTES & SUMMARY OF QUANTITIES
4-6	DETAIL SHEETS
7-15	F.A.U. 7695 14 TH STREET
16-25	F.A.U. 7680 19 TH STREET
26-35	F.A.U. 7679 RUDY AVENUE

LIST OF STANDARDS

- 000001-04
- 442201-02
- 701301-02
- 701306-01
- 701311-02
- 701501-03
- 702001-06
- 780001-01

BEGINNING AND ENDING STATIONS

F.A.U. 7695	0+00 ~ 33+82
F.A.U. 7680	0+00 ~ 34+46
F.A.U. 7679	0+41 ~ 39+53

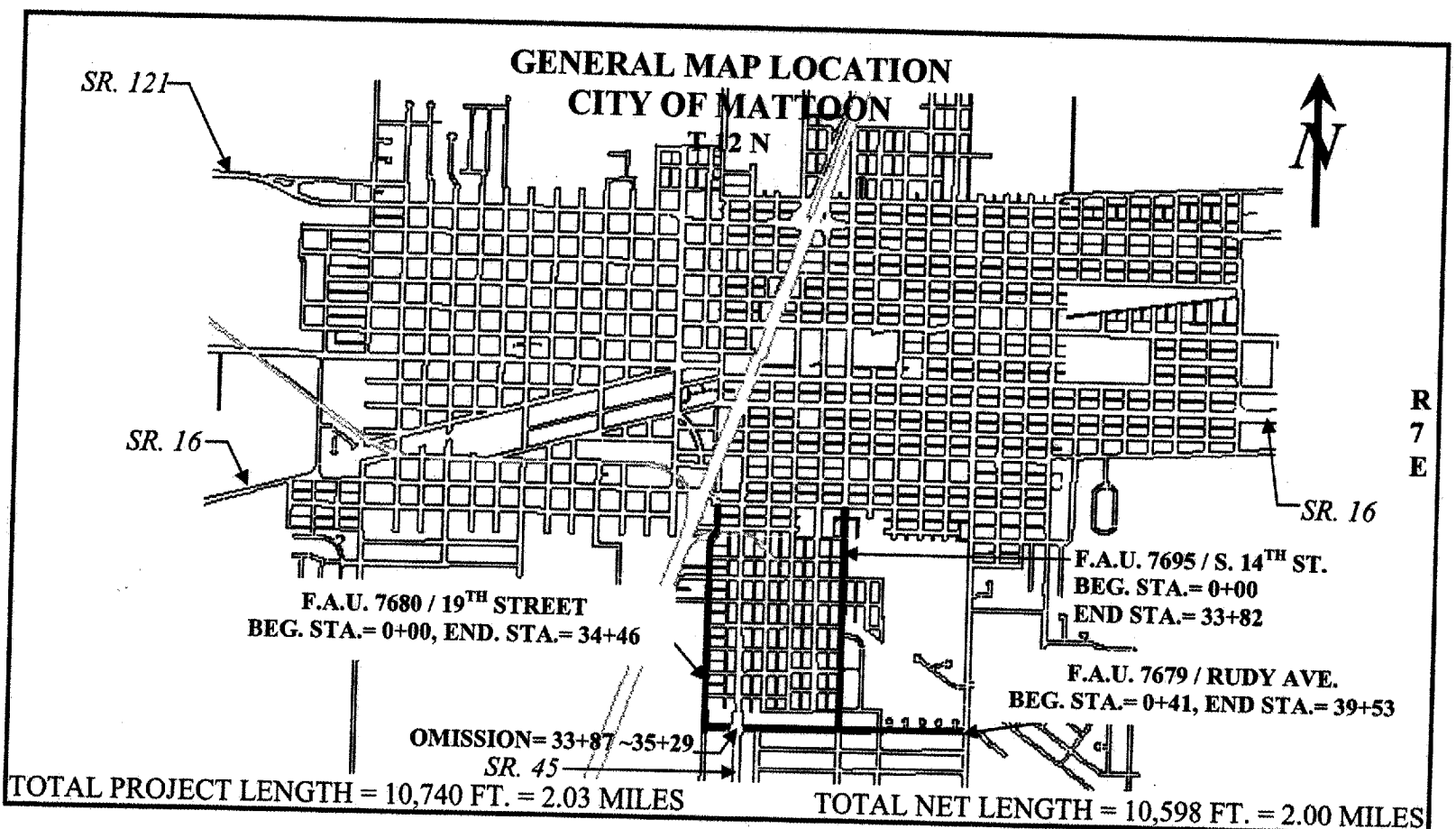

FUNCTION CLASS : URBAN COLLECTOR
 ADT : P.V. = 3403 S.U. = 58 M.U. = 6
 DESIGN SPEED : 30 MPH



David M. Wortman
David M. Wortman
 Registered P.E.
 Ill No. 062-054078
 Expires 11-30-07

CITY OF MATTOON
 208 N. 19TH STREET
 MATTOON, IL. 61938

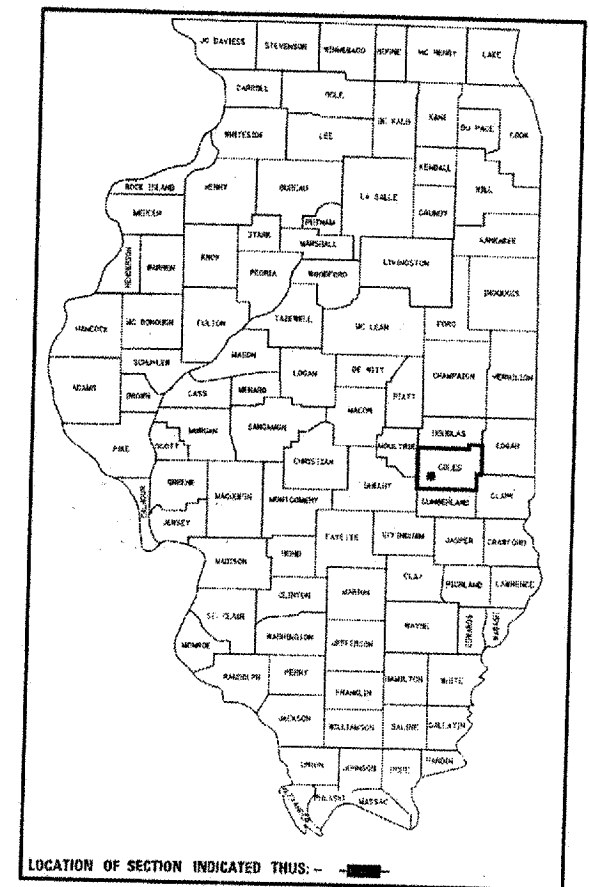

APPROVED March 20 2007
[Signature]
 CITY ENGINEER

PASSED 3/27 2007
Maureen E. Kael
 DISTRICT SEVEN ENGINEER
 OF LOCAL ROADS & STREETS

Releasing For Bid Based on Limited Review 3/27 2007
Christina M. Reed
 DEPUTY DIRECTOR OF HIGHWAYS,
 REGION FOUR ENGINEER

GENERAL NOTES:

THIS PROJECT SHALL BE CONSTRUCTED TO THE LINES AND GRADES AS SHOWN ON THE PLANS, OR AS DETERMINED BY THE ENGINEER. AT ANY TIME THE CONTRACTOR INCURS ADDITIONAL COST CONSTRUCTING THIS PROJECT TO THE LINES AND GRADES ON THE PLANS, OR AS DETERMINED BY THE ENGINEER, SUCH COST SHALL BE INCLUDED IN THE PAY ITEM INVOLVED.

TEMPORARY RAMP SLOPES SHALL BE 1:40 AND SHALL BE PLACED AT ALL BUTT JOINTS INCLUDING THOSE CREATED BY BITUMINOUS SURFACE REMOVAL OR PAVING OPERATIONS NEXT TO PROPOSED OR EXISTING PAVEMENT. THIS MATERIAL AND WORK SHALL BE INCLUDED IN THE PAY ITEM INVOLVED. THE TEMPORARY RAMPS SHALL BE REMOVED PRIOR TO PLACEMENT OF LEVELING BINDER OR SURFACE COURSE. REMOVAL OF TEMPORARY RAMPS SHALL BE INCLUDED IN THE PAY ITEM INVOLVED. AT NO TIME SHALL A ROAD OR LANE BE OPENED TO TRAFFIC DURING CONSTRUCTION WITHOUT TEMPORARY RAMPS IN PLACE AS DETERMINED BY THE ENGINEER.

ANY UNSUITABLE MATERIALS OR EXCAVATION SHALL BE DISPOSED OF BY THE CONTRACTOR AND AS DIRECTED BY THE ENGINEER. NO PAYMENT WILL BE MADE FOR OVERHAUL ON ANY MATERIAL FROM ANY SOURCE ON THIS PROJECT.

ANY OVER MILLING/REMOVAL IN DEPTH OF EXISTING SURFACE RESULTING IN INCREASED PROPOSED BITUMINOUS PAVING QUANTITIES SHALL BE AT THE EXPENSE OF THE CONTRACTOR AND NO ADDITIONAL COMPENSATION SHALL BE ALLOWED.

THE PATCHING SCHEDULES INCLUDED IN THESE PLANS REPRESENT THE BEST INFORMATION AVAILABLE AT THE TIME OF COMPLETION OF THE PLANS FOR LETTING. VARIATIONS IN LOCATION AND SIZES MAY OCCUR.

SECTION 06-00144-00-RS MIX DESIGNS

F.A.U. 7680/19th STREET MIXTURE REQUIREMENTS

LOCATION	19 th STREET, 0+00 ~ 34+46	19 th STREET, 0+25 ~ 34+46
MIXTURE USE	SURFACE	LEVEL BINDER
AC/PG	PG 64-22	PG 64-22
DESIGN AIR VOIDS	4.0 % @ Ndes = 50	4.0% @ Ndes = 50
MIX. COMPOSITION	IL 9-5	IL 9-5
(GRADATION MIX)		
FRICITION AGGREGATE	MIX D	MIX C

F.A.U. 7679/ RUDY AVE. MIXTURE REQUIREMENTS

LOCATION	RUDY AVENUE. , 0+41 ~ 39+53	RUDY AVENUE, 0+00 ~ 39+53
MIXTURE USE	SURFACE (OMIT 33+87~35+29)	LEVEL BINDER
AC/PG	PG 64-22	PG 64-22 (OMIT 33+87~35+29)
DESIGN AIR VOIDS	4.0 % @ Ndes = 50	4.0% @ Ndes = 50
MIX. COMPOSITION	IL 9-5	IL 9-5
(GRADATION MIX)		
FRICITION AGGREGATE	MIX D	MIX C

CONTINUED GENERAL NOTES:

F.A.U. 7695/ 14th STREET MIXTURE REQUIREMENTS

LOCATION	14 th STREET, 0+00 ~ 33+82
MIXTURE USE	SURFACE
AC/PG	PG 64-22
DESIGN AIR VOIDS	4.0 % @ Ndes = 50
MIX. COMPOSITION (GRADATION MIX)	IL 9-5
FRICITION AGGREGATE	MIX D

F.A.U. 7680/S. 19th STREET

PATCHING MIXTURE REQUIREMENTS

LOCATION	ALL PATCHING LOCATIONS
MIXTURE USE	PATCHING
AC/PG	PG 64-22
DESIGN AIR VOIDS	4.0% @ Ndes = 50
MIX COMPOSITIONS (GRADATION MIX)	IL 19.0
FRICITION AGGREGATE	N.A.

CITY OF MATTOON
SECTION 06-00144-00-RS
VARIOUS F.A.U. ROUTES
JOB#: C-97-043-07
PROJECT#: M5042(16)
CONTRACT #: 95501
COLES COUNTY
SHEET 3 OF 35

SUMMARY OF QUANTITIES

ITEM #	PAY ITEM	UNIT	QUANTITY
XX003140	SHORT - TERM PAVEMENT MARKING REMOVAL	FOOT	2,000.0
Z0048665	RAILROAD PROTECTION LIABILITY INSURANCE	LUMP SUM	1.0
40600100	BIFUMINOUS MATERIALS (PRIME COAT)	GALLON	2,847.0
40600300	AGGREGATE (PRIME COAT)	TON	14.0
40600625	LEVELING BINDER (MACHINE METHOD), N50	TON	791.0
40600982	HOT-MIX ASPHALT SURFACE REMOVAL - BUTT JOINT	SQ. YD.	897.0
40603335	HOT-MIX ASPHALT SURFACE COURSE, MIX "D", N50	TON	2,060.0
44201761	CLASS D PATCHES, TYPE I, 10 INCH	SQ. YD.	27.0
44201765	CLASS D PATCHES, TYPE II, 10 INCH	SQ. YD.	32.3
44201769	CLASS D PATCHES, TYPE III, 10 INCH	SQ. YD.	16.7
60300350	MANHOLE FRAMES TO BE ADJUSTED	EACH	34.0
66700105	PERMANENT SURVEY MARKERS (SPECIAL)	EACH	1.0
67100100	MOBILIZATION	LUMP SUM	1.0
70100460	TRAFFIC CONTROL AND PROTECTION, STANDARD 701306	LUMP SUM	1.0
70102620	TRAFFIC CONTROL AND PROTECTION, STANDARD 701501	LUMP SUM	1.0
70300100	SHORT-TERM PAVEMENT MARKING	FOOT	2,000.0
* 78000200	THERMOPLASTIC PAVEMENT MARKING - LINE 4"	FOOT	21,890.0
* 78000400	THERMOPLASTIC PAVEMENT MARKING - LINE 6"	FOOT	705.0
* 78000650	THERMOPLASTIC PAVEMENT MARKING - LINE 24"	FOOT	357.0
* 78000100	THERMOPLASTIC PAVEMENT MARKING - LETTERS AND SYMBOLS	SQ. FT.	244.8

* SPECIALTY ITEMS

P.E., C.E., PARKING LOT, & TWO (2) FOOT OR LESS TAPER DETAIL

CITY OF MATTOON
 SECTION 06-00144-00-RS
 F.A.U. 7695 / 14th STREET
 F.A.U. 7680 / 19th STREET
 F.A.U. 7679 / RUDY AVE.
 CONTRACT#: 95501
 COLES COUNTY
 SHEET 4 OF 35

LOCATIONS:

F.A.U. 7695 / 14th STREET

<u>Type</u>	<u>Location</u>	<u>Taper Length</u>
SOUTH LAWN ST.	Rt. 2+80	2'
SOUTH LAWN ST.	Rt. 14+30	2'
MAPLE AVE.	Rt. 19+07	2'
P.E.	Rt. 21+28	2'
P.E.	Rt. 21+78	2'
OAK AVE.	Rt. 22+64	2'
LAWSON PARK	Rt. 26+11	2'
P.E.	Rt. 31+42	2'
P.E.	Rt. 32+07	2'

LOCATIONS:

F.A.U. 7680 / 19th STREET

<u>Type</u>	<u>Location</u>	<u>Taper Length</u>
C.E.	Lt. 2+71	2'
OLIVE AVE.	Rt. 5+46	2'

LEFT AND RIGHT LANES

C~L

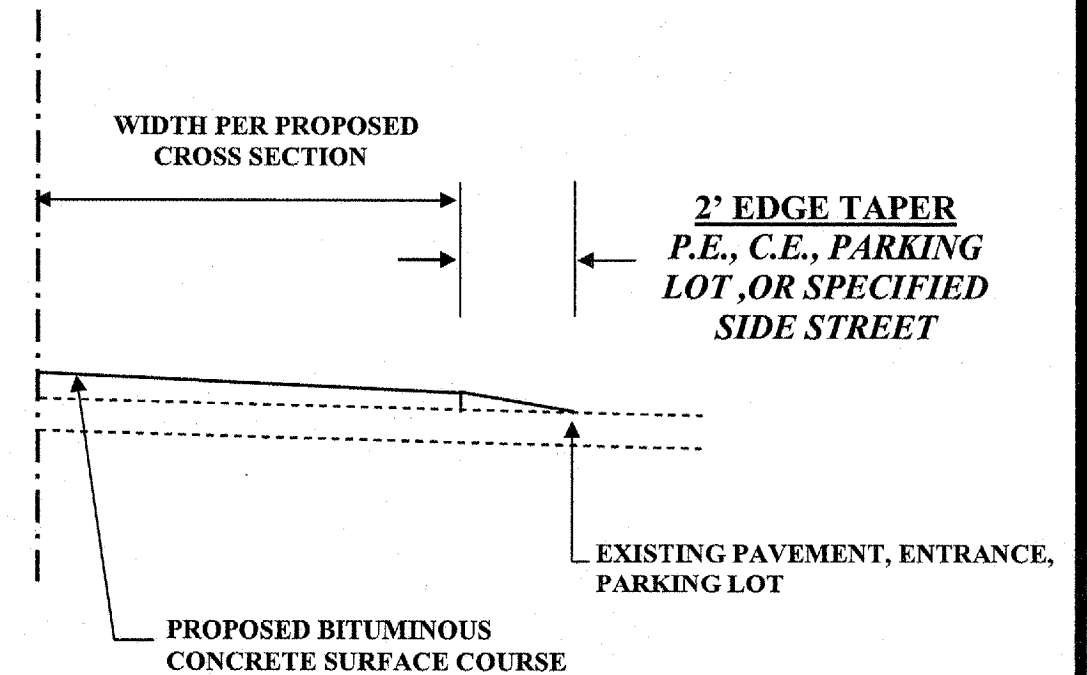

TYPICAL BITUMINOUS RUNDOWN DETAIL

CITY OF MATTOON
 SECTION 06-00144-00-RS
 F.A.U. 7695 / 14th STREET
 F.A.U. 7680 / 19th STREET
 F.A.U. 7679 / RUDY AVE.
 CONTRACT#: 95501
 COLES COUNTY
 SHEET 5 OF 35

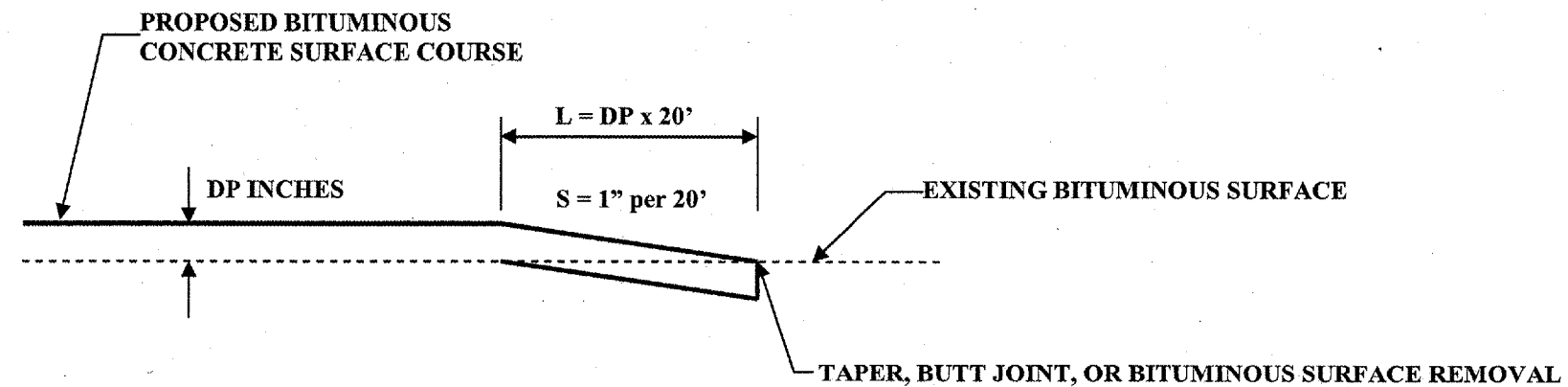

40600982 HOT MIX ASPHALT SURFACE REMOVE BUTT JOINT

<u>Location</u>	<u>Depth (DP)</u>	<u>Length of Rundown</u>	<u>Street</u>
12' Lt. - Rt., 17+30 ~ 17+45	1 1/4"	15.0' (LENGTH EXCEPTION RR TRACKS)	F.A.U. 7695 / 14 th STREET
12' Lt. - Rt., 17+51 ~ 17+66	1 1/4"	15.0' (LENGTH EXCEPTION RR TRACKS)	F.A.U. 7695 / 14 th STREET
18' Lt. - 11' Rt., 33+57 ~ 37' Lt. - 31' Rt., 33+82	1 1/4"	25.0'	F.A.U. 7695 / 14 th STREET
12' Lt. - Rt., 0+00 ~ 0+25	1 1/4"	25.0'	F.A.U. 7680 / 19 th STREET
12' Lt. - Rt., 30+60 ~ 30+75	1 1/4"	15.0' (LENGTH EXCEPTION RR TRACKS)	F.A.U. 7680 / 19 th STREET
12' Lt. - Rt., 30+81 ~ 30+96	1 1/4"	15.0' (LENGTH EXCEPTION RR TRACKS)	F.A.U. 7680 / 19 th STREET
12' Lt. - Rt., 34+21 ~ 34+46	1 1/4"	25.0'	F.A.U. 7680 / 19 th STREET
12' Lt. - Rt., 0+41 ~ 0+66	1 1/4"	25.0'	F.A.U. 7679 / RUDY AVE.
20' - 45' Lt., 12+63 ~ 13+50	1 1/4"	25.0'	F.A.U. 7679 / RUDY AVE.
19' - 30' Rt., 12+63 ~ 13+50	1 1/4"	11.0'	F.A.U. 7679 / RUDY AVE.
19' Lt. - Rt., 33+62 ~ 21' Lt. - Rt., 33+87	1 1/4"	25.0'	F.A.U. 7679 / RUDY AVE.
28' Lt. - 20' Rt., 35+29 ~ 23.5' Lt. 18' Rt., 35+54	1 1/4"	25.0'	F.A.U. 7679 / RUDY AVE.

LEVELING BINDER RUNDOWN TAPER

<u>Location</u>	<u>Depth (DP)</u>	<u>Length of Rundown</u>	<u>Street</u>
12' Lt. - Rt., 0+25 ~ 0+40	3/4"	15.0'	F.A.U. 7680 / 19 th STREET
11' Lt. - Rt., 30+45 ~ 30+60	3/4"	15.0'	F.A.U. 7680 / 19 th STREET
11' Lt. - Rt., 30+96 ~ 31+11	3/4"	15.0'	F.A.U. 7680 / 19 th STREET
11' Lt. - Rt., 34+06 ~ 34+21	3/4"	15.0'	F.A.U. 7680 / 19 th STREET
11' Lt. - Rt., 0+66 ~ 0+81	3/4"	15.0'	F.A.U. 7679 / RUDY AVE.
11' Lt. Rt., 33+47 ~ 33+62	3/4"	15.0'	F.A.U. 7679 / RUDY AVE.
11' Lt. - Rt., 35+54 ~ 35+69	3/4"	15.0'	F.A.U. 7679 / RUDY AVE.

PAVEMENT PATCHING DETAIL

CITY OF MATTOON
SECTION 06-00144-00-RS
F.A.U. 7695 / 14th STREET
F.A.U. 7680 / 19th STREET
F.A.U. 7679 / RUDY AVE.
CONTRACT#: 95501
COLES COUNTY
SHEET 6 OF 35

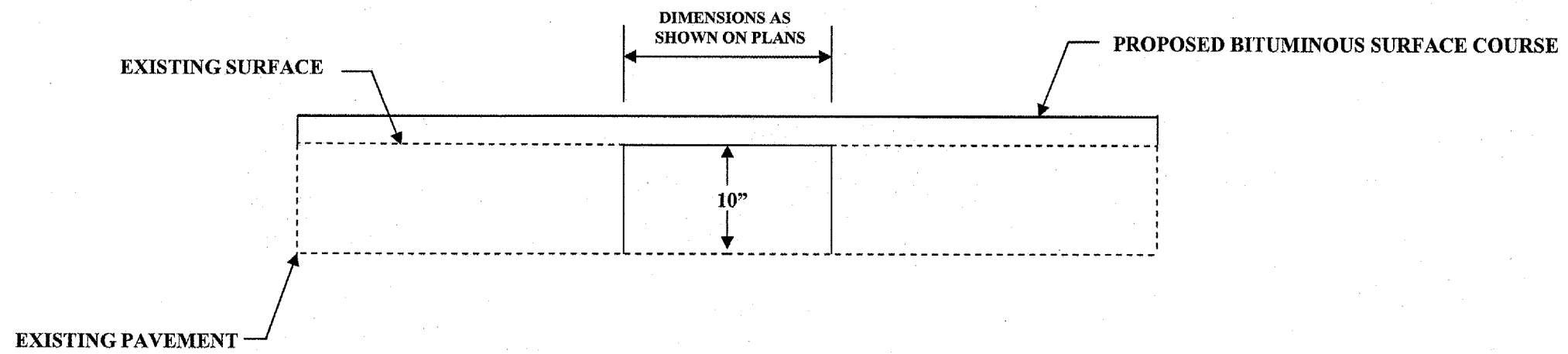

SCHEDULE OF QUANTITIES

F.A.U. 7695 / S. 14TH STREET

CITY OF MATTOON

SECTION 06-00144-00-RS

ROUTE: F.A.U. 7695

S. 14TH STREET

JOB#: C-97-043-07

PROJ#: M-5042(16)

CONTRACT#: 95501

COLES COUNTY

SHEET 7 OF 35

40600100 BITUMINOUS MATERIALS (PRIME COAT)
 Lt. ~ Rt., 0+00 ~ 33+82 =882.0 GALLON
 TOTAL =882.0 GALLON

40600300 AGGREGATE (PRIME COAT)
 Lt. ~ Rt., 0+00 ~ 33+82 =4 TON
 TOTAL =4 TON

40600982 HOT-MIX ASPHALT SURFACE REMOVAL BUTT JOINT
 12' Lt. ~ Rt., 17+30 ~ 17+45 =40.0 SQ. YD.
 12' Lt. ~ Rt., 17+51 ~ 17+66 =40.0 SQ. YD.
 11' Lt. ~ Rt., 33+57 ~ 37' Lt. ~ 31' Rt. 33+82 =98.0 SQ. YD.
 TOTAL =178.0 SQ. YD.

60300350 MANHOLE FRAMES TO ADJUST
 3' Lt., 1+38 =1 EACH
 14' Lt., 2+51 =1 EACH
 11' Rt., 17+20 =1 EACH
 4' Rt., 17+80 =1 EACH
 3' Lt., 19+03 =1 EACH
 3' Lt., 22+64 =1 EACH
 3' Lt., 25+76 =1 EACH
 4' Lt., 28+86 =1 EACH
 4' Lt., 29+03 =1 EACH
 3' Lt., 32+07 =1 EACH
 5' Lt., 33+63 =1 EACH
 TOTAL =11 EACH

7800200 THERMOPLASTIC PVT. MK. LINE 4"
DASHED 10' YELLOW 4"
 C-L., 0+25 ~ 33+50 = 830.0 FOOT
SOLID WHITE 4"
 10' Lt. & Rt., 0+25 ~ 33+50 = 5850.0 FOOT
 TOTAL = 6680.0 FOOT

78000400 THERMOPLASTIC PVT MK LINE 6"
 23.5' Lt. ~ Rt., 0+00 =47.0 FOOT
 19' Lt. ~ Rt., 0+16 =38.0 FOOT
 18' Lt. ~ 11' Rt., 33+58 =29.0 FOOT
 18' Lt. ~ 11' Rt., 33+64 =29.0 FOOT
 TOTAL =143.0 FOOT

78000100 THPL PVT MK LTR & SYM
 ~17+78 = 122.4 SQ. FT.

78000650 THERMOPLASTIC PVT MK-LINE 24"
SOLID WHITE 24" STOP BAR
 CL. ~ 17' Lt., 0+24 =17.0 FOOT
 CL. ~ 11' Rt., 33+50 =11.0 FOOT
 ~ 17+48 =72.0 FOOT
 TOTAL =100 FOOT

40603335 HOT-MIX ASPHALT SURFACE COURSE MIX "D" N50
 12' Lt. ~ Rt., 0+00 ~ 19+47 =365 TON
 12' ~ 42.5' Lt., 0+00 ~ 12' ~ 18' Lt., 0+36 =3 TON
 12' ~ 42.5' Rt., 0+00 ~ 12' ~ 18' Rt., 0+36 =3 TON
 12' Lt. ~ Rt., 19+47 ~ 33+82 =246 TON
 11' ~ 37.4' Lt., 33+53 ~ 11' ~ 37.4' Lt., 33+82 =2 TON
 11' Rt. ~ 33+63 ~ 11' ~ 31 Rt., 33+82 =1 TON
 TOTAL =620 TON

EXISTING TYPICAL CROSS SECTIONS

CITY OF MATTOON
SECTION 06-00144-00-RS
CONTRACT #: 95501
ROUTE: F.A.U. 7695 / S. 14TH ST
COLES COUNTY
SHEET 8 OF 35

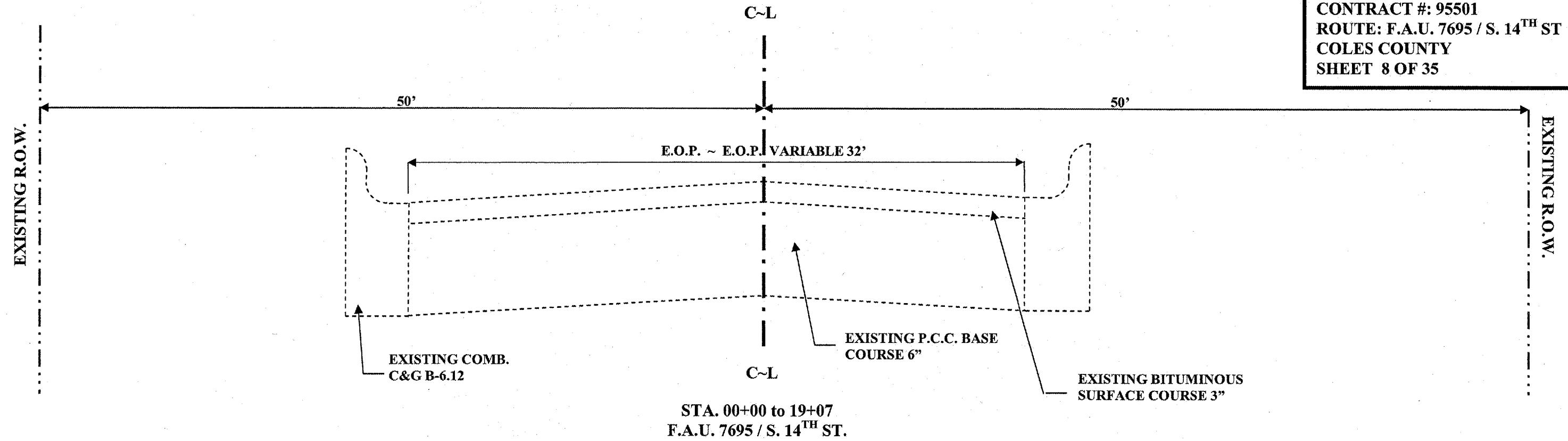

EXISTING TYPICAL CROSS SECTIONS

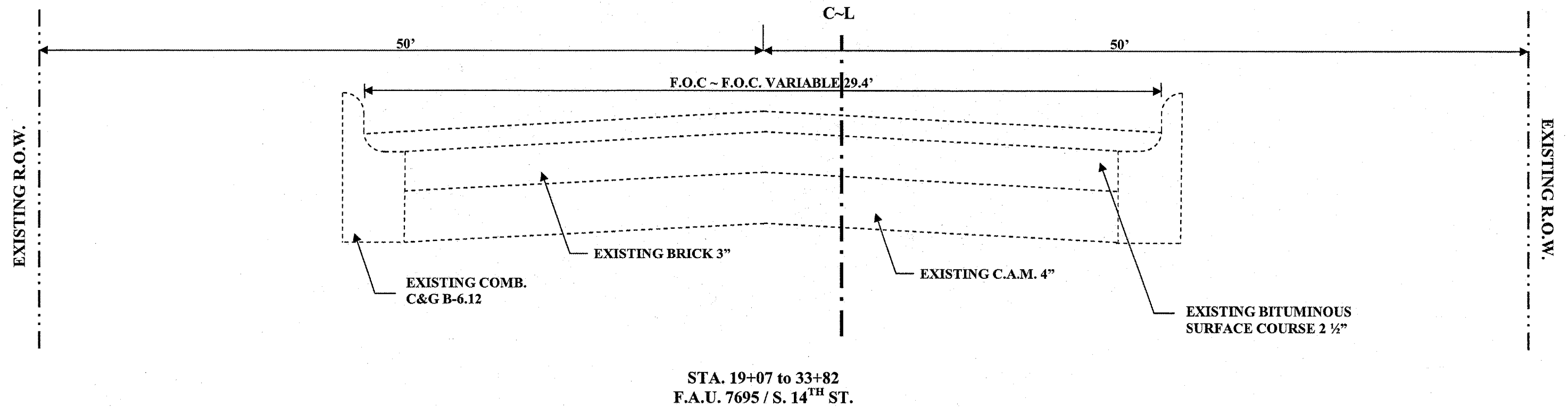

PROPOSED TYPICAL CROSS SECTIONS

CITY OF MATTOON
SECTION 06-00144-00-RS
CONTRACT #: 95501
ROUTE: F.A.U. 7695 / S. 14TH ST
COLES COUNTY
SHEET 9 OF 35

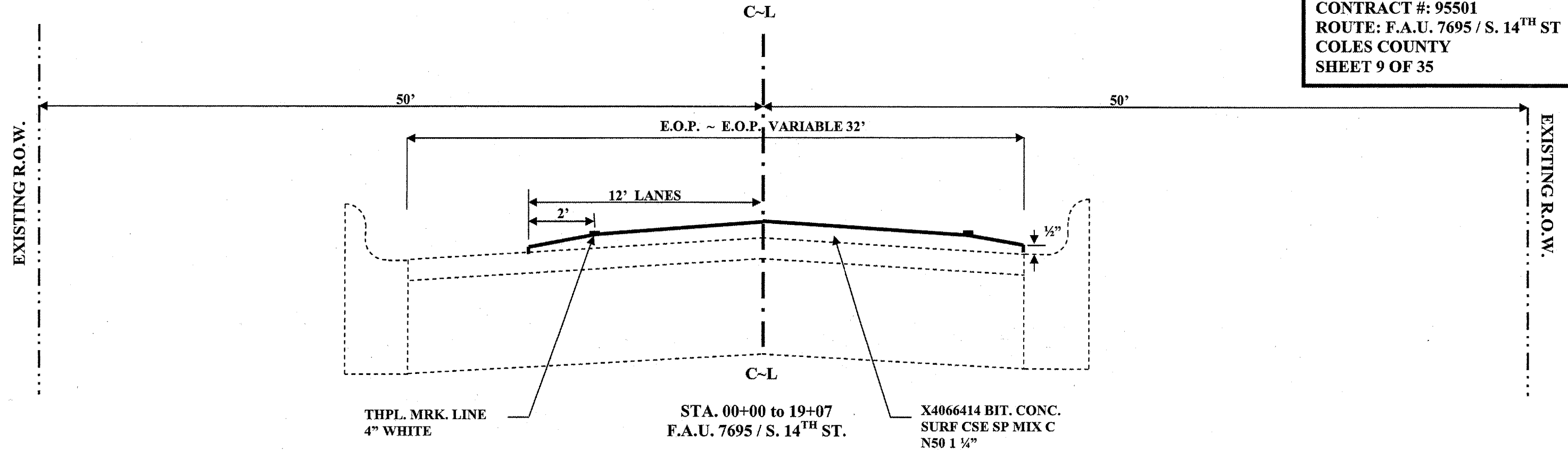

PROPOSED TYPICAL CROSS SECTIONS

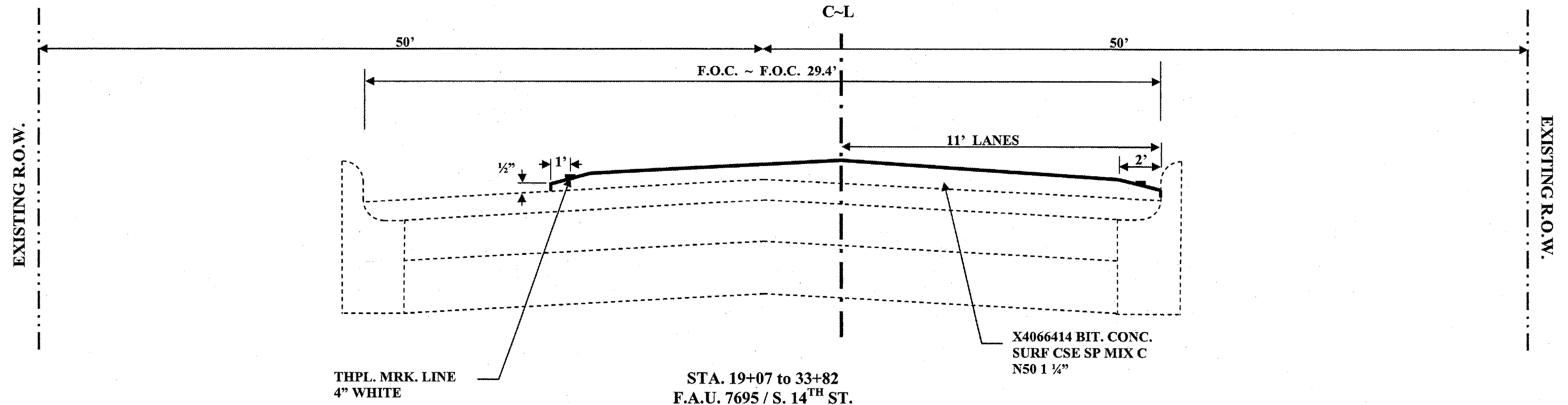

PLAN VIEW

7695 / S. 14TH STREET

CITY OF MATTOON
 SECTION 06-00144-00-RS
 ROUTE: 7695 / S. 14TH ST.
 CONTRACT: 95501
 JOB: C-97-043-07
 PROJECT: M-5042(16)
 COLES COUNTY
 SHEET 10 OF 35

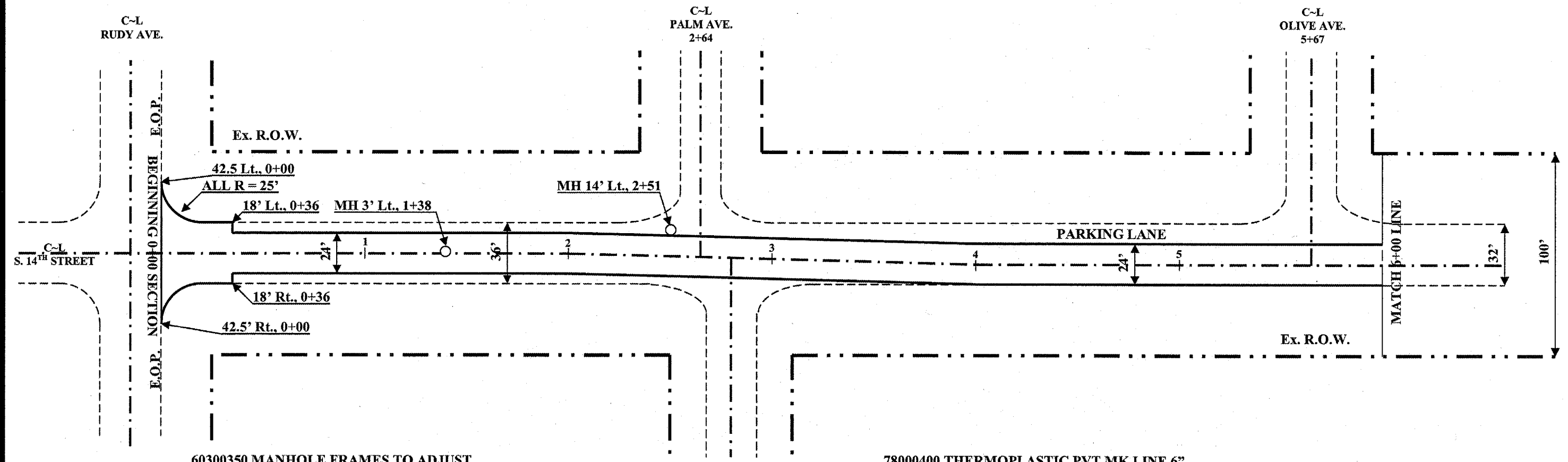

60300350 MANHOLE FRAMES TO ADJUST

3' Lt., 1+38	=1 EACH
14' Lt., 2+51	=1 EACH
TOTAL	=2 EACH

78000400 THERMOPLASTIC PVT MK LINE 6"

23.5' Lt. ~ Rt., 0+00	=47.0 FOOT
19' Lt. ~ Rt., 0+16	=38.0 FOOT
TOTAL	=85.0 FOOT

78000650 THERMOPLASTIC PVT MK LINE 24"
SOLID WHITE 24" STOP BAR

CL. ~ 17' Lt., 0+24	=17.0 FOOT
TOTAL	=17.0 FOOT

SCALE: 1" = 50'

PLAN VIEW

7695 / S.14TH STREET

CITY OF MATTOON
SECTION 06-00144-00-RS
ROUTE: 7695 / S. 14TH ST.
CONTRACT: 95501
JOB: C-97-043-07
PROJECT: M-5042(16)
COLES COUNTY
SHEET 11 OF 35

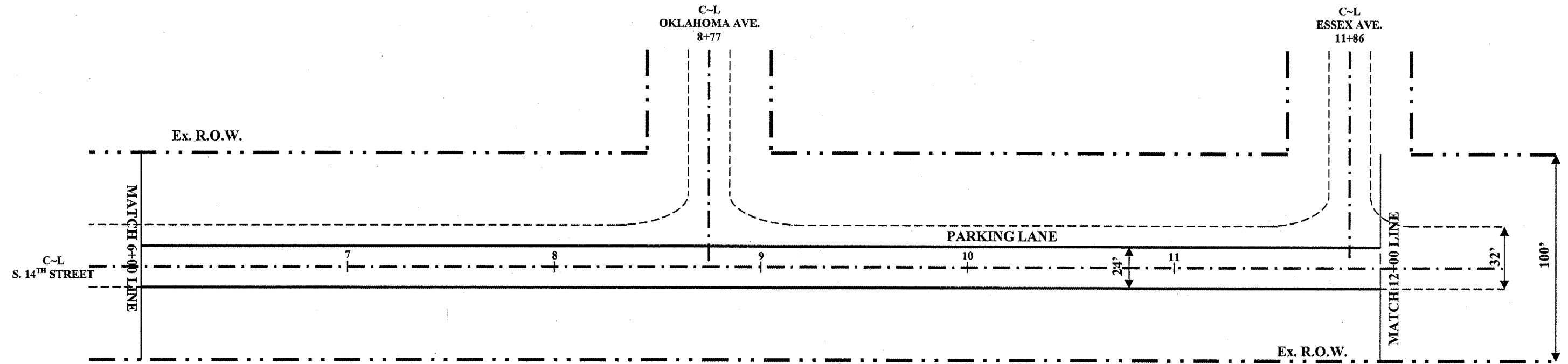

SCALE: 1" = 50'

PLAN VIEW

7695 / S.14TH STREET

CITY OF MATTOON
SECTION 06-00144-00-RS
ROUTE: 7695 / S. 14TH ST.
CONTRACT: 95501
JOB: C-97-043-07
PROJECT: M-5042(16)
COLES COUNTY
SHEET 12 OF 35

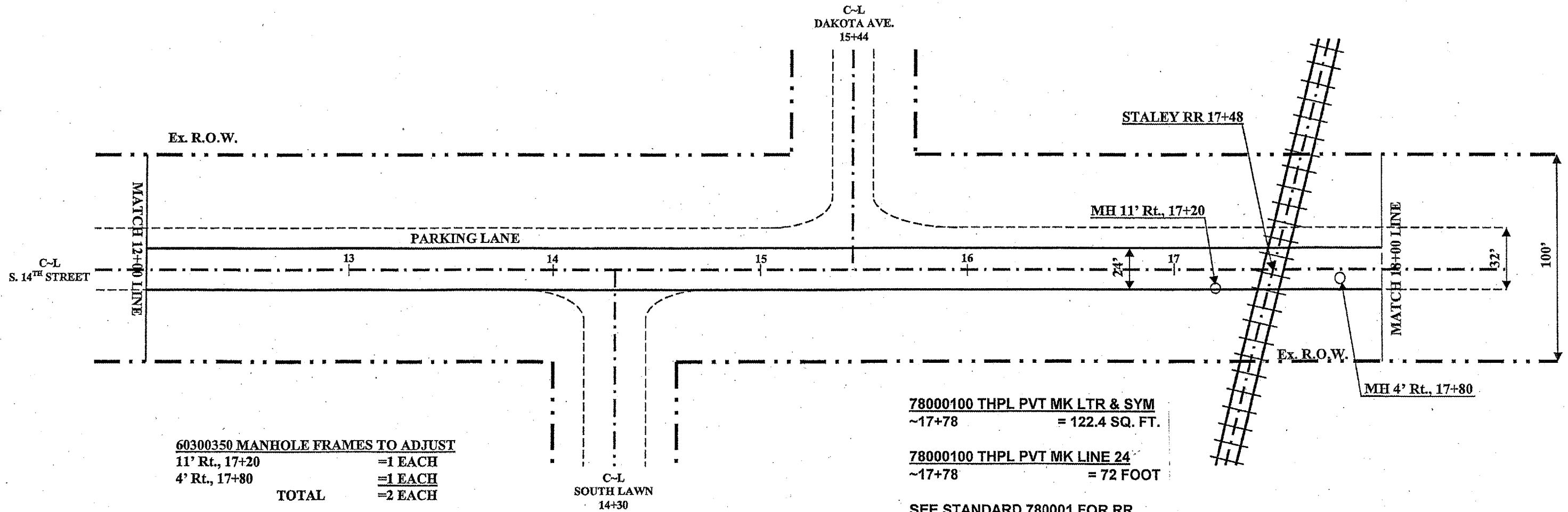

60300350 MANHOLE FRAMES TO ADJUST

11' Rt., 17+20	=1 EACH
4' Rt., 17+80	=1 EACH
TOTAL	=2 EACH

C-L
SOUTH LAWN
14+30

40600982 HOT-MIX ASPHALT SURFACE REMOVAL BUTT JOINT

12' Lt. ~ Rt., 17+30 ~ 17+45	=40.0 SQ. YD.
12' Lt. ~ Rt., 17+51 ~ 17+66	=40.0 SQ. YD.
TOTAL	=80.0 SQ. YD.

78000100 THPL PVT MK LTR & SYM
~17+78 = 122.4 SQ. FT.

78000100 THPL PVT MK LINE 24'
~17+78 = 72 FOOT

SEE STANDARD 780001 FOR RR
CROSSING STRIPING DETAILS

SCALE: 1" = 50'

PLAN VIEW

7695 / S.14TH STREET

CITY OF MATTOON
 SECTION 06-00144-00-RS
 ROUTE: 7695 / S. 14TH ST.
 CONTRACT: 95501
 JOB: C-97-043-07
 PROJECT: M-5042(16)
 COLES COUNTY
 SHEET 13 OF 35

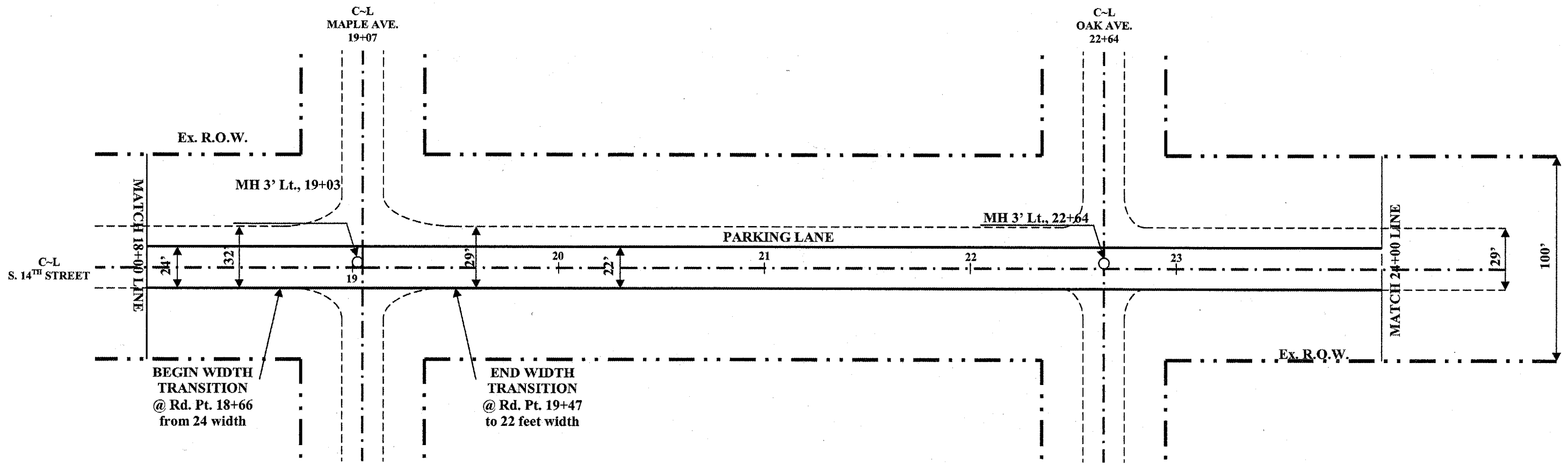

60300350 MANHOLE FRAMES TO ADJUST

3' Lt., 19+03	=1 EACH
3' Lt., 22+64	=1 EACH
TOTAL	=2 EACH

SCALE: 1" = 50'

PLAN VIEW

7695 / S.14TH STREET

CITY OF MATTOON
 SECTION 06-00144-00-RS
 ROUTE: 7695 / S. 14TH ST.
 CONTRACT: 95501
 JOB: C-97-043-07
 PROJECT: M-5042(16)
 COLES COUNTY
 SHEET 14 OF 35

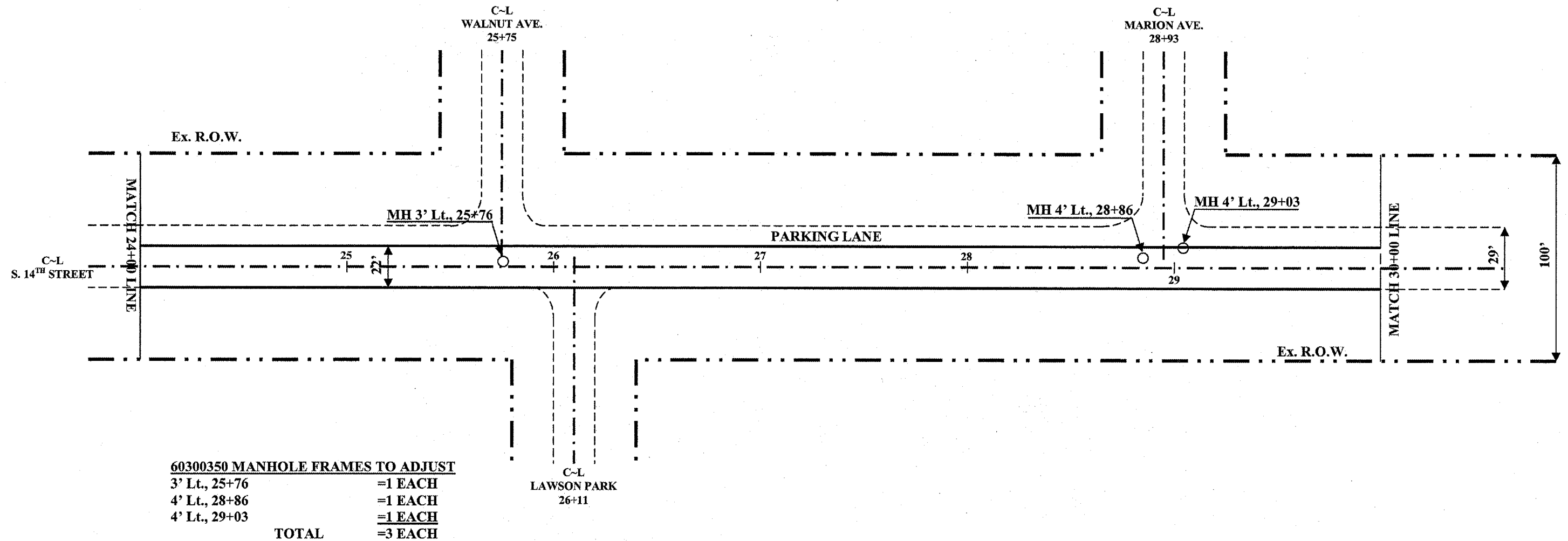

SCALE: 1" = 50'

PLAN VIEW

7695 / S.14TH STREET

CITY OF MATTOON
 SECTION 06-00144-00-RS
 ROUTE: 7695 / S. 14TH ST.
 CONTRACT: 95501
 JOB: C-97-043-07
 PROJECT: M-5042(16)
 COLES COUNTY
 SHEET 15 OF 35

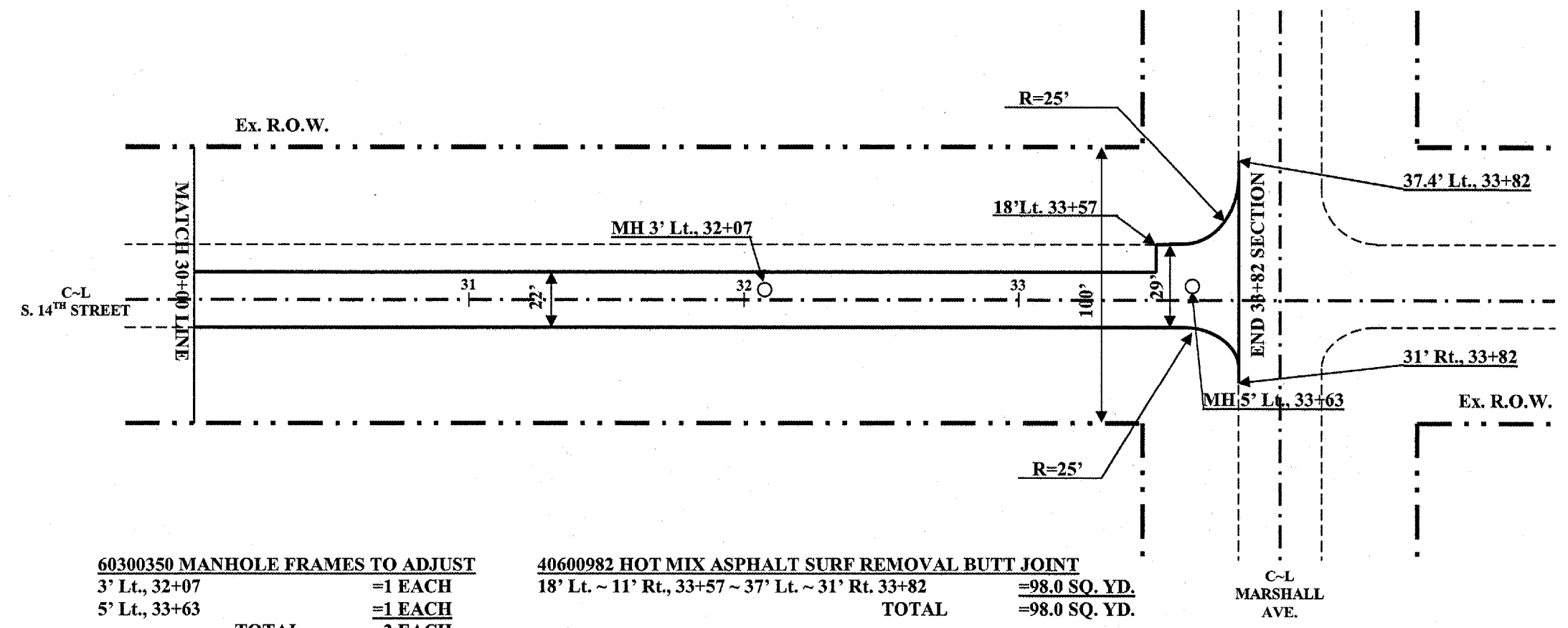

60300350 MANHOLE FRAMES TO ADJUST
 3' Lt., 32+07 =1 EACH
 5' Lt., 33+63 =1 EACH
TOTAL =2 EACH

40600982 HOT MIX ASPHALT SURF REMOVAL BUTT JOINT
 18' Lt. ~ 11' Rt., 33+57 ~ 37' Lt. ~ 31' Rt. 33+82 =98.0 SQ. YD.
TOTAL =98.0 SQ. YD.

C-L
 MARSHALL
 AVE.

78000400 THERMOPLASTIC PVT MK LINE 6"
 18' Lt. ~ 11' Rt., 33+58 =29.0 FOOT
 18' Lt. ~ 11' Rt., 33+64 =29.0 FOOT
TOTAL =58.0 FOOT

78000650 THERMOPLASTIC PVT MK LINE 24"
SOLID WHITE 24" STOP BAR
 CL. ~ 11' Rt., 33+50 =11.0 FOOT
TOTAL =11.0 FOOT

SCALE: 1" = 50'

SCHEDULE OF QUANTITIES

F.A.U. 7680/S. 19TH STREET

CITY OF MATTOON
 SECTION 06-00144-00-RS
 ROUTE: F.A.U. 7680
 S. 19TH STREET
 JOB#: C-97-043-07
 PROJ#: M-5042(16)
 CONTRACT#: 95501
 COLES COUNTY
 SHEET 16 OF 35

40600100 BITUMINOUS MATERIALS (PRIME COAT)
 Lt. ~ Rt., 0+00 ~ 34+46 =856 GALLON
 TOTAL =856 GALLON

44201765 CLASS D PATCH TYPE 2 10"
 CL. ~ 10' Lt., 6+13 ~ 6+20 =7.8 SQ. YD.
 CL. ~ 10' Rt., 6+13 ~ 6+20 =7.8 SQ. YD.
 CL. ~ 12' Lt., 19+74 ~ 19+80 =8.0 SQ. YD.
 CL. ~ 13' Rt., 19+74 ~ 19+80 =8.7 SQ. YD.
 TOTAL =32.2 SQ. YD.

7800200 THERMOPLASTIC PLASTIC PVT MK LINE 4"
DASHED 10' YELLOW 4"
 CL., 0+00 ~ 39+90 =1000.0 FOOT
SOLID WHITE 4"
 10' Lt. & Rt., 0+00 ~ 39+90 =7320.0 FOOT
 TOTAL =8320.0 FOOT

40600300 AGGREGATE (PRIME COAT)
 Lt. ~ Rt., 0+00 ~ 34+46 =4 TON
 TOTAL =4 TON

44201769 CLASS D PATCH TYPE 3 10"
 CL. ~ 12.5' Rt., 3+02 ~ 3+14 =16.7 SQ. YD.
 TOTAL =16.7 SQ. YD.

78000650 THERMOPLASTIC PVT MK LINE 24"
SOLID WHITE 24" STOP BAR
 CL. ~ 30' Rt., 39+92 =30.0 FOOT
 ~ 30+78 =60.0 FOOT
 TOTAL =90.0 FOOT

78000100 THPL PVT MK LTR & SYM
 ~30+78 = 122.4 SQ. FT.

40600982 HOT MIX ASPHALT SURFACE REMOVAL BUTT JOINT
 12' Lt. ~ Rt., 0+00 ~ 0+25 =67.0 SQ. YD.
 12' Lt. ~ Rt., 30+60 ~ 30+75 =40.0 SQ. YD.
 12' Lt. ~ Rt., 30+81 ~ 30+96 =40.0 SQ. YD.
 12' Lt. ~ Rt., 34+21 ~ 34+46 =67.0 SQ. YD.
 TOTAL =214.0 SQ. YD.

60300350 MANHOLE FRAMES TO ADJUST
 6' Rt., 0+80 =1.0 EACH
 3' Lt., 3+03 =1.0 EACH
 8' Lt., 4+47 =1.0 EACH
 12' Lt., 4+90 =1.0 EACH
 11' Lt., 5+47 =1.0 EACH
 15' Lt., 5+87 =1.0 EACH
 12' Lt., 8+73 =1.0 EACH
 1' Rt., 19+82 =1.0 EACH
 10' Rt., 28+58 =1.0 EACH
 TOTAL =9.0 EACH

40603335 HOT MIX ASPHALT SURFACE COURSE D 50
 12' Lt. ~ Rt., 0+00 ~ 34+46 =650 TON
 TOTAL =650 TON

44201761 CLASS D PATCH TYPE 1 10"
 CL. ~ 10' Lt., 11+84 ~ 11+88 =4.5 SQ. YD.
 CL. ~ 10' Rt., 11+84 ~ 11+88 =4.5 SQ. YD.
 CL. ~ 10' Lt., 18+05 ~ 18+09 =4.5 SQ. YD.
 CL. ~ 10' Rt., 18+05 ~ 18+09 =4.5 SQ. YD.
 CL. ~ 10' Lt., 18+94.5 ~ 18+98.5 =4.5 SQ. YD.
 CL. ~ 10' Rt., 18+94.5 ~ 18+98.5 =4.5 SQ. YD.
 TOTAL =27.0 SQ. YD.

66700105 PERMANENT SURVEY MARKER (SPECIAL)
 4' Rt., 3+26 =1.0 EACH
 TOTAL =1.0 EACH

40600625 LEVEL BINDER MM MIXC N50
 12' Lt. ~ Rt., 0+25 ~ 6+00 =70 TON
 11' Lt. ~ Rt., 6+00 ~ 34+21 =335 TON
 TOTAL =405 TON

EXISTING TYPICAL CROSS SECTION

CITY OF MATTOON
SECTION 06-00144-00-RS
CONTRACT #: 95501
ROUTE: F.A.U. 7675 / S. 19TH ST.
COLES COUNTY
SHEET 17 OF 35

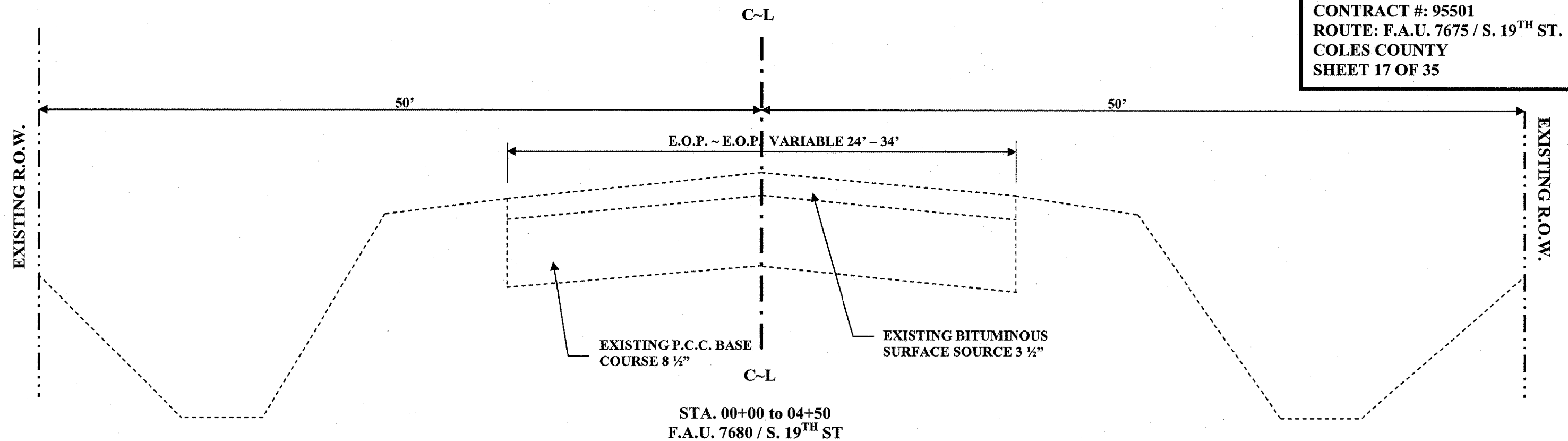

PROPOSED TYPICAL CROSS SECTIONS

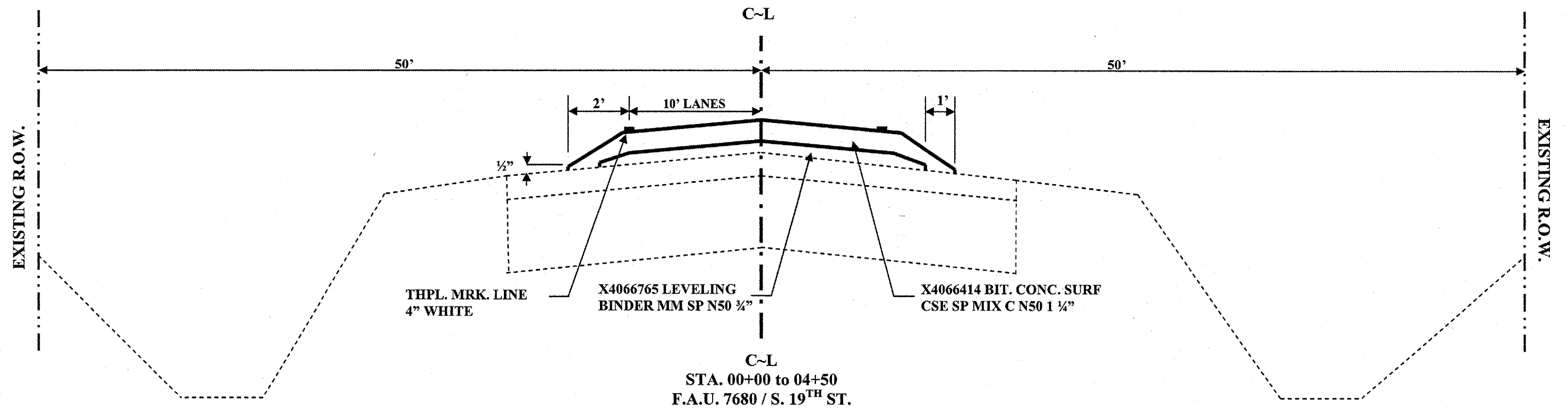

EXISTING TYPICAL CROSS SECTIONS

CITY OF MATTOON
SECTION 06-00144-00-RS
CONTRACT #: 95501
ROUTE: F.A.U. 7679 / S. 19TH ST.
COLES COUNTY
SHEET 18 OF 35

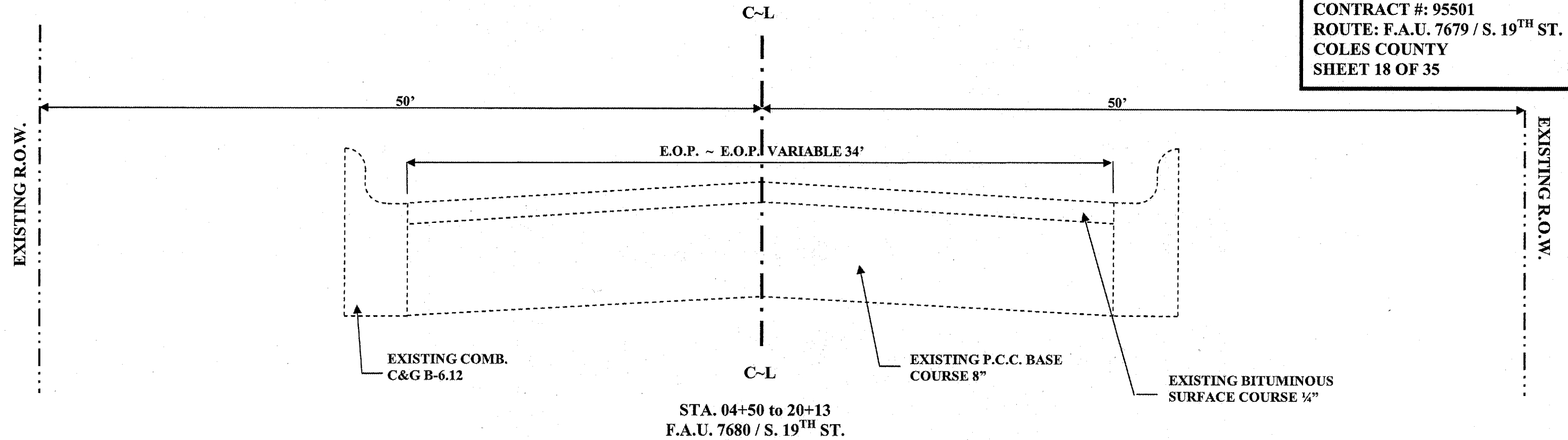

EXISTING TYPICAL CROSS SECTIONS

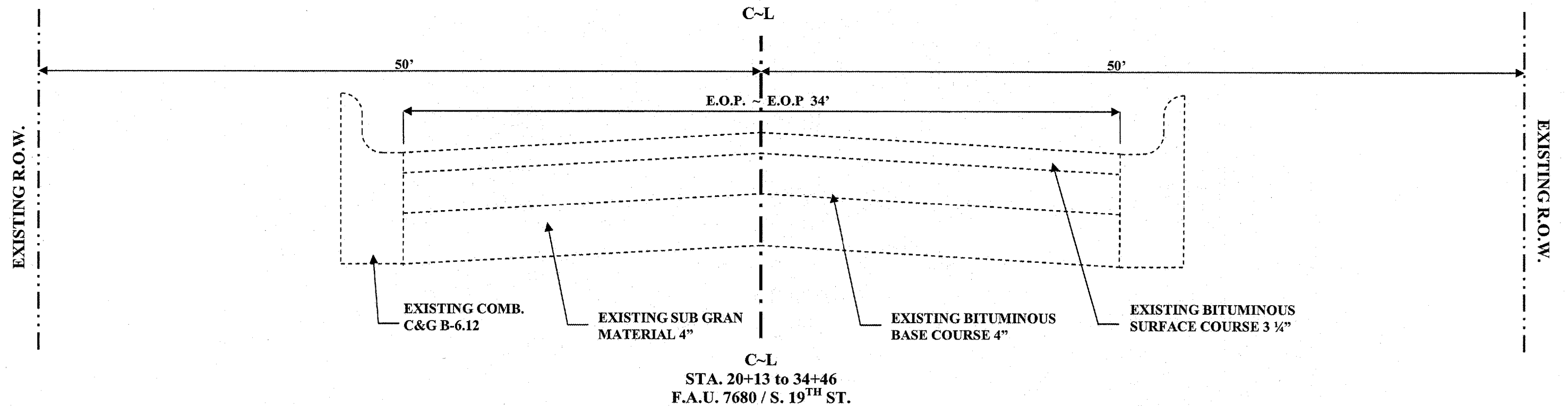

PROPOSED TYPICAL CROSS SECTIONS

CITY OF MATTOON
SECTION 06-00144-00-RS
CONTRACT #: 95501
ROUTE: F.A.U. 7680 / S. 19TH ST.
COLES COUNTY
SHEET 19 OF 35

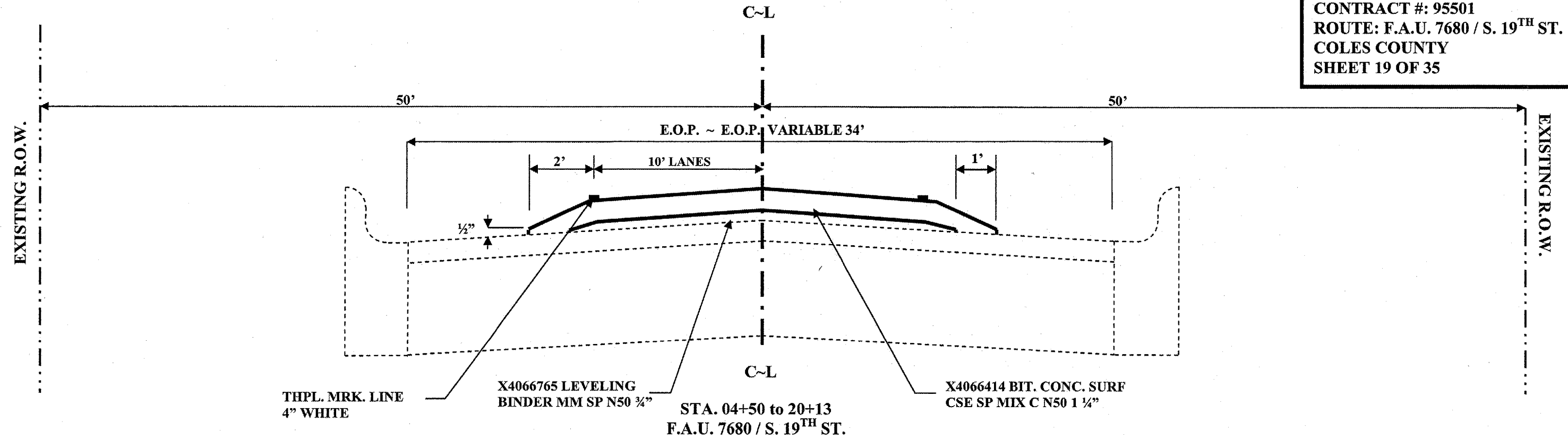

PROPOSED TYPICAL CROSS SECTIONS

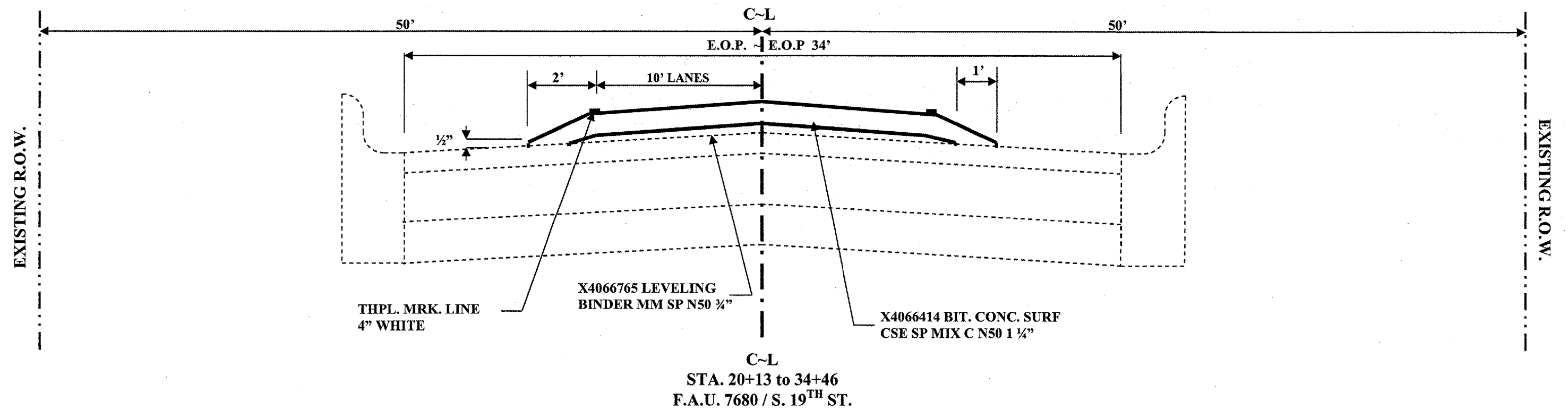

PLAN VIEW

7680 / S. 19TH ST.

CITY OF MATTOON
SECTION 06-00144-00-RS
ROUTE: 7680 / S. 19TH ST.
COLES COUNTY
SHEET 20 OF 35

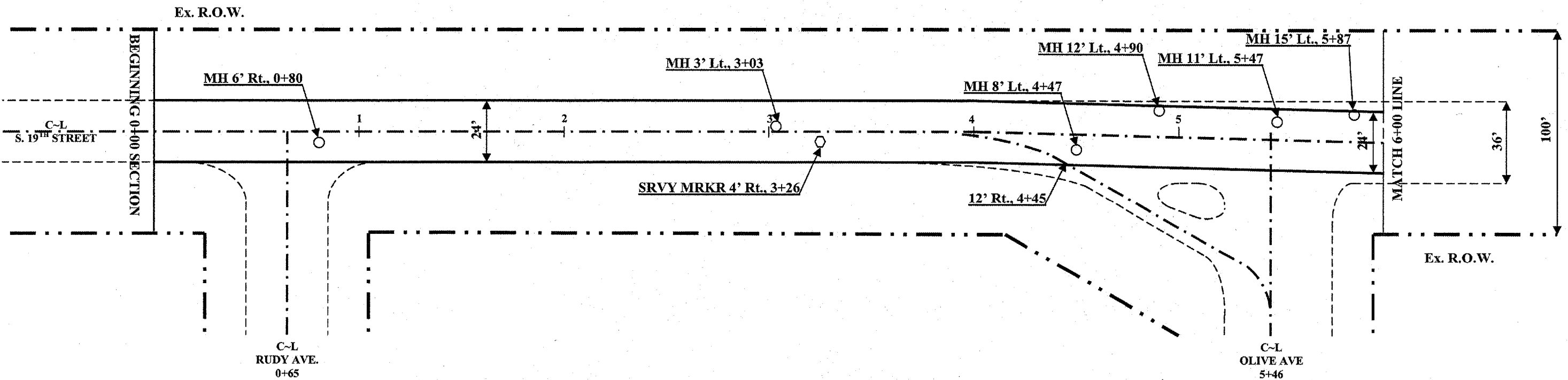

60300350 MANHOLE FRAMES TO ADJUST

6' Rt., 0+80	=1 EACH
3' Lt., 3+03	=1 EACH
8' Lt., 4+47	=1 EACH
12' Lt., 4+90	=1 EACH
11' Lt., 5+47	=1 EACH
15' Lt., 5+87	=1 EACH
TOTAL	=6 EACH

44201769 CLASS D PATCH TYPE 3 10"

CL. ~ 12.5' Rt., 3+02 ~ 3+14	=16.7 SQ. YD.
TOTAL	=16.7 SQ. YD.

66700105 PERMANENT SURVEY MARKER (SPECIAL)

4' Rt., 3+26	=1 EACH
TOTAL	=1 EACH

40600982 HOT MIX ASPHALT SURF REMOVAL BUTT JOINT

12' Lt. ~ Rt., 0+00 ~ 0+25	=67.0 SQ. YD.
TOTAL	=67.0 SQ. YD.

CONTRACT: 95501
JOB: C-97-043-07
PROJECT: M-5042(16)
SCALE: 1" = 50'



PLAN VIEW
7680 / S. 19TH ST.

CITY OF MATTOON
SECTION 06-00144-00-RS
ROUTE: 7680 / S. 19TH ST.
CONTRACT#: 95501
COLES COUNTY
SHEET 21 OF 35

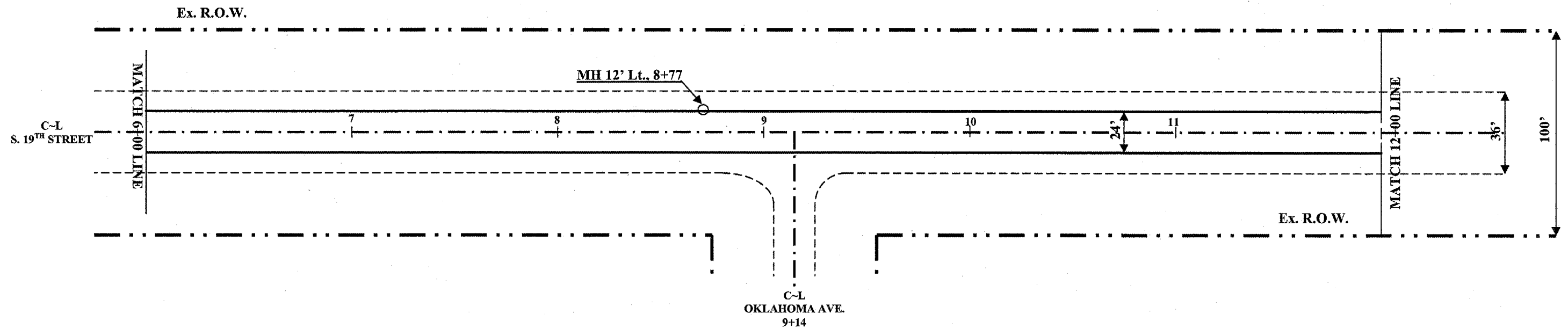

60300350 MANHOLE FRAMES TO ADJUST
12' Lt., 8+73 =1 EACH
TOTAL =1 EACH

44201761 CLASS D PATCH TYPE 1 10"
CL. ~ 10' Lt., 11+84 ~ 11+88 =4.5 SQ. YD.
CL. ~ 10' Rt., 11+84 ~ 11+88 =4.5 SQ. YD.
TOTAL =9.0 SQ. YD.

44201765 CLASS D PATCH TYPE 2 10"
CL. ~ 10' Lt., 6+13 ~ 6+20 =7.8 SQ. YD.
CL. ~ 10' Rt., 6+13 ~ 6+20 =7.8 SQ. YD.
TOTAL =15.6 SQ. YD.

JOB: C-97-043-07
PROJECT: M-5042(16)
SCALE: 1" = 50'

PLAN VIEW
7680 / S. 19TH ST.

CITY OF MATTOON
SECTION 06-00144-00-RS
ROUTE: 7680 / S. 19TH ST.
CONTRACT#: 95501
COLES COUNTY
SHEET 22 OF 35

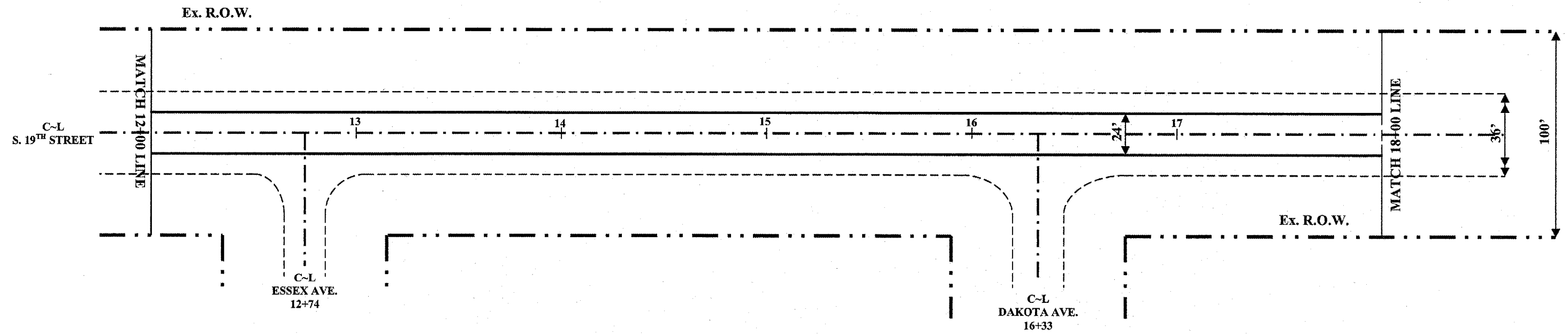

JOB: C-97-043-07
PROJECT: M-5042(16)
SCALE: 1" = 50'

PLAN VIEW

7680 / S. 19TH ST.

CITY OF MATTOON
SECTION 06-00144-00-RS
ROUTE: 7680 / S. 19TH ST.
CONTRACT#: 95501
COLES COUNTY
SHEET 23 OF 35

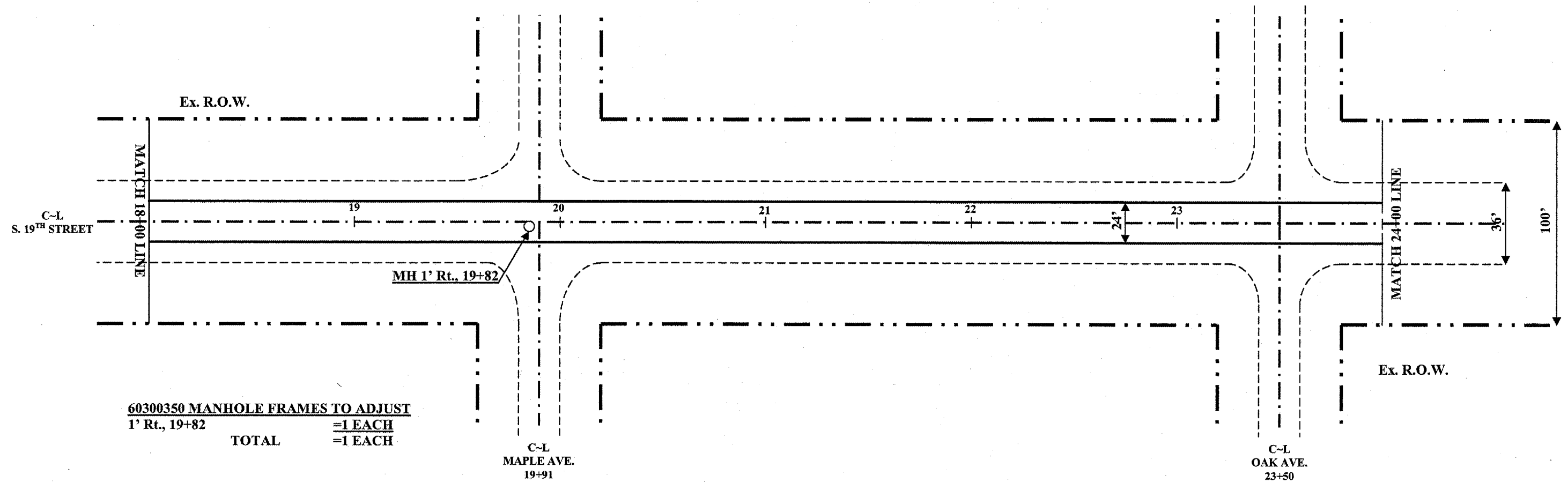

60300350 MANHOLE FRAMES TO ADJUST
1' Rt., 19+82 =1 EACH
TOTAL =1 EACH

44201761 CLASS D PATCH TYPE 1 10"
CL. ~ 10' Lt., 18+05 ~ 18+09 =4.5 SQ. YD.
CL. ~ 10' Rt., 18+05 ~ 18+09 =4.5 SQ. YD.
CL. ~ 10' Lt., 18+94.5 ~ 18+98.5 =4.5 SQ. YD.
CL. ~ 10' Rt., 18+94.5 ~ 18+98.5 =4.5 SQ. YD.
TOTAL =18.0 SQ. YD.

44201765 CLASS D PATCH TYPE 2 10"
CL. ~ 12' Lt., 19+74 ~ 19+80 =8.0 SQ. YD.
CL. ~ 13' Rt., 19+74 ~ 19+80 =8.7 SQ. YD.
TOTAL =16.7 SQ. YD.

JOB: C-97-043-07
PROJECT: M-5042(16)
SCALE: 1" = 50'



PLAN VIEW
7680 / S. 19TH ST.

CITY OF MATTOON
SECTION 06-00144-00-RS
ROUTE: 7680 / S. 19TH ST.
CONTRACT#: 95501
COLES COUNTY
SHEET 24 OF 35

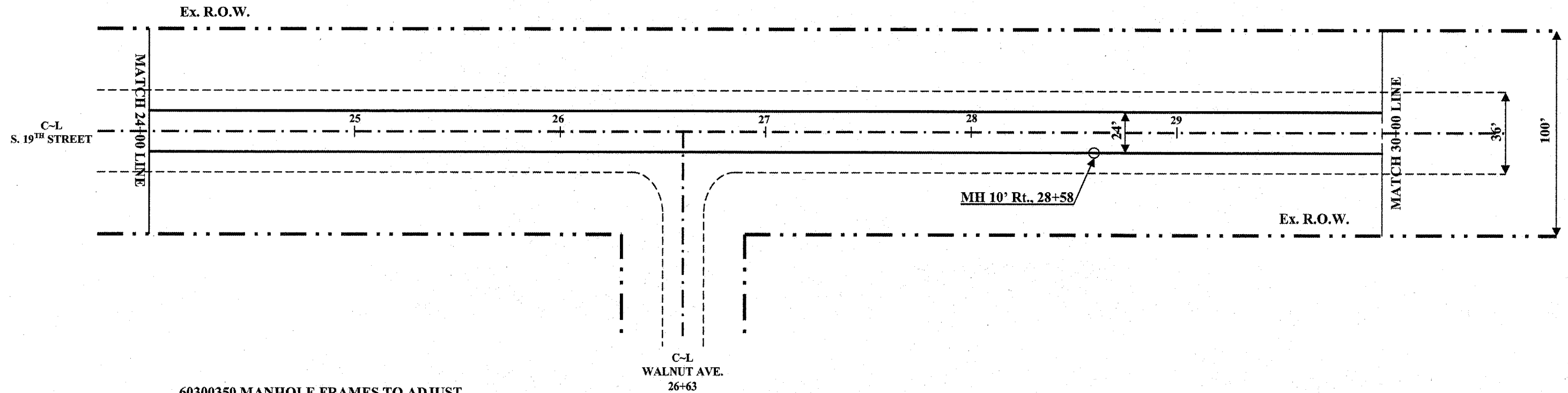

60300350 MANHOLE FRAMES TO ADJUST
10' Rt., 28+58 =1 EACH
TOTAL =1 EACH

JOB: C-97-043-07
PROJECT: M-5042(16)
SCALE: 1" = 50'

PLAN VIEW

7680 / S. 19TH ST.

CITY OF MATTOON
SECTION 06-00144-00-RS
ROUTE: 7680 / S. 19TH ST.
CONTRACT#: 95501
COLES COUNTY
SHEET 25 OF 35

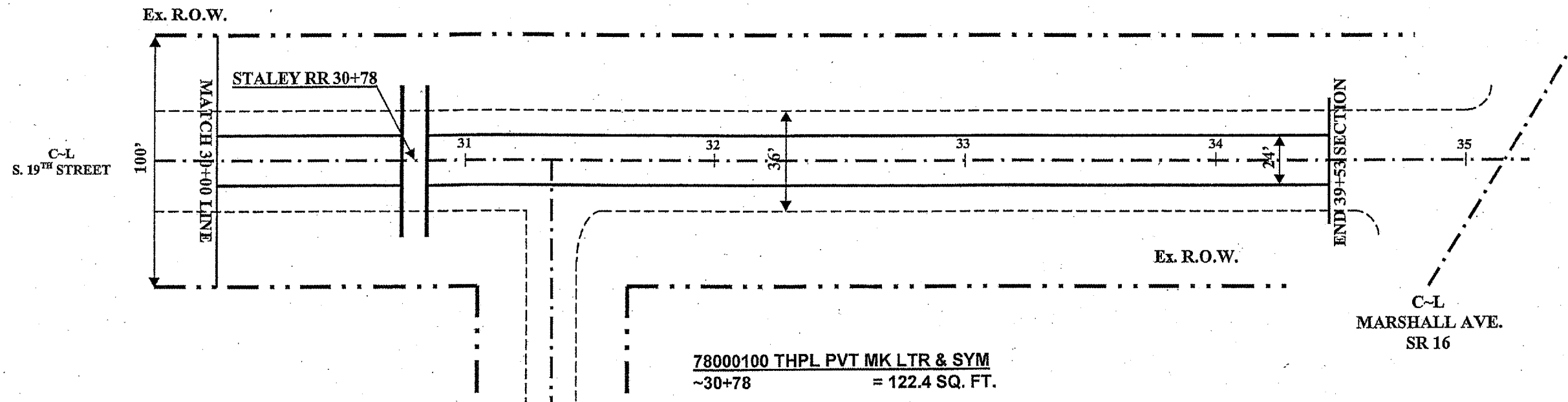

40600982 HOT MIX ASPHALT SURF REMOVAL BUTT JOINT
 12' Lt. ~ Rt., 30+60 ~ 30+75 =40.0 SQ. YD.
 12' Lt. ~ Rt., 30+81 ~ 30+96 =40.0 SQ. YD.
 12' Lt. ~ Rt., 34+21 ~ 34+46 =67.0 SQ. YD.
TOTAL =147.0 SQ. YD.

78000650 THERMOPLASTIC PVT MK LINE 24"
SOLID WHITE 24" STOP BAR
 CL. ~ 30' Rt., 39+92 =30.0 FOOT
TOTAL =30.0 FOOT

78000100 THPL PVT MK LTR & SYM
 ~30+78 = 122.4 SQ. FT.
78000100 THPL PVT MK LINE 24
 ~30+78 = 60 FOOT
 SEE STANDARD 780001 FOR RR
 CROSSING STRIPING DETAILS

EXISTING TYPICAL CROSS SECTIONS

CITY OF MATTOON
SECTION 06-00144-00-RS
CONTRACT #: 95501
ROUTE: F.A.U. 7679 / RUDY AVE.
COLES COUNTY
SHEET 27 OF 35

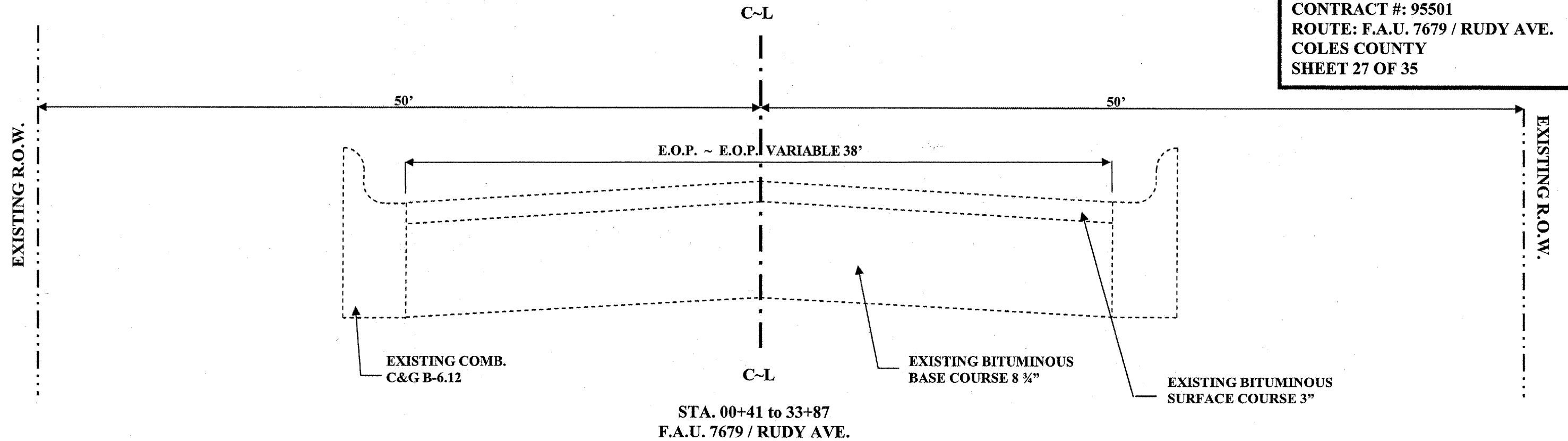

EXISTING TYPICAL CROSS SECTIONS

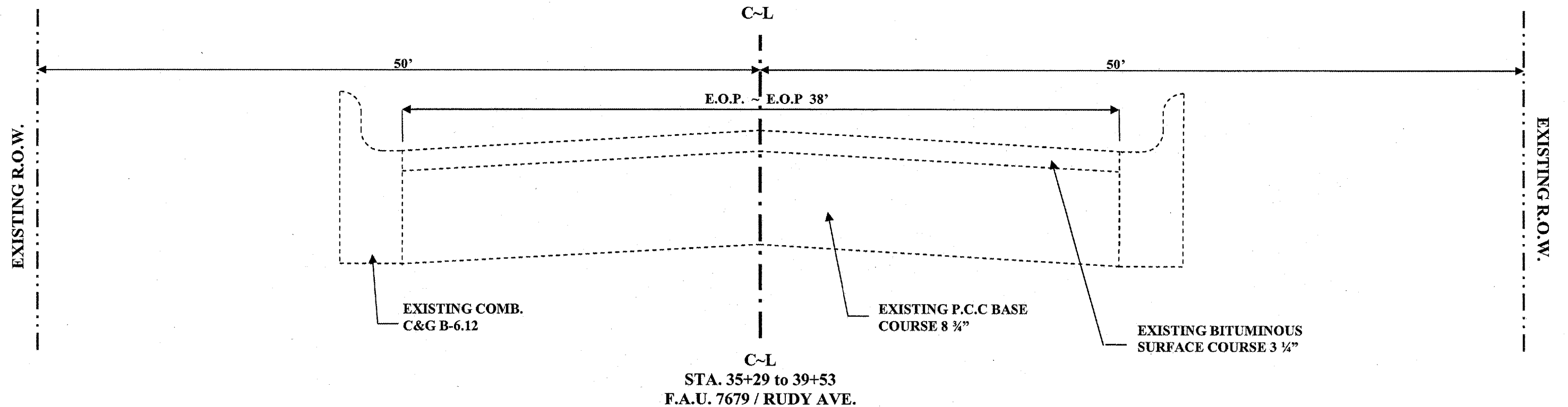

PROPOSED TYPICAL CROSS SECTIONS

CITY OF MATTOON
SECTION 06-00144-00-RS
CONTRACT #: 95501
ROUTE: F.A.U. 7679 / RUDY AVE.
COLES COUNTY
SHEET 28 OF 35

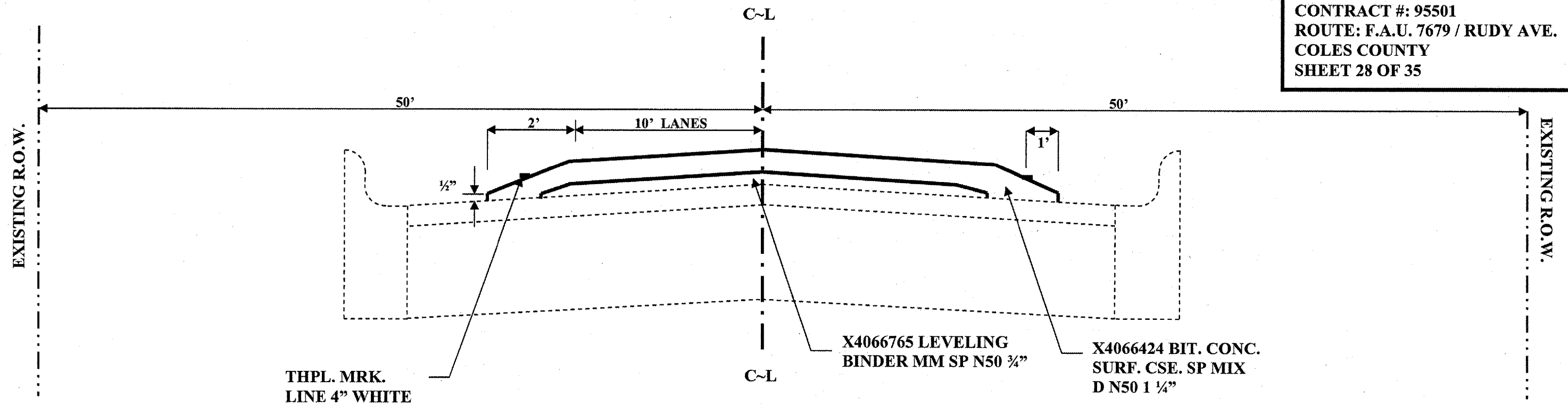

STA. 00+41 to 33+87
F.A.U. 7679 / RUDY AVE.

PROPOSED TYPICAL CROSS SECTIONS

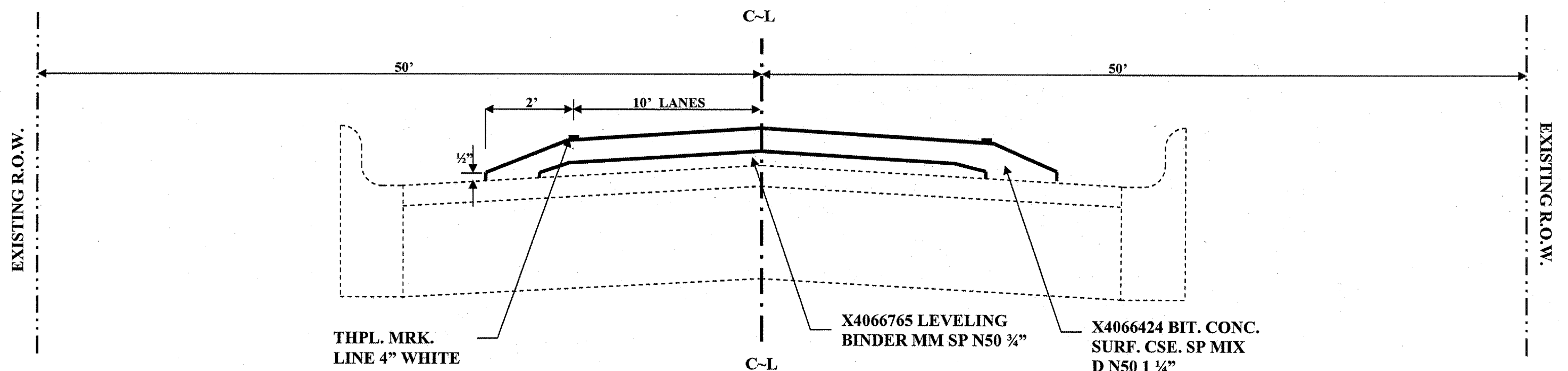

STA. 35+29 to 39+53
F.A.U. 7679 / RUDY AVE.



PLAN VIEW
7679 / RUDY AVE.

CITY OF MATTOON
SECTION 06-00144-00-RS
ROUTE: 7679 / RUDY AVE.
CONTRACT#: 95501
COLES COUNTY
SHEET 29 OF 35

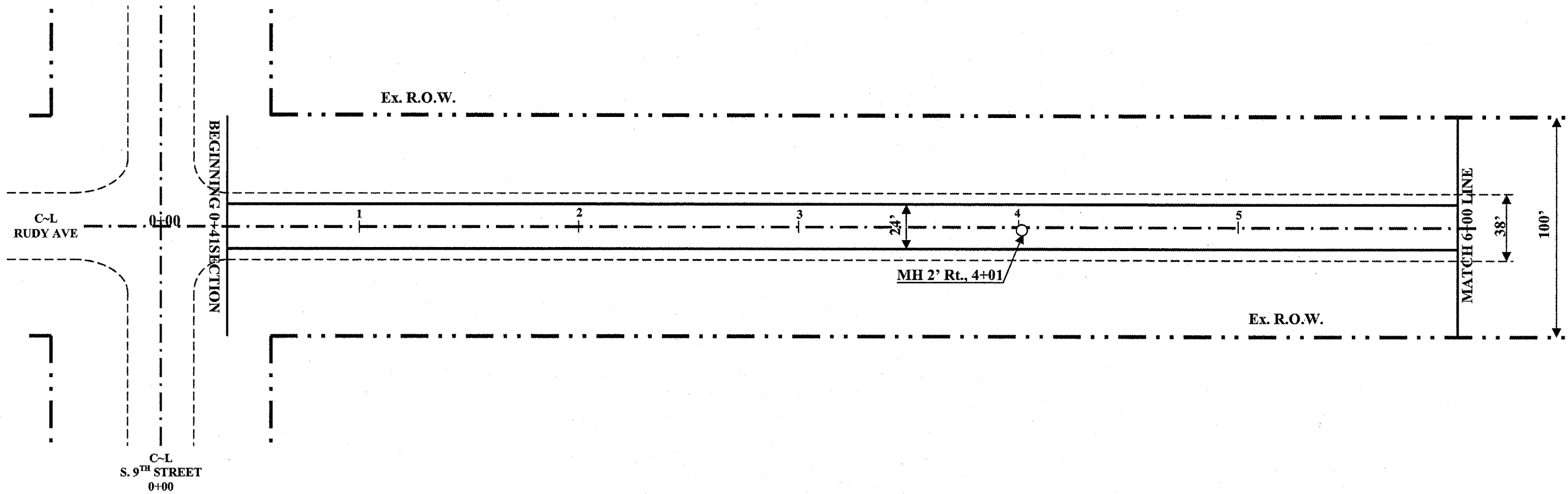

60300350 MANHOLE FRAMES TO ADJUST
2' Rt., 4+01 =1 EACH
TOTAL =1 EACH

40600982 HOT MIX ASPHALT SURF REMOVAL BUTT JOINT
12' Lt. ~ Rt., 0+41 ~ 0+66 =67.0 SQ. YD.
TOTAL =67.0 SQ. YD.

78000400 THERMOPLASTIC PVT MK LINE 6"
20.5' Lt. ~ Rt., 0+34 =41.0 FOOT
19' Lt. ~ Rt., 0+40 =38.0 FOOT
TOTAL =79.0 FOOT

78000650 THERMOPLASTIC PVT MK LINE 24"
SOLID WHITE 24" STOP BAR
CL. ~ 19' Lt., 0+45 =19.0 FOOT
TOTAL =19.0 FOOT

JOB: C-97-043-07
PROJECT: M-5042(16)
SCALE: 1" = 50'



PLAN VIEW
7679 / RUDY AVE.

CITY OF MATTOON
SECTION 06-00144-00-RS
ROUTE: 7679 / RUDY AVE.
CONTRACT#: 95501
COLES COUNTY
SHEET 30 OF 35

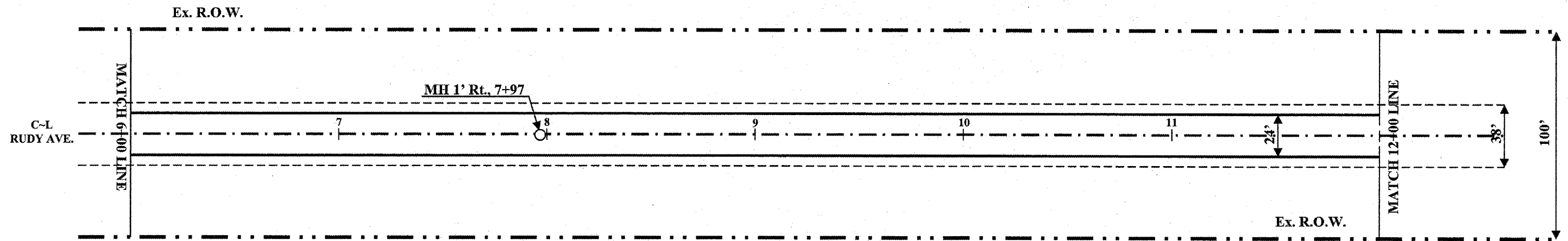

<u>60300350 MANHOLE FRAMES TO ADJUST</u>		
1' Rt., 7+97		<u>=1 EACH</u>
TOTAL		<u>=1 EACH</u>

JOB: C-97-043-07
PROJECT: M-5042(16)
SCALE: 1" = 50'



PLAN VIEW

7679 / RUDY AVE.

CITY OF MATTOON
SECTION 06-00144-00-RS
ROUTE: 7679 / RUDY AVE.
CONTRACT#: 95501
COLES COUNTY
SHEET 31 OF 35

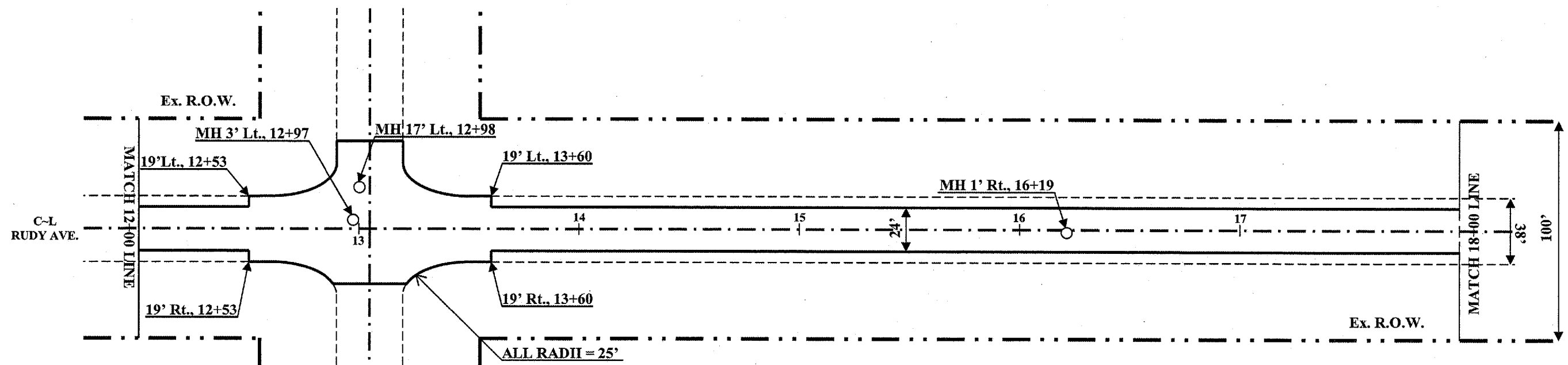

78000650 THERMOPLASTIC PVT MK LINE 24"
SOLID WHITE 24" STOP BAR
 40' Rt., 13+06 ~ 13+20 =14.0 FOOT
 39' Lt., 12+92 ~ 13+06 =14.0 FOOT
TOTAL =28.0 FOOT

60300350 MANHOLE FRAMES TO ADJUST
 3' Lt., 12+97 =1 EACH
 17' Lt., 12+98 =1 EACH
 1'Rt., 16+19 =1 EACH
TOTAL =3 EACH

40600982 HOT MIS ASPHALT SURF REMOVAL BUTT JOINT
 20' ~ 45' Lt., 12+63 ~ 13+50 =116.0 SQ. YD.
 19' ~ 30' Rt., 12+63 ~ 13+50 =89.0 SQ. YD.
TOTAL =205.0 SQ. YD.

78000400 THERMOPLASTIC PVT MK LINE 6"
SOLID WHITE 6" CROSSWALK
 29' Rt., 12+87 ~ 13+25 =38.0 FOOT
 35' Rt., 12+90 ~ 13+22 =32.0 FOOT
 20.5' Lt. ~ Rt., 12+74 =41.0 FOOT
 23.5' Lt. ~ Rt., 12+80 =47.0 FOOT
 22.5' Lt. ~ Rt., 13+33 =45.0 FOOT
 20' Lt. ~ Rt., 13+39 =40.0 FOOT
 29' Lt., 12+87 ~ 13+26 =39.0 FOOT
 34' Lt., 12+91 ~ 13+22 =31.0 FOOT
TOTAL =313.0 FOOT

JOB: C-97-043-07
 PROJECT: M-5042(16)
 SCALE: 1" = 50'



PLAN VIEW
7679 / RUDY AVE.

CITY OF MATTOON
SECTION 06-00144-00-RS
ROUTE: 7679 / RUDY AVE.
CONTRACT#: 95501
COLES COUNTY
SHEET 32 OF 35

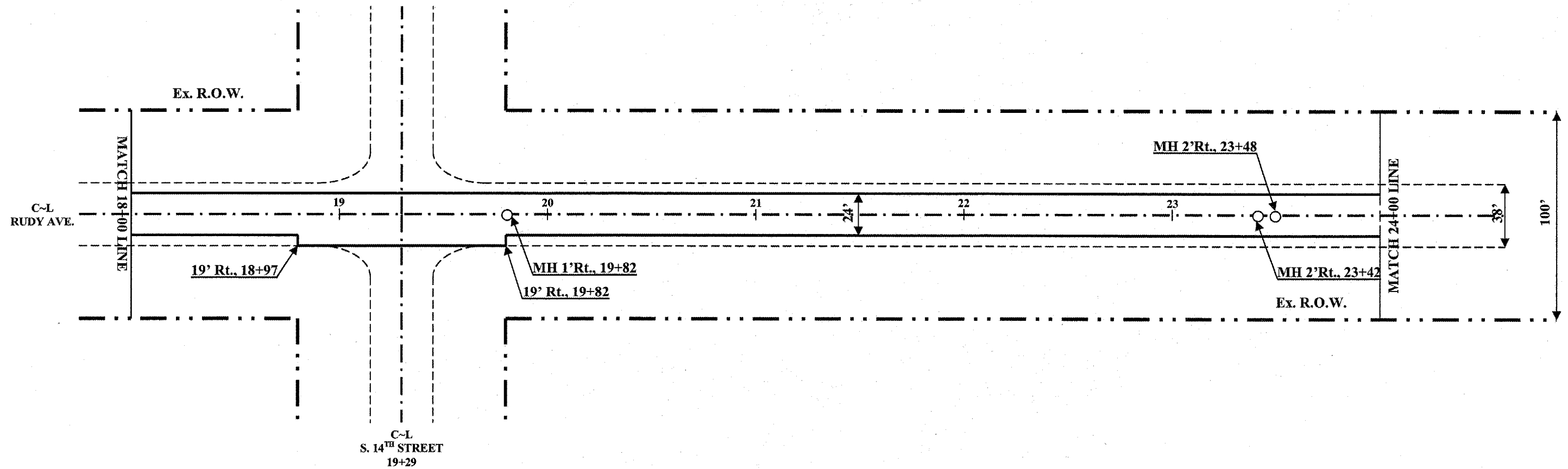

60300350 MANHOLE FRAMES TO ADJUST	
1' Rt., 19+82	=1 EACH
2' Rt., 23+42	=1 EACH
2' Rt., 23+48	=1 EACH
TOTAL	=3 EACH

78000400 THERMOPLASTIC PVT MK LINE 6"	
SOLID WHITE 6" CROSSWALK	
19.5' Lt. ~ Rt., 18+94	=39.0 FOOT
22.5' Lt. ~ Rt., 19+00	=45.0 FOOT
22.5' Lt. ~ Rt., 19+60	=45.0 FOOT
20.5' Lt. ~ Rt., 19+66	=41.0 FOOT
TOTAL	=170.0 FOOT

78000650 THERMOPLASTIC PVT MK LINE 24"	
SOLID WHITE 24" STOP BAR	
CL. ~ 19' Rt., 18+92	=19.0 FOOT
CL. ~ 19' Lt., 19+67	=19.0 FOOT
TOTAL	=38.0 FOOT

JOB: C-97-043-07
PROJECT: M-5042(16)
SCALE: 1" = 50'



PLAN VIEW
7679 / RUDY AVE.

CITY OF MATTOON
SECTION 06-00144-00-RS
ROUTE: 7679 / RUDY AVE.
CONTRACT#: 95501
COLES COUNTY
SHEET 33 OF 35

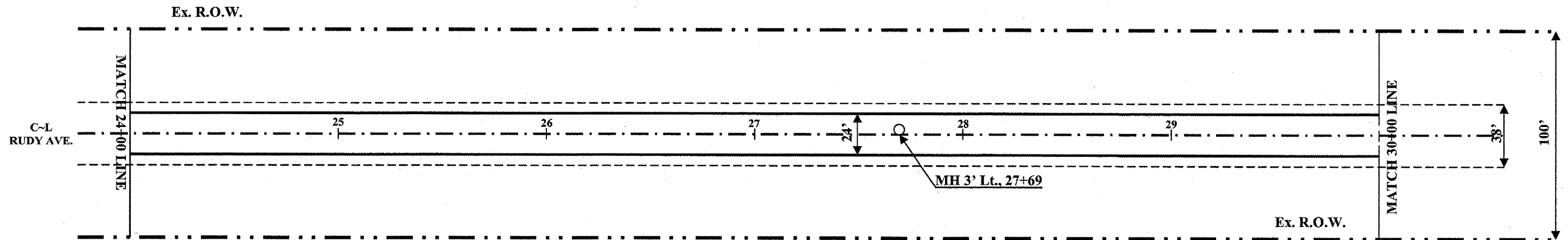

<u>60300350 MANHOLE FRAMES TO ADJUST</u>	
3' Lt., 27+69	<u>=1 EACH</u>
TOTAL	<u>=1 EACH</u>

JOB: C-97-043-07
PROJECT: M-5042(16)
SCALE: 1" = 50'



PLAN VIEW
7679 / RUDY AVE.

CITY OF MATTOON
SECTION 06-00144-00-RS
ROUTE: 7679 / RUDY AVE.
CONTRACT#: 95501
COLES COUNTY
SHEET 34 OF 35

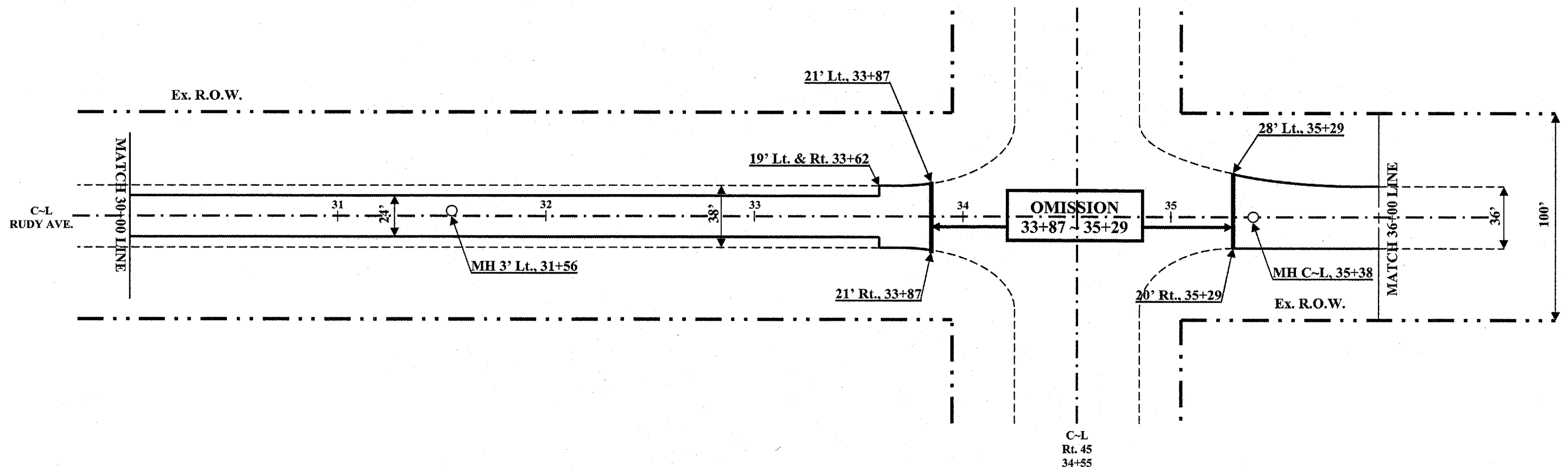

60300350 MANHOLE FRAMES TO ADJUST
3' Lt., 31+56 =1 EACH
C-L, 35+38 =1 EACH
TOTAL =2 EACH

40600982 HOT MIX ASPHALT SURFACE REMOVAL BUTT JOINT
19' Lt. ~ Rt., 33+62 ~ 21' Lt. ~ Rt. 33+87 =108.0 SQ. YD.
28' Lt. ~ 20' Rt., 35+29 ~ 23.5' Lt. ~ 18' Rt. 35+54 =123.0 SQ. YD.
TOTAL =231.0 SQ. YD.

78000650 THERMOPLASTIC PVT MK LINE 24"
SOLID WHITE 24" STOP BAR
CL. ~ 26' Rt., 34+08 =26.0 FOOT
CL. ~ 38' Lt., 35+06 =38.0 FOOT
TOTAL =64.0 FOOT

JOB: C-97-043-07
PROJECT: M-5042(16)
SCALE: 1" = 50'



PLAN VIEW
7679 / RUDY AVE.

CITY OF MATTOON
SECTION 06-00144-00-RS
ROUTE: 7679 / RUDY AVE.
CONTRACT#: 95501
COLES COUNTY
SHEET 35 OF 35

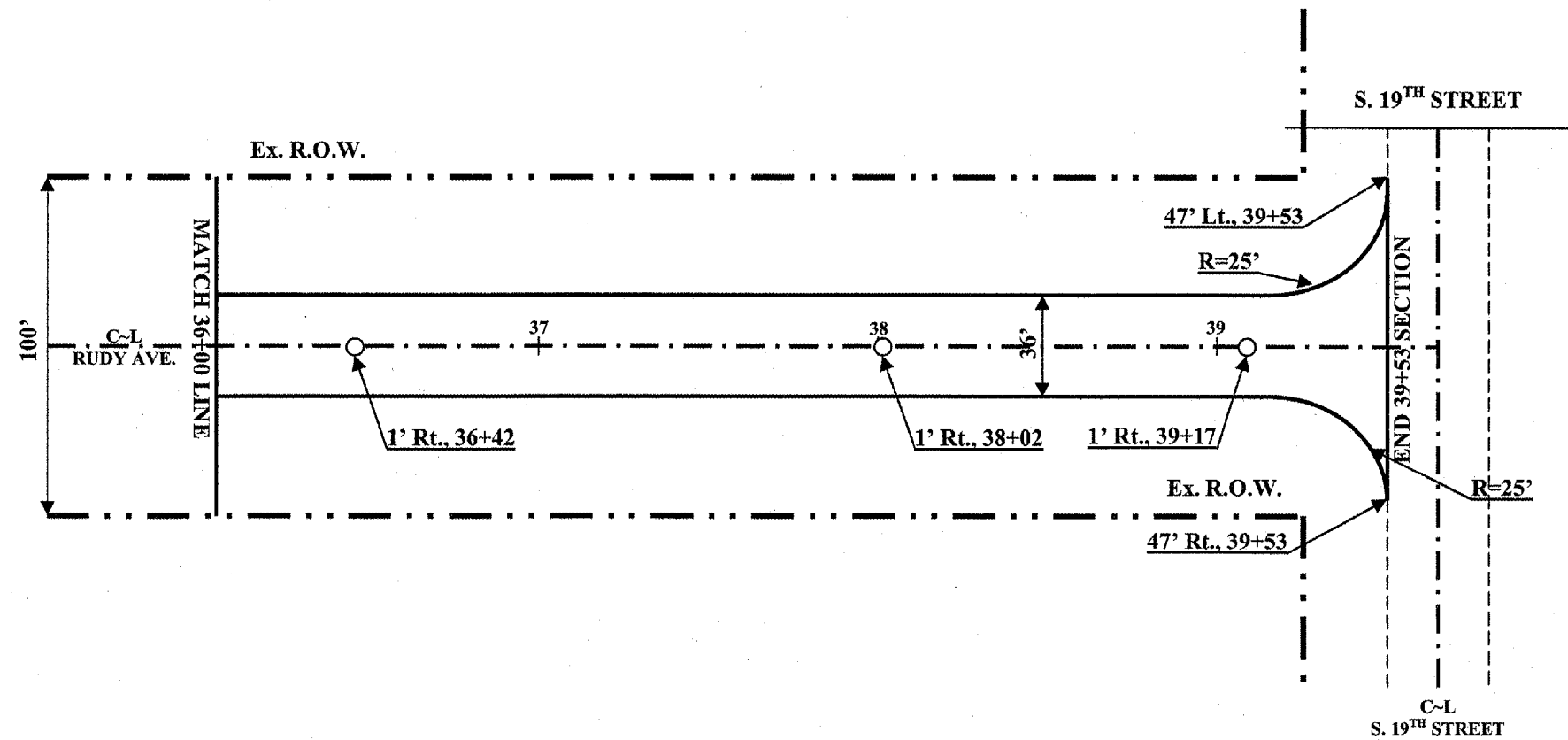

60300350 MANHOLE FRAMES TO ADJUST

1' Rt., 36+42	=1 EACH
1' Rt., 38+02	=1 EACH
1' Rt., 39+17	=1 EACH
TOTAL	=3 EACH

78000650 THERMOPLASTIC PVT MK LINE 24"

SOLID WHITE 24" STOP BAR	
CL. ~ 18' Rt., 39+20	=18.0 FOOT
TOTAL	=18.0 FOOT

JOB: C-97-043-07
PROJECT: M-5042(16)
SCALE: 1" = 50'