

SECTION NO.	COUNTY HIGHWAY	COUNTY	SHEET OF SHEETS
02-00161-02-BR	CH 34	ST. CLAIR	7 OF 22
FHWA REG.NO.7		ILLINOIS	PROJ: BRM-5011(188)
LEVEE DETAILS		CONTRACT 97280	

LEVEE DETAILS

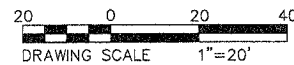

CURVE DATA
P.I. = 0+97.27
DELTA = 16°06'48"
NO CURVE

CURVE DATA
P.I. = 1+75.31
DELTA = 91°32'09"
RADIUS = 38.00'
TANGENT = 39.03'
LENGTH = 60.71'
P.C. = 1+36.28
P.T. = 1+96.99

CURVE DATA
P.I. = 1+88.44
DELTA = 81°46'03"
RADIUS = 30.00'
TANGENT = 25.97'
LENGTH = 42.81'
P.C. = 1+62.47
P.T. = 2+05.28

CURVE DATA
P.I. = 0+97.27
DELTA = 16°06'48"
NO CURVE

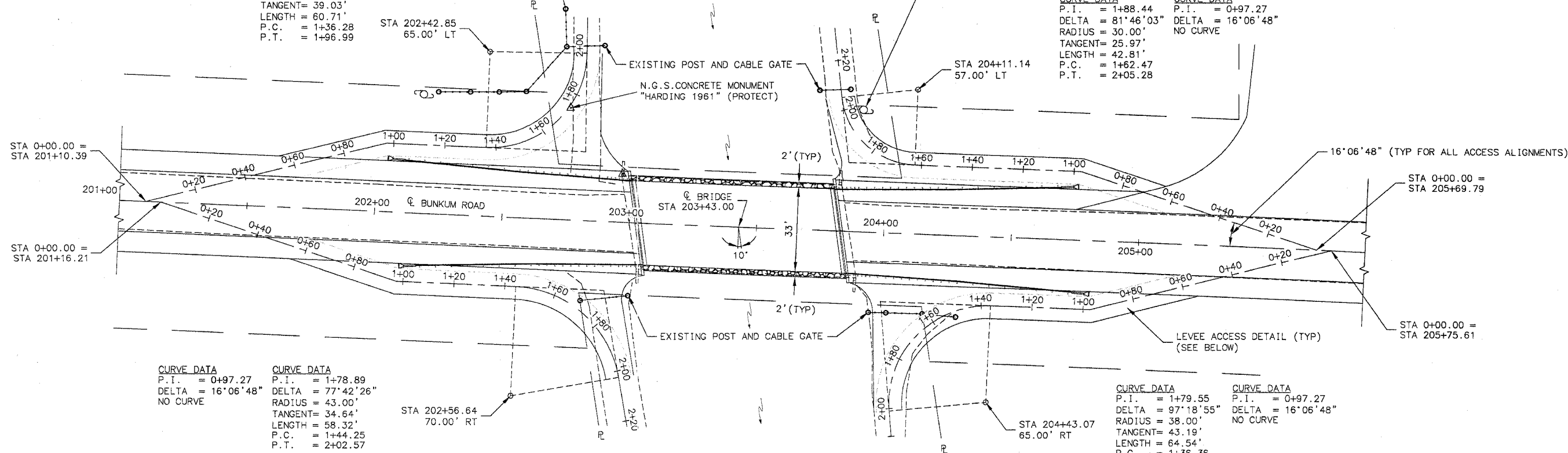

CURVE DATA
P.I. = 0+97.27
DELTA = 16°06'48"
NO CURVE

CURVE DATA
P.I. = 1+78.89
DELTA = 77°42'26"
RADIUS = 43.00'
TANGENT = 34.64'
LENGTH = 58.32'
P.C. = 1+44.25
P.T. = 2+02.57

CURVE DATA
P.I. = 1+79.55
DELTA = 97°18'55"
RADIUS = 38.00'
TANGENT = 43.19'
LENGTH = 64.54'
P.C. = 1+36.36
P.T. = 2+00.90

CURVE DATA
P.I. = 0+97.27
DELTA = 16°06'48"
NO CURVE

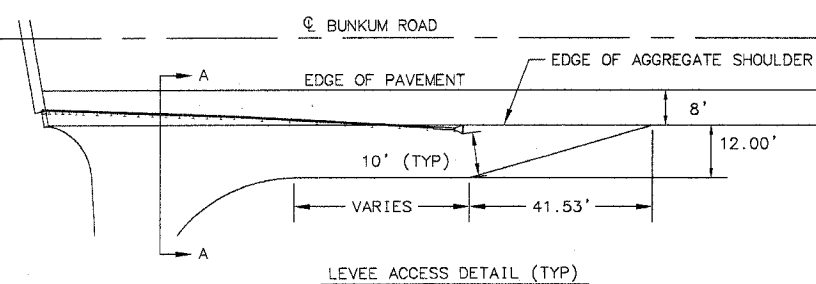

LEVEE ACCESS DETAIL (TYP)

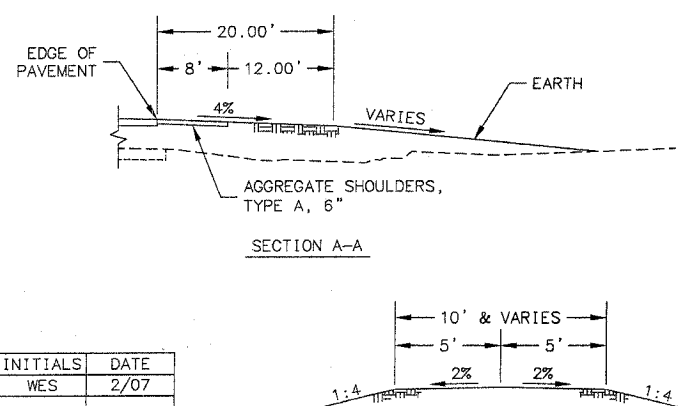

TYPICAL SECTION OF ACCESS

PROFILE SCALE: VERTICAL: 1"=20'
HORIZONTAL: 1"=20'

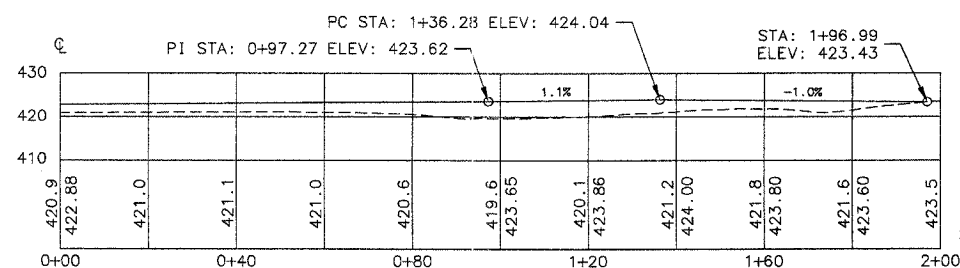

PROFILE OF NORTHWEST ACCESS

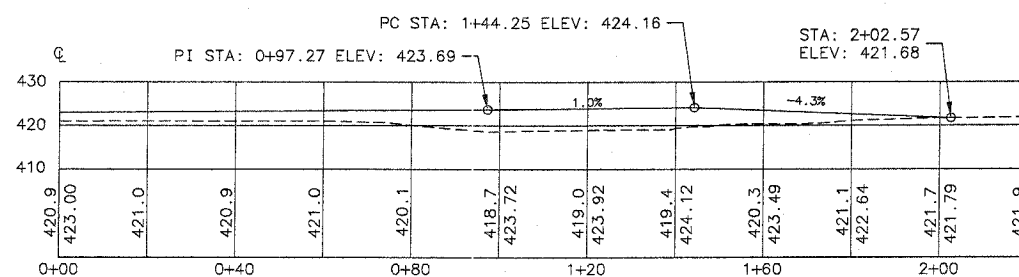

PROFILE OF SOUTHWEST ACCESS

LEVEE ACCESS PROFILES

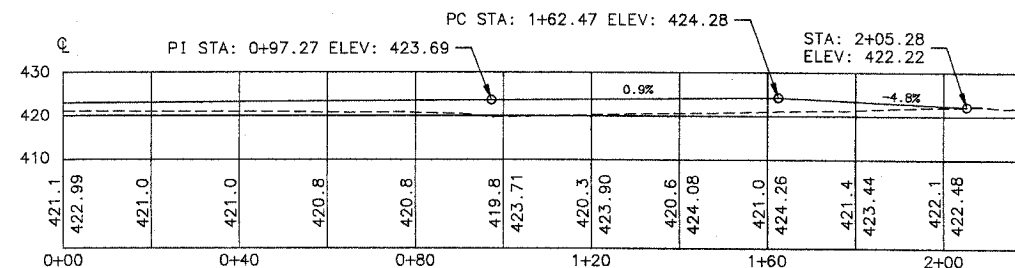

PROFILE OF NORTHEAST ACCESS

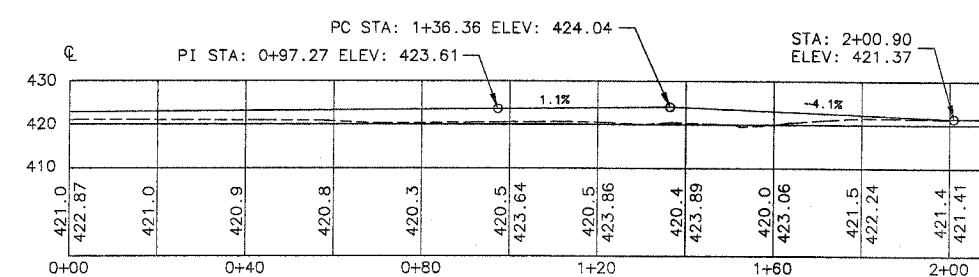

PROFILE OF SOUTHEAST ACCESS

DRAWING FILE: LEVEE DETAILS.dwg

	INITIALS	DATE
DESIGNED	WES	2/07
CHECKED		
DRAWN	WES	2/07
CHECKED		
PREPARED BY ST. CLAIR COUNTY		