

RTE.	SECTION	COUNTY	TOTAL SHEETS	SHEET NO.
T.R. 140	*	JERSEY	8	1
FEDERAL AID PROJECT				
* 05-05112-00-BR				
CONTRACT NO. 97292				

**STATE OF ILLINOIS
DEPARTMENT OF TRANSPORTATION**

**PLANS FOR PROPOSED
HIGHWAY BRIDGE PROGRAM
PROJECT NO. BROS-083(039)
T.R. 140 OVER BRANCH OF LITTLE PIASA CREEK
SECTION 05-05112-00-BR
JERSEY COUNTY
JOB NO. C-98-354-06**

INDEX OF SHEETS

- 1 - TITLE SHEET
- 2 - SUMMARY OF QUANTITIES,
DETAILS, & TYPICAL SECTIONS
- 3 - PLAN & PROFILE
- 4 - GENERAL PLAN & ELEVATION
- 5 - SUPERSTRUCTURE
- 6 - RAILING
- 7 - ABUTMENTS
- 8 - CROSS SECTIONS

STANDARDS

- STANDARD 515001-02
- STANDARD 635006-02
- STANDARD 702001-06
- STANDARD BLR 21-6
- STANDARD BLR 23-1

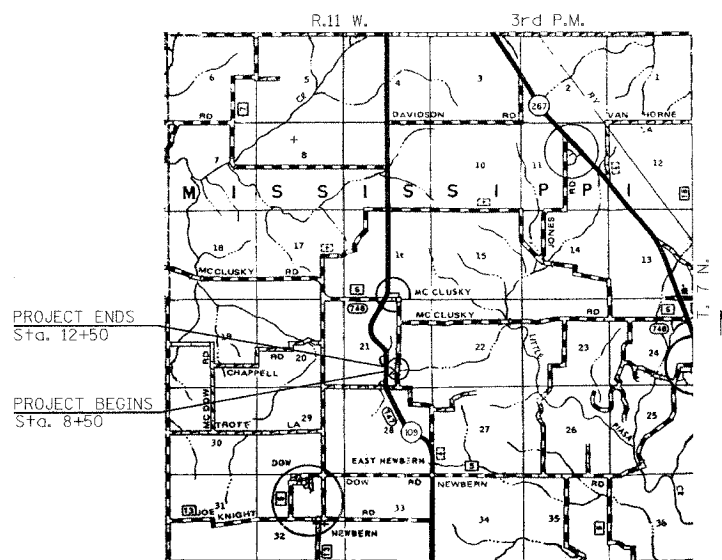

EXISTING STRUCTURE: SINGLE SPAN REINFORCED CONCRETE DECK ON CLOSED CONCRETE ABUTMENTS WITH CONCRETE WINGWALLS AND CONCRETE RAILINGS. ±23'-0" BK.-BK. ABUTMENTS, ±17'-9" CLEAR DECK WIDTH. ±0° SKEW
EXISTING STRUCTURE NO. 042-3075

PROPOSED STRUCTURE: SINGLE SPAN PRECAST PRESTRESSED CONCRETE DECK BEAM BRIDGE (21') ON OPEN CONCRETE ABUTMENTS. 27'-0" OUT.-OUT. DECK, 54'-0" BK.-BK. ABUTMENTS. STEEL RAILING TYPE S1. 15° SKEW LT. FORWARD.
PROPOSED STRUCTURE NO. 042-3140

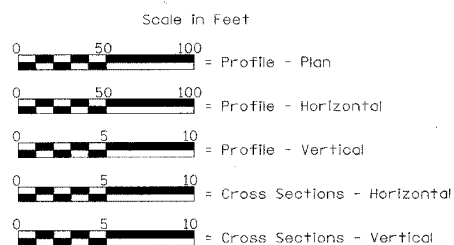

LOCATION PLAN

Length of Section - 400.00 Feet = 0.076 Miles

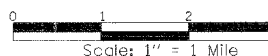

Land Section - 21
Land Quarter Section - S.E.
Political Township - Mississippi
Design Designation
Functional Class - Local Road
Design Speed = 30 m.p.h.
ADT: 150 (2002)
ADT: 159 (2029)



Christopher P. Hollman 12/12/06
Expiration: 11/30/07

ILLINOIS DEPARTMENT OF TRANSPORTATION	
APPROVED	12/18, 2006 <i>Thomas F. Kline</i> JERSEY COUNTY ENGINEER
PASSED	1-2, 2007 <i>James J. O'Brien</i> DISTRICT ENGINEER OF LOCAL ROADS & STREETS
RELEASING FOR BID BASED ON LIMITED REVIEW	1-2, 2007 <i>Mary C. Lane</i> DEPUTY DIRECTOR OF HIGHWAYS REGION FIVE ENGINEER

FILE NAME: JCI4035 (REV. 12/05/06)

TOLL FREE
"JOINT UTILITY LOCATION INFORMATION FOR EXCAVATORS"
WWW.U.L.I. TELEPHONE NUMBER
1-800-892-0123