

NOTE: PAVEMENT REMOVAL QUANTITIES AND ASPHALT QUANTITIES CALCULATED FOR THIS SHEET ARE FOR EDWARDSVILLE ROAD ONLY

REVISIONS

SMS Sheppard, Morgan & Schwaab, Inc.
CONSULTING ENGINEERS AND LAND SURVEYORS
315 Market Street, P.O. Box 1, Alton, IL 62802, 618-465-9755, E-mail: mail@smseng.com
110 Central Inland Drive, Granite City, IL 62040, 618-977-9700, E-mail: mail@smseng.com
DESIGN FIRM # 184-000992

INTERSECTION OF EDWARDSVILLE ROAD / NINTH STREET

DETECTOR LOOP REQUIREMENTS AND CALCULATIONS

NO.	LOOP	PHASE	LOOP SIZE (FT.)	REQUIRED NO. OF TURNS	LEAD-IN LENGTH (FT.)	CALCULATED INDUCTANCE MICROHENRIES (-uH)	CALCULATED RESISTANCE OHMS (Ω)
1.	SOUTHBOUND THRU/LT.	-	6x50	3-6-3	174'	824.3	2.5
2.	NORTHBOUND THRU/LT.	-	6x50	3-6-3	97'	807.3	2.1
3.	NORTHBOUND RT.	-	6x35	5-10-5	83'	1,747.3	2.3
4.	WESTBOUND THRU/LT.	-	6x50	4-8-4	21'	1,214.6	2.2
5.	WESTBOUND CCO(THRU)	-	6'x6'	9	284'	745.3	2.0

PHASE Ø	EXISTING/PROPOSED OPERATION							
	1	2	3	4	5	6	7	8
MOVEMENT	↙	→	↘	↖	↗	↔		
CONCURRENT MOVEMENT PERMITTED	5 OR 6	5 OR 6	NONE	NONE	1 OR 2	1 OR 2	NOT USED	NOT USED

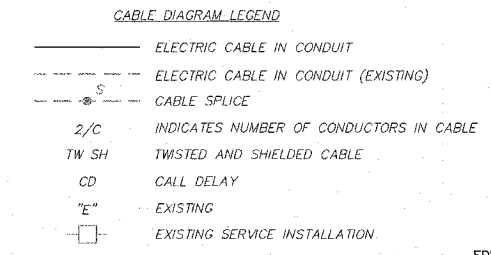

NOTES

- ALL PEDESTRIAN SIGNAL HEADS SHALL HAVE 12-INCH L.E.D. INDICATIONS. ALL MOUNTING HARDWARE SHALL BE UNPAINTED ALUMINUM. ALL BOLTS, SCREWS, NUTS AND WASHERS SHALL BE STAINLESS STEEL. ANTI-SIEZE PASTE COMPOUND SHALL BE USED ON ALL MOUNTING HARDWARE FIELD CONNECTIONS.
- ALL TRAFFIC SIGNAL CABLES SHALL BE #14 AWG STRANDED COPPER, UNLESS OTHERWISE SPECIFIED. FIELD WIRES SHALL BE CONNECTED AT CONTROLLER OUTPUT TERMINALS USING ILSCO SLU-55 CONNECTORS OR EQUIVALENT.
- IN FLASHING MODE, ALL VEHICULAR SIGNAL FACES SHALL FLASH RED.

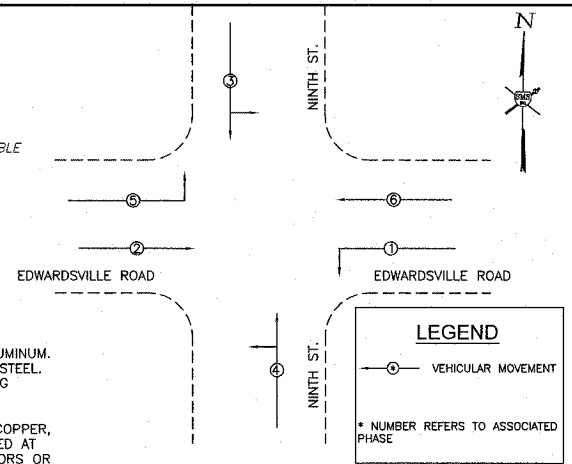

PHASE DESIGNATION DIAGRAM
IL. RTE. 111 & EDWARDSVILLE ROAD

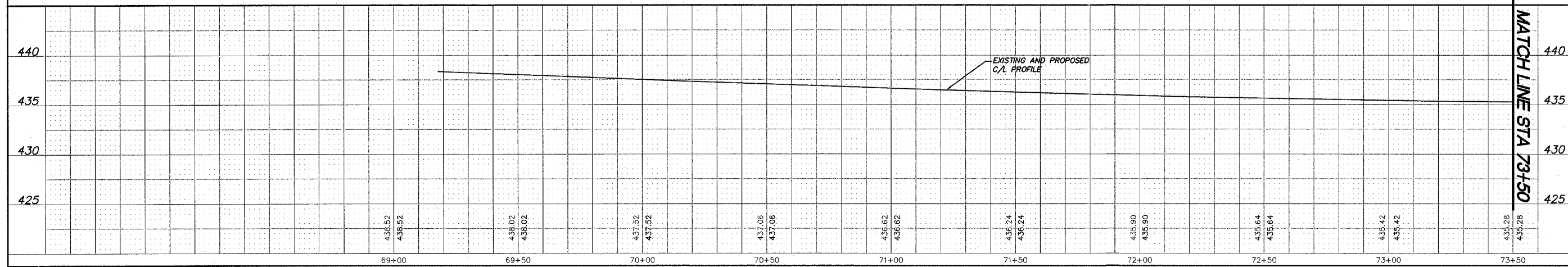

EDWARDSVILLE ROAD PHASE II (FAU 8980)
SECTION 05-00043-02-WR
WOOD RIVER, ILLINOIS
PLAN PROFILE

DWG. NO. Edwardsville_road_phs_ii_PPI.dwg
REF. BK. PG.
JOB NO. 286614
DSH. BY. CL
DWN. BY. COP-jmk
CHK. BY. JHH
DATE: JANUARY, 2007
HORIZ.: 1" = 20'
SCALE: VERT.: 1" = 5'
SHEET 12 OF 31

I:\land projects\W RIVER PW (286614)\eg\Edwardsville_road_phs_ii_PPI.dwg, 2/21/2007 11:58:12 AM, jhmedey, 120