



**CORPORATE OFFICE**

4940 OLD COLLINSVILLE RD.  
SWANSEA, ILLINOIS 62226  
TEL (618) 624-4488  
FAX (618) 624-6688  
corp@twm-inc.com

**WATERLOO OFFICE**

113 SOUTH MAIN STREET  
WATERLOO, ILLINOIS 62206  
TEL (618) 989-5050  
FAX (618) 989-8988  
waterloo@twm-inc.com

**ST. LOUIS OFFICE**

1001 CRAIG ROAD, SUITE 260  
ST. LOUIS, MISSOURI 63146  
TEL (314) 236-5052  
FAX (314) 672-2194  
stlouis@twm-inc.com

PROFESSIONAL REGISTRATIONS	LICENSE NO.
ILLINOIS PROFESSIONAL DESIGN FIRM	104-00290
PROFESSIONAL ENGINEERING CORP.	03-08879
PROFESSIONAL ENVIRONMENTAL ENGR. CORP.	03-00803
ILLINOIS PROF. LAND SURVEYING CORP.	046-00008
MISSOURI PROFESSIONAL ENGR. CORP.	910 00026
MISSOURI LAND SURVEYING CORP.	910 00046

SEAL

Signature: \_\_\_\_\_  
Expiration Date: \_\_\_\_\_

**STATEMENT OF RESPONSIBILITY**  
I hereby confirm that the document herein to be authorized by my seal is restricted to this sheet, and I hereby disclaim any responsibility for all other drawings, specifications, estimates, reports or other documents or statements relating to or intended to be utilized for any other part of the architectural, engineering or survey project.

**MATCHLINE STA. 37+00**

**STRUCTURE #8**  
STA. 37+56.97, 14.00' RT  
INLET, TYPE A  
T-24 FRAME & GRATE  
TOG  $\bar{H}$  = 600.93  
INV = 597.18

12" SS - 26 LF @ 1.08%  
CLASS A, TYPE 2

12" SS - 26 LF @ 1.08%  
CLASS A, TYPE 2

12" SS - 26 LF @ 1.08%  
CLASS A, TYPE 2

**MATCHLINE STA. 41+50**

**STRUCTURE #10**  
STA. 38+93.40, 14.00' RT  
INLET, TYPE A  
T-24 FRAME & GRATE  
TOG  $\bar{H}$  = 596.01  
INV = 592.26

**STRUCTURE #12**  
STA. 41+43.40, 14.00' RT  
INLET, TYPE A  
T-24 FRAME & GRATE  
TOG  $\bar{H}$  = 583.00  
INV = 579.25

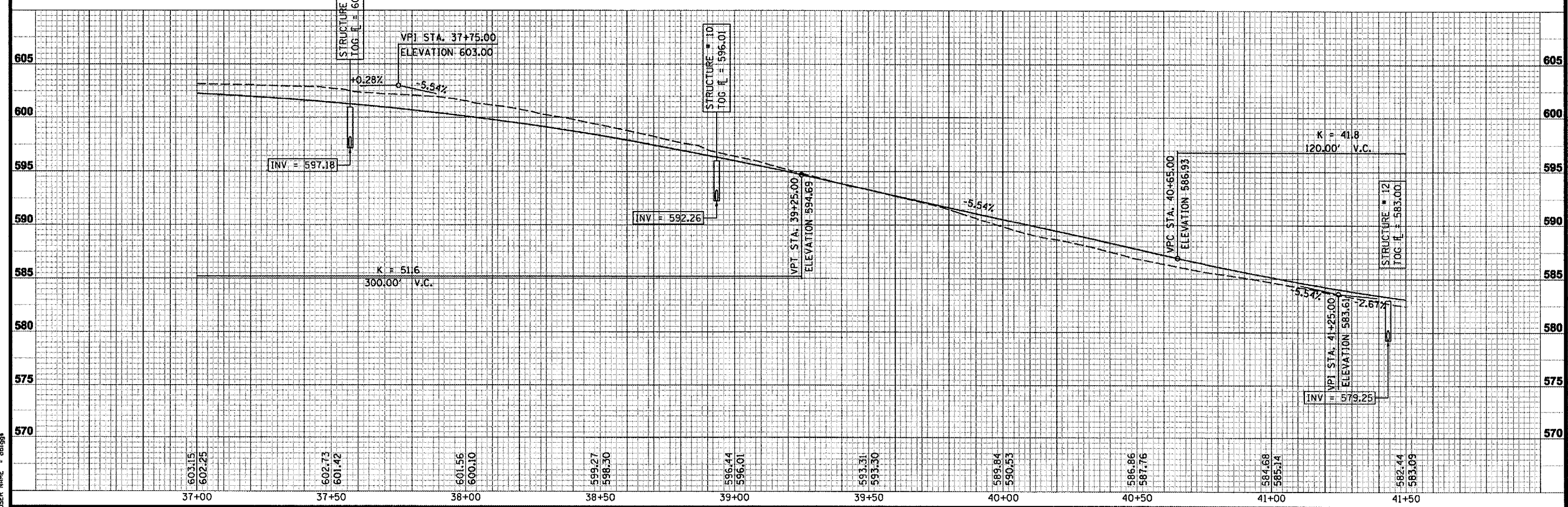
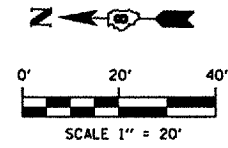

**TITLE**  
STORM SEWER PLAN AND PROFILE  
RIGHT SIDE - STA. 37+00 TO 41+50

**PROJECT:**  
SEIBERT ROAD  
RECONSTRUCTION - PHASE IV  
VILLAGE OF SHILOH  
ST. CLAIR COUNTY, ILLINOIS

REV.	DATE	DESCRIPTION
△		
△		
△		

DRAWN BY: MJJ	SHEET
DESIGNED BY: MJJ	
CHECKED BY: XXX	<b>22</b>
APPROVED BY: XXX	
PROJECT NUMBER: D20010479	OF 36 SHEETS
<input checked="" type="checkbox"/> ISSUED FOR REVIEW	<input type="checkbox"/> ISSUED FOR BIDDING
<input type="checkbox"/> ISSUED FOR CONSTR.	<input type="checkbox"/> RECORD DRAWING

PLOT DATE = 9/21/2007  
FILE NAME = P:\2007\REVISED\Phase IV Plans\REVISED 2-16-07\871018479PPT.4.dgn  
PLOT SCALE = 48,0000 / IN  
USER NAME = dhsaga