

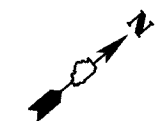



F.A.U. RTE.	SECTION	COUNTY	TOTAL SHEETS	SHEET NO.
9276	05-00029-02-RS	CAHOKIA	10	8
STA. 23+00.00		TO STA. 29+00.00		
FED. ROAD DIST. NO.		ILLINOIS FED. AID PROJECT		
CONTRACT NO. 97311				



-  LIMITS OF HMA SURFACE REMOVAL (2") & PROPOSED 2" HMA SURFACE COURSE
-  4" YELLOW THERMOPLASTIC SKIP DASH STRIPING (10' - 30' SKIP)
-  12" WHITE THERMOPLASTIC PAVEMENT MARKING

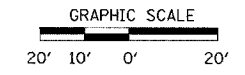
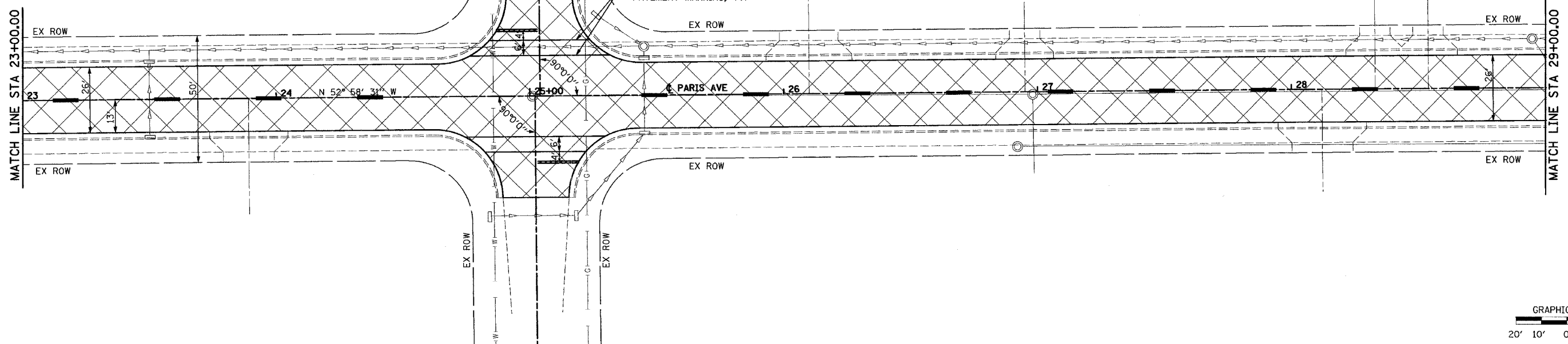

PLAN	SURVEYED	DATE
NOTE BOOK	BY	
NO.		

PROFILE	SURVEYED	DATE
NOTE BOOK	BY	
NO.		

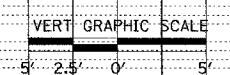
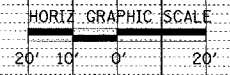
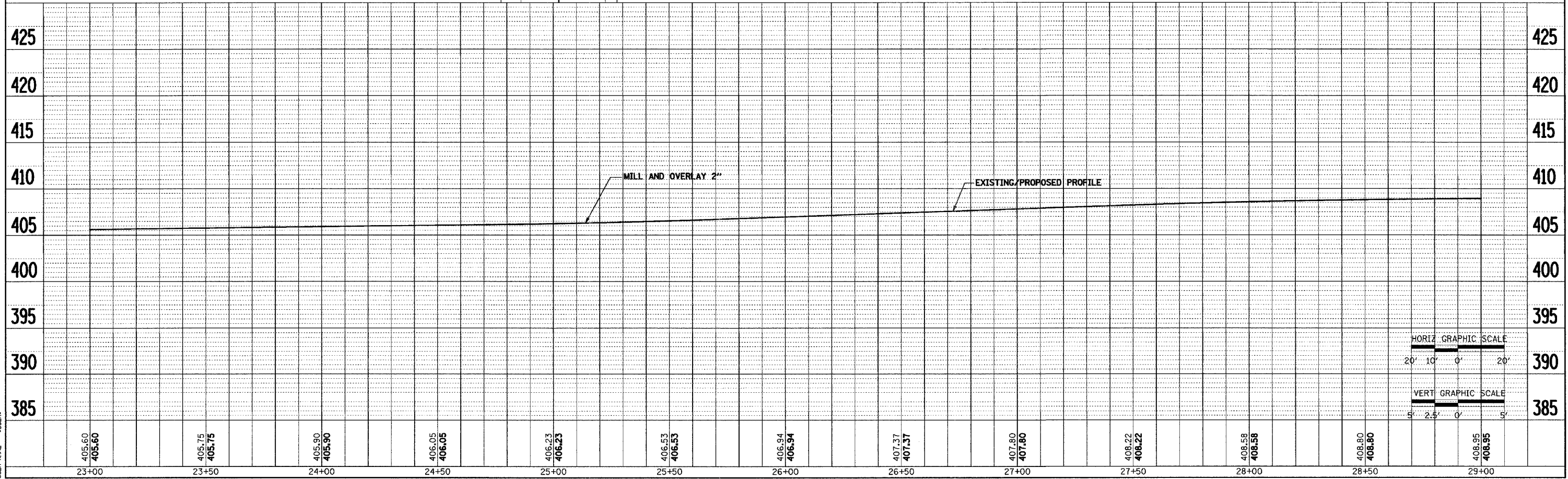

PLOT DATE = #DATE#
 FILE NAME = #FILE#
 PLOT SCALE = #SCALE#
 USER NAME = #USER#