

STATE OF ILLINOIS
DEPARTMENT OF TRANSPORTATION
DIVISION OF HIGHWAYS

PLANS FOR PROPOSED
FEDERAL AID HIGHWAY
VILLAGE OF CAHOKIA

FAU ROUTE 9276 (PARIS AVE. RESURFACING)
SECTION NUMBER 05-00029-02-RS
PROJECT NUMBER M-5011 (237)
ST. CLAIR COUNTY
C-98-334-07

F.A.U. RTE.	SECTION	COUNTY	TOTAL SHEETS	SHEET NO.
9276	05-00029-02-RS	ST CLAIR	10	1
FED. ROAD DIST. NO.	ILLINOIS	FED. AID PROJECT		
CONTRACT NO. 97311				

INDEX OF SHEETS

- 1 COVER SHEET
- 2 GENERAL NOTES, SUMMARY OF QUANTITIES AND TYPICAL ROADWAY SECTIONS
- 3 SCHEDULE OF QUANTITIES
- 4-10 PLAN AND PROFILE SHEETS

STANDARDS

000001-04	701301-02	702001-06
424001-04	701311-02	780001-01
606001-03	701501-03	781001-02

UTILITY OWNERS

SEE SHEET 2 FOR UTILITY OWNERS

SCALES USED FOR VARIOUS PLAN SHEETS

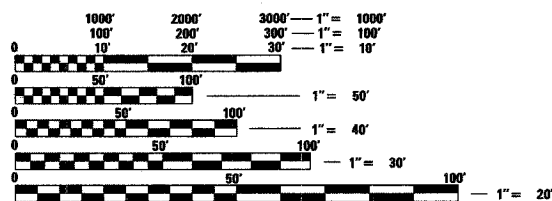

FULL SIZE PLANS HAVE BEEN PREPARED USING STANDARD ENGINEERING SCALES. REDUCED SIZED PLANS WILL NOT CONFORM TO STANDARD SCALES. IN MAKING MEASUREMENTS ON REDUCED PLANS, THE ABOVE SCALES MAY BE USED.

J.U.L.I.E.
JOINT UTILITY LOCATION INFORMATION FOR EXCAVATION
1-800-892-0123

CONTRACT NO. 97311

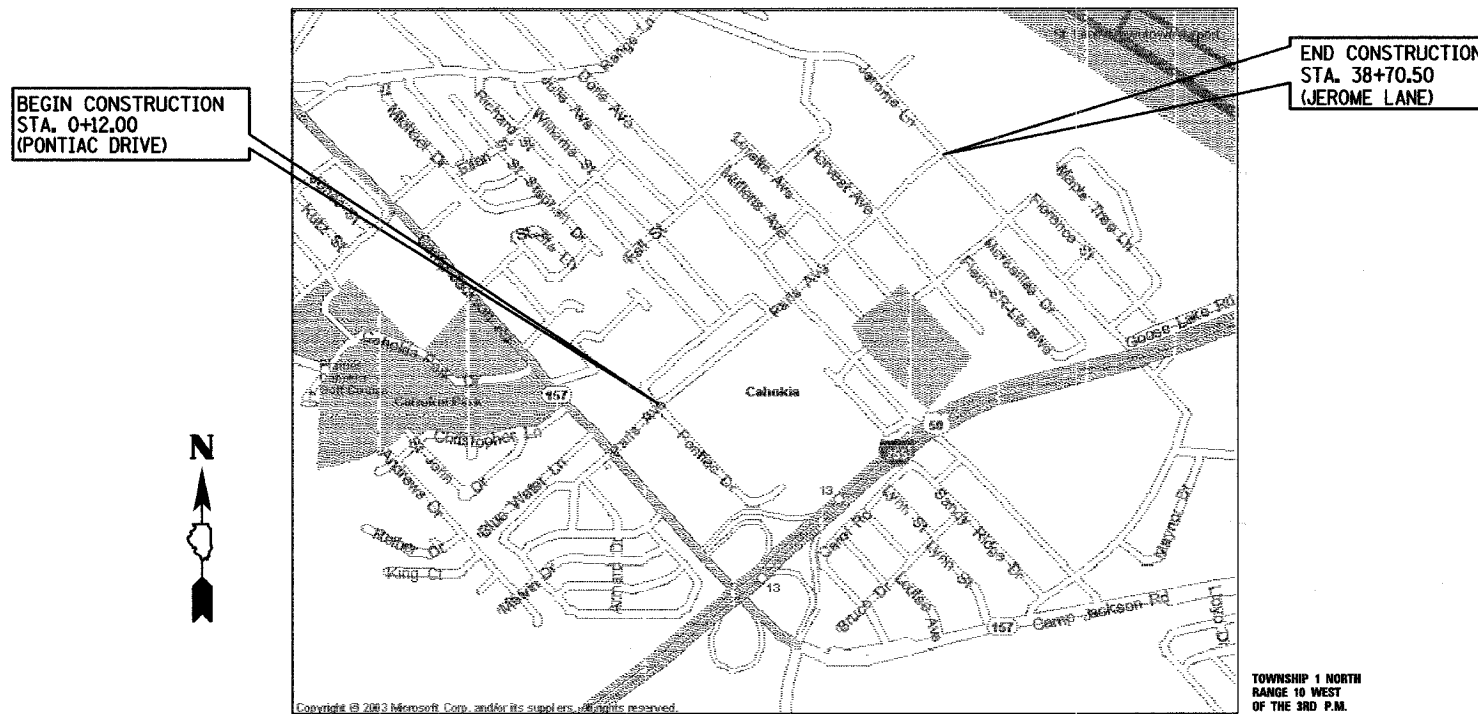

TOTAL LENGTH OF SECTION: 3858.5 FEET = 0.7308 MILES

DESIGN SPEED
URBAN 30 MPH

ROADWAY DESIGN DESIGNATION
LOCAL (RESIDENTIAL) (TWS-2)

CURRENT ADT = 3400

LOCATION MAP



Jeremy J. Connor 4/5/07
ILL PE 062-057938 JEREMY J. CONNOR DATE
LICENSE EXPIRES 11/30/2007

TOWNSHIP 1 NORTH
RANGE 10 WEST
OF THE 3RD P.M.

END CONSTRUCTION
STA. 38+70.50
(JEROME LANE)

BEGIN CONSTRUCTION
STA. 0+12.00
(PONTIAC DRIVE)

ILLINOIS DEPARTMENT OF TRANSPORTATION

APPROVED _____ 20 _____
Frank C. Bergman
VILLAGE OF CAHOKIA, BOARD PRESIDENT

PASSED April 13 20 07
Jennifer S. Bertino
DISTRICT 8 ENGINEER OF LOCAL ROADS & STREETS

RELEASING FOR BID
BASED ON LIMITED
REVIEW 4-13 20 07
Mary C. Lammie
DEPUTY DIRECTOR OF HIGHWAYS, REGION 5 ENGINEER

HURST-ROSCHER ENGINEERS, INC
CONSULTING ENGINEERS
EAST ST LOUIS, ILLINOIS

F.A.U. RTE.	SECTION	COUNTY	TOTAL SHEETS	SHEET NO.
9276	05-00029-02-RS	CAHOKIA	10	2
STA.		TO STA.		
FED. ROAD DIST. NO.		ILLINOIS FED. AID PROJECT		
CONTRACT NO. 97311				

SUMMARY OF QUANTITIES

CODE NO.	ITEM	UNITS	TOTAL
40600100	BITUMINOUS MATERIALS (PRIME COAT)	GALLON	1250
40600300	AGGREGATE (PRIME COAT)	TON	25
40603315	HOT-MIX ASPHALT SURFACE COURSE, MIX "C", N70	TON	1400
42400100	PORTLAND CEMENT CONCRETE SIDEWALK 4 INCH	SQ FT	1418
42400800	DETECTABLE WARNINGS	SQ FT	18
44000157	HOT-MIX ASPHALT SURFACE REMOVAL, 2"	SQ YD	12500
44000500	COMBINATION CURB AND GUTTER REMOVAL	FOOT	47
44000600	SIDEWALK REMOVAL	SQ FT	1356
60605000	COMBINATION CONCRETE CURB AND GUTTER, TYPE B-6.24	FOOT	47
70101700	TRAFFIC CONTROL AND PROTECTION	L SUM	1
70300100	SHORT-TERM PAVEMENT MARKING	FOOT	1052
70301000	WORK ZONE PAVEMENT MARKING REMOVAL	SQ FT	351
78000200	THERMOPLASTIC PAVEMENT MARKING - LINE 4"	FOOT	862
78000400	THERMOPLASTIC PAVEMENT MARKING - LINE 6"	FOOT	1157
78000600	THERMOPLASTIC PAVEMENT MARKING - LINE 12"	FOOT	236

Δ SPECIALTY ITEMS

GENERAL NOTES

- THIS SECTION SHALL BE CONSTRUCTED IN ACCORDANCE WITH THE PLANS, THE "STANDARD SPECIFICATION FOR ROAD AND BRIDGE CONSTRUCTION" ADOPTED JANUARY 1, 2007 AND THE SPECIAL PROVISIONS.
- CONTRACTOR TO SAW-CUT ALL EXISTING PAVEMENT A DEPTH OF 2" IN ALL AREAS WHERE IT ABUTS PROPOSED PAVEMENT. SAW CUTS SHALL BE INCLUDED IN THE UNIT PRICE FOR HMA SURFACE REMOVAL, 2". BUTT JOINTS WILL NOT BE PAID FOR SEPARATELY, BUT SHALL BE INCLUDED IN THE COST FOR HMA SURFACE REMOVAL, 2".
- ALL STATIONING REFERS TO THE CENTERLINE OF NEW CONSTRUCTION.
- ANY STANDARD NUMBER LISTED SHALL BE INTERPRETED TO MEAN THE COPY OF THE STANDARD INCLUDED IN THE SPECIFICATIONS.
- THE LOCATIONS AND / OR DEPTHS OF UNDERGROUND UTILITIES SHOWN HAVE BEEN TAKEN FROM AVAILABLE RECORD INFORMATION FURNISHED BY THE UTILITY OWNERS AND MUST BE CONSIDERED APPROXIMATE. FIELD MARKING OF FACILITIES IN CRITICAL AREAS MAY BE OBTAINED BY PROVIDING A MINIMUM OF 48 HOURS ADVANCE NOTICE TO J.U.L.I.E. @ (800) 892 - 0123.
- THE FOLLOWING CONSTANTS WERE USED IN THE CALCULATIONS OF QUANTITIES FOR THIS PROJECT:
 HMA SURFACE COURSE, MIX "C" N70 - 112 LBS. / SQ. YD. / INCH THICKNESS
 BITUMINOUS MATERIALS (PRIME COAT) - 0.10 GAL. / SQ. YD.
 AGGREGATE (PRIME COAT) - 4 LBS. / SQ. YD.
- DISPOSAL OF ALL MATERIAL FROM DEMOLITION (CURB REMOVAL, ETC.) SHALL BE INCLUDED IN THE CONTRACT AND PERFORMED IN ACCORDANCE WITH ALL STATE AND LOCAL CODES.
- THE EXISTING RIGHT OF WAY LINES AND WIDTHS SHOWN ON THE PLAN SHEETS WERE TAKEN FROM EXISTING ST. CLAIR COUNTY TAX MAPS AND ATLASES. THE LOCATIONS SHOWN ARE FOR INFORMATIONAL PURPOSES ONLY AND SHOULD BE CONSIDERED APPROXIMATE.

UTILITY OWNERS

WATER: ILLINOIS AMERICAN WATER COMPANY
100 NORTH WATERWORKS DRIVE
BELLEVILLE, ILLINOIS 62223
(618)-277-9887

TELEPHONE: AT&T ILLINOIS
203 GOETHE
COLLINSVILLE, ILLINOIS 62234
618-346-6400

GAS: ILLINOIS POWER COMPANY
CONSTRUCTION DEPARTMENT
DECATUR, ILLINOIS
1-800-892-7715

COMMONFIELDS OF CAHOKIA
PUBLIC WATER DISTRICT
2525 MOUSETTE LANE
CAHOKIA, ILLINOIS 62206
(618)-332-6620

WATER & SEWER: VILLAGE OF CAHOKIA
WATER AND SEWER DEPARTMENT
201 W. 4TH STREET
CAHOKIA, ILLINOIS 62206
618-337-9500

POWER: AMEREN UE
500 EAST BROADWAY
EAST ST. LOUIS, ILLINOIS 62203
1-800-552-7583

CABLE T.V.: A.T. & T. BROADBAND
508 NIAGRA
EAST ALTON, ILLINOIS 62024
618-875-4155

CHARTER COMMUNICATIONS
201 W. DIVISION
MARYVILLE, ILLINOIS 62062
618-345-8122

REVISIONS	
NAME	DATE

ILLINOIS DEPARTMENT OF TRANSPORTATION

GENERAL NOTES, SUMMARY OF QUANTITIES & TYPICAL ROADWAY SECTIONS

SCALE: VERT. HORIZ. DATE: 04/05/07

DRAWN BY: JJC
CHECKED BY: MAR

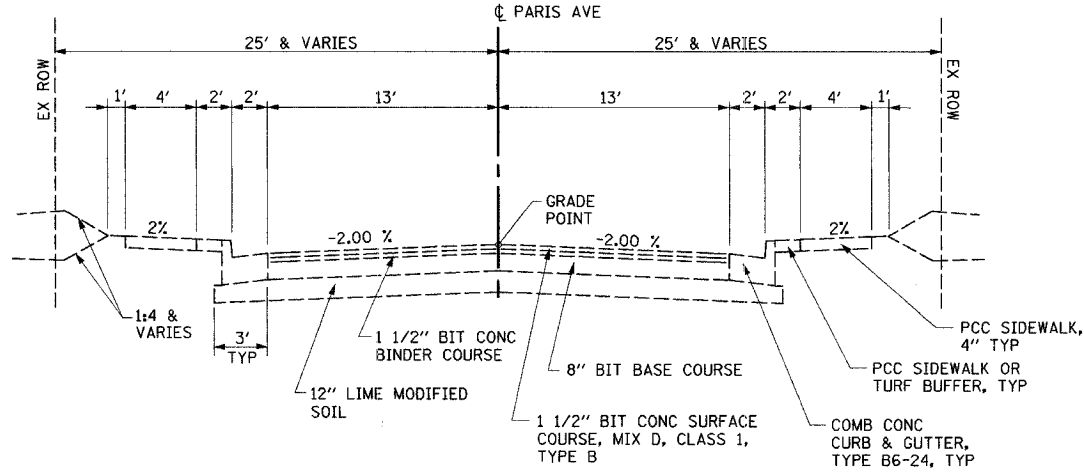

EXISTING TYPICAL SECTION
STA 0+12.00 TO STA 38+70.50

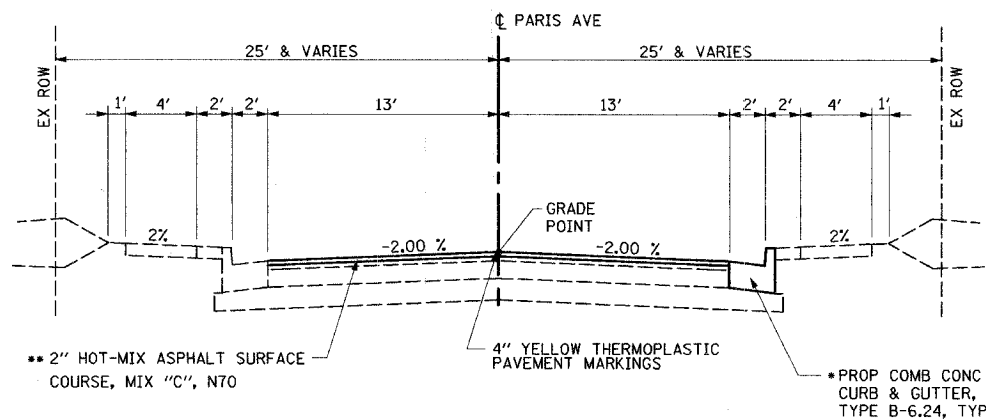

PROPOSED TYPICAL SECTION
STA 0+12.00 TO STA 38+70.50

MIXTURE TABLES

LOCATION:	PARIS AVENUE
MIXTURE USE:	SURFACE COURSE
PG:	PG 64-22
RAP %:	10%
DESIGN AIR VOIDS:	4% @ N _{DESIGN} = 70
MIXTURE COMPOSITION: (GRADATION MIXTURE)	IL-9.5
FRICTION AGGREGATE:	MIXTURE C
MIXTURE WEIGHT:	112 LB/SQ YD/IN

- SEE PLAN SHEETS 4-10 AND SHEET 3 FOR SCHEDULE LOCATIONS
- REMOVE EXISTING BITUMINOUS PAVEMENT (2")

F.A.U. RTE.	SECTION	COUNTY	TOTAL SHEETS	SHEET NO.
9276	05-00029-02-RS	CAHOKIA	10	3
STA.		TO STA.		
FED. ROAD DIST. NO.		ILLINOIS	FED. AID PROJECT	
CONTRACT NO. 97311				

QUANTITY SCHEDULES

HOT-MIX ASPHALT SURFACE COURSE, MIX "C", N70			
STA	STA	Sq Yd	TON
SHEET #1			
00+12.00	to 05+00.00	1500	168.0
SHEET #2			
05+00.00	to 11+00.00	1733	194.1
SHEET #3			
11+00.00	to 17+00.00	1852	207.4
SHEET #4			
17+00.00	to 23+00.00	2240	250.8
SHEET #5			
23+00.00	to 29+00.00	1959	219.4
SHEET #6			
29+00.00	to 35+00.00	1959	219.4
SHEET #7			
35+00.00	to 38+70.50	1258	140.9
TOTAL			1400

PORTLAND CEMENT CONCRETE SIDEWALK 4 INCH			
Sta	Sta	Side	SQ FT
17+55.50	to 17+81.92	Rt	192
20+20.33	to 21+27.34	Rt	540
29+81.66	to 30+63.00	Lt	400
37+12.72	to 37+68.08	Lt	286
TOTAL			1418

THERMOPLASTIC PAVEMENT MARKING - LINE 4"		
Station	Station	FOOT
0+12.00	to 14+55.51	361
15+36.77	to 17+60.71	56
18+39.80	to 21+12.00	68
21+92.00	to 24+62.00	68
25+42.00	to 29+19.25	94
29+91.66	to 38+50.78	215
TOTAL		862

DETECTABLE WARNINGS		
Station	Side	SQ FT
17+71.00	Rt	6
21+27.34	Rt	6
29+81.66	Lt	6
Total		18

COMBINATION CURB AND GUTTER REMOVAL			
Station	Station	Side	FOOT
4+90.00	to 05+10.00	Lt	20
11+10.00	to 11+20.00	Lt	10
17+64.71	to 17+78.74	Rt	17
TOTAL			47

THERMOPLASTIC PAVEMENT MARKING - LINE 6"			
Station	Side	Side Road	FOOT
14+76.13	LT	Old Paris Ave	72
17+64.71			63
17+71.00	RT	Doris Ave	102
18+29.87			63
21+22.20	LT	Mullens Ave	102
21+22.20	RT	Mullens Ave	102
24+76.37	LT	Loretta Ave	96
24+74.37	RT	Loretta Ave	96
29+23.25			60
29+30.40	LT	Harvest Ave	90
29+29.25	RT	Harvest Ave	93
29+81.66			63
38+54.78			155
TOTAL			1157

SHORT-TERM PAVEMENT MARKING			
STA	STA	* of Applications	FOOT
00+12.00	to 38+70.50	3	1052

SIDEWALK REMOVAL			
Station	Station	Side	SQ FT
17+55.50	to 17+81.92	Rt	130
20+20.33	to 21+27.34	Rt	540
29+81.66	to 30+63.00	Lt	400
37+12.72	to 37+68.08	Lt	286
TOTAL			1356

THERMOPLASTIC PAVEMENT MARKING - LINE 12"			
Station	Side	Side Road	FOOT
14+82.00	LT	Old Paris Ave	15
17+60.71	RT		14
17+85.61	LT	Doris Ave	16
18+00.50	RT		19
18+39.80	LT		14
21+34.45	LT	Mullens Ave	18
21+52.00	RT	Mullens Ave	19
24+87.09	LT	Loretta Ave	17
25+02.00	RT	Loretta Ave	17
29+19.24	RT		14
29+40.53	LT	Harvest Ave	17
29+57.00	RT	Harvest Ave	17
29+91.66	LT		14
38+50.78	RT		25
TOTAL			236

WORK ZONE PAVEMENT MARKING REMOVAL				
STA	STA	* of Applications	Width (In)	SQ FT
00+12.00	to 38+70.50	3	4	351

COMBINATION CONCRETE CURB AND GUTTER, TYPE B-6.24			
Station	Station	Side	FOOT
4+90.00	to 05+10.00	Lt	20
11+10.00	to 11+20.00	Lt	10
17+64.71	to 17+78.74	Rt	17
TOTAL			47

REVISIONS	
NAME	DATE

ILLINOIS DEPARTMENT OF TRANSPORTATION



QUANTITY SCHEDULES

SCALE: VERT.
HORIZ.
DATE: 04/05/07

DRAWN BY: JJC
CHECKED BY: MAR

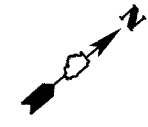
CONTRACT NO.				
F.A.U. RTE.	SECTION	COUNTY	TOTAL SHEETS	SHEET NO.
9276	05-00029-02-RS	CAHOKIA	10	5
STA. 5+00.00		TO STA. 11+00.00		
FED. ROAD DIST. NO.		ILLINOIS	FED. AID PROJECT	
CONTRACT NO. 97311				



 LIMITS OF HMA SURFACE REMOVAL (2") & PROPOSED 2" HMA SURFACE COURSE
 4" YELLOW THERMOPLASTIC SKIP DASH STRIPING (10' - 30' SKIP)

NOTE: STATIONS ARE APPROXIMATE FOR PROP C&G TO BE REPLACED AS DIRECTED BY THE ENGINEER.

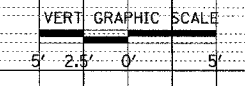
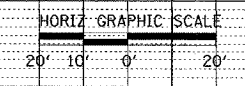
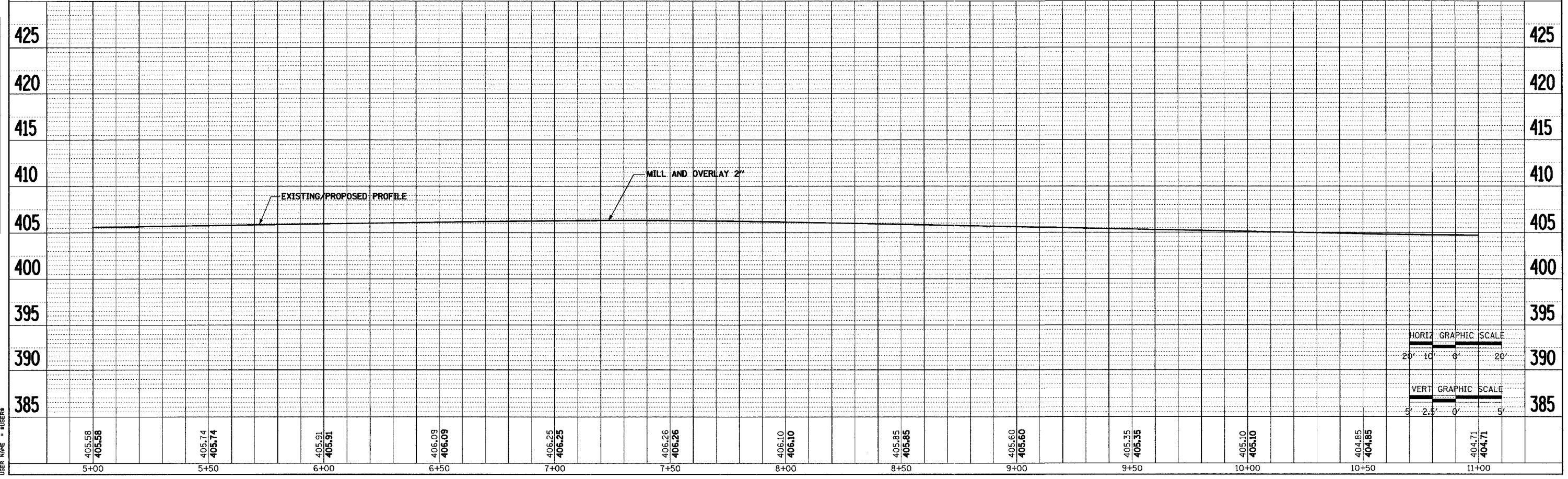
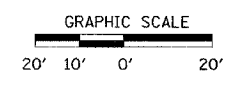
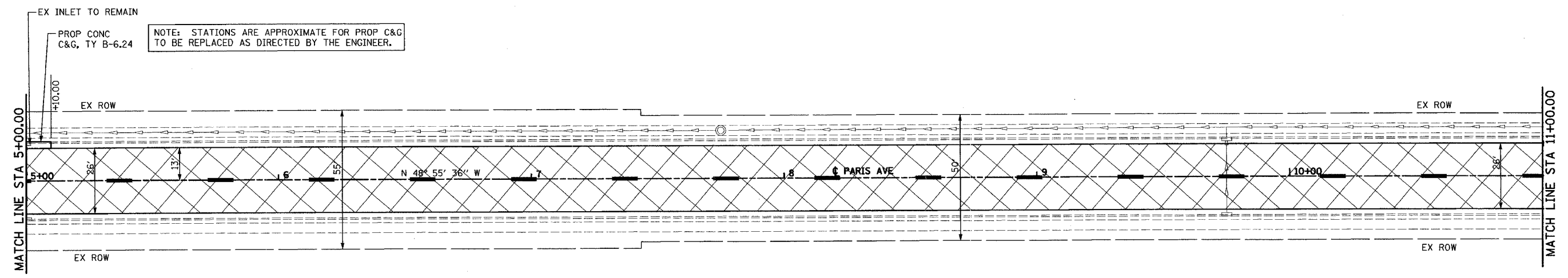

DATE	BY

SURVEYED: _____
 PLAN: _____
 NOTE BOOK: _____
 NO.: _____



DATE	BY

PROFILE: _____
 GRADES CHECKED: _____
 NO.: _____

PLOT DATE = 8/04/09
 FILE NAME = #FILE#
 USER NAME = #USER#

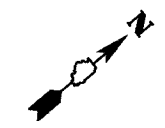
F.A.U. RTE.	SECTION	COUNTY	TOTAL SHEETS	SHEET NO.
9276	05-00029-02-RS	CAHOKIA	10	8
STA. 23+00.00		TO STA. 29+00.00		
FED. ROAD DIST. NO.		ILLINOIS FED. AID PROJECT		
CONTRACT NO. 97311				

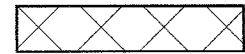

-  LIMITS OF HMA SURFACE REMOVAL (2") & PROPOSED 2" HMA SURFACE COURSE
-  4" YELLOW THERMOPLASTIC SKIP DASH STRIPING (10' - 30' SKIP)
-  12" WHITE THERMOPLASTIC PAVEMENT MARKING

MATCH LINE STA 23+00.00

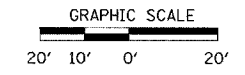
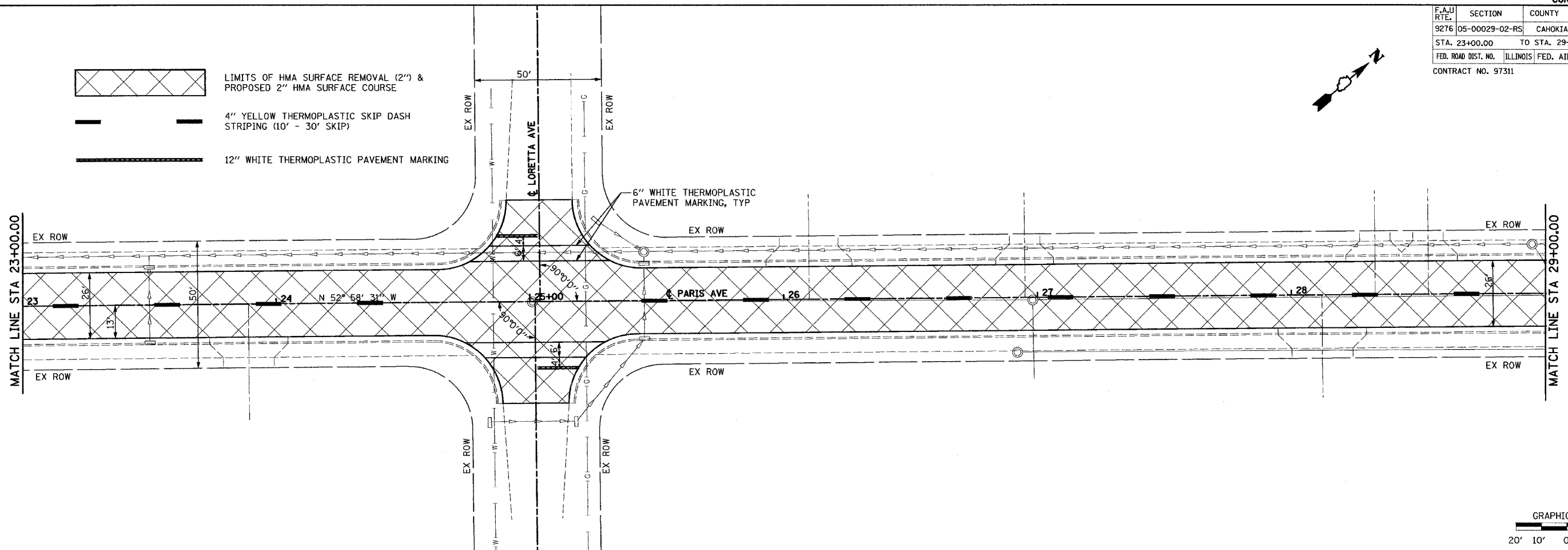

PLAN	SURVEYED	DATE
NOTE BOOK	BY	
NO.	NO.	
	FILE NAME	

PROFILE	SURVEYED	DATE
NOTE BOOK	BY	
NO.	NO.	
	FILE NAME	

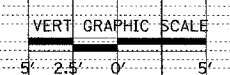
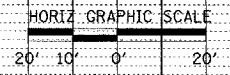
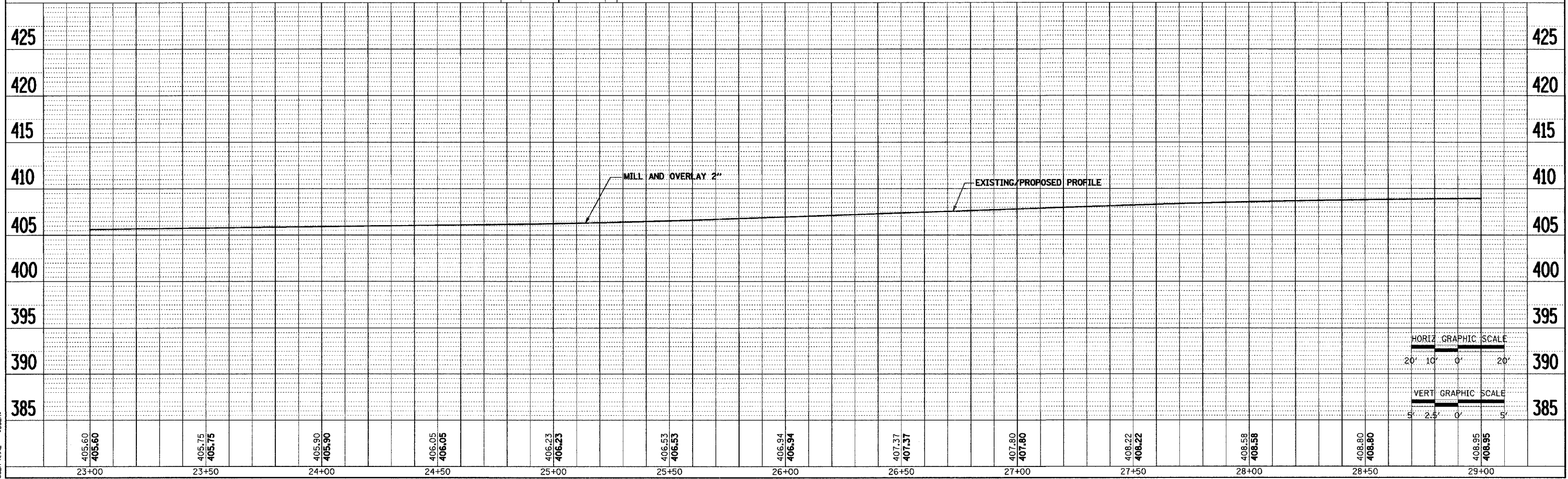

PLOT DATE = #DATE#
 FILE NAME = #FILE#
 PLOT SCALE = #SCALE#
 USER NAME = #USER#

F.A.U. RTE.	SECTION	COUNTY	TOTAL SHEETS	SHEET NO.
9276	05-00029-02-RS	CAHOKIA	10	9
STA. 29+00.00		TO STA. 35+00.00		
FED. ROAD DIST. NO.		ILLINOIS	FED. AID PROJECT	
CONTRACT NO. 97311				

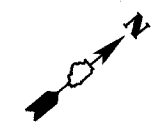

DATE	BY

DATE	BY

PLOT DATE = #DATE#
 FILE NAME = #FILE#
 USER NAME = #USER#

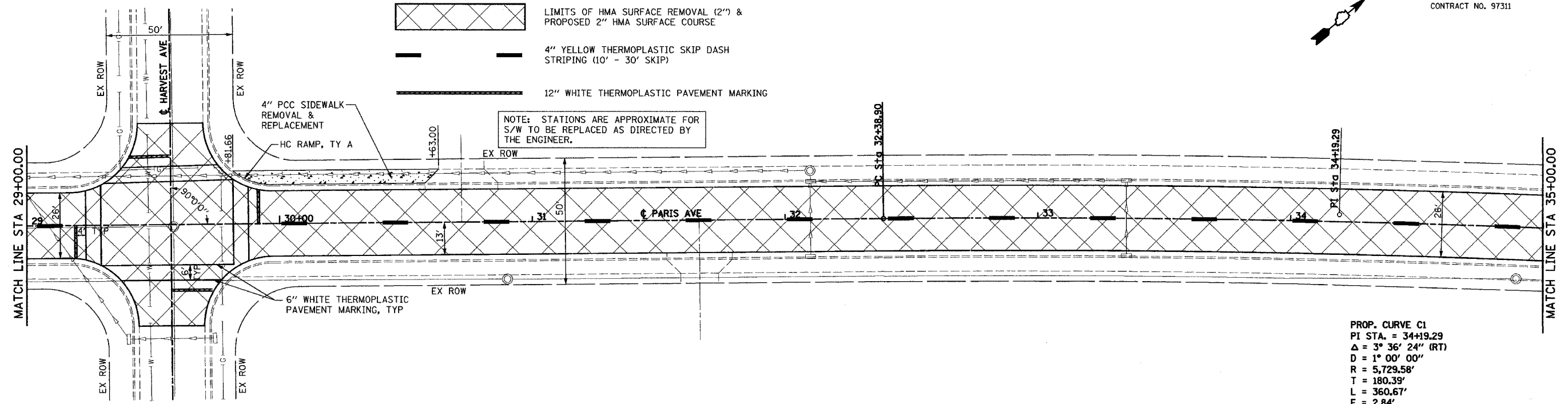

PROP. CURVE C1
 PI STA. = 34+19.29
 $\Delta = 3^\circ 36' 24''$ (RT)
 D = 1° 00' 00"
 R = 5,729.58'
 T = 180.39'
 L = 360.67'
 E = 2.84'
 e = NC
 T.R. = NA
 S.E. RUN = NA
 P.C. STA = 32+38.90
 P.T. STA = 35+99.57

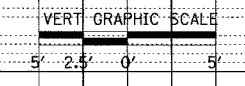
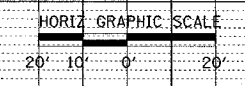
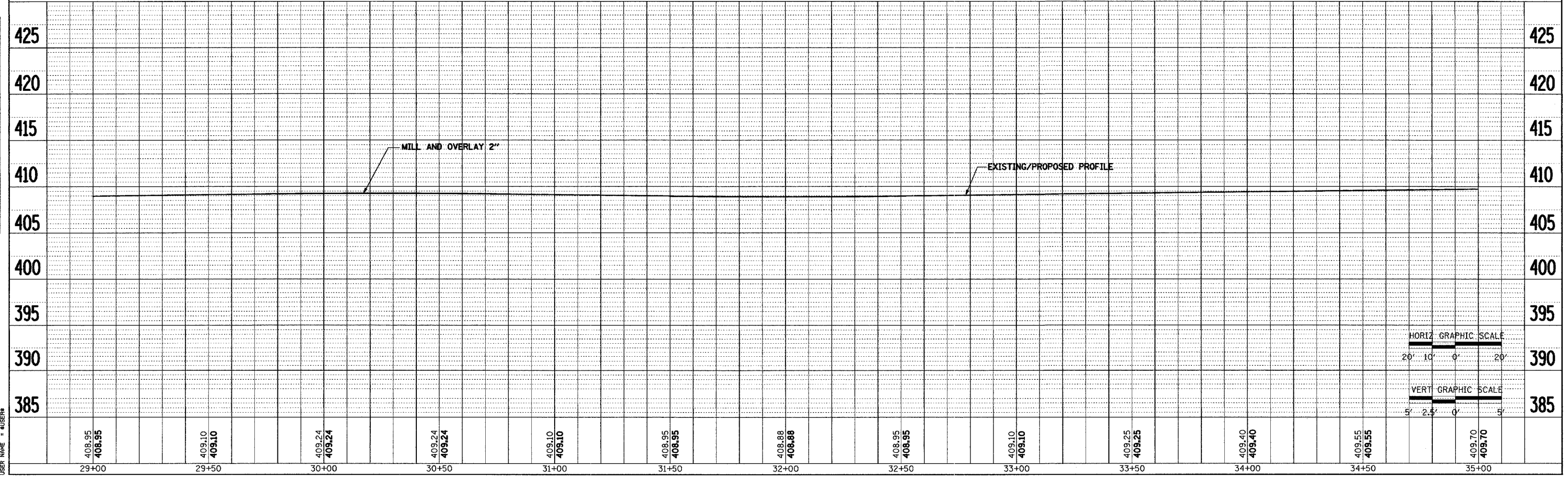
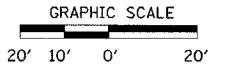

F.A.U. RTE.	SECTION	COUNTY	TOTAL SHEETS	SHEET NO.
9276	05-00029-02-RS	CAHOKIA	10	10
STA. 35+00.00		TO STA. 39+00.00		
FED. ROAD DIST. NO.		ILLINOIS	FED. AID PROJECT	
CONTRACT NO. 97311				

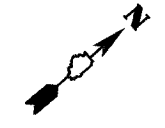

- LIMITS OF HMA SURFACE REMOVAL (2") & PROPOSED 2" HMA SURFACE COURSE
- 4" YELLOW THERMOPLASTIC SKIP DASH STRIPING (10' - 30' SKIP)
- 12" WHITE THERMOPLASTIC PAVEMENT MARKING

NOTE: STATIONS ARE APPROXIMATE FOR S/W TO BE REPLACED AS DIRECTED BY THE ENGINEER.

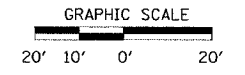
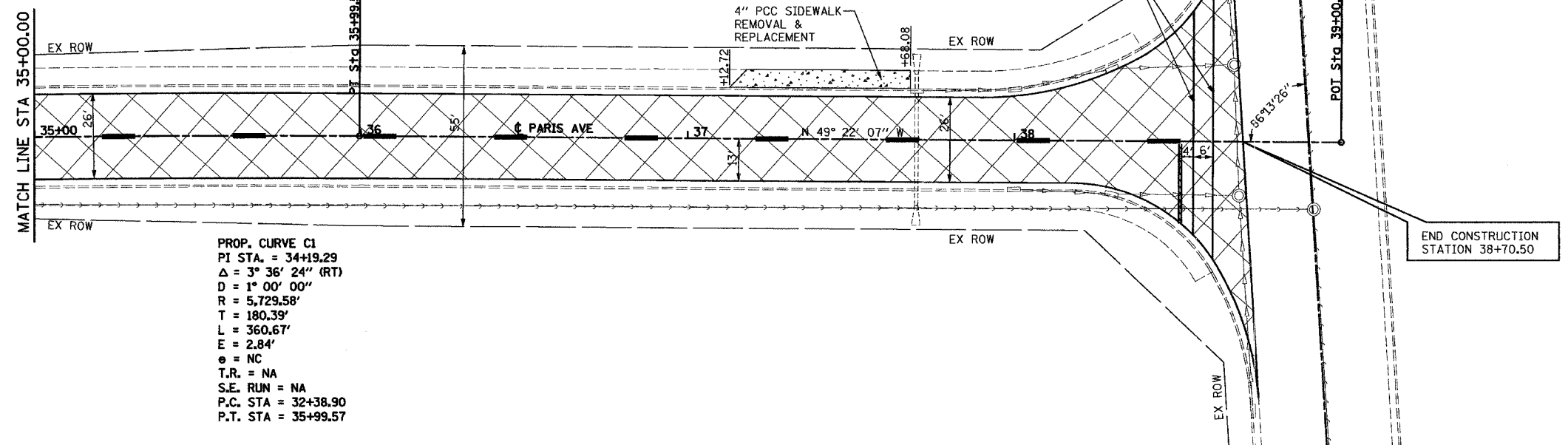

PLAN	DATE
BY: _____	DATE: _____
NO. _____	DATE: _____

PROFILE	DATE
BY: _____	DATE: _____
NO. _____	DATE: _____

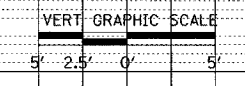
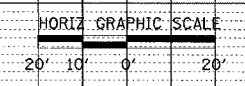
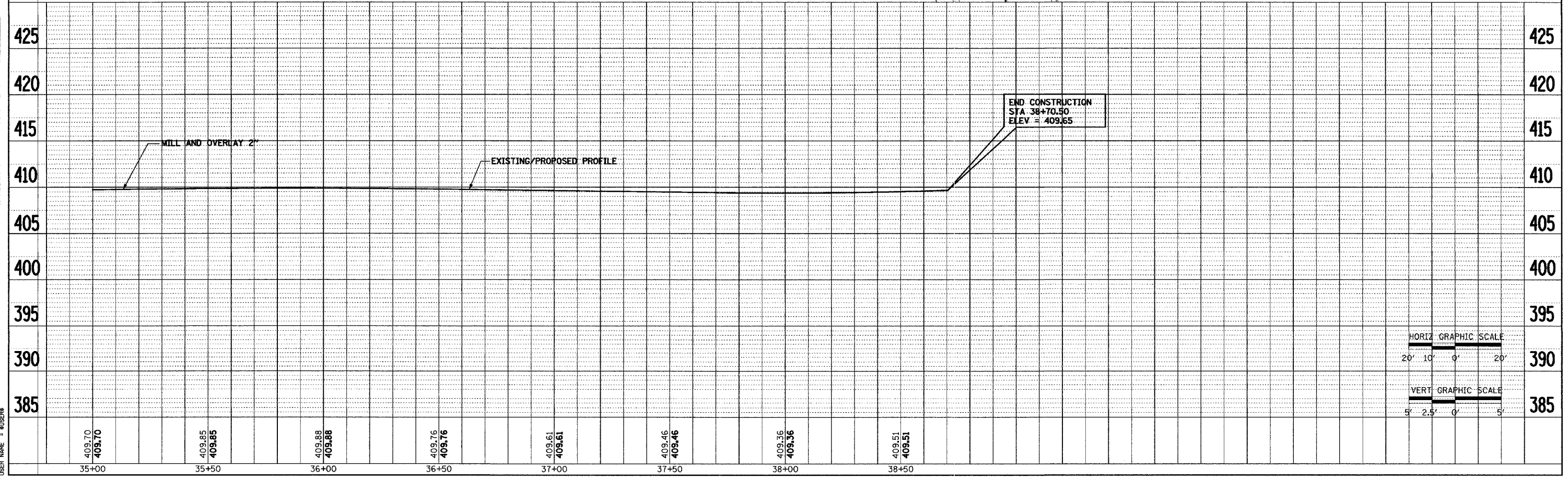

PLOT DATE = 8/24/07
 FILE NAME = 871110
 USER NAME = MUSER