

F.A.I. RTE.	SECTION	COUNTY	TOTAL SHEETS	SHEET NO
57	77-03, 4-1, 4-2RS-2	PULASKI	52	35
STA.	TO STA.			
FED. ROAD DIST. NO.	ILLINOIS	FED. AID PROJECT		
		CONTRACT NO. 98829		

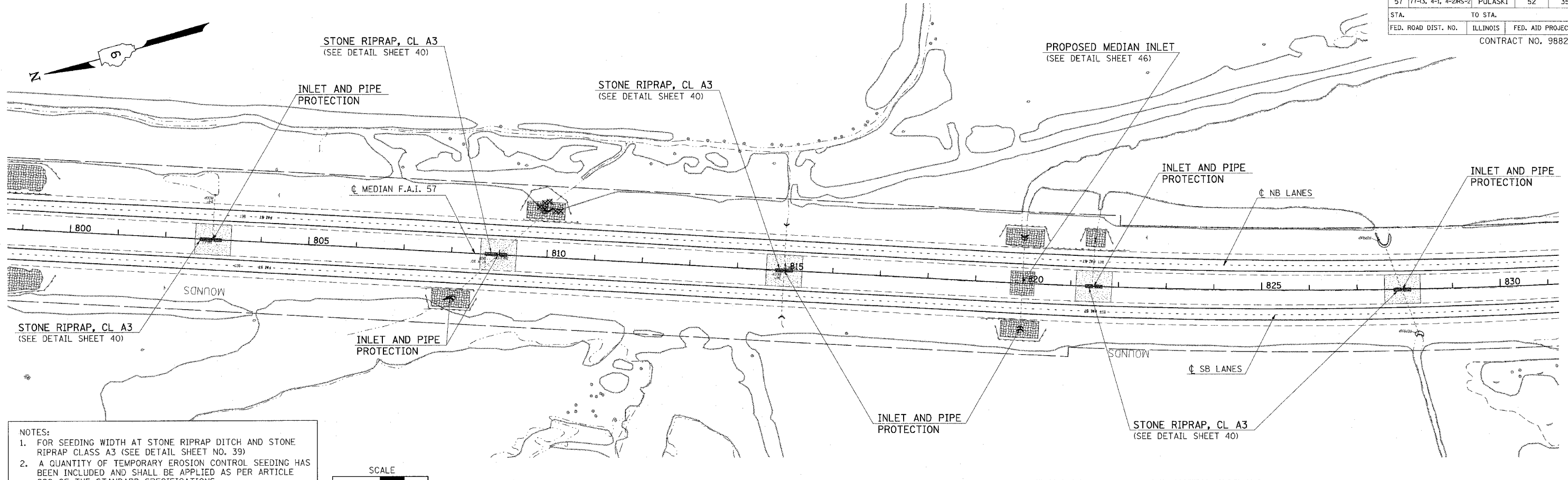

NOTES:
 1. FOR SEEDING WIDTH AT STONE RIPRAP DITCH AND STONE RIPRAP CLASS A3 (SEE DETAIL SHEET NO. 39)
 2. A QUANTITY OF TEMPORARY EROSION CONTROL SEEDING HAS BEEN INCLUDED AND SHALL BE APPLIED AS PER ARTICLE 280 OF THE STANDARD SPECIFICATIONS.

LEGEND

- SEEDING, CLASS 2 (MODIFIED); SEEDING CLASS 7; MULCH METHOD 2
- EROSION CONTROL BLANKET
- PERIMETER EROSION BARRIER

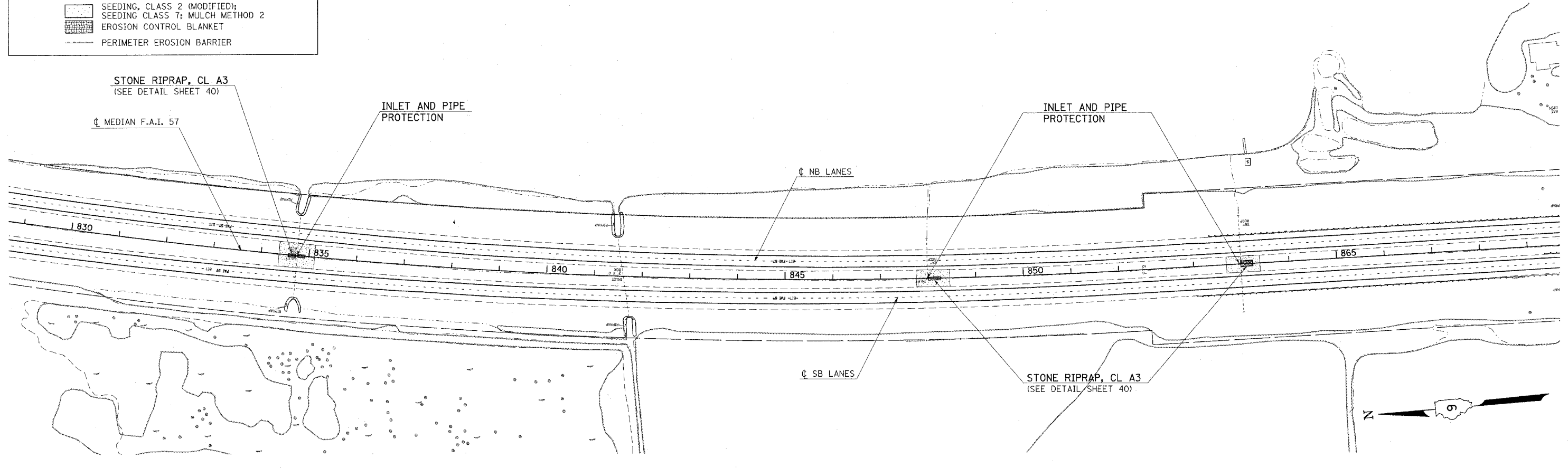
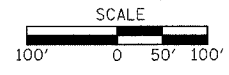

PLOT DATE = 3/21/2007
 FILE NAME = c:\p\projects\1044603\1044603.dwg
 PLOT SCALE = 100.0000 / 1 IN.
 USER NAME = thomashf

EROSION CONTROL PLAN STA 800+00 TO 865+00