

F.A.I. RTE.	SECTION	COUNTY	TOTAL SHEETS	SHEET NO
57	77-G, 4-1, 4-2RS-2	PULASKI	52	37
STA.	TO STA.			
FED. ROAD DIST. NO.	ILLINOIS	FED. AID PROJECT		
CONTRACT NO. 98829				

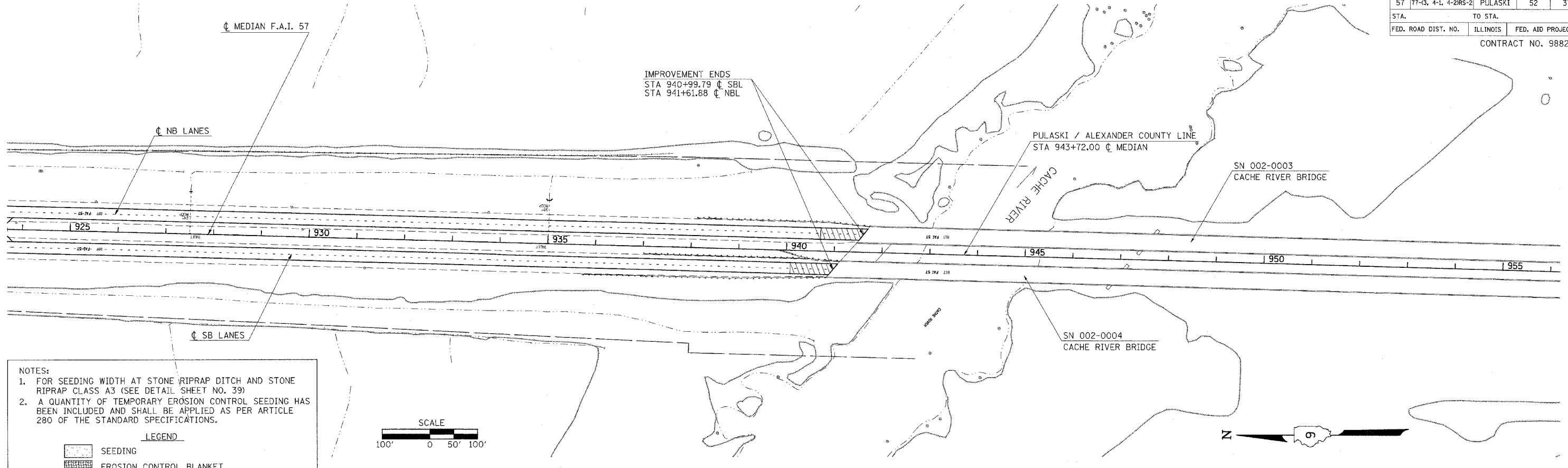

- NOTES:
1. FOR SEEDING WIDTH AT STONE RIPRAP DITCH AND STONE RIPRAP CLASS A3 (SEE DETAIL SHEET NO. 39)
  2. A QUANTITY OF TEMPORARY EROSION CONTROL SEEDING HAS BEEN INCLUDED AND SHALL BE APPLIED AS PER ARTICLE 280 OF THE STANDARD SPECIFICATIONS.

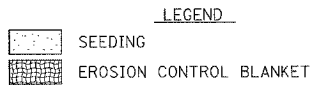

- CULVERT CLEANING STAGES**
- STAGE 1: DIVERT FLOW THROUGH A CELL AND BLOCK OFF THE CELLS TO BE CLEANED
- STAGE 2: DIVERT FLOW THROUGH CLEANED CELLS AND CLEAN REMAINING CELL

- NOTES:
- PERIMETER EROSION BARRIER SHALL BE INSTALLED PRIOR TO THE START OF CLEANING.
- SEEDING OF THE WASTED MATERIAL SHALL BE PERFORMED AFTER PLACEMENT.

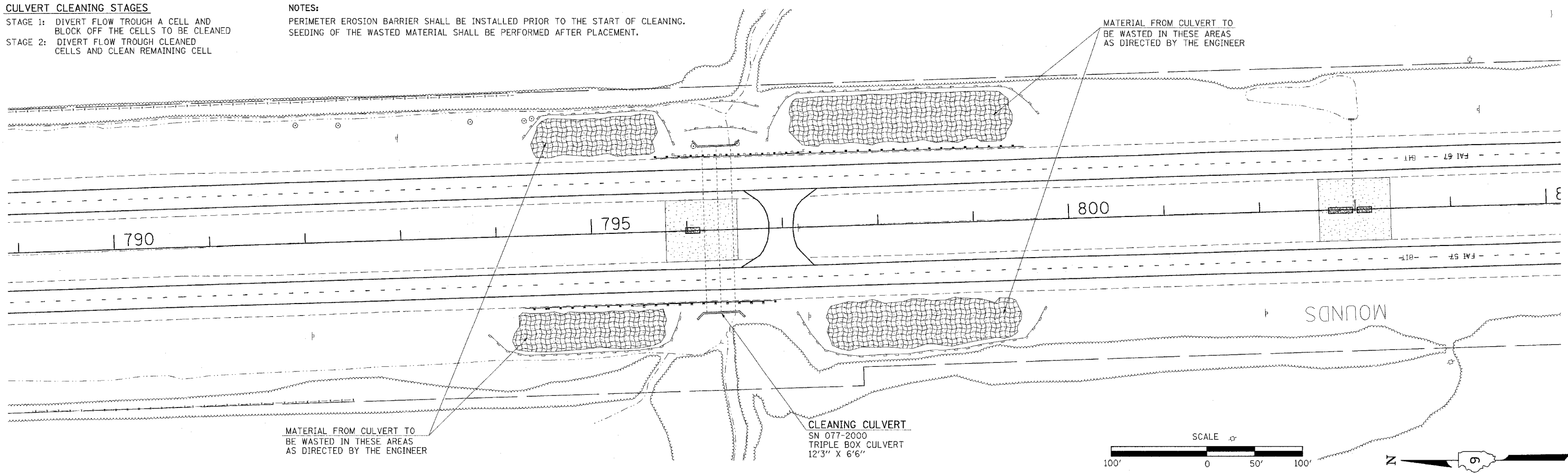

PLOT DATE = 3/21/2007  
 FILE NAME = c:\p\projects\98829\98829.dwg  
 PLOT SCALE = 1/8" = 1' IN.  
 USER NAME = thomson

**EROSION CONTROL PLAN STA 925+00 TO 955+00  
CULVERT CLEANING DETAIL**