

F.A.I. RTE.	SECTION	COUNTY	TOTAL SHEETS	SHEET NO
57	77-3, 4-1, 4-2RS-2	PULASKI	52	38
STA.	TO STA.			
FED. ROAD DIST. NO.	ILLINOIS	FED. AID PROJECT		

98829

PAVEMENT DETAIL AT TR 44 OVERPASS (SN 077-0031)
NORTHBOUND
CL STA 699+45

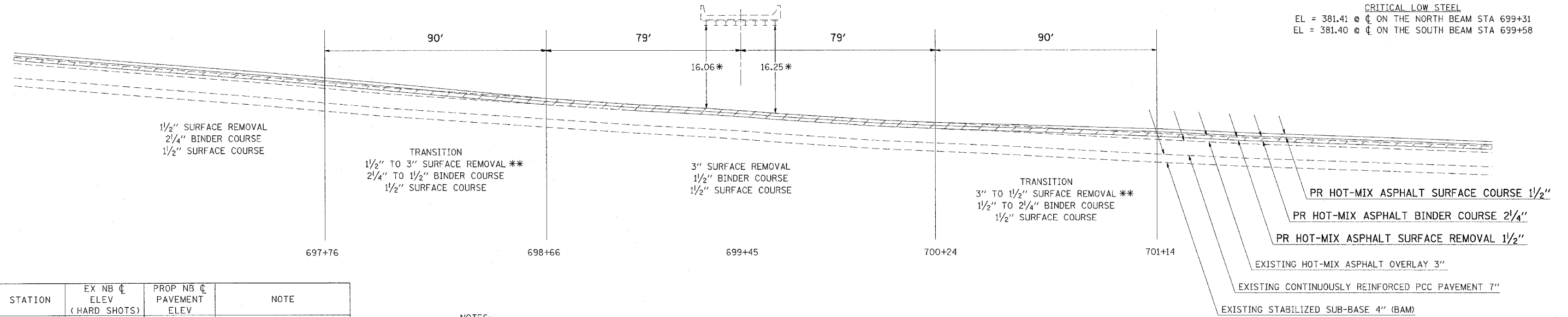
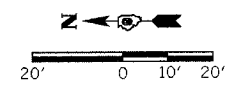

CRITICAL LOW STEEL
EL = 381.41 @ CL ON THE NORTH BEAM STA 699+31
EL = 381.40 @ CL ON THE SOUTH BEAM STA 699+58

DATE	BY
DATE	BY

DATE	BY
DATE	BY

STATION	EX NB CL ELEV (HARD SHOTS)	PROP NB CL PAVEMENT ELEV	NOTE
697+50	366.66	366.85	
697+76	366.43	366.62	BEGIN TRANSITION
698+00	366.21	366.39	
698+25	366.04	366.15	
698+50	365.87	365.91	
698+66	365.76	365.76	BEGIN 3" REMOVAL
699+00	365.52	365.52	
699+31	365.35	365.35	
699+45	365.25	365.25	CL BRIDGE
699+50	365.22	365.22	
699+58	365.15	365.15	
699+75	365.04	365.04	
700+00	364.87	364.87	
700+24	364.76	364.76	BEGIN TRANSITION
700+50	364.65	364.68	
700+75	364.51	364.61	
701+00	364.38	364.54	
701+14	364.31	364.50	RESUME 1 1/2" REMOVAL
701+50	364.14	364.33	

NOTES:
① THE PROPOSED PAVEMENT SHALL BE CONSTRUCTED UTILIZING STRING LINE GRADE CONTROL WITH A MAXIMUM PIN SPACING OF 25 FEET.

* A MINIMUM VERTICAL CLEARANCE OF 16' 0" TO BE ACHIEVED BY INCREASING THE MILLING DEPTH AND REDUCING THE BINDER THICKNESS.
** SURFACE REMOVAL IN TRANSITION AREAS WILL BE PAID FOR AS HMA SURFACE REMOVAL (VARIABLE DEPTH)

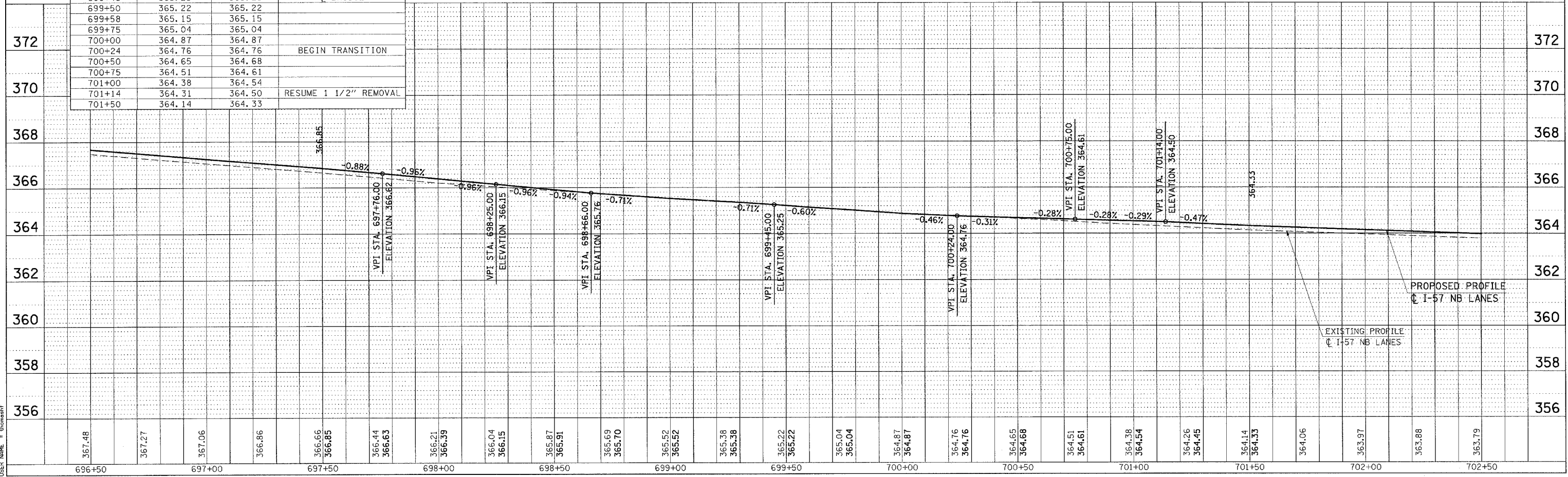

PLOT DATE = 3/21/2007
FILE NAME = c:\pws\mets\03916803\03916803.dwg
USER NAME = bbonamir