

F.A.I. RTE.	SECTION	COUNTY	TOTAL SHEETS	SHEET NO.
57	.	ALEXANDER	22	1

02-(1,1-1,1-2,1-3)RS-1

STATE OF ILLINOIS  
DEPARTMENT OF TRANSPORTATION  
DIVISION OF HIGHWAYS

**PROPOSED  
INTERSTATE HIGHWAY PLANS**

F.A.I. ROUTE 57 (I-57)  
SECTION 02-(1, 1-1, 1-2, 1-3)RS-1

ALEXANDER COUNTY  
C-99-017-05

D-99-011-05

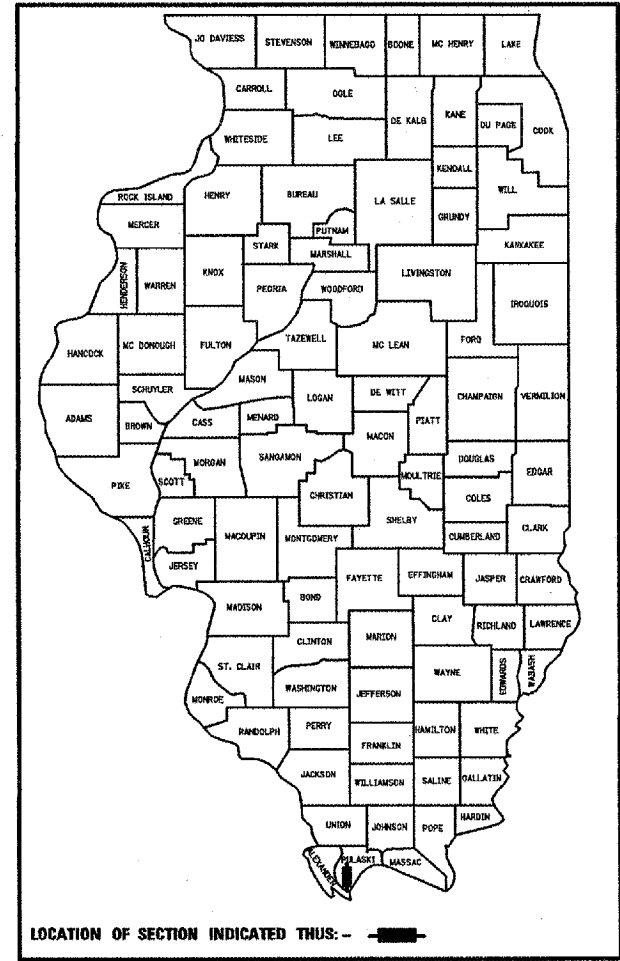

LOCATION OF SECTION INDICATED THUS: -

FOR INDEX OF SHEETS, SEE SHEET NO. 2  
FOR SUMMARY OF QUANTITIES, SEE SHEET NO. 4

STATION EQUATIONS

- EQ. STA. 1019+23.07 BK.(C MEDIAN) = STA. 1017A+42.64 AH. (C MEDIAN)
- EQ. STA. 1020A+00.0 BK.(C MEDIAN)= STA. 1020+00.0 AH. (C MEDIAN)
- EQ. STA. 1083+00.00 BK.(C MEDIAN)= STA. 1083+00.00 AH. (C NBL & C SBL)
- EQ. STA. 1134+12.70 BK.(C SBL) & STA. 1134+36.20 BK. (C NBL) = STA. 1134+24.45 AH. (C MEDIAN)

TRAFFIC DATA

- I-57 TRAFFIC DATA
- 2005 ADT = 10,500 WITH 47% TRUCKS
- PV = 5600
- SU = 600
- MU = 4300

TOWNSHIPS

- CACHE NO. 1
- CACHE NO. 2

STRUCTURES TO BE OMITTED:

- S.N. 002-0001 - N.B. STA. 965+84
- S.N. 002-0002 - S.B. STA. 965+84
- S.N. 002-0023 - N.B. STA. 1089+22.46 TO STA. 1120+11.74
- S.N. 002-0024 - S.B. STA. 1089+37.39 TO STA. 1120+11.74
- S.N. 002-0025 - RAILROAD OVERPASS STA. 1030+85.86

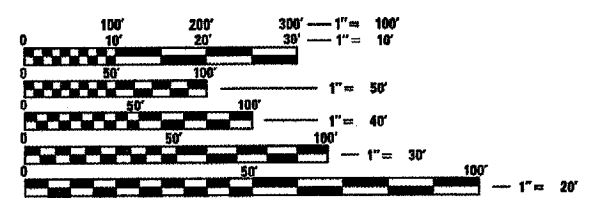
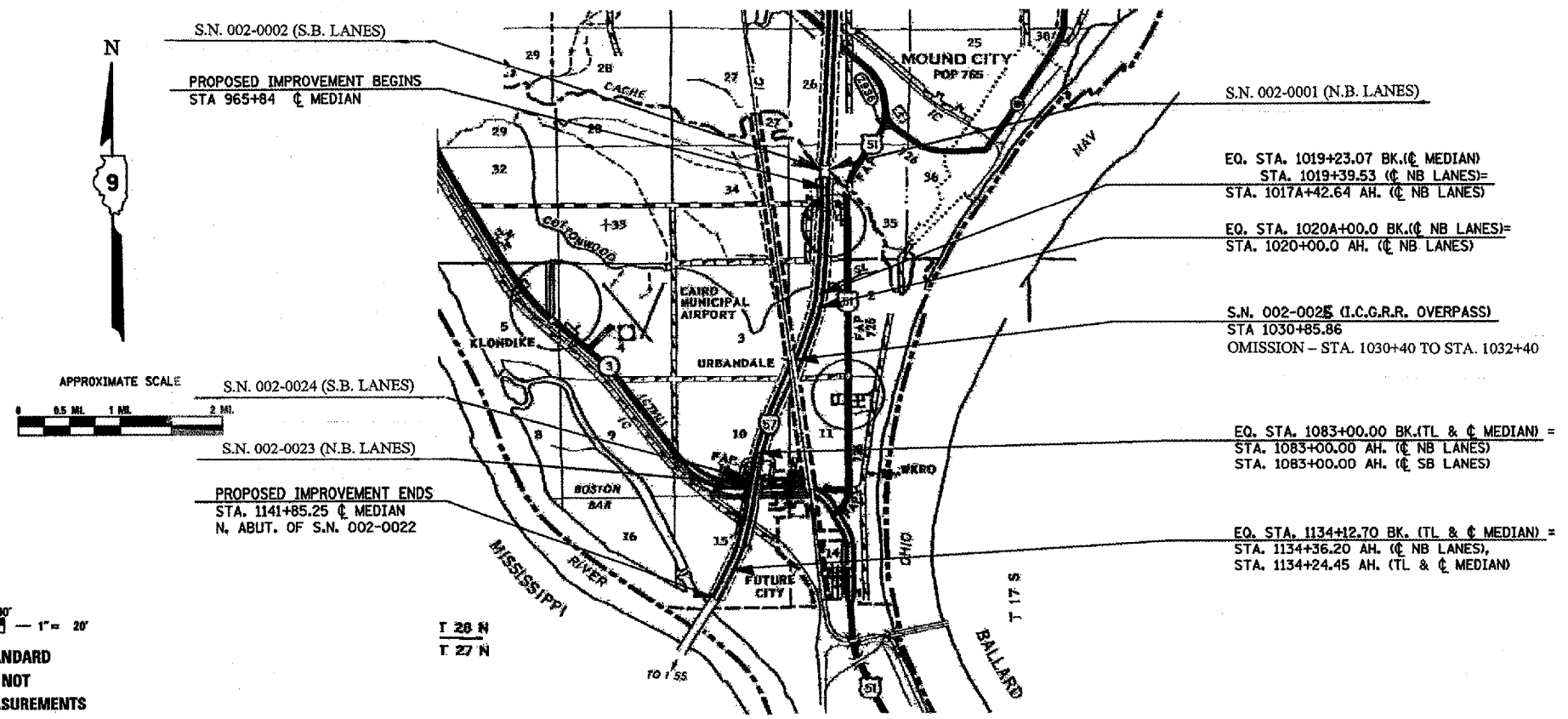

FULL SIZE PLANS HAVE BEEN PREPARED USING STANDARD ENGINEERING SCALES. REDUCED SIZED PLANS WILL NOT CONFORM TO STANDARD SCALES. IN MAKING MEASUREMENTS ON REDUCED PLANS, THE ABOVE SCALES MAY BE USED.

J.U.L.I.E.  
JOINT UTILITY LOCATION INFORMATION FOR EXCAVATION  
1-800-892-0123 or www.julie1call.com

GROSS LENGTH OF PROJECT = 17,770 FT = 3.36 MILES (SB)  
17,775 FT = 3.37 MILES (NB)

NET LENGTH OF PROJECT = 14,695 FT = 2.78 MILES (SB)  
14,685 FT = 2.78 MILES (NB)

STATE OF ILLINOIS  
DEPARTMENT OF TRANSPORTATION  
DIVISION OF HIGHWAYS

SUBMITTED April 20 07  
May 11 20 07  
May 11 20 07  
May 11 20 07

Eric E. Harshbarger  
ENGINEER OF DESIGN AND ENVIRONMENT

Melton R. Sees P.E.  
DIRECTOR OF HIGHWAYS, CHIEF ENGINEER

**PRINTED BY THE AUTHORITY  
OF THE STATE OF ILLINOIS**

CONTRACT NO. 98905

PROJECT ENGINEER: CHARLES STEIN  
 DESIGN TECHNICIAN: KATHI MCCORD  
 (618)351-5210  
 (618)351-5291